

RECEIVED

AUG 29 2008

FORM APPROVED  
OMB No 1004-0135  
Expires July 31, 2010UNITED STATES  
DEPARTMENT OF THE INTERIOR  
BUREAU OF LAND MANAGEMENTBureau of Land Management  
Farmington Field OfficeLease Serial No  
Office

NM - 012200

## SUNDRY NOTICES AND REPORTS ON WELLS

*Do not use this form for proposals to drill or to re-enter an  
Abandoned well Use Form 3160-3 (APD) for such proposals.***SUBMIT IN TRIPLICATE - Other instructions on reverse side**

1 Type of Well <input type="checkbox"/> Oil Well <input checked="" type="checkbox"/> Gas Well <input type="checkbox"/> Other		6 If Indian, Allottee or tribe Name <b>RCVD SEP 2 '08</b>
2 Name of Operator <b>BP America Production Company Attn: Kristen Holder</b>		7 If Unit or CA/Agreement, Name and/or No <b>OIL CONS. DIV. DIST. 3</b>
3a Address <b>P.O. Box 3092 Houston, TX 77253</b>	3b Phone No (include area code) <b>281-</b>	8 Well Name and No <b>Dryden 1</b>
4 Location of Well (Footage, Sec., T., R., M., or Survey Description) <b>790' FSL &amp; 1190' FWL SEC 28 T28N R08W</b>		9 API Well No <b>30-045-11881</b>
		10 Field and Pool, or Exploratory Area <b>Blanco MesaVerde &amp; Otero Chacra</b>
		11 County or Parish, State <b>San Juan County, New Mexico</b>

## 12. CHECK APPROPRIATE BOX(ES) TO INDICATE NATURE OR NOTICE, REPORT, OR OTHER DATA

## TYPE OF SUBMISSION

☒ Notice of Intent☐ Subsequent Report☐ Final Abandonment Notice

## TYPE OF ACTION

☐ Acidize☐ Alter Casing☐ Casing Repair☐ Change Plans☐ Convert to Injection☐ Deepen☐ Fracture Treat☐ New Construction☐ Plug and Abandon☐ Plug Back☐ Production (Start/Resume)☐ Reclamation☒ Recomplete☐ Water Disposal☐ Water shut-Off☐ Well Integrity☒ Other Downhole Tri-Commingle

- 13 Describe Proposed or Completed Operation (clearly state all pertinent details, including estimated starting date of any proposed work and approximate duration thereof. If the proposal is to deepen directionally or recomple horizontally, give subsurface locations and measured and true vertical depths of all pertinent markers and zones. Attach the Bond under which the work will be performed or provide the Bond No. on file with BLM/BIA. Required subsequent reports shall be filed within 30 days following completion of the involved operations. If the operation results in a multiple completion or recompletion in a new interval, a Form 3160-4 shall be filed once testing has been completed. Final Abandonment Notices shall be filed only after all requirements, including reclamation, have been completed, and the operator has determined that the site is ready for final inspection.

**BP America Production Company request permission to recomple the subject well into the Blanco MesaVerde & Otero Chacra and commingle production downhole with the existing Basin Dakota as per the attached procedure.**

**Application is also submitted to the NMOCD Santa Fe Office for approval.**

**Notification of the intent to commingle the subject well was sent to all interest owners via certified mail on 08/08/08 and there were no objections.**

**Production is proposed to be allocated based on a fixed percentage. It is our intent to isolate the Dakota, complete into the MV, isolate the MV, & complete into the Chacra. Flow back to stabilize the Chacra & perform a Chacra flow test. Drill out bridge plug between the MV & CH, combined stream test on MV & CH. Chacra test will then be subtracted from the total and a % calculated to determine the flow rate for the MV & CH. A decline will be used for the Dakota (see attached)**

**Commingling Production Downhole in the subject well from the proposed pools will not reduce the value of the total remaining production.**

*No DHC order 9/4/08*

- 14 I hereby certify that the foregoing is true and correct  
Name (Printed/typed)

**Kristen Holder**Title **Regulatory Analyst**

Signature

*Kristen Holder*Date **08/28/2008**

## THIS SPACE FOR FEDERAL OR STATE OFFICE USE

Approved by <b>Original Signed: Stephen Mason</b>	Title	Date <b>AUG 29 2008</b>
Conditions of approval, if any, are attached. Approval of this notice does not warrant or certify that the applicant holds legal or equitable title to those rights in the subject lease which would entitle the applicant to conduct operations thereon.	Office	

Title 18 U.S.C. Section 1001 and Title 43 U.S.C. Section 1212, make it a crime for any person knowingly and willfully to make to any department or agency of the United States any false, fictitious or fraudulent statements or representations as to any matter within its jurisdiction.

NMOCD



District I

1625 N French Dr., Hobbs, NM 88240  
Phone: (505) 393-6161 Fax: (505) 393-0720

District II

1301 W Grand Ave., Artesia, NM 88210  
Phone: (505) 748-1283 Fax: (505) 748-9720

District III

1000 Rio Brazos Rd., Aztec, NM 87410  
Phone: (505) 334-6178 Fax: (505) 334-6170

District IV

1220 S St Francis Dr., Santa Fe, NM 87505  
Phone: (505) 476-3470 Fax: (505) 476-3462

**State of New Mexico**  
**Energy, Minerals and Natural Resources**

**Oil Conservation Division**

**1220 S. St Francis Dr.**

**Santa Fe, NM 87505**

Form C-102  
Permit 61102

**WELL LOCATION AND ACREAGE DEDICATION PLAT**

1 API Number <b>30045 1188</b>	2 Pool Code <b>82329</b>	3 Pool Name <b>OTERO CHACRA (GAS)</b>
4 Property Code <b>431</b>	5 Property Name <b>DRYDEN</b>	6 Well No <b>001</b>
7 OGRID No <b>778</b>	8 Operator Name <b>BP AMERICA PRODUCTION COMPANY</b>	9 Elevation <b>5813</b>

**10. Surface Location**

UL - Lot <b>M</b>	Section <b>28</b>	Township <b>28N</b>	Range <b>08W</b>	Lot Idn	Feet From <b>790</b>	N/S Line <b>S</b>	Feet From <b>1190</b>	E/W Line <b>W</b>	County <b>SAN JUAN</b>
----------------------	----------------------	------------------------	---------------------	---------	-------------------------	----------------------	--------------------------	----------------------	---------------------------

**11. Bottom Hole Location If Different From Surface**

UL - Lot	Section	Township	Range	Lot Idn	Feet From	N/S Line	Feet From	E/W Line	County
12 Dedicated Acres <b>160.00</b>	13. Joint or Infill	14 Consolidation Code	15 Order No						

**NO ALLOWABLE WILL BE ASSIGNED TO THIS COMPLETION UNTIL ALL INTERESTS HAVE BEEN CONSOLIDATED OR A NON-STANDARD UNIT HAS BEEN APPROVED BY THE DIVISION**

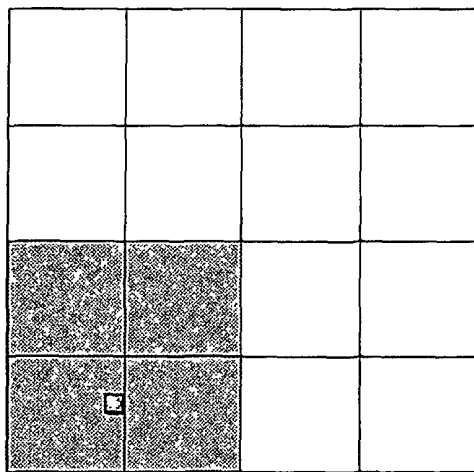

**OPERATOR CERTIFICATION**

*I hereby certify that the information contained herein is true and complete to the best of my knowledge and belief, and that this organization either owns a working interest or unleased mineral interest in the land including the proposed bottom hole location(s) or has a right to drill this well at this location pursuant to a contract with an owner of such a mineral or working interest, or to a voluntary pooling agreement or a compulsory pooling order heretofore entered by the division*

E-Signed By: *Kristin Holder*  
Title: *Regulatory Analyst*  
Date: *07/08/2008*

**SURVEYOR CERTIFICATION**

*I hereby certify that the well location shown on this plat was plotted from field notes of actual surveys made by me or under my supervision, and that the same is true and correct to the best of my belief.*

Surveyed By: **Robert Ernst**  
Date of Survey: **9/19/1966**  
Certificate Number: **2463**

District I

1625 N French Dr , Hobbs, NM 88240  
Phone.(505) 393-6161 Fax (505) 393-0720

District II

1301 W Grand Ave., Artesia, NM 88210  
Phone (505) 748-1283 Fax (505) 748-9720

District III

1000 Rio Brazos Rd , Aztec, NM 87410  
Phone (505) 334-6178 Fax (505) 334-6170

District IV

1220 S St Francis Dr . Santa Fe, NM 87505  
Phone.(505) 476-3470 Fax (505) 476-3462

**State of New Mexico**  
**Energy, Minerals and Natural Resources**  
**Oil Conservation Division**  
**1220 S. St Francis Dr.**  
**Santa Fe, NM 87505**

Form C-102  
Permit 61102

**WELL LOCATION AND ACREAGE DEDICATION PLAT**

1 API Number <b>3004511881</b>	2 Pool Code 72319	3 Pool Name BLANCO-MESAVERDE (PRORATED GAS)
4 Property Code 431	5. Property Name DRYDEN	6 Well No 001
7. OGRID No 778	8 Operator Name BP AMERICA PRODUCTION COMPANY	9 Elevation 5813

**10. Surface Location**

UL - Lot M	Section 28	Township 28N	Range 08W	Lot Idn	Feet From 790	N/S Line S	Feet From 1190	E/W Line W	County SAN JUAN
---------------	---------------	-----------------	--------------	---------	------------------	---------------	-------------------	---------------	--------------------

**11. Bottom Hole Location If Different From Surface**

UL - Lot	Section	Township	Range	Lot Idn	Feet From	N/S Line	Feet From	E/W Line	County
12 Dedicated Acres 320.00	13 Joint or Infill	14 Consolidation Code	15 Order No						

**NO ALLOWABLE WILL BE ASSIGNED TO THIS COMPLETION UNTIL ALL INTERESTS HAVE BEEN CONSOLIDATED OR A NON-STANDARD UNIT HAS BEEN APPROVED BY THE DIVISION**

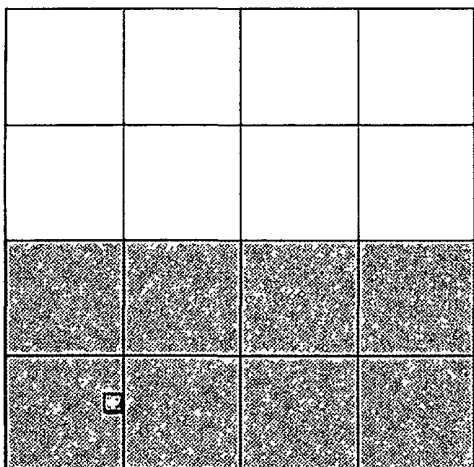
	<p style="text-align: center;"><b>OPERATOR CERTIFICATION</b></p> <p><i>I hereby certify that the information contained herein is true and complete to the best of my knowledge and belief, and that this organization either owns a working interest or unleased mineral interest in the land including the proposed bottom hole location(s) or has a right to drill this well at this location pursuant to a contract with an owner of such a mineral or working interest, or to a voluntary pooling agreement or a compulsory pooling order heretofore entered by the division.</i></p> <p>E-Signed By: <i>Kristen Bolder</i> Title: <i>Regulatory Analyst</i> Date: <i>7/08/2008</i></p> <hr/> <p style="text-align: center;"><b>SURVEYOR CERTIFICATION</b></p> <p><i>I hereby certify that the well location shown on this plat was plotted from field notes of actual surveys made by me or under my supervision, and that the same is true and correct to the best of my belief.</i></p> <p>Surveyed By: Robert Ernst Date of Survey: 9/19/1966 Certificate Number: 2463</p>
---	--

30-045-11881

# NEW MEXICO OIL CONSERVATION COMMISSION WELL LOCATION AND ACERAGE DEDICATION PLAT

All distances must be from the outer boundaries of the Section

Operator <b>TEXACO OIL COMPANY</b>		Lease <b>DRYDEN</b>		Well No <b>1</b>	
Unit Letter <b>M</b>	Section <b>28</b>	Township <b>28 North</b>	Range <b>8 West</b>	County <b>San Juan</b>	
Actual Footage Location of Well.					
<b>790</b> feet from the <b>South</b> line and <b>1190</b> feet from the <b>West</b> line					
Ground Level Elev. <b>5813' ungraded</b>	Producing Formation <b>San Juan</b>	Pool <b>San Juan</b>	Dedicated Average <b>20 4/5</b>		Acres

- Outline the acreage dedicated to the subject well by colored pencil or hatchure marks on the plat below.
- If more than one lease is dedicated to the well, outline each and identify the ownership thereof (both as to working interest and royalty).
- If more than one lease of different ownership is dedicated to the well, have the interests of all owners been consolidated by communitization, unitization, force-pooling etc?

( ) Yes ( ) No If answer is "yes," type of consolidation .....

If answer is "no," list the owners and tract descriptions which have actually consolidated (Use reverse side of this Form if necessary.) .....

No allowable will be assigned to the well until all interests have been consolidated (by communitization, unitization, forced-pooling, or otherwise) or until a non standard unit, eliminating such interests, has been approved by the Commission

## CERTIFICATION

I hereby certify that the information contained herein is true and complete to the best of my knowledge and belief.

*Harold C. Nichols*  
Name **Harold C. Nichols**  
Position **Senior Production Clerk**  
Company **Texaco Oil Company**  
Date **October 13, 1966**

I hereby certify that the well location shown on this plat was plotted from field notes of actual surveys made by me or under my supervision, and that the same is true and correct to the best of my knowledge and belief.

19 September 1966

Date Surveyed  
*Robert H. Ernst*  
Registered Professional Engineer and/or Land Surveyor  
**Robert H. Ernst**  
**N. Mex. No. 2463**  
Certificate No

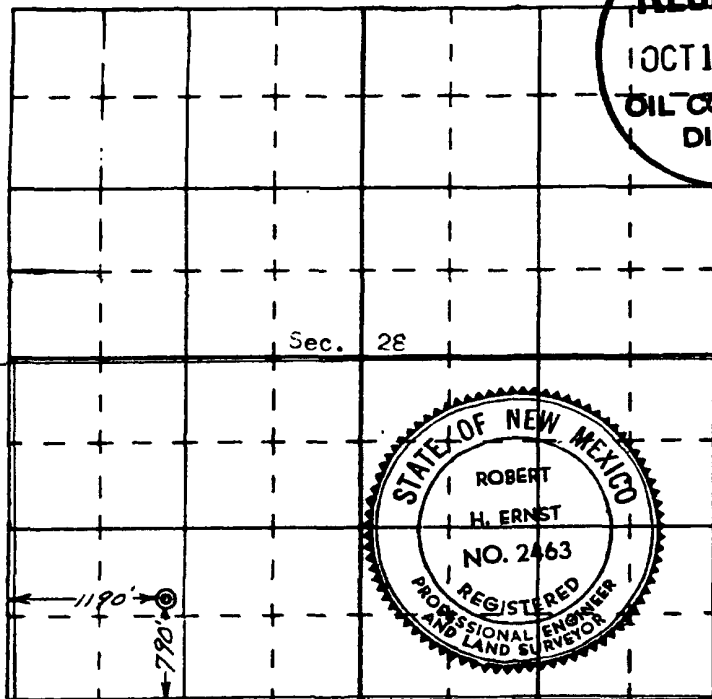

ERNST ENGINEERING CO.  
DURANGO, COLORADO

SI 080112

**BLM Procedure  
Dryden #1  
30-045-11881**

<b>Date:</b>	<b>July 8, 2008</b>	
<b>Work:</b>	<b>Horizon add CH &amp; MV</b>	<b>Engr: Richard W. Pomrenke</b>
<b>Location:</b>	<b>Sec 28, T28N, R8W</b>	<b>Office: 281-366-5023</b>
		<b>Cell: 281-455-8449</b>

**Objective of Work:**

The Dryden #1 will be a replacement well for the Dryden LS #1 in the Point Lookout/Mesa Verde with Chacra Payadd and downhole commingle with Dakota, Point Lookout and Chacra.

1. Complete well in Point Lookout 4400'-4550' Down the casing frac at 50-60 bpm 125,000# sand for Point Lookout.
2. Run CBL and necessary remedial cement work as required for Chacra Completion.
3. Perforate Chacra 3100-3275' and fracture treat with 200,000# down casing frac. Flow back and test Chacra and then clean out bridge plugs to Dakota perforations and trimingle well, DK, Point Lookout, Chacra.

Approval is contingent on Shut In and plugging of Dryden LS #1 321' away producing 50 MCFD from PNLK at 4400'.

**Simplified Work Procedure:**

1. Check anchors. MIRU workover rig.
2. If necessary, kill with 2% KCL water. Nipple down WH. NU BOPs.
3. Tag for fill and tally OH with 2-3/8" production tubing currently set at 6670'. Visually inspect tubing while POOH.
4. TIH with bit and scraper for 4 1/2" casing to 4900'.
5. TIH with tubing-set RBP. Set RBP at 4900'. Dump 20' of sand on RBP and load hole with 2% KCL and test casing to 3000 psi.
6. Run CBL and RST log up to 2000'. Note: DV Tool at 2325' and bottom of 7 5/8" at 2387'. See wellbore diagram.
7. Depending on bonding across and above the Chacra 3100'-3275'. Remedial cement will be designed.
8. Perforate using 3-1/8" casing guns loaded with HEG charges Point Lookout 4400'-4550'. Note: Depths and SPF will be adjusted after review of RST Log..

9. RU frac equipment. Use Slick Water 2% KCL Water 125,000# sand 45Q-N2 foam in fracture stimulation.
10. Frac Point Lookout according to pump schedule down casing with wellhead isolation tool installed. Leave well shut-in overnight.
11. Flow back frac.
12. TIH with tubing and notched collar. Cleanout fill to RBP. Blow well dry.
13. Test Point Lookout for 8 hours.
14. Wash out sand to RBP and recover at 4900'.
15. Set RBP at 4000' and dump 20' sand on RBP.
16. Perforate using 3-1/8" casing guns loaded with HEG charges Point Lookout 3100'-3275'.  
Note: Depths and SPF will be adjusted after review of RST Log.
17. RU frac equipment. Use Slick Water 2% KCL Water 200,000# sand 45Q-N2 foam in fracture stimulation.
18. Frac Chacra according to pump schedule down casing with wellhead isolation tool installed. Leave well shut-in overnight.
19. Flow back frac.
20. TIH with tubing and notched collar. Cleanout fill to RBP. Blow well dry.
21. Test Chacra for 8 hours.
22. Wash out sand to RBP and recover at 4000'.
23. Clean out well to PBTD 6690'
24. Run 2 3/8" completion tubing at 6670'
25. ND BOP's. NU WH. Test well for air. Return well to production. as down hole commingle Dakota, Mesa Verde/ Point Lookout and Chacra completion.

# Dryden #1

Sec 28, T28N, R8W  
API 30-045-74120000  
Completed 10/23/66

5824' GL

## History

Completed in 10/66

est TOC @ surface (circ)

10 3/4" 32# @ 335'  
375 sxs Cmt

Perf @ 1150' and pumped cement to surface

TOC @ 1210 CBL in 1991

Installed new 4 1/2" casing 10 5# in 1991 0-2325'

DV - Tool @ 2325' installed in 1991  
when 4 1/2" was backed off and reinstalled  
Pumped cement to surface 4 1/2" x 7 5/8" annulus

7 5/8" 26.4# @ 2387'  
Cmt w/260 sxs

6 1/4" drilled hole

Chacra 3100'-3275'

Calculated Top Cement 2 nd Stage 3167'

Mesa Verde/Point Lookout 4400'-4550'

DV - Tool @ 5009'  
2 nd Stage Cement 150 Sx  
Calculated Top Cement 1 st Stage 5500'

## Dakota Perf Detail

6540' - 6546'	1 HPF
6614' - 6618'	1 HPF
6638' - 6644'	1 HPF
6654' - 6656'	1 HPF
6672' - 6682'	1 HPF

## Dakota Perforations

6540' - 6682'  
1966

2 3/8" @ 6670' Est  
4 1/2" 10 5 & 11 6# set @ 6722'  
Cement 1 st Stage 100 sxs

TD 6722'  
PBTID 6690'

6-10-2008 Richard Pomrenke



20-045-11881

Dryden #1

True-Mingle Notif. Call on  
8/8/08

AMELIA ANNE SUNDBERG  
1915 BROWN SCHOOL CT  
RICHMOND, TX 77469

ANNA REBECCA WARD OELKRUG  
15402 STONEHILL DRIVE  
HOUSTON, TX 77062

ATKO PARTNERS LTD  
DR B J ATKINS MD  
260 I-45 S, SUITE A  
HUNTSVILLE, TX 77340

BARBARA A BRYANT 2003 GRANT TRUST  
BARBARA A BRYANT TRUSTEE  
143 POP CASTLE ROAD  
WHITE STONE, VA 22578

BARBARA REESE DINGES  
508 IRONWOOD FOREST DR  
RICHMOND, TX 77469

BETSY BRYANT  
2201 BROOKHOLLOW  
ABILENE, TX 79605-5507

BETTY RAY DAVIS  
PO BOX 871  
MIDLAND, TX 79702

BETTY WEST STEDMAN  
ATTN LOCK BOX  
PO BOX 1349  
HOUSTON, TX 77251-1349

BONANZA CREEK MINERALS LLC  
ATTN: RICHARD HUGHES MANAGER  
2321 CANDELARIA NW  
ALBUQUERQUE, NM 87107

BRIAN D GIBSON  
66 C ARROYO HONDO TRAIL  
SANTA FE, NM 87508

CAROLYN DAVANT FRICKE  
113 BOWIE ST  
PORT LAVACA, TX 77979-2606

CATHARINE GRAY REMENICK  
JPMORGAN CHASE BANK  
PO BOX 99084  
FORT WORTH, TX 76199-0084

CHARLES B EDMIASTON  
PO BOX 178  
JUSTICEBURG, TX 79330

CHARLES RUSSELL BELL  
2400 OLD SOUTH DR # 501  
RICHMOND, TX 77469

CLAUD W RAYBOURN  
16260 MONACHE CT  
APPLE VALLEY, CA 92307-1465

CLAUDIA MARCIA LUNDELL GILMER  
1102 S AUSTIN AVE # 110-371  
GEORGETOWN, TX 78628

COOKSEY FAMILY TRUST  
ROBERT A COOKSEY TRUSTEE  
4925 GREENVILLE - BOX 92  
DALLAS, TX 75206

CORNELIA DAVANT PERRY  
PO BOX 206  
BLESSING, TX 77419-0206

CREPS HARNED KUYKENDALL FAMILY TR  
ELIZABETH R HARNED TRUSTEE  
523 MARSHALL DRIVE  
WEST CHESTER, PA 19380

CYNTHIA GRAY MILANI ESTATE  
JPMORGAN CHASE BANK  
PO BOX 99084  
FORT WORTH, TX 76199-0084

DAVID ELBERT REESE  
2203 N BELMONT  
RICHMOND, TX 77469-5501

DAVID H GRAY AGENCY  
JPMORGAN CHASE BANK  
PO BOX 99084  
FORT WORTH, TX 76199-0084

DAVID HENDERSON  
PO BOX 2090  
HOLLYWOOD, CA 90078-2090

DEAN C KENYON  
1009 HEATHERFIELD AVE  
ROSAMOND, CA 93560

DICK HOLLAND  
P O BOX 2926  
MIDLAND, TX 79702

DONALD ERWIN HERROLD REV TRUST  
DONALD ERWIN HERROLD TRUSTEE  
8677 E 104 PL S  
TULSA, OK 74133

DOROTHY B HUGHES, REV LIVING TR  
SUZY SARNA SUCCESSOR TRUSTEE  
U/T DATED 05-17-1991  
303 MISTY CREEK LN  
PORT ANGELES, WA 98363-9762

DORTHY M TUCKER, ESTATE  
BRAD TUCKER EXECUTOR  
PO BOX 2822  
HOUSTON, TX 77252-2822

DOUGLAS E ATWILL  
604B CANYON RD  
SANTA FE, NM 87501-2722

E HUNTER STONE , II TRUST  
PO BOX 61419  
DENVER, CO 80206-8419

EDWARD AND JACQUELINE WINTERER  
REVOCABLE TRUST NO 1 DTD 12-4-91  
EDWARD & D JACQUELINE WINTERER  
TRSTE  
289 OCEAN VIEW  
DEL MAR, CA 92014-3321

EDWARD R ATWILL  
PO BOX 1551  
TUBAC, AZ 85646-1551

ELIZABETH GOODWIN REESE  
7800 NAIRN  
HOUSTON, TX 77074-5321

ELIZABETH H WHITE , FAMILY TRUST  
LINDA PAYNE, TRUSTEE  
PO BOX 780099  
DALLAS, TX 75378-0099

ELIZABETH TURNER CALLOWAY  
PO BOX 191767  
DALLAS, TX 75219-1767

ELLIOTT HALL COMPANY  
PO BOX 1231  
OGDEN, UT 84402-1231

ELLIOTT MGMT COMPANY PENSION PLAN  
STEPHEN L ELLIOTT TRSTEE  
PO BOX 3300  
ROSWELL, NM 88202-1355

ELSR LP  
EVERETT R JONES JR GEN PARTNER  
PO BOX  
DALLAS, TX 75206

EMILY B HUGHES  
PO BOX 1497  
RATON, NM 87740-1497

EUGENIA DAVANT WILSON  
561 CASS ST  
SULPHUR, LA 70663-1015

FRED E OR JANE B SPENCER  
JOINT TENANTS WROS  
10717 CRYSTAL CREEK DRIVE  
MUSTANG, OK 73064-9382

FRED E TURNER  
ONE ENERGY SQUARE  
4925 GREENVILLE AVE STE 852  
DALLAS, TX 75206-4079

GIBSON FAMILY TRUST  
JAFFA D WAHLBERT &  
GEORGE ANNE SCHARHAG CO-TRUSTEES  
P O BOX 546  
TESUQUE, NM 87574

GLADYS WATFORD , TRUST  
ANNE V POGSON, SUCCESSOR TSTE  
12112 TALMAY DR  
DALLAS, TX 75230

GLENN HEINTSCHEL  
6227 W STATE HIGHWAY 159  
FAYETTEVILLE, TX 78940-5344

GLORIA SPENCER KUBIK  
3814 WHIPPOORWILL LANE  
ENID, OK 73703

GROVER FAMILY L P  
PO BOX 3666  
MIDLAND, TX 79702-3666

GURDON RANSON MILLER III  
704 CANYON CREST  
SIERRA MADRE, CA 91024

GUY DAVID WARD  
6022 CHICKADEE CIRCLE  
SPRING HILL, TN 37174

H LIMITED PARTNERSHIP  
PO BOX 2185  
SANTA FE, NM 87504-2185

HANSON MCBRIDE PETROLEUM COMPANY  
PO BOX 1515  
ROSWELL, NM 88202-1515

HAROLD D CARTER TRUSTEE  
5949 SHERRY LN STE 1475  
DALLAS, TX 75225

HARRIET M BUCHENAU , LIVING TRUST  
U/A/DATED 8-30-1994  
HARRIET M BUCHENAU TRUSTEE  
PO BOX 867585  
PLANO, TX 75086-7585

HARRY D PORTER , REVOCABLE TRUST  
BANK OF AMERICA NA TRUSTEE  
PO BOX 840738  
DALLAS, TX 75284-0738

ICON PETROLEUM INC  
1411 W ILLINOIS AVE  
MIDLAND, TX 79701

INACTIVE OWNER  
PO BOX 19036  
DOVER, DE 19901

J GLENN TURNER , JR  
TWO TURTLE CREEK VILLAGE  
3838 OAK LAWN STE 1450  
DALLAS, TX 75219

JAMES E DAVANT , DVM  
PO BOX 695  
BLESSING, TX 77419-0695

JAMES H ATWILL  
PO BOX 1810  
PORT ARANSAS, TX 78373-1810

30-095-11881 Dryden  
JAMES H ESSMAN  
PO BOX 302  
MIDLAND, TX 79702-0302

JAMES R LEETON JR  
SAN JUAN ROYALTY JV-90 ACCOUNT  
PO BOX 10561  
MIDLAND, TX 79702

JAMES WENDELL WEST  
PO BOX 492382  
LOS ANGELES, CA 90049-8382

JANICE P CAMPBELL  
PO BOX 2033  
MIDLAND, TX 79702-2033

JEAN ASHLEY WARD CARTER  
14622 UNDERWOOD CREEK WAY  
HOUSTON, TX 77062

JEREMY S DAVIS  
7539 BROMPTON BLVD  
HOUSTON, TX 77025-2267

JESSE S RAYBOURN  
207 WILSHIRE LN  
NEWARK, DE 19711

JESSICA JONES STANLEY  
13121 DELPHINUS WALK  
AUSTIN, TX 78732

JOHN HUNTER JONES  
3211 PARK HILLS  
AUSTIN, TX 78746

JOHN L GRAY AGENCY  
JPMORGAN CHASE BANK  
PO BOX 99084  
FORT WORTH, TX 76199-0084

JOHN L TURNER  
PMB 285  
317 SIDNEY BAKER SOUTH #400  
KERRVILLE, TX 78028

KATHRYN DAVANT DODSON  
111 MCGUIRE COVE  
CLARKSDALE, MS 38614-9708

KATHRYN DAVANT HIGGINS  
111 CABANA DR  
VICTORIA, TX 77901

KENNEDY MINERALS LTD  
500 W TEXAS, SUITE 655  
MIDLAND, TX 79701

KENYON 1994 FAMILY TRUST  
DAVID G AND KAREN L KENYON TRUSTEES  
7200 REDWOOD BLVD #404  
NOVATO, CA 94945

KEVIN K LEONARD  
PO BOX 50688  
MIDLAND, TX 79710

L DORIS WILLIAMS TRUST  
JOHN G HEARD & JANE M CAROLUS  
CO INDEPENDENT TRUSTEES  
PO BOX 20606  
HOUSTON, TX 77225-0606

LARRY AND RUTH GEILENFELDT  
32090 BAYBERRY ROAD  
WILDOMAR, CA 92595

LAURA A GUNN  
13408 VISTA DEL PRADO  
SAN ANTONIO, TX 78216-2227

LELAND PRICE INC  
1511 NORTHGATE PL  
ARTESIA, NM 88210

LILLIE SPENCER NEWKIRK  
218 WEST HILLCREST AVENUE  
INDIANOLA, IA 50125-3708

LINDA JEANNE LUNDELL LINDSEY  
PO BOX 631565  
NACOGDOCHES, TX 75963

LINDSAY PROD AND ROYALTIES LTD  
112 E PECAN SUITE 500  
SAN ANTONIO, TX 78205

LLOYD J AND RUTH R MONEY 1990 TR  
DATED 10-9-90  
LLOYD J AND RUTH R MONEY TRUSTEES  
3939 WALNUT AVE # 307  
CARMICHAEL, CA 95608

M ROBERT THOMPSON REVOCABLE TRUST  
M ROBERT & JEANNE L THOMPSON TTEES  
U/A DATED APRIL 26 1994  
15 IVY ST  
DENVER, CO 80220

MABEL GLENN HAM , REVOCABLE TRUST  
KATHLYN NORA BLACK TRUSTEE  
PO BOX 15040  
SANTA FE, NM 87592

MADGE SPENCER GREEAR  
FRED E SPENCER AND JANE B SPENCER  
JOINT TENANTS WROS  
7 E JANICE 202  
YUKON, OK 73099

MARGARET A KEARNS , TRUST  
JAMES B DRAPER TRUSTEE  
F/B/O JAMES B DRAPER  
77 S BIRCH RD APT #8D  
FORT LAUDERDALE, FL 33316-1556

MARGARET A KEARNS , TRUST  
U/A F/B/O HELENE D GORMAN  
HELENE D GORMAN TRUSTEE  
1440 OSPREY AVE  
NAPLES, FL 34102-3464

MARIAN N HARWELL  
112 E PECAN STE 500  
SAN ANTONIO, TX 78205-1516

MARK L KENYON  
7200 REDWOOD BLVD SUITE 404  
NOVATO, CA 94945

MARY ANNE HOWARD  
438 FOX BRIAR  
SUGAR LAND, TX 77478-3717

MARY KATHERYN DUNNAM LADEWIG  
1373 WOODBROOK LANE  
SOUTHLAKE, TX 76092

MARY LOUISE HERROLD REV TRUST  
MARY LOUISE HERROLD TRUSTEE  
8677 E 104 PL S  
TULSA, OK 74133

MINERALS MANAGEMENT SERVICE  
PO BOX 5810 TA  
DENVER, CO 80217-5810

MITZI EASLEY  
1203 ARRONIMIMK CIRCLE  
AUSTIN, TX 78746

NANCY JANE SPENCER  
502 EVERGREEN DR  
REEDSPORT, OR 97467

NEAL S WATERFALL , FAMILY TRUST  
NEAL S WATERFALL TRUSTEE  
14438 NE 16TH PL  
BELLEVUE, WA 98007-3904

NINETY SIX CORPORATION  
500 WEST TEXAS SUITE 655  
MIDLAND, TX 79701

NORDAN TRUST  
LOUIS BELINSKY TRUSTEE  
112 E PECAN STE 500  
SAN ANTONIO, TX 78205-1516

NORTHSTAR PRODUCTION AND LAND LLC  
RUSSELL B BUCHANAN  
PO BOX 2454  
MIDLAND, TX 79702-2454

PAMELA GRAY BALDWIN  
JPMORGAN CHASE BANK  
PO BOX 99084  
FORT WORTH, TX 76199-0084

PAUL DAVIS , LTD  
PO BOX 871  
MIDLAND, TX 79702

PAUL SLAYTON  
PO BOX 2035  
ROSWELL, NM 88202-2035

PRIMITIVE PETROLEUM INC  
4514 ROBIN LANE  
MIDLAND, TX 79707

R E BEAMON III  
2603 AUGUSTA STE 1050  
HOUSTON, TX 77057-5640

RICHARD A GROENENDYKE , JR  
2545 E 30TH ST  
TULSA, OK 74114

ROBERT L BAYLESS PRODUCER LLC  
PO BOX 461002  
DENVER, CO 80246

ROBERT WALTER LUNDELL  
2450 FONDREN #304  
HOUSTON, TX 77063-2306

RUGELEY TRUST  
3813 TOLMAS DRIVE  
METAIRIE, LA 70002

SALLY ANN MAHAFFEY  
P O BOX 680244  
HOUSTON, TX 77268

SANDRA T CURRIE  
PO BOX 949  
HEMPSTEAD, TX 77445

SARAH S MIMS , TRUST  
WILLIAM L MADSEN AND SARAH S MIMS  
COTRUSTEES  
PO BOX 111846  
CARROLLTON, TX 75011-1846

SHERRI HULT HEINTSCHEL  
6227 W STATE HIGHWAY 159  
FAYETTEVILLE, TX 78940-5344

STOREY LINCOLN PARTNERSHIP  
21205 5TH AVE S  
DES MOINES, WA 98198

SUSAN FRY BRACKEN  
PO BOX 7550  
TYLER, TX 75711-7550

SUSAN RITTER  
4700 VIA MEDIA  
AUSTIN, TX 78746

THOMAS E DUNNAM , III  
14618 REIGH COUNT ST  
SAN ANTONIO, TX 78248-1139

THOMPSON FAMILY LLC  
SHERRY THOMPSON MILLER MNGR  
1370 TESUQUE CREEK ROAD  
SANTA FE, NM 87501

TIMOTHY WINSTON WARD  
6906 FALCON CREST LANE  
SACHSE, TX 75048

VALORIE HUNDLEY  
7402 SYDNEY STREET  
CORPUS CHRISTI, TX 78414

WATERS S DAVIS III  
JPMORGAN CHASE BANK  
PO BOX 99084  
FORT WORTH, TX 76199-0084

WESLEY WEST , MINERALS LTD  
FROST NATIONAL BANK  
LOCK BOX DEPARTMENT  
PO BOX 1141  
HOUSTON, TX 77251-1141

WILLIAM LOUIS DAVANT  
PO BOX 214  
BLESSING, TX 77419

WILLIAM R ARCHER JR 2003 GNT TRST  
WILLIAM R ARCHER JR TRUSTEE  
3021 NORTH EDISON ST  
ARLINGTON, VA 22207

WILLIAM W AND JULIANNE BRAMLETT  
1776 WOODSTEAD COURT SUITE 205  
SPRING, TX 77380

XTO ENERGY INC  
PO BOX 730586  
DALLAS, TX 75373-0586