

District I
1625 N. French Dr., Hobbs, NM 88240
District II
1301 W. Grand Avenue, Artesia, NM 88210
District III
1000 Rio Brazos Road, Aztec, NM 87410
District IV
1220 S. St. Francis Dr., Santa Fe, NM 87505

State of New Mexico
Energy Minerals and Natural Resources

Oil Conservation Division
1220 South St. Francis Dr.
Santa Fe, NM 87505

OK
Bedrock
Submit 1 copy to
appropriate
District Office
and 1 copy to
the Santa Fe Office

(Revised 3/9/94)

PIT REMEDIATION AND CLOSURE REPORT

30-045-09228
Operator: Meridian (Site Closed by El Paso Field Services)

Telephone: _____

Address: _____

Facility Or: Mansfield #6, Meter 73397

Well Name _____

Location: Unit or Qtr/Qtr Sec C Sec 29 T 30 R 9 County San Juan

Pit Type: Separator _____ Dehydrator _____ Other Drip

Land Type: BLM X, State _____, Fee _____ Other _____

Pit Location: Pit dimensions: length 12', width 10', depth 2'
(Attach diagram)

Reference: wellhead X, other _____

Footage from reference: 88'

Direction from reference: 260 Degrees X East North _____
of _____ West South _____

Depth To Ground Water	Less than 50 feet	(20 points)
(Vertical distance from	50 feet to 99 feet	(10 points)
contaminants to seasonal	Greater than 100 feet	(0 points) <u>10</u>
high water elevation of		
ground water.)		

Wellhead Protection Area:	Yes (20 points)
(Less than 200 feet from a private	No (0 points) <u>0</u>
domestic water source, or; less than	
1000 feet from all other water sources.)	

Distance To Surface Water:	Less than 200 feet	(20 points)
(Horizontal distance to perennial	200 feet to 1000 feet	(10 points)
lakes, ponds, rivers, streams, creeks,	Greater than 1000 feet	(0 points) <u>0</u>
irrigation canals and ditches.)		

RANKING SCORE (TOTAL POINTS): 10

Date Remediation Started: 05/06/94 Date completed: 05/06/94

Remediation Method: Excavation X Approx. cubic yards 50
(Check all appropriate sections.) Landfarmed _____ Insitu Bioremediation _____
Other _____

Remediation Location: Onsite _____ Offsite Tierra
(i.e. landfarmed onsite, name and location of offsite facility)

General Description of Remedial Action: Pit was contaminated. Excavation went to 9' where hard layer of rock started.
At this depth PID reading was taken. Closed pit.

Ground Water Encountered: No X Yes _____ Depth _____

Final Pit:
Closure Sampling:
(if multiple samples,
attach sample results
and diagram of sample
locations and depths)

Sample location Four walls and center of pit composite

Sample depth 9'

Sample Date 05/06/94 Sample time 14:20

Sample Results

Benzene(ppm) <0.50

Total BTEX(ppm) 39

Field headspace(ppm) 483

TPH 3060

Ground Water Sample: Yes _____ No X (If yes, attach sample results)

I hereby certify that the information above is true and complete to the best of my knowledge and belief.

Date 4/23/03

Signature

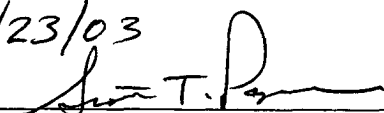

Printed Name
and Title

Scott Pope, Senior Environmental Scientist



PIT CLOSURE REQUEST

Mansfield #6
Meter/Line ID 73397

SITE DETAILS

Legals - Twn: 30N	Rng: 9W	Sec: 29	Unit: C
NMOCD Hazard Ranking: 10		Land Type: BLM	
Operator: Amoco Production Company		Pit Closure Date: 5/6/94	

RATIONALE FOR RISK-BASED CLOSURE

The pit noted above was assessed and ranked according to the criteria in the New Mexico Oil Conservation Division's (NMOCD) Unlined Surface Impoundment Closure Guidelines.

A test pit was excavated to 9 feet (ft) below ground surface (bgs) where a hard layer of rock was encountered and a soil sample was collected for field headspace and laboratory analysis for TPH and BTEX. Groundwater was not encountered in the test pit. Headspace analysis indicated an organic vapor content of 483 ppm; laboratory analysis indicated a benzene concentration of <0.50 mg/kg, a total BTEX concentration of 39 mg/kg, and a TPH concentration of 3,060 mg/kg. The TPH measurement exceeded recommended remediation levels for the Hazard Ranking Score of 10.

Approximately 50 cubic yards of soil were excavated and hauled to Tierra, a commercial landfarm, for treatment and disposal. The pit was backfilled with clean soil and graded in a manner to direct surface runoff away from the pit area.

A Phase II boring was completed with refusal at 27 ft bgs. No groundwater was encountered in the soil boring. One laboratory sample was collected at 25-27 ft bgs. Headspace analysis indicated an organic vapor content of 329 ppm; laboratory analysis indicated a benzene concentration of 0.083 mg/kg, a total BTEX concentration of 2.07 mg/kg, and a TPH concentration of 392 mg/kg. The benzene, total BTEX, and TPH concentrations were below recommended remediation levels for the Hazard Ranking Score of 10.

No Phase III activities were conducted.

El Paso Field Services requests closure of the above-mentioned pit location for the following reasons:

- The primary source, discharge to the pit, has been removed for over 8 years.
- The impacted soil was excavated to the practical extent of the equipment and subsurface conditions. All excavated soil was disposed of offsite.
- The test pit was backfilled and the former pit area graded to direct surface runoff away from the former pit.
- Backfilling the pit with clean soil eliminated the potential for direct contact with hazardous constituents by livestock or the public; i.e., direct contact exposure pathways are incomplete.
- Groundwater was not encountered in the soil boring at 27 ft bgs; local geologic features indicate the depth to groundwater is greater than 50 ft bgs.



PIT CLOSURE REQUEST

- There are no water supply wells or other sources of fresh water extraction within 1,000 feet of the site.
- Benzene and total BTEX concentrations at the base of the test pit (9 feet bgs) and at the base of the Phase II soil boring (27 feet bgs) were below recommended remediation levels for the Hazard Ranking Score.
- TPH concentrations in the soil at 27 ft bgs were about 11% of the concentration at 12 ft bgs, and were below the recommended remediation levels for this site. This strong attenuation with depth indicates that residual hydrocarbons will degrade by natural attenuation with minimal risk to the environment.

ATTACHMENTS

Field Pit Assessment Form

Revised Field Pit Assessment Form

Field Pit Remediation/Closure Form

Phase II Soil Boring Log

Laboratory Analytical Results

REVISED
FIELD PIT SITE ASSESSMENT FORM

GENERAL

Meter: 73997 Location: MANSFIELD #6
Operator #: 2999 Operator Name: MERIDIAN P/L District: BLUMEFIELD
Coordinates: Letter C Section 29 Township: 30 Range: 9
or Latitude _____ Longitude _____
Pit Type: Dehydrator _____ Location Drip: X Line Drip: _____ Other: _____
Site Assessment Date: 4-14-94 Area: 10 Run: 83
Revised Date: 1-24-03

SITE ASSESSMENT

NMOCD Zone:

(from NMCOD Maps)

Land Type:

BLM ☒ (1)

State ☐ (2)

Fee ☐ (3)

Indian _____

Inside ☒ (1)

Outside ☐ (2)

Depth to Groundwater

Less than 50 Feet (20 points) ☐ (1)

50 Feet to 99 Feet (10 Points) ☒ (2)

Greater than 100 Feet (0 Points) ☐ (3)

Well Protection Area

Is it less than 1000 feet from well, spring or other source of fresh water extraction?
or; Is it less than 200 feet from a private domestic water source?

☐ YES (20 Points)

☒ NO (0 Points)

Horizontal Distance to Surface Water Body

Less than 200 Feet (20 points) ☐ (1)

200 Feet to 1000 Feet (10 Points) ☐ (2)

Greater than 1000 Feet (0 Points) ☒ (3)

Name of Surface Water Body PEMADA CANYON

(Surface Water Body: Perennial River, Stream, Creek, Irrigation Canal, Ditch, Lake, Pond)

Distance to Nearest Ephemeral Stream ☐ (1) < 100 feet (Navajo Pits Only)

☐ (2) > 100 feet

TOTAL HAZARD RANKING SCORE 10 **POINTS**

REMARKS

Remarks: REVISION BASED ON REASSESSMENT OF THE DEPTH TO
GROUNDWATER AND THE HORIZONTAL DISTANCE TO SURFACE
WATER BODY.

FIELD PIT SITE ASSESSMENT FORM

GENERAL

Meter: 73392 Location: MANSFIELD #6
 Operator #: 2999 Operator Name: MERIDIAN P/L District: BLOOMFIELD
 Coordinates: Letter: C Section 29 Township: 30 Range: 9
 Or Latitude _____ Longitude _____
 Pit Type: Dehydrator _____ Location Drip: X Line Drip: _____ Other: _____
 Site Visit Date: 4.14.94 Run: 10 83

SITE ASSESSMENT

NMOCD Zone: Inside Land Type: BLM ☒
 (From NMOCD Vulnerable State ☐
 Maps) Zone ☒ Fee ☐
 Outside ☐ Indian _____

Depth to Groundwater

Less Than 50 Feet (20 points) ☐
 50 Ft to 99 Ft (10 points) ☐
 Greater Than 100 Ft (0 points) ☒

Wellhead Protection Area :

Is it less than 1000 ft from wells, springs, or other sources of fresh water extraction? , or ; Is it less than 200 ft from a private domestic water source? ☐ YES (20 points) ☒ NO (0 points)

Horizontal Distance to Surface Water Body

Less Than 200 Ft (20 points) ☐
 200 Ft to 1000 Ft (10 points) ☐
 Greater Than 1000 Ft (0 points) ☒

Name of Surface Water Body _____

(Surface Water Body : Perennial Rivers, Major Wash, Streams, Creeks, Irrigation Canals, Ditches, Lakes, Ponds)

TOTAL HAZARD RANKING SCORE: 0 POINTS

REMARKS

Remarks : TWO PITS ON LOCATION. WILL CLOSE ONLY ONE. PIT IS
DRY. DO NOT KNOW WHY LOCATION IS IN THE WATER VULNERABLE ZONE.

ORIGINAL PIT LOCATION

ORIGINAL PIT LOCATION

Original Pit : a) Degrees from North 260° Footage to Wellhead 88'
b) Degrees from North _____ Footage to Dogleg _____
Dogleg Name _____
c) Length : 12' Width : 10' Depth : 2'

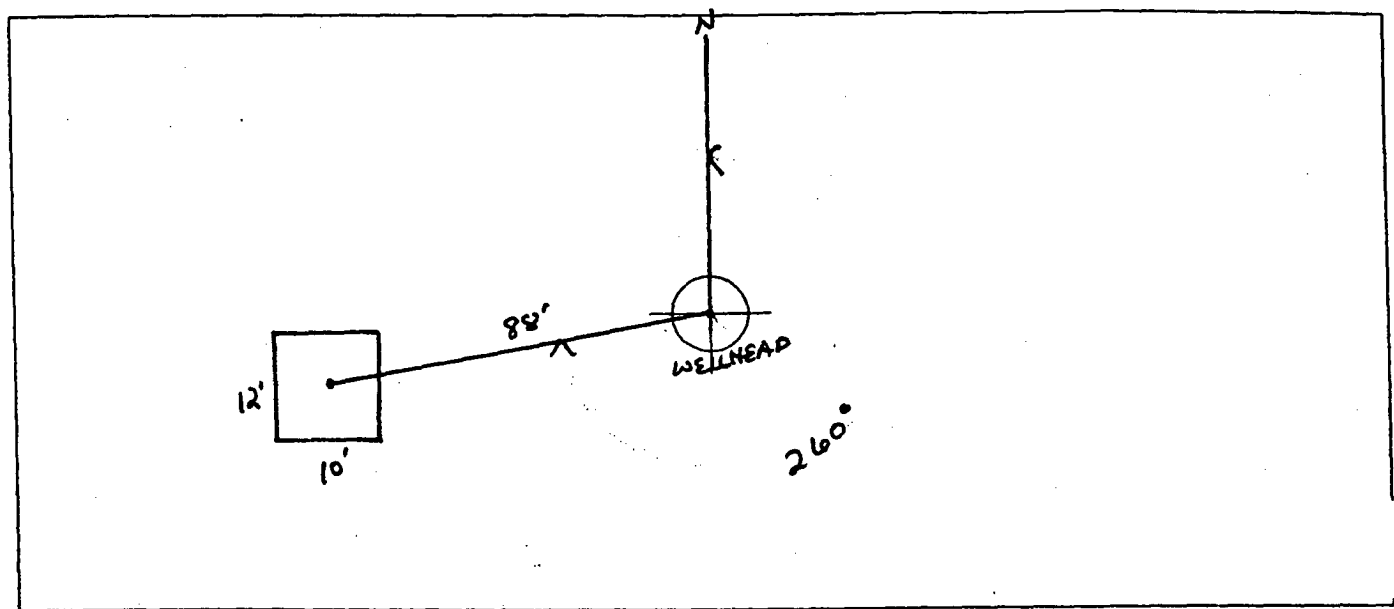

REMARKS

Remarks :
STARTED TAKING PICTURES AT 1:35 P.M.
END DUMP

Completed By:
Robert Thompson
Signature

4.14.94
Date

4.24.94
RT

Revised

FIELD PIT SITE ASSESSMENT FORM

GENERAL	<p>Meter: <u>73397</u> Location: <u>MANSEFIELD #16</u></p> <p>Operator #: _____ Operator Name: _____ P/L District: _____</p> <p>Coordinates: Letter: _____ Section _____ Township: _____ Range: _____</p> <p>Or Latitude _____ Longitude _____</p> <p>Pit Type: Dehydrator _____ Location Drip: _____ Line Drip: _____ Other: _____</p> <p>Site Assessment Date: _____ Area: <u>10</u> Run: <u>83</u></p>
SITE ASSESSMENT	<p>NMOCD Zone: (From NMOCD. Maps)</p> <p>Inside <input type="checkbox"/> (1)</p> <p>Outside <input type="checkbox"/> (2)</p> <p>Land Type: BLM <input type="checkbox"/> (1) State <input type="checkbox"/> (2) Fee <input type="checkbox"/> (3) Indian _____</p> <p>Depth to Groundwater</p> <p>Less Than 50 Feet (20 points) <input checked="" type="checkbox"/> (1)</p> <p>50 Ft to 99 Ft (10 points) <input type="checkbox"/> (2)</p> <p>Greater Than 100 Ft (0 points) <input type="checkbox"/> (3)</p> <p>Wellhead Protection Area :</p> <p>Is it less than 1000 ft from wells, springs, or other sources of fresh water extraction? , or ; Is it less than 200 ft from a private domestic water source? <input type="checkbox"/> (1) YES (20 points) <input type="checkbox"/> (2) NO (0 points)</p> <p>Horizontal Distance to Surface Water Body</p> <p>Less Than 200 Ft (20 points) <input type="checkbox"/> (1)</p> <p>200 Ft to 1000 Ft (10 points) <input checked="" type="checkbox"/> (2)</p> <p>Greater Than 1000 Ft (0 points) <input type="checkbox"/> (3)</p> <p>Name of Surface Water Body <u>PEMADA CANYON</u></p> <p>(Surface Water Body : Perennial Rivers, Major Wash, Streams, Creeks, Irrigation Canals, Ditches, Lakes, Ponds)</p> <p>Distance to Nearest Ephemeral Stream <input type="checkbox"/> (1) < 100' (Navajo Pits Only)</p> <p><input type="checkbox"/> (2) > 100'</p> <p>TOTAL HAZARD RANKING SCORE: <u>30</u> POINTS</p>
MARKS	<p>Remarks : _____</p> <p>_____</p> <p>_____</p>