

District I  
1625 N. French Dr., Hobbs, NM 88240  
District II  
1301 W. Grand Avenue, Artesia, NM 88210  
District III  
1000 Rio Brazos Road, Aztec, NM 87410  
District IV  
1220 S. St. Francis Dr., Santa Fe, NM 87505

State of New Mexico  
Energy Minerals and Natural Resources

Oil Conservation Division  
1220 South St. Francis Dr.  
Santa Fe, NM 87505

Risk  
defined  
Plume  
TPH

Submit 1 copy to  
appropriate  
District Office  
and 1 copy to  
the Santa Fe Office

(Revised 3/9/94)

**PIT REMEDIATION AND CLOSURE REPORT**

30-045-21157

Operator: Texaco (Site Closed by El Paso Field Services)

Telephone: \_\_\_\_\_

Address: \_\_\_\_\_

Facility Or: Schumacher Fed #1K, Meter 87722

Well Name \_\_\_\_\_

Location: Unit or Qtr/Qtr Sec K Sec 18 T 30 R 10 County San Juan

Pit Type: Separator \_\_\_\_\_ Dehydrator \_\_\_\_\_ Other Drip

Land Type: BLM X, State \_\_\_\_\_, Fee \_\_\_\_\_ Other \_\_\_\_\_

Pit Location: Pit dimensions: length 34', width 25', depth 3'  
(Attach diagram)

Reference: wellhead X, other \_\_\_\_\_

Footage from reference: 72'

Direction from reference: 139 Degrees X East North \_\_\_\_\_  
of  
\_\_\_\_\_ West South \_\_\_\_\_

Depth To Ground Water	Less than 50 feet	(20 points)
(Vertical distance from	50 feet to 99 feet	(10 points)
contaminants to seasonal	Greater than 100 feet	( 0 points) <u>0</u>
high water elevation of		
ground water.)		

Wellhead Protection Area:	Yes (20 points)
(Less than 200 feet from a private	No ( 0 points) <u>0</u>
domestic water source, or; less than	
1000 feet from all other water sources.)	

Distance To Surface Water:	Less than 200 feet	(20 points)
(Horizontal distance to perennial	200 feet to 1000 feet	(10 points)
lakes, ponds, rivers, streams, creeks,	Greater than 1000 feet	( 0 points) <u>0</u>
irrigation canals and ditches.)		

RANKING SCORE (TOTAL POINTS): 0

Date Remediation Started: 09/29/94 Date completed: 09/29/94

Remediation Method: Excavation \_\_\_\_\_ Approx. cubic yards \_\_\_\_\_  
(Check all appropriate sections.) Landfarmed \_\_\_\_\_ Insitu Bioremediation \_\_\_\_\_  
Other Backfill Pit Without Excavation

Remediation Location: Onsite N/A Offsite N/A  
(i.e. landfarmed onsite, name and location of offsite facility)

General Description of Remedial Action: No line markers. Soil turned black with a smell.

Ground Water Encountered: No X Yes \_\_\_\_\_ Depth \_\_\_\_\_

Final Pit: Sample location Four walls and center of pit composite  
Closure Sampling: \_\_\_\_\_  
(if multiple samples, attach sample results and diagram of sample locations and depths) Sample depth 12'

Sample Date 09/29/94 Sample time 10:43

Sample Results

Benzene(ppm) Not reported.

Total BTEX(ppm) Not reported.

Field headspace(ppm) 402

TPH 5300

Ground Water Sample: Yes \_\_\_\_\_ No X (If yes, attach sample results)

I hereby certify that the information above is true and complete to the best of my knowledge and belief.

Date 4/23/93

Signature

Scott T. Pope

Printed Name

and Title

Scott Pope, Senior Environmental Scientist



## PIT CLOSURE REQUEST

---

Schumacher Fed #1K  
Meter/Line ID 87722

---

### SITE DETAILS

Legals - Twn: 30N

Rng: 10W

Sec: 18

Unit: K

NMOCD Hazard Ranking: 0

Land Type: BLM

Operator: Texaco E&P Inc

Pit Closure Date: 9/29/94

---

### **RATIONALE FOR RISK-BASED CLOSURE**

---

The pit noted above was assessed and ranked according to the criteria in the New Mexico Oil Conservation Division's (NMOCD) Unlined Surface Impoundment Closure Guidelines.

A test pit was excavated to 12 feet (ft) below ground surface (bgs) and a soil sample was collected for field headspace and laboratory analysis for TPH. Groundwater was not encountered in the test pit. Headspace analysis indicated an organic vapor content of 402 ppm; laboratory analysis indicated a TPH concentration of 5,300 mg/kg. The TPH measurement exceeded recommended remediation levels for the Hazard Ranking Score of 0.

No soil was disposed of offsite. The pit was backfilled with site soil, topped with clean soil from the surrounding berms, and graded in a manner to direct surface runoff away from the pit area.

A Phase II boring was completed to 27 ft bgs. A soil sample was collected at 25-27 ft bgs for field headspace and laboratory analysis for TPH and BTEX. No groundwater was encountered in the soil boring. Headspace analysis indicated an organic vapor content of 0 ppm; laboratory analysis indicated a benzene concentration of <0.5 mg/kg, a total BTEX concentration of <3 mg/kg, and a TPH concentration of <20 mg/kg. All measurement were within recommended remediation levels for the Hazard Ranking Score of 0.

No Phase III activities were conducted.

El Paso Field Services requests closure of the above-mentioned pit location for the following reasons:

- The primary source, discharge to the pit, has been removed for over 8 years.
- The test pit was backfilled and the former pit area graded to direct surface runoff away from the former pit.
- The clean soil from the berms placed on top of the excavation would limit the potential for direct contact with hazardous constituents by livestock or the public; i.e., direct contact exposure pathways are unlikely to be completed.
- Groundwater was not encountered in the soil boring at 27 ft.
- There are no water supply wells or other sources of fresh water extraction within 1,000 feet of the site.



## **PIT CLOSURE REQUEST**

---

- Benzene, total BTEX, and TPH concentrations in the soil sample collected at the base of the Phase II soil boring at 27 ft bgs were non-detect, indicating that no significant downward constituent migration is occurring.
- Residual hydrocarbons in the soil, if any, will likely degrade by natural attenuation with minimal risk to the environment.

## **ATTACHMENTS**

Field Pit Assessment Form

Revised Field Pit Assessment Form

Field Pit Remediation/Closure Form

Phase II Soil Boring Log

Laboratory Analytical Results

**REVISED**  
**FIELD PIT SITE ASSESSMENT FORM**

GENERAL

Meter: 87722 Location: SCHUMACHER FED #112  
Operator #: 0263 Operator Name: TEXACO P/L District: AZTEC  
Coordinates: Letter 1C Section 18 Township: 30 Range: 10  
or Latitude \_\_\_\_\_ Longitude \_\_\_\_\_  
Pit Type: Dehydrator \_\_\_\_\_ Location Drip: X Line Drip: \_\_\_\_\_ Other: \_\_\_\_\_  
Site Assessment Date: 8-16-99 Area: 04 Run: 33  
Revised Date: 1-27-03

SITE ASSESSMENT

**NMOCD Zone:** (from NMCOD Maps) **Land Type:** BLM ☒ (1)  
State ☐ (2)  
Fee ☐ (3)  
Indian \_\_\_\_\_  
Inside ☐ (1)  
Outside ☒ (2)

**Depth to Groundwater**

Less than 50 Feet (20 points) ☐ (1)  
50 Feet to 99 Feet (10 Points) ☐ (2)  
Greater than 100 Feet (0 Points) ☒ (3)

**Well Protection Area**

Is it less than 1000 feet from well, spring or other source of fresh water extraction?  
or; Is it less than 200 feet from a private domestic water source?

☐ YES (20 Points) ☒ NO (0 Points)

**Horizontal Distance to Surface Water Body**

Less than 200 Feet (20 points) ☐ (1)  
200 Feet to 1000 Feet (10 Points) ☐ (2)  
Greater than 1000 Feet (0 Points) ☒ (3)

Name of Surface Water Body HAMPSON ARROYO

(Surface Water Body: Perennial River, Stream, Creek, Irrigation Canal, Ditch, Lake, Pond)

Distance to Nearest Ephemeral Stream ☐ (1) < 100 feet (Navajo Pits Only)  
☐ (2) > 100 feet

**TOTAL HAZARD RANKING SCORE** 0 **POINTS**

REMARKS

Remarks: REVISION BASED ON REASSESSMENT OF THE DEPTH  
TO GROUNDWATER.

**REVISED**  
**FIELD PIT SITE ASSESSMENT FORM**

GENERAL

Meter: 87722 Location: Schumacher Fed #1K  
 Operator #: \_\_\_\_\_ Operator Name: \_\_\_\_\_ P/L District: \_\_\_\_\_  
 Coordinates: Letter: K Section 18 Township: 30 Range: 10  
 Or Latitude \_\_\_\_\_ Longitude \_\_\_\_\_  
 Pit Type: Dehydrator \_\_\_\_\_ Location Drip: \_\_\_\_\_ Line Drip: \_\_\_\_\_ Other: \_\_\_\_\_  
 Site Assessment Date: 4/14/98 Area: \_\_\_\_\_ Run: \_\_\_\_\_

SITE ASSESSMENT

**NMOCD Zone:**

(From NMOCD  
Maps)

Inside

Outside

**Land Type:**

☐ (1)

☒ (2)

BLM

State

Fee

Indian

☒ (1)

☐ (2)

☐ (3)

**Depth to Groundwater**

Less Than 50 Feet (20 points)

☒ (1)

50 Ft to 99 Ft (10 points)

☐ (2)

Greater Than 100 Ft (0 points)

☐ (3)

**Wellhead Protection Area**

Is it less than 1000 ft from wells, springs or other sources of fresh water extraction?, or; Is it less than 200 ft from a private domestic water source?

☐ (1) YES (20 points)

☒ (2) NO (0 points)

**Horizontal Distance to Surface Water Body**

Less Than 200 Ft (20 points)

☐ (1)

200 Ft to 1000 Ft (10 points)

☐ (2)

Greater Than 1000 Ft (0 points)

☒ (3)

Name of Surface Water Body \_\_\_\_\_

(Surface Water Body: Perennial Rivers, Streams, Creeks, Irrigation Canals, Ditches, Lakes, Ponds)

Distance to Nearest Ephemeral Stream

☐ (1) < 100' (Navajo Pits Only)

☐ (2) > 100'

TOTAL HAZARD RANKING SCORE: 20 POINTS

REMARKS

Remarks : Site has been re-assessed, due to initial assessment including washes as a Surface Water Body. Site is < 50' vertical from center of Hampton Arroyo.

# FIELD PIT SITE ASSESSMENT FORM

GENERAL	<p style="text-align: right;">Well No. <u>1K</u> <small>CNC 9/19/94</small></p> <p>Meter: <u>87-TZ</u> Location: <u>Schumacher Fed. SF077764</u></p> <p>Operator #: <u>0263</u> Operator Name: <u>Texaco</u> P/L District: <u>Aztec</u></p> <p>Coordinates: Letter: <u>K</u> Section <u>18</u> Township: <u>30</u> Range: <u>10</u></p> <p>Or Latitude _____ Longitude _____</p> <p>Pit Type: Dehydrator _____ Location Drip: <u>X</u> Line Drip: _____ Other: _____</p> <p>Site Assessment Date: <u>8/16/94</u> Area: <u>04</u> Run: <u>33</u></p>														
	<table border="0"> <tr> <td data-bbox="51 688 149 1858" rowspan="5">SITE ASSESSMENT</td> <td data-bbox="149 688 844 903"> <p>NMOCD Zone: (From NMOCD Maps)</p> <p>Inside <input type="checkbox"/> (1) Outside <input checked="" type="checkbox"/> (2)</p> </td> <td data-bbox="844 688 1169 903"> <p>Land Type:</p> <p>BLM <input checked="" type="checkbox"/> (1) State <input type="checkbox"/> (2) Fee <input type="checkbox"/> (3) Indian _____</p> </td> </tr> <tr> <td colspan="2" data-bbox="149 903 1589 1113"> <p>Depth to Groundwater</p> <p>Less Than 50 Feet (20 points) <input checked="" type="checkbox"/> (1) 50 Ft to 99 Ft (10 points) <input type="checkbox"/> (2) Greater Than 100 Ft (0 points) <input type="checkbox"/> (3)</p> </td> </tr> <tr> <td colspan="2" data-bbox="149 1113 1589 1323"> <p>Wellhead Protection Area :</p> <p>Is it less than 1000 ft from wells, springs, or other sources of fresh water extraction? , or ; Is it less than 200 ft from a private domestic water source? <input type="checkbox"/> (1) YES (20 points) <input checked="" type="checkbox"/> (2) NO (0 points)</p> </td> </tr> <tr> <td colspan="2" data-bbox="149 1323 1589 1533"> <p>Horizontal Distance to Surface Water Body</p> <p>Less Than 200 Ft (20 points) <input type="checkbox"/> (1) 200 Ft to 1000 Ft (10 points) <input checked="" type="checkbox"/> (2) Greater Than 1000 Ft (0 points) <input type="checkbox"/> (3)</p> </td> </tr> <tr> <td colspan="2" data-bbox="149 1533 1589 1858"> <p>Name of Surface Water Body <u>Hampton Arroyo</u></p> <p>(Surface Water Body : Perennial Rivers, Major Wash, Streams, Creeks, Irrigation Canals, Ditches, Lakes, Ponds)</p> <p>Distance to Nearest Ephemeral Stream <input type="checkbox"/> (1) &lt; 100' (Navajo Pits Only) <input type="checkbox"/> (2) &gt; 100'</p> <p>TOTAL HAZARD RANKING SCORE: <u>30</u> POINTS</p> </td> </tr> <tr> <td data-bbox="51 1858 149 2051">REMARKS</td> <td colspan="2" data-bbox="149 1858 1589 2051"> <p>Remarks : <u>Redline Book - Outside Vulnerable Zone Type - Outside</u></p> <p><u>Five pits, location drip pit is dry, will close one pit.</u></p> <p style="text-align: right;"><u>PUSH IN</u></p> </td> </tr> </table>		SITE ASSESSMENT	<p>NMOCD Zone: (From NMOCD Maps)</p> <p>Inside <input type="checkbox"/> (1) Outside <input checked="" type="checkbox"/> (2)</p>	<p>Land Type:</p> <p>BLM <input checked="" type="checkbox"/> (1) State <input type="checkbox"/> (2) Fee <input type="checkbox"/> (3) Indian _____</p>	<p>Depth to Groundwater</p> <p>Less Than 50 Feet (20 points) <input checked="" type="checkbox"/> (1) 50 Ft to 99 Ft (10 points) <input type="checkbox"/> (2) Greater Than 100 Ft (0 points) <input type="checkbox"/> (3)</p>		<p>Wellhead Protection Area :</p> <p>Is it less than 1000 ft from wells, springs, or other sources of fresh water extraction? , or ; Is it less than 200 ft from a private domestic water source? <input type="checkbox"/> (1) YES (20 points) <input checked="" type="checkbox"/> (2) NO (0 points)</p>		<p>Horizontal Distance to Surface Water Body</p> <p>Less Than 200 Ft (20 points) <input type="checkbox"/> (1) 200 Ft to 1000 Ft (10 points) <input checked="" type="checkbox"/> (2) Greater Than 1000 Ft (0 points) <input type="checkbox"/> (3)</p>		<p>Name of Surface Water Body <u>Hampton Arroyo</u></p> <p>(Surface Water Body : Perennial Rivers, Major Wash, Streams, Creeks, Irrigation Canals, Ditches, Lakes, Ponds)</p> <p>Distance to Nearest Ephemeral Stream <input type="checkbox"/> (1) &lt; 100' (Navajo Pits Only) <input type="checkbox"/> (2) &gt; 100'</p> <p>TOTAL HAZARD RANKING SCORE: <u>30</u> POINTS</p>		REMARKS	<p>Remarks : <u>Redline Book - Outside Vulnerable Zone Type - Outside</u></p> <p><u>Five pits, location drip pit is dry, will close one pit.</u></p> <p style="text-align: right;"><u>PUSH IN</u></p>
SITE ASSESSMENT	<p>NMOCD Zone: (From NMOCD Maps)</p> <p>Inside <input type="checkbox"/> (1) Outside <input checked="" type="checkbox"/> (2)</p>	<p>Land Type:</p> <p>BLM <input checked="" type="checkbox"/> (1) State <input type="checkbox"/> (2) Fee <input type="checkbox"/> (3) Indian _____</p>													
	<p>Depth to Groundwater</p> <p>Less Than 50 Feet (20 points) <input checked="" type="checkbox"/> (1) 50 Ft to 99 Ft (10 points) <input type="checkbox"/> (2) Greater Than 100 Ft (0 points) <input type="checkbox"/> (3)</p>														
	<p>Wellhead Protection Area :</p> <p>Is it less than 1000 ft from wells, springs, or other sources of fresh water extraction? , or ; Is it less than 200 ft from a private domestic water source? <input type="checkbox"/> (1) YES (20 points) <input checked="" type="checkbox"/> (2) NO (0 points)</p>														
	<p>Horizontal Distance to Surface Water Body</p> <p>Less Than 200 Ft (20 points) <input type="checkbox"/> (1) 200 Ft to 1000 Ft (10 points) <input checked="" type="checkbox"/> (2) Greater Than 1000 Ft (0 points) <input type="checkbox"/> (3)</p>														
	<p>Name of Surface Water Body <u>Hampton Arroyo</u></p> <p>(Surface Water Body : Perennial Rivers, Major Wash, Streams, Creeks, Irrigation Canals, Ditches, Lakes, Ponds)</p> <p>Distance to Nearest Ephemeral Stream <input type="checkbox"/> (1) &lt; 100' (Navajo Pits Only) <input type="checkbox"/> (2) &gt; 100'</p> <p>TOTAL HAZARD RANKING SCORE: <u>30</u> POINTS</p>														
REMARKS	<p>Remarks : <u>Redline Book - Outside Vulnerable Zone Type - Outside</u></p> <p><u>Five pits, location drip pit is dry, will close one pit.</u></p> <p style="text-align: right;"><u>PUSH IN</u></p>														

### ORIGINAL PIT LOCATION

Original Pit : a) Degrees from North 139° Footage from Wellhead 72'  
b) Length : 34' Width : 25' Depth : 3'

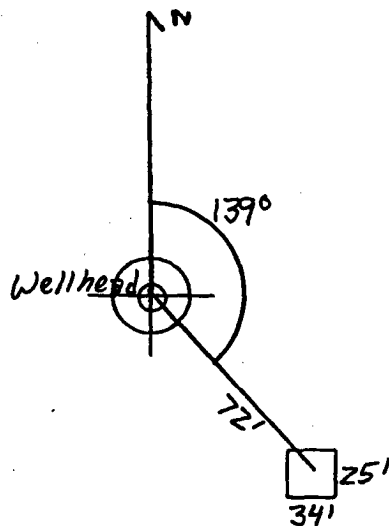

### REMARKS :

Pictures @ 1537 (Roll 2, 1-4)  
Dump Truck

Completed By:

*Sam Kelly*

Signature

8/16/94

Date