

District I
1625 N. French Dr., Hobbs, NM 88240
District II
1301 W. Grand Avenue, Artesia, NM 88210
District III
1000 Rio Brazos Road, Aztec, NM 87410
District IV
1220 S. St. Francis Dr., Santa Fe, NM 87505

State of New Mexico
Energy Minerals and Natural Resources

Oil Conservation Division
1220 South St. Francis Dr.
Santa Fe, NM 87505

Submit 1 copy to
appropriate
District Office
and 1 copy to
the Santa Fe Office

(Revised 3/9/94)

OK
Risk
defined
plume

PIT REMEDIATION AND CLOSURE REPORT

30-045-09257

Operator: Meridian (Site Closed by El Paso Field Services)

Telephone: _____

Address: _____

Facility Or: McGee #1 Fee, Meter 73797

Well Name _____

Location: Unit or Qtr/Qtr Sec B Sec 27 T 30 R 13 County San Juan

Pit Type: Separator _____ Dehydrator X Other _____

Land Type: BLM _____, State _____, Fee X Other _____

Pit Location: Pit dimensions: length 15', width 14', depth 3'

(Attach diagram)

Reference: wellhead X, other _____

Footage from reference: 159'

Direction from reference: 287 Degrees X East North _____
of
_____ West South _____

Depth To Ground Water	Less than 50 feet	(20 points)
(Vertical distance from	50 feet to 99 feet	(10 points)
contaminants to seasonal	Greater than 100 feet	(0 points) <u>0</u>
high water elevation of		
ground water.)		

Wellhead Protection Area:	Yes (20 points)
(Less than 200 feet from a private	No (0 points) <u>0</u>
domestic water source, or; less than	
1000 feet from all other water sources.)	

Distance To Surface Water:	Less than 200 feet	(20 points)
(Horizontal distance to perennial	200 feet to 1000 feet	(10 points)
lakes, ponds, rivers, streams, creeks,	Greater than 1000 feet	(0 points) <u>0</u>
irrigation canals and ditches.)		

RANKING SCORE (TOTAL POINTS): 0

Date Remediation Started: 04/19/94 Date completed: 04/19/94

Remediation Method: Excavation X Approx. cubic yards 7
(Check all appropriate sections.) Landfarmed _____ Insitu Bioremediation _____

Other _____

Remediation Location: Onsite _____ Offsite Tierra
(i.e. landfarmed onsite, name and location of offsite facility) _____

General Description of Remedial Action: Excavation went to average depth of 3'. Slight contamination at surface. At 3' PID read 89 ppm. Closed hole.

Ground Water Encountered: No X Yes _____ Depth _____

Final Pit:
Closure Sampling:
(if multiple samples,
attach sample results
and diagram of sample
locations and depths)

Sample location Four walls and center of pit composite

Sample depth 3'

Sample Date 04/19/94 Sample time 08:40

Sample Results

Benzene(ppm) <1.0

Total BTEX(ppm) 2.88

Field headspace(ppm) 89

TPH 425

Ground Water Sample: Yes _____ No X (If yes, attach sample results)

I hereby certify that the information above is true and complete to the best of my knowledge and belief.

Date

4/22/03

Signature

Scott T. Pope

Printed Name
and Title

Scott Pope, Senior Environmental Scientist



PIT CLOSURE REQUEST

McGee #1
Meter/Line ID 73797

SITE DETAILS

Legals - Twn: 30N	Rng: 13W	Sec: 27	Unit: B
NMOCD Hazard Ranking: 0		Land Type: Fee	
Operator: Meridian Oil Inc.		Pit Closure Date: 4/19/94	

RATIONALE FOR CLEAN CLOSURE

The pit noted above was assessed and ranked according to the criteria in the New Mexico Oil Conservation Division's (NMOCD) Unlined Surface Impoundment Closure Guidelines.

The pit was excavated to 3 feet (ft) below ground surface (bgs) and a soil sample was collected for field headspace and laboratory analysis for TPH. Groundwater was not encountered in the test pit. Headspace analysis indicated an organic vapor content of 89 ppm, laboratory analysis indicated a benzene concentration of <1.0 mg/kg, a total BTEX concentration of 2.88 mg/kg, and a TPH concentration of 425 mg/kg. The benzene, total BTEX, and TPH measurements below recommended remediation levels for the Hazard Ranking Score.

Approximately 7 cubic yards of impacted soil was excavated and removed off-site to the Tierra land farm. The pit was backfilled with clean soil from the surrounding berms and graded in a manner to direct surface runoff away from the pit area.

A Phase II boring was completed to 7 ft bgs. A soil sample was collected at 5-7 feet bgs for field headspace, total BTEX and TPH laboratory analysis. No groundwater was encountered in the soil boring. Headspace analysis indicated an organic vapor content of 0 ppm, laboratory analysis indicated a benzene concentration of <0.5 mg/kg, a total BTEX concentration of <3 mg/kg, and a TPH concentration of 108 mg/kg. The benzene, total BTEX and TPH concentrations were below recommended remediation levels for the Hazard Ranking Score.

No Phase III activities were performed.

El Paso Field Services requests closure of the above mentioned pit location for the following reasons:

- The primary source, discharge to the pit, has been removed for approximately eight years.
- Environmental analyses of all soil samples collected from this site have indicated concentrations below recommended remediation levels for the Hazard Ranking Score.
- Impacted soils were excavated and disposed of at an off-site facility.
- The test pit was backfilled with clean soil and the former pit area graded to direct surface runoff away from the former pit.
- There are no water supply wells or other sources of fresh water extraction within 1,000 feet of the site.
- Groundwater was not encountered during the excavation.

FIELD PIT SITE ASSESSMENT FORM

GENERAL	<p>Meter: <u>73797</u> Location: <u>McGEE #1 FEE</u></p> <p>Operator #: <u>0128</u> Operator Name: <u>MERIDIAN P/L</u> District: <u>Kurtz</u></p> <p>Coordinates: Letter: <u>B</u> Section <u>22</u> Township: <u>30</u> Range: <u>13</u></p> <p>Or Latitude _____ Longitude _____</p> <p>Pit Type: Dehydrator <input checked="" type="checkbox"/> Location Drip: _____ Line Drip: _____ Other: _____</p> <p>Site Visit Date: <u>3-24-94</u> Run: <u>02 31</u></p>				
SITE ASSESSMENT	<table style="width: 100%;"> <tr> <td style="width: 30%;"> NMOCD Zone: (From NMOCD Maps) </td> <td style="width: 30%;"> Inside Vulnerable Zone <input checked="" type="checkbox"/> Outside <input type="checkbox"/> </td> <td style="width: 30%;"> Land Type: </td> <td style="width: 10%;"> BLM <input type="checkbox"/> State <input type="checkbox"/> Fee <input checked="" type="checkbox"/> Indian _____ </td> </tr> </table> <p>Depth to Groundwater</p> <p>Less Than 50 Feet (20 points) <input type="checkbox"/></p> <p>50 Ft to 99 Ft (10 points) <input type="checkbox"/></p> <p>Greater Than 100 Ft (0 points) <input checked="" type="checkbox"/></p> <p>Wellhead Protection Area :</p> <p>Is it less than 1000 ft from wells, springs, or other sources of fresh water extraction? , or ; Is it less than 200 ft from a private domestic water source? <input type="checkbox"/> YES (20 points) <input checked="" type="checkbox"/> NO (0 points)</p> <p>Horizontal Distance to Surface Water Body</p> <p>Less Than 200 Ft (20 points) <input type="checkbox"/></p> <p>200 Ft to 1000 Ft (10 points) <input type="checkbox"/></p> <p>Greater Than 1000 Ft (0 points) <input checked="" type="checkbox"/></p> <p>Name of Surface Water Body _____</p> <p>(Surface Water Body : Perennial Rivers, Major Wash, Streams, Creeks, Irrigation Canals, Ditches, Lakes, Ponds)</p> <p>TOTAL HAZARD RANKING SCORE: <u>0</u> POINTS</p>	NMOCD Zone: (From NMOCD Maps)	Inside Vulnerable Zone <input checked="" type="checkbox"/> Outside <input type="checkbox"/>	Land Type:	BLM <input type="checkbox"/> State <input type="checkbox"/> Fee <input checked="" type="checkbox"/> Indian _____
NMOCD Zone: (From NMOCD Maps)	Inside Vulnerable Zone <input checked="" type="checkbox"/> Outside <input type="checkbox"/>	Land Type:	BLM <input type="checkbox"/> State <input type="checkbox"/> Fee <input checked="" type="checkbox"/> Indian _____		
REMARKS	<p>Remarks : <u>ONLY PIT ON LOCATION. DEHY HAS NOT BEEN DIS-CONNECTED FROM PIT YET. PIT IS DRY.</u></p>				

ORIGINAL PIT LOCATION

Original Pit : a) Degrees from North 287° Footage to Wellhead 159'
 b) Degrees from North _____ Footage to Dogleg _____
 Dogleg Name _____
 c) Length : 15' Width : 14' Depth : 3'

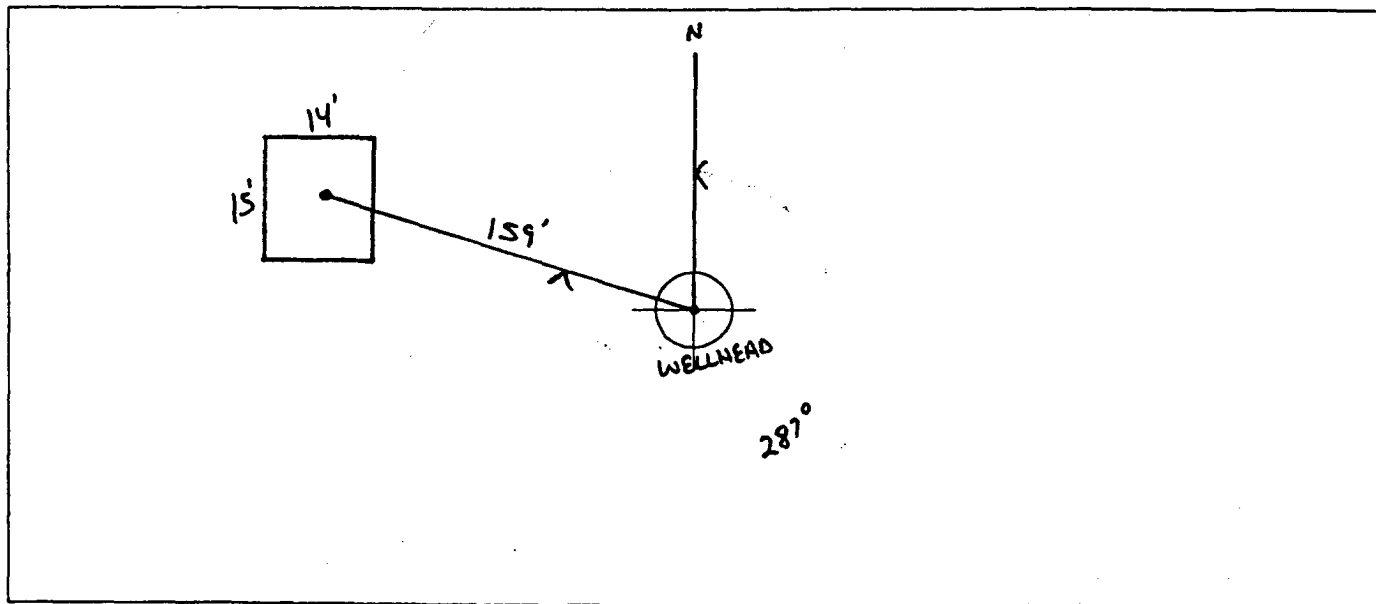

REMARKS :

STARTED TAKING PICTURES AT 11:53 A.M.
END DUMP

Completed By:

Robert Thompson
 Signature

3-24-94
 Date

FIELD PIT REMEDIATION/CLOSURE FORM

GENERAL

Meter: 73797 Location: M^cGee #1 Fee
 Coordinates: Letter: B Section 27 Township: 30 Range: 13
 Or Latitude _____ Longitude _____
 Date Started : 4-19-94 Area: 02 Run: 31

FIELD OBSERVATIONS

Sample Number(s): ⁹⁴⁰⁸²⁹KD-6
 Sample Depth: 3 Feet
 Final PID Reading 89 ppm PID Reading Depth 3 Feet
 Yes No
 Groundwater Encountered ☐ (1) ☒ (2) Approximate Depth _____ Feet

CLOSURE

Remediation Method :
 Excavation ☒ (1) Approx. Cubic Yards 7
 Onsite Bioremediation ☐ (2)
 Backfill Pit Without Excavation ☐ (3)
 Soil Disposition:
 Envirotech ☐ (1) ☒ (3) Tierra
 Other Facility ☐ (2) Name: _____
 Pit Closure Date: 4-19-94 Pit Closed By: BEI

REMARKS

Remarks : EXCAVATION went to Average Depth of 3ft. slight
contamination at surface at 3' PID Read 89 ppm. ~~pit~~ closed
hole.

Signature of Specialist: *Randy Dean*

RECORD OF SUBSURFACE EXPLORATION

PHILIP ENVIRONMENTAL

4000 Morroe Road
Farmington, New Mexico 87401
(505) 326-2262 FAX (505) 326-2388

Borehole # BH-1
Well # N/A
Page 1 of 1

Project Name EPNG PITS
Project Number 14509 Phase 6000 77
Project Location McGee #1 Fee (23797)

Elevation _____
Borehole Location T30, R13, S27, B
GWL Depth N/A
Logged By ST Pope
Drilled By M. DONOHUE K. Padilla
Date/Time Started 9/29/95 1230
Date/Time Completed 9/29/95

Well Logged By ST Pope
Personnel On-Site D. Charles
Contractors On-Site N/A
Client Personnel On-Site N/A
Drilling Method 4 1/4" ID HSA
Air Monitoring Method PID, CGI

Depth (Feet)	Sample Number	Sample Interval	Sample Type & Recovery (inches)	Sample Description Classification System: USCS	USCS Symbol	Depth Lithology Change (feet)	Air Monitoring Units: PPM			Drilling Conditions & Blow Counts
							BZ	BH	HS	
0				Brown Sandy Fill						
				Bottom of Pit		3.0				
5	1	5 7	12	Brown Sand, Fine-Medium grainy, trace silt, Medium Dense, Moist	SW		0	0	0	Headspace = 0.0 *
				ToB - 7.0						
10										
15										
20										
25										
30										
35										
40										

Comments:

* Sample Collected in TPH BTEX, STP-22 5-7'

Geologist Signature

St. T. Pope



FIELD SERVICES LABORATORY
ANALYTICAL REPORT

PIT CLOSURE PROJECT - Soil Samples Inside the GWV Zone

SAMPLE IDENTIFICATION

	Field ID	Lab ID
SAMPLE NUMBER:	STP 22	947563
MTR CODE SITE NAME:	73797	McGee #1 Fee
SAMPLE DATE TIME (Hrs):	09-29-95	1250
PROJECT:	Phase II Drilling	
DATE OF TPH EXT. ANAL.:	10/3/95	
DATE OF BTEX EXT. ANAL.:	10/2/95	10/2/95
TYPE DESCRIPTION:	VG	Brown fine sand

Field Remarks:

RESULTS

PARAMETER	RESULT	UNITS	QUALIFIERS			
			DF	Q	M(g)	V(ml)
BENZENE	< 0.5	MG/KG				
TOLUENE	< 0.5	MG/KG				
ETHYL BENZENE	< 0.5	MG/KG				
TOTAL XYLENES	< 1.5	MG/KG				
TOTAL BTEX	< 3	MG/KG				
TPH (418.1)	108	MG/KG			2.02	28
HEADSPACE PID	0	PPM				
PERCENT SOLIDS	97.0	%				

-- TPH is by EPA Method 418.1 and BTEX is by EPA Method 8020 --

The Surrogate Recovery was at 98% for this sample All QA/QC was acceptable.
Narrative:

DF = Dilution Factor Used

Approved By: JR

Date: 10-4-95