

District I
1625 N. French Dr., Hobbs, NM 88240
District II
1301 W. Grand Avenue, Artesia, NM 88210
District III
1000 Rio Brazos Road, Aztec, NM 87410
District IV
220 S. St. Francis Dr., Santa Fe, NM 87505

State of New Mexico
Energy Minerals and Natural Resources

Oil Conservation Division
1220 South St. Francis Dr.
Santa Fe, NM 87505

Risk
Defined
Plume
sandstone

Submit 1 copy to
appropriate
District Office
and 1 copy to
the Santa Fe Office
(Revised 3/9/94)

PIT REMEDIATION AND CLOSURE REPORT

30-045-10489

Operator: Amoco Production (Site Closed by El Paso Field Services) Telephone: _____

Address: _____

Facility Or: Atlantic Com LS 3, Meter 70565

Well Name _____

Location: Unit or Qtr/Qtr Sec K Sec 24 T 31 R 10 County San Juan

Pit Type: Separator _____ Dehydrator _____ Other Drip

Land Type: BLM X, State _____, Fee _____ Other _____

Pit Location: Pit dimensions: length 66', width 35', depth 4'

(Attach diagram)

Reference: wellhead X, other _____

Footage from reference: 57'

Direction from reference: 80 Degrees X East North _____
of
_____ West South _____

Depth To Ground Water	Less than 50 feet	(20 points)
(Vertical distance from	50 feet to 99 feet	(10 points)
contaminants to seasonal	Greater than 100 feet	(0 points) <u>0</u>
high water elevation of		
ground water.)		

Wellhead Protection Area:	Yes (20 points)
(Less than 200 feet from a private	No (0 points) <u>20</u>
domestic water source, or; less than	
1000 feet from all other water sources.)	

Distance To Surface Water:	Less than 200 feet	(20 points)
(Horizontal distance to perennial	200 feet to 1000 feet	(10 points)
lakes, ponds, rivers, streams, creeks,	Greater than 1000 feet	(0 points) <u>0</u>
irrigation canals and ditches.)		

RANKING SCORE (TOTAL POINTS): 20

Date Remediation Started: 09/30/94 Date completed: 09/30/94

Remediation Method: Excavation _____ Approx. cubic yards _____
(Check all appropriate sections.) Landfarmed _____ Insitu Bioremediation _____
Other Backfill Pit Without Excavation

Remediation Location: Onsite N/A Offsite N/A
(i.e. landfarmed onsite,
name and location of
offsite facility)

General Description of Remedial Action: Excavated test hole to 7', hit hard clay-shale layer. Took PID, closed pit.

Ground Water Encountered: No X Yes _____ Depth _____

Final Pit: Sample location Four walls and center of pit composite
Closure Sampling:
(if multiple samples,
attach sample results
and diagram of sample
locations and depths) Sample depth 7'

Sample Date 09/30/94 Sample time 11:15

Sample Results

Benzene(ppm) Not reported

Total BTEX(ppm) Not reported

Field headspace(ppm) 67

TPH 3740

Ground Water Sample: Yes _____ No X (If yes, attach sample results)

I hereby certify that the information above is true and complete to the best of my knowledge and belief.

Date 4/23/03

Signature

Scott T. Pope

Printed Name
and Title

Scott Pope, Senior Environmental Scientist



PIT CLOSURE REQUEST

Atlantic Com LS3
Meter/Line ID 70565

SITE DETAILS

Legals - Twn: 31N

Rng: 10W

Sec: 24

Unit: K

NMOCD Hazard Ranking: 20

Land Type: BLM

Operator: Amoco Production Company

Pit Closure Date: 9/30/94

RATIONALE FOR RISK-BASED CLOSURE

The pit noted above was assessed and ranked according to the criteria in the New Mexico Oil Conservation Division's (NMOCD) Unlined Surface Impoundment Closure Guidelines.

A test pit was excavated to 7 feet (ft) below ground surface (bgs) where bedrock was encountered and a soil sample was collected for field headspace and laboratory analysis for TPH. Groundwater was not encountered in the test pit. Headspace analysis indicated an organic vapor content of 67 ppm; laboratory analysis indicated a TPH concentration of 3,740 mg/kg. The TPH measurement exceeded the recommended remediation level for the Hazard Ranking Score of 20.

No soil was disposed of offsite. The pit was backfilled with site soil, topped with clean soil from the surrounding berms, and graded in a manner to direct surface runoff away from the pit area.

A Phase II boring was terminated with sandstone refusal at 15.5 ft bgs. A soil sample was collected at 15-15.5 for field headspace, and laboratory analysis for TPH and total BTEX. No groundwater was encountered in the soil boring. Headspace analysis indicated an organic vapor content of 2 ppm; laboratory analysis indicated a benzene concentration of <0.5 mg/kg, a total BTEX concentration of <3 mg/kg, and a TPH concentration of <20 mg/kg. The benzene, total BTEX and TPH concentrations were below recommended remediation levels for the Hazard Ranking Score of 20.

No Phase III activities were performed.

El Paso Field Services requests closure of the above mentioned pit location for the following reasons:

- The primary source, discharge to the pit, has been removed for over 8 years.
- Bedrock was encountered at 7 feet bgs making additional excavation impractical and further downward migration of contaminants unlikely.
- The test pit was backfilled and the former pit area graded to direct surface runoff away from the former pit.
- The clean soil from the berms placed on top of the excavation would limit the potential for direct contact with hazardous constituents by livestock or the public; i.e., direct contact exposure pathways are unlikely to be completed.
- Groundwater was not encountered in the soil boring to 15.5 ft bgs; local geologic features indicate the depth to groundwater is greater than 100 ft bgs.

REVISED
FIELD PIT SITE ASSESSMENT FORM

GENERAL

Meter: 70565 Location: ATLANTIC Com LS 3
Operator #: 0203 Operator Name: Amoco P/L District: AZTEC
Coordinates: Letter 16 Section 24 Township: 31 Range: 10
or Latitude _____ Longitude _____
Pit Type: Dehydrator _____ Location Drip: ☒ Line Drip: _____ Other: _____
Site Assessment Date: 8-29-99 Area: 04 Run: 87
Revised Date: 1-27-02

SITE ASSESSMENT

NMOCD Zone:

(from NMCOD Maps)

Land Type:

BLM ☒ (1)

State ☐ (2)

Fee ☐ (3)

Indian _____

Inside ☐ (1)

Outside ☒ (2)

Depth to Groundwater

Less than 50 Feet (20 points) ☐ (1)

50 Feet to 99 Feet (10 Points) ☐ (2)

Greater than 100 Feet (0 Points) ☒ (3)

Well Protection Area

Is it less than 1000 feet from well, spring or other source of fresh water extraction?
or; Is it less than 200 feet from a private domestic water source?

☒ YES (20 Points)

☐ NO (0 Points)

Horizontal Distance to Surface Water Body

Less than 200 Feet (20 points) ☐ (1)

200 Feet to 1000 Feet (10 Points) ☐ (2)

Greater than 1000 Feet (0 Points) ☒ (3)

Name of Surface Water Body _____

(Surface Water Body: Perennial River, Stream, Creek, Irrigation Canal, Ditch, Lake, Pond)

Distance to Nearest Ephemeral Stream ☐ (1) < 100 feet

(Navajo Pits Only)

☐ (2) > 100 feet

TOTAL HAZARD RANKING SCORE _____ POINTS

REMARKS

Remarks: REVISION BASED ON REASSESSMENT OF THE DEPTH TO
GROUNDWATER AND THE HORIZONTAL DISTANCE TO SURFACE
WATER BODY.

FIELD PIT SITE ASSESSMENT FORM

GENERAL	Meter: <u>70-565</u> Location: <u>Atlantic COM L53</u> Operator #: <u>0203</u> Operator Name: ^{AMOCO} Production P/L District: <u>Artec</u> Coordinates: Letter: <u>K</u> Section <u>24</u> Township: <u>31</u> Range: <u>10</u> Or Latitude _____ Longitude _____ Pit Type: Dehydrator _____ Location Drip: <u>X</u> Line Drip: _____ Other: _____ Site Assessment Date: <u>8/29/94</u> Area: <u>04</u> Run: <u>83</u>	
SITE ASSESSMENT	NMOCD Zone: (From NMOCD Maps) Inside <input type="checkbox"/> (1) Outside <input checked="" type="checkbox"/> (2) Land Type: BLM <input checked="" type="checkbox"/> (1) State <input type="checkbox"/> (2) Fee <input type="checkbox"/> (3) Indian _____ Depth to Groundwater: Less Than 50 Feet (20 points) <input checked="" type="checkbox"/> (1) 50 Ft to 99 Ft (10 points) <input type="checkbox"/> (2) Greater Than 100 Ft (0 points) <input type="checkbox"/> (3) Wellhead Protection Area : Is it less than 1000 ft from wells, springs, or other sources of fresh water extraction? , or ; Is it less than 200 ft from a private domestic water source? <input checked="" type="checkbox"/> (1) YES (20 points) <input type="checkbox"/> (2) NO (0 points) Horizontal Distance to Surface Water Body: Less Than 200 Ft (20 points) <input type="checkbox"/> (1) 200 Ft to 1000 Ft (10 points) <input checked="" type="checkbox"/> (2) Greater Than 1000 Ft (0 points) <input type="checkbox"/> (3) Name of Surface Water Body <u>Arch Rock Canyon</u> (Surface Water Body : Perennial Rivers, Major Wash, Streams, Creeks, Irrigation Canals, Ditches, Lakes, Ponds) Distance to Nearest Ephemeral Stream <input type="checkbox"/> (1) < 100' (Navajo Pits Only) <input type="checkbox"/> (2) > 100' TOTAL HAZARD RANKING SCORE: <u>50</u> POINTS	
REMARKS	Remarks : <u>Redline Book - Inside Vulnerable Zone - Outside</u> <u>Three pits, location drip pit is dry, will close one pit.</u> <div style="text-align: right;"><u>PUSH IN</u></div>	

ORIGINAL PIT LOCATION

ORIGINAL PIT LOCATION

Original Pit : a) Degrees from North 80° Footage from Wellhead 57'
b) Length : 66' Width : 35' Depth : 4'

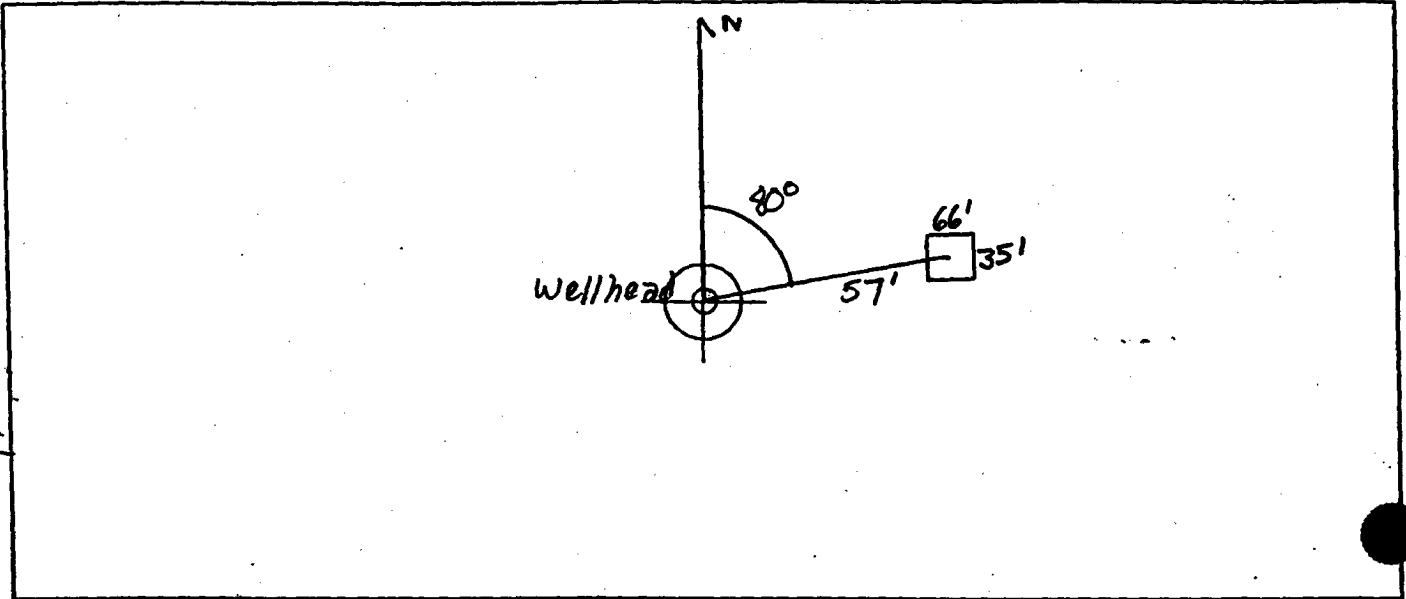

REMARKS

Remarks :

Pictures @ 1258 (9-12, Roll 1)
Dump Truck

Completed By:

David Kelly
Signature

6/29/94
Date

FIELD PIT REMEDIATION/CLOSURE FORM

GENERAL

Meter: 70565 Location: Atlantic Cm LS 3
 Coordinates: Letter: K Section 24 Township: 31 Range: 10
 Or Latitude _____ Longitude _____
 Date Started : 9/30/94 Run: 04 83

FIELD OBSERVATIONS

Sample Number(s): KD 297
 Sample Depth: 7' Feet
 Final PID Reading 67 ppm PID Reading Depth 7' Feet
 Yes No
 Groundwater Encountered ☐ ☒ Approximate Depth _____ Feet

CLOSURE

Remediation Method :
 Excavation ☐ Approx. Cubic Yards _____
 Onsite Bioremediation ☐
 Backfill Pit Without Excavation ☒
 Soil Disposition:
 Envirotech ☐ Tierra ☐
 Other Facility ☐ Name: _____
 Pit Closure Date: 9/30/94 Pit Closed By: BET

REMARKS

Remarks : Excavated test hole to 7', Hit hard clay-shale layer, Took pid, closed pit

Signature of Specialist: 



FIELD SERVICES LABORATORY
ANALYTICAL REPORT
PIT CLOSURE PROJECT

SAMPLE IDENTIFICATION

	Field ID	Lab ID
SAMPLE NUMBER:	CMC375	980324
MTR CODE SITE NAME:	70565	Atlantic Com LS #3
SAMPLE DATE TIME (Hrs):	4/27/98	1303
PROJECT:	Phase II Drilling	
DATE OF TPH EXT. ANAL.:	5/1/98	5/1/98
DATE OF BTEX EXT. ANAL.:	4/28/98	4/29/98
TYPE DESCRIPTION:	VG	SOIL

Field Remarks: 15-15.5'

RESULTS

PARAMETER	RESULT	UNITS	QUALIFIERS			
			DF	Q	M(g)	V(ml)
BENZENE	<0.5	MG/KG				
TOLUENE	<0.5	MG/KG				
ETHYL BENZENE	<0.5	MG/KG				
TOTAL XYLENES	<1.5	MG/KG				
TOTAL BTEX	<3	MG/KG				
TPH (MOD.8015)	<20	MG/KG				
HEADSPACE PID	2	PPM				
PERCENT SOLIDS	94.9	%				

-- TPH is by EPA Method 418.1 and BTEX is by EPA Method 8020 --

The Surrogate Recovery was at 105 % for this sample All QA/QC was acceptable.
negative:

DF = Dilution Factor Used

Approved By:

John Sanchez

Date:

5/11/98

RECORD OF SUBSURFACE EXPLORATION

PHILIP SERVICES CORP.

1000 Monroe Road
Albuquerque, New Mexico 87401
(505) 326-2262 FAX (505) 326-2388

Borehole # BH-1
Well # NA
Page 1 of 1

Project Number 19007 Phase 1001.77
Project Name EPFS WELLHEAD PITS
Project Location Atlantic Combs #3 70565

Elevation _____
Borehole Location LTR: K S: 24 T: 31 R: 10
GWL Depth NA
Drilled By K. PADILLA
Well Logged By C. CHANCE
Date Started 4/27/98
Date Completed 4/27/98

Drilling Method 4 1/4 ID HSA
Air Monitoring Method PID

Depth (Feet)	Sample Number	Sample Interval	Sample Type & Recovery (inches)	Sample Description Classification System: USCS	USCS Symbol	Depth Lithology Change (feet)	Air Monitoring Units: PPM			Drilling Conditions & Blow Counts
							BZ	BH	S/H	
0										
5	1	5-7	18	Backfill to ~5' DK Gray silty CLAY, stiff, dry, nonplastic, odor			1	1	47	~1241 hr - Hard Drilling
10	2	10-11	2-3	Lt Br silty SAND, v-f sand, loose, dry, st odor			0	0	127	500/2-3" -1250 - Hard Drilling
15	3	15-15.5	4	Lt br SANDSTONE, weathered, f-med sand, tr xtn, dry TOB 15.5'			0	0	72	1200 50/4" - sample
20										
25										
30										
35										
40										

Comments: Pit is <1000' From Arch Rock Spring. Pit was located using Fastag & bearing from assessment. CMC375 collected from 15-15.5' for BTEX & TPH (2015). BH grouted to surface
Geologist Signature Cory Chance