

# BURLINGTON RESOURCES

SAN JUAN DIVISION

*Waiting period end 12-07-03*

*30.045 32035*

November 12, 2003

(Certified Mail – Return Receipt Requested)

Re: Brown 100S  
Basin Fruitland Coal  
1525'FSL, 1790'FWL Section 9, T-32-N, R-10-W  
San Juan County, New Mexico



To the Affected Persons:

Burlington Resources Oil & Gas Company LP is submitting the enclosed Application for Permit to Drill to the appropriate regulatory agency(s) for approval. This well is located inside the High Productivity Area of the Basin-Fruitland Coal Pool as indicated on the attached plat. Notice is being made pursuant to New Mexico Oil Conservation Commission Order R-8768-F dated July 17, 2003.

The affected parties have twenty (20) days from receipt of this notice in which to file with the District Office of the New Mexico Oil Conservation Division written objection to the proposed Application for Permit to Drill.

Sincerely,

*Frances Bond*

Frances Bond  
Regulatory Assistant

2. Article Number		COMPLETE THIS SECTION ON DELIVERY	
1. Article Addressee <b>EXXON MOBIL CORPORATION</b> ATTN JIB ACCOUNTING P O BOX 4707 P O BOX 4707 Houston, TX 77210		A. Signature <b>X</b> <i>[Signature]</i>	<input type="checkbox"/> Agent <input type="checkbox"/> Addressee
		B. Received by (Printed Name)	C. Date of Delivery
		D. Is delivery address different from item 1? <input type="checkbox"/> Yes If YES enter delivery address below	
		3. Service Type <input checked="" type="checkbox"/> <b>Certified</b>	
		4. Restricted Delivery? (Extra Fee) <input type="checkbox"/> Yes	

PS Form 3811

7:50 AM 9/18/2003

Domestic Return Receipt Code: Brown 1005

File:

2. Article Number		COMPLETE THIS SECTION ON DELIVERY	
1. Article Addressee <b>ST JOHN INSTITUTIONAL INVESTORS LP</b> C/O THE DEERPATH OIL & GAS PTNR INC ATTN LISA LAVIN 800 E NORTHWEST HWY STE 203 Mount Prospect, IL 60056		A. Signature <b>X</b> <i>[Signature]</i>	<input type="checkbox"/> Agent <input type="checkbox"/> Addressee
		B. Received by (Printed Name)	C. Date of Delivery
		D. Is delivery address different from item 1? <input type="checkbox"/> Yes If YES enter delivery address below	
		3. Service Type <input checked="" type="checkbox"/> <b>Certified</b>	
		4. Restricted Delivery? (Extra Fee) <input type="checkbox"/> Yes	

PS Form 3811

7:50 AM 9/18/2003

Domestic Return Receipt Code: Brown 1005

File:

2. Article Number		COMPLETE THIS SECTION ON DELIVERY	
1. Article Addressee <b>McElvaine Oil &amp; Gas Properties</b> Attn: Carl R. McElvaine 1050 17th Street, Ste 1800 1050 17th Street, Ste 1800 Denver, CO 80236		A. Signature <b>X</b> <i>[Signature]</i>	<input type="checkbox"/> Agent <input type="checkbox"/> Addressee
		B. Received by (Printed Name)	C. Date of Delivery
		D. Is delivery address different from item 1? <input type="checkbox"/> Yes If YES enter delivery address below	
		3. Service Type <input checked="" type="checkbox"/> <b>Certified</b>	
		4. Restricted Delivery? (Extra Fee) <input type="checkbox"/> Yes	

PS Form 3811

1:11 PM 9/16/2003

Domestic Return Receipt Code: FTC HPA Initial

File:

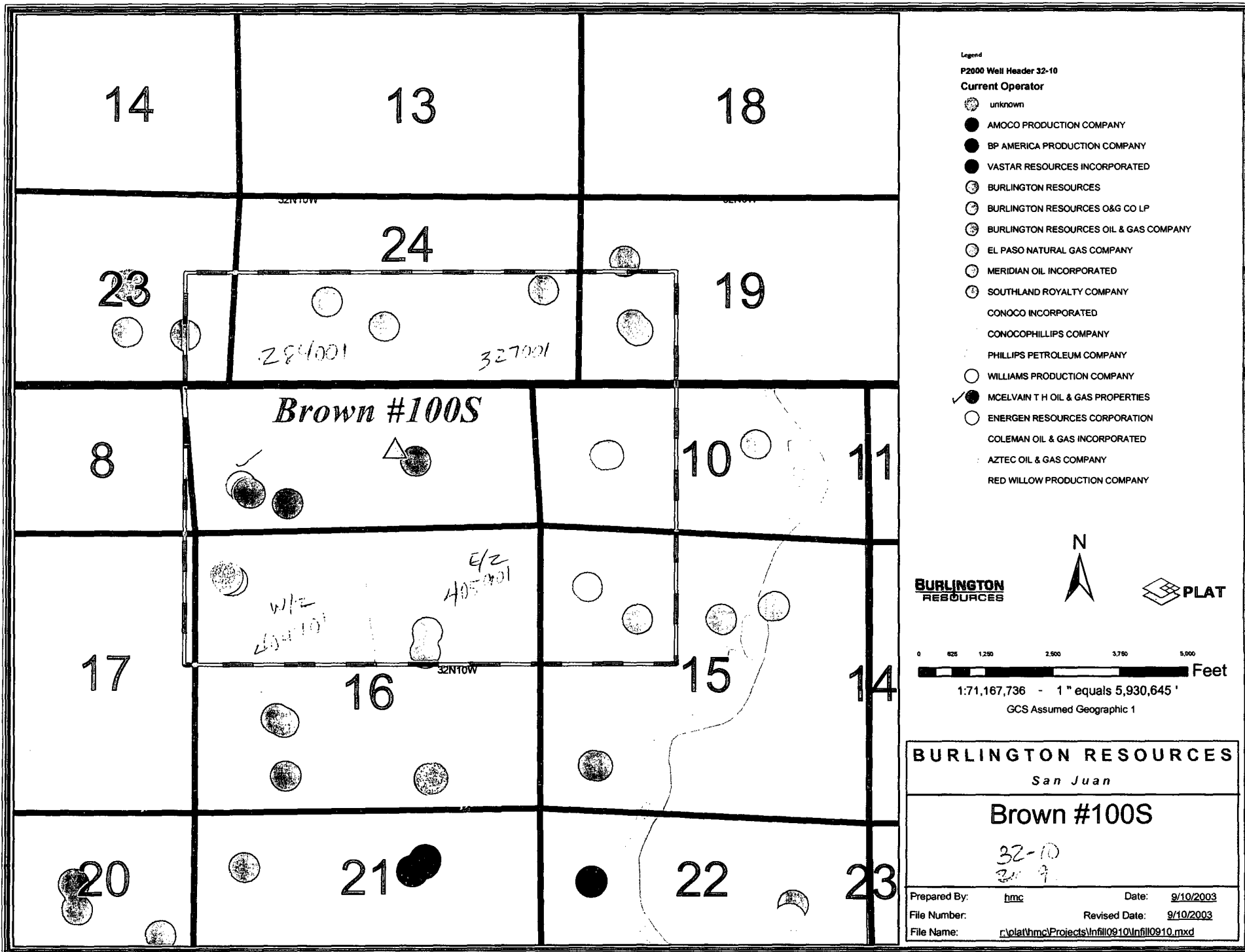

Legend

P2000 Well Header 32-10

Current Operator

- unknown
- AMOCO PRODUCTION COMPANY
- BP AMERICA PRODUCTION COMPANY
- VASTAR RESOURCES INCORPORATED
- BURLINGTON RESOURCES
- BURLINGTON RESOURCES O&G CO LP
- BURLINGTON RESOURCES OIL & GAS COMPANY
- EL PASO NATURAL GAS COMPANY
- MERIDIAN OIL INCORPORATED
- SOUTHLAND ROYALTY COMPANY
- CONOCO INCORPORATED
- CONOCOPHILLIPS COMPANY
- PHILLIPS PETROLEUM COMPANY
- WILLIAMS PRODUCTION COMPANY
- ✓ ● MCELVAIN T H OIL & GAS PROPERTIES
- ENERGEN RESOURCES CORPORATION
- COLEMAN OIL & GAS INCORPORATED
- AZTEC OIL & GAS COMPANY
- RED WILLOW PRODUCTION COMPANY

**BURLINGTON**  
RESOURCES



**PLAT**

0 625 1,250 2,500 3,750 5,000  
Feet  
1:71,167,736 - 1" equals 5,930,645'  
GCS Assumed Geographic 1

**BURLINGTON RESOURCES**

San Juan

**Brown #100S**

32-10  
20 9

Prepared By:	hmc	Date:	9/10/2003
File Number:		Revised Date:	9/10/2003
File Name:	r:\plat\hmc\Projects\Infill0910\Infill0910.mxd		

