

Submit 3 Copies To Appropriate District
Office
District I
1625 N French Dr, Hobbs, NM 87240
District II
1301 W. Grand Ave, Artesia, NM 88210
District III
1000 Rio Brazos Rd., Aztec, NM 87410
District IV
1220 S. St. Francis Dr., Santa Fe, NM
87505

State of New Mexico
Energy, Minerals and Natural Resources

OIL CONSERVATION DIVISION
1220 South St. Francis Dr.
Santa Fe, NM 87505

4-26-2010
Form C-103
June 19, 2008

WELL API NO.
30-045-34290

5. Indicate Type of Lease
STATE ☐ FEE ☒

6. State Oil & Gas Lease No.

7. Lease Name or Unit Agreement Name:

8. Well Number
SNYDER GAS COM B #1N

9. OGRID Number
5380

10. Pool name or Wildcat
BASIN DK/BLANCO MV

11. Elevation (Show whether DR, RKB, RT, GR, etc.)
5547'

SUNDRY NOTICES AND REPORTS ON WELLS
(DO NOT USE THIS FORM FOR PROPOSALS TO DRILL OR TO DEEPEN OR PLUG BACK TO A
DIFFERENT RESERVOIR. USE "APPLICATION FOR PERMIT" (FORM C-101) FOR SUCH
PROPOSALS.)

1. Type of Well:
Oil Well ☐ Gas Well ☒ Other

2. Name of Operator
XTO ENERGY INC.

3. Address of Operator
382 CR 3100 AZTEC, NM 87410

4. Well Location
Unit Letter K : 1980 feet from the SOUTH line and 1125 feet from the WEST line
Section 19 Township 29N Range 9W NMPM NMPM County SAN JUAN

11. Elevation (Show whether DR, RKB, RT, GR, etc.)
5547'

12. Check Appropriate Box to Indicate Nature of Notice, Report, or Other Data

NOTICE OF INTENTION TO:

SUBSEQUENT REPORT OF:

PERFORM REMEDIAL WORK <input type="checkbox"/>	PLUG AND ABANDON <input type="checkbox"/>	REMEDIAL WORK <input type="checkbox"/>	ALTERING CASING <input type="checkbox"/>
TEMPORARILY ABANDON <input type="checkbox"/>	CHANGE PLANS <input type="checkbox"/>	COMMENCE DRILLING OPNS. <input type="checkbox"/>	P AND A <input type="checkbox"/>
PULL OR ALTER CASING <input type="checkbox"/>	MULTIPLE COMPL <input type="checkbox"/>	CASING/CEMENT JOB <input type="checkbox"/>	
DOWNHOLE COMMINGLE <input type="checkbox"/>			
OTHER: <input type="checkbox"/>		OTHER: UPDATED MANCOS PLAT <input checked="" type="checkbox"/>	

13. Describe proposed or completed operations. (Clearly state all pertinent details, and give pertinent dates, including estimated date of starting any proposed work). SEE RULE 1103. For Multiple Completions: Attach wellbore diagram of proposed completion or recompletion.

Please see the attached revised plat per Order No. B-12984 effective 9/3/2008.

RCVD APR 27 '10

OIL CONS. DIV.

DIST. 3

Spud Date:

Rig Release Date:

I hereby certify that the information above is true and complete to the best of my knowledge and belief.

SIGNATURE Lorri D. Bingham TITLE REGULATORY ANALYST DATE 07/28/09
Type or print name LORRI D. BINGHAM E-mail address: Lorri_bingham@xtoenergy.com PHONE 505-333-3100

For State Use Only

APPROVED BY _____ TITLE _____ DATE _____
Conditions of Approval (if any):

AZ

RCVD JUN 23 '10

OIL CONS. DIV.
DIST. 3

Form C-102

Revised October 19, 2009
Submit one copy to appropriate
District Office

District I
1625 N. French Dr., Hobbs, NM 88240
District II
811 South First, Artesia, NM 88210
District III
1000 Rio Brazos Rd., Aztec, NM 87410
District IV
1220 S. St. Francis Dr., Santa Fe, NM 87505

State of New Mexico
Energy, Minerals & Natural Resources Department
OIL CONSERVATION DIVISION
1220 South St. Francis Dr.
Santa Fe, NM 87505

☒ AMENDED REPORT

WELL LOCATION AND ACREAGE DEDICATION PLAT

¹ API Number 30-045-34290		² Pool Code 97232		³ Pool Name BASIN MANCOS	
⁴ Property Code 22816		⁵ Property Name SNYDER GAS COM B			⁶ Well Number 1N
⁷ OGRID No. 5380		⁸ Operator Name XTO Energy, Inc.			⁹ Elevation 5547'

¹⁰ Surface Location

UL or lot no.	Section	Township	Range	Lot Idn	Feet from the	North/South line	Feet from the	East/West line	County
K	19	29N	9W		1980	SOUTH	1125	WEST	SAN JUAN

¹¹ Bottom Hole Location If Different From Surface

UL or lot no.	Section	Township	Range	Lot Idn	Feet from the	North/South line	Feet from the	East/West line	County
SAME									

¹² Dedicated Acres MC: 262.81 acres	¹³ Joint or Infill	¹⁴ Consolidation Code	¹⁵ Order No.
---	-------------------------------	----------------------------------	-------------------------

NO ALLOWABLE WILL BE ASSIGNED TO THIS COMPLETION UNTIL ALL INTERESTS HAVE BEEN CONSOLIDATED OR A NON-STANDARD UNIT HAS BEEN APPROVED BY THE DIVISION

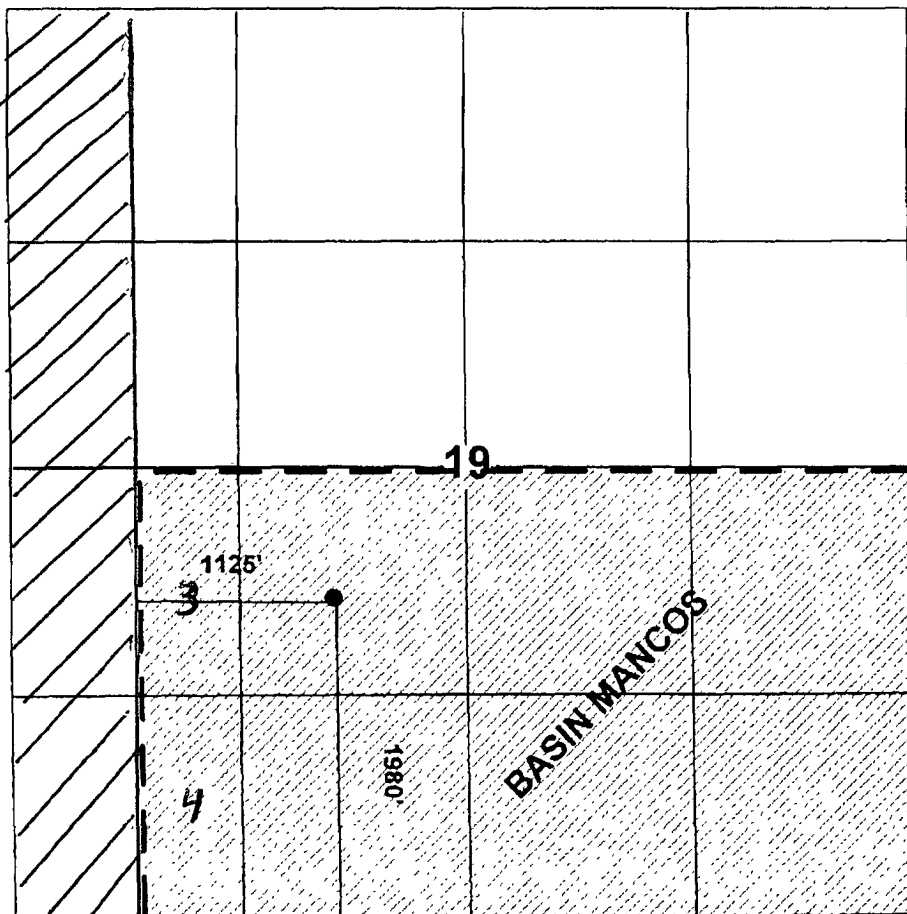

¹⁷ OPERATOR CERTIFICATION	
I hereby certify that the information contained herein is true & complete to the best of my knowledge & belief and that this organization either owns a working interest or unleased mineral interest in the land including the proposed bottom hole location or has a right to drill this well at this location pursuant to a contract with an owner of such a mineral or working interest, or to a voluntary pooling agreement or a compulsory pooling order heretofore entered by the division	
Signature	
Printed Name	LORRI BINGHAM
Title	REGULATORY ANALYST
Date	6/23/10
¹⁸ SURVEYOR CERTIFICATION	
I hereby certify that the well location shown on this plat was plotted from field notes of actual surveys made by me or under my supervision, and that the same is true & correct to the best of my belief.	
Date of Survey	6/23/1984
Original Survey Signed By:	John A. Vukonich
Certificate Number	14831