

UNITED STATES
DEPARTMENT OF THE INTERIOR
GEOLOGICAL SURVEY

30031-05135

APPLICATION FOR PERMIT TO DRILL, DEEPEN, OR PLUG BACK

1a. TYPE OF WORK
 DRILL DEEPEN PLUG BACK

b. TYPE OF WELL
 OIL WELL GAS WELL OTHER
 SINGLE ZONE MULTIPLE ZONE

2. NAME OF OPERATOR
Whigham Drilling Co., Inc.

3. ADDRESS OF OPERATOR
P. O. Box 1439, Farmington, New Mexico

4. LOCATION OF WELL (Report location clearly and in accordance with any State requirements.*)
 At surface **2310'S, 1392'E**
 At proposed prod. zone **Same**

14. DISTANCE IN MILES AND DIRECTION FROM NEAREST TOWN OR POST OFFICE*
One mile south of Hespah

15. DISTANCE FROM PROPOSED* LOCATION TO NEAREST PROPERTY OR LEASE LINE, FT. (Also to nearest drlg. line, if any)
330'

16. NO. OF ACRES IN LEASE
902.49

17. NO. OF ACRES ASSIGNED TO THIS WELL
40

18. DISTANCE FROM PROPOSED LOCATION* TO NEAREST WELL, DRILLING, COMPLETED, OR APPLIED FOR, ON THIS LEASE, FT.
1320'

19. PROPOSED DEPTH
1650

20. ROTARY OR CABLE TOOLS
Rotary

21. ELEVATIONS (Show whether DF, RT, GR, etc.)
7013 GR.

22. APPROX. DATE WORK WILL START*
4-1-65

5. LEASE DESIGNATION AND SERIAL NO.
NM 0536034

6. IF INDIAN, ALLOTTEE OR TRIBE NAME

7. UNIT AGREEMENT NAME

8. FARM OR LEASE NAME
CTV Hespah "A"

9. WELL NO.
2

10. FIELD AND POOL, OR WILDCAT
Hespah

11. SEC., T., R., M., OR BLK. AND SURVEY OR AREA
Sec. 12, T 17 N, R 9 W

12. COUNTY OR PARISH
McKinley

13. STATE
New Mexico

23. PROPOSED CASING AND CEMENTING PROGRAM

SIZE OF HOLE	SIZE OF CASING	WEIGHT PER FOOT	SETTING DEPTH	QUANTITY OF CEMENT
8 3/4	7"	17.00	30'	10 sacks
6 1/4	4 1/2"	9.5	1650'	60 sacks

It is intended to drill to 1650' with mud as a circulating medium. Set 4 1/2" casing through the Hespah-Gallup and perforate.

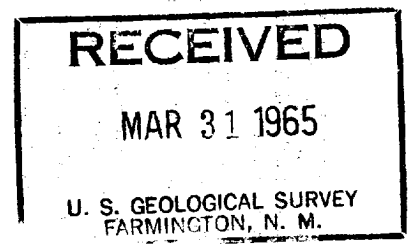

IN ABOVE SPACE DESCRIBE PROPOSED PROGRAM: If proposal is to deepen or plug back zone. If proposal is to drill or deepen directionally, give pertinent data on subsurface data on present productive zone and proposed new productive locations and measured and true vertical depths. Give blowout preventer program, if any.

24. SIGNED *Gene M. Romney* TITLE **Petroleum Geologist** DATE **3-31-65**

(This space for Federal or State office use)

PERMIT NO. _____ APPROVAL DATE _____

APPROVED BY _____ TITLE _____ DATE _____

CONDITIONS OF APPROVAL, IF ANY:

OK

Instructions

General: This form is designed for submitting proposals to perform certain well operations, as indicated, on all types of lands and leases for appropriate action by either a Federal or a State agency, or both, pursuant to applicable Federal and/or State laws and regulations. Any necessary special instructions concerning the use of this form and the number of copies to be submitted, particularly with regard to local, area, or regional procedures and practices, either are shown below or will be issued by, or may be obtained from, the local Federal and/or State office.

Item 1: If the proposal is to redrill to the same reservoir at a different subsurface location or to a new reservoir, use this form with appropriate notations. Consult applicable State or Federal regulations concerning subsequent work proposals or reports on the well.

Item 4: If there are no applicable State requirements, locations on Federal or Indian land should be described in accordance with Federal requirements. Consult local State or Federal office for specific instructions.

Item 14: Needed only when location of well cannot readily be found by road from the land or lease description. A plat, or plats, separate or on this reverse side, showing the roads to, and the surveyed location of, the well, and any other required information, should be furnished when required by Federal or State agency offices.

Items 15 and 18: If well is to be, or has been directionally drilled, give distances for subsurface location of hole in any present or objective production zone.

Item 22: Consult applicable Federal or State regulations, or appropriate officials, concerning approval of the proposal before operations are started.

NEW MEXICO OIL CONSERVATION COMMISSION
WELL LOCATION AND ACREAGE DEDICATION PLAT

SECTION A.

DATE 3-11-65

OPERATOR Whigham Drilling Co., Inc. LEASE CTV Hospah "A"
 WELL NO. 2 UNIT LETTER I SECTION 12 TOWNSHIP 17 North RANGE 9 West NMPM
 LOCATED 2310 FEET FROM South LINE, ~~1392~~ 1391 FEET FROM East LINE
 COUNTY Mc Kinley G. L. ELEVATION 7013 DEDICATED ACREAGE 10 ACRES
 NAME OF PRODUCING FORMATION Hospah-Gallup POOL Hospah

1. IS THE OPERATOR THE ONLY OWNER* IN THE DEDICATED ACREAGE OUTLINED ON THE PLAT BELOW? YES NO
2. IF THE ANSWER TO QUESTION ONE IS "NO," HAVE THE INTERESTS OF ALL THE OWNERS BEEN CONSOLIDATED BY COMMUNITIZATION AGREEMENT OR OTHERWISE? YES NO IF ANSWER IS "YES," TYPE OF CONSOLIDATION: _____
3. IF THE ANSWER TO QUESTION TWO IS "NO," LIST ALL THE OWNERS AND THEIR RESPECTIVE LAND INTERESTS BELOW:

OWNER

LAND



SECTION B.

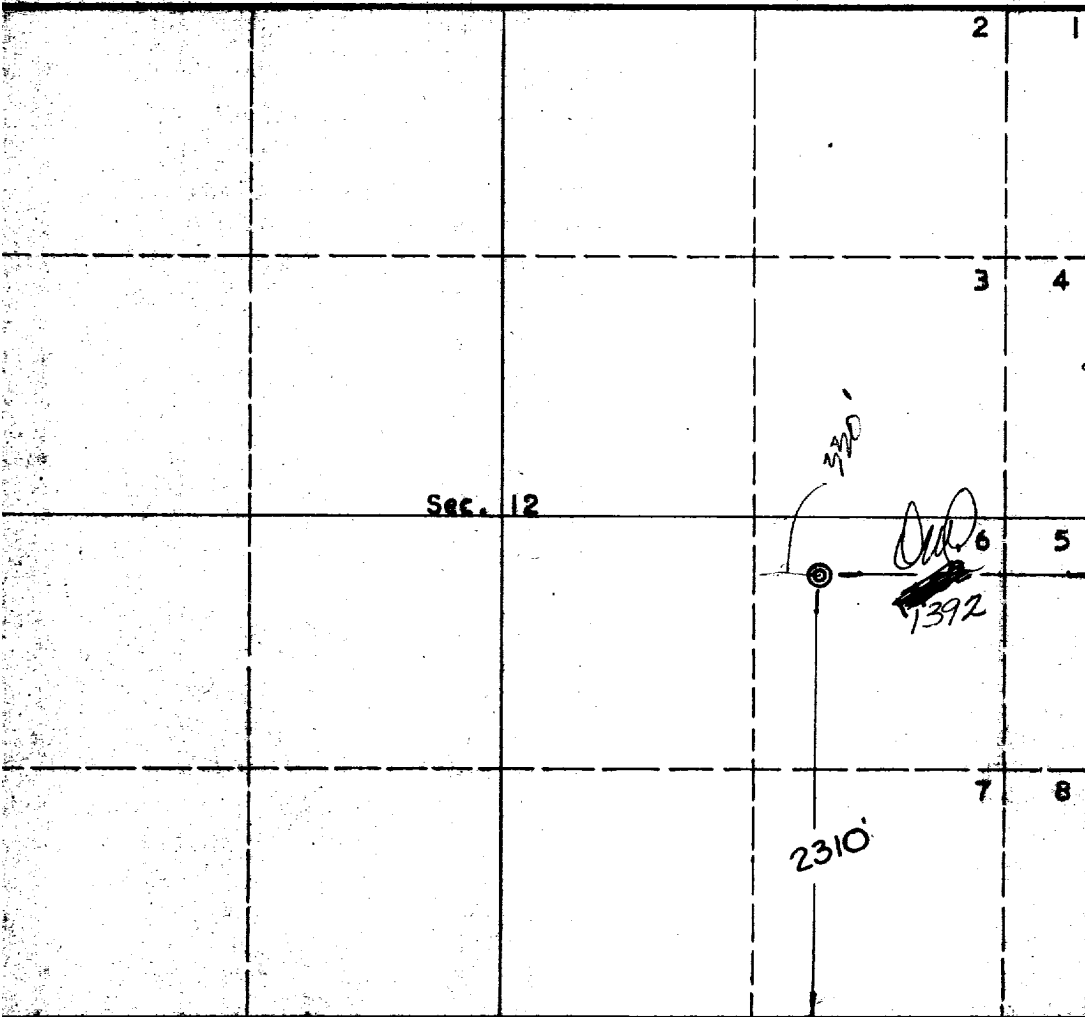

THIS IS TO CERTIFY THAT THE INFORMATION IN SECTION A ABOVE IS TRUE AND COMPLETE TO THE BEST OF MY KNOWLEDGE AND BELIEF.

Whigham Drilling Co., Inc.
(OPERATOR)

Dave M. Shannon
(REPRESENTATIVE)

P. O. Box 1439
Farmington, New Mexico

REGISTERED LAND
 STATE ENGINEER
 REG. NO. 3602
 THIS IS TO CERTIFY THAT THE LOCATION OF THE WELL PLOTTED IN SECTION B WAS PLOTTED FROM FIELD NOTES OF ACTUAL SURVEYS MADE BY ME OR UNDER MY SUPERVISION AND THAT THE SAME ARE TRUE AND CORRECT TO THE BEST OF MY KNOWLEDGE AND BELIEF.

DATE SURVEYED March 11, 1965

FOUR STATES ENGINEERING CO.

FARMINGTON, NEW MEXICO

Donald C. Cochran
REGISTERED ENGINEER OR LAND SURVEYOR

CERTIFICATE NO. 3602

