

(SUBMIT IN TRIPLICATE)

UNITED STATES
DEPARTMENT OF THE INTERIOR
GEOLOGICAL SURVEY

Land Office Santa Fe, NM.
Lease No. NM.040742
Unit _____

SUNDRY NOTICES AND REPORTS ON WELLS

NOTICE OF INTENTION TO DRILL	<input checked="" type="checkbox"/>	SUBSEQUENT REPORT OF WATER SHUT-OFF
NOTICE OF INTENTION TO CHANGE PLANS		SUBSEQUENT REPORT OF SHOOTING OR ACIDIZING
NOTICE OF INTENTION TO TEST WATER SHUT-OFF		SUBSEQUENT REPORT OF ALTERING CASING
NOTICE OF INTENTION TO RE-DRILL OR REPAIR WELL		SUBSEQUENT REPORT OF RE-DRILLING OR REPAIR
NOTICE OF INTENTION TO SHOOT OR ACIDIZE		SUBSEQUENT REPORT OF ABANDONMENT
NOTICE OF INTENTION TO PULL OR ALTER CASING		SUPPLEMENTARY WELL HISTORY
NOTICE OF INTENTION TO ABANDON WELL		

(INDICATE ABOVE BY CHECK MARK NATURE OF REPORT, NOTICE, OR OTHER DATA)

October 29, 1960

Well No. R&S Fed. #7 is located 3630 ft. from 3833 ft. from [N] line and 990 ft. from [E] line of sec. 2
NE/4 of the SE/4 17 North 11 West N.M.P.M.
(1/4 Sec. and Sec. No.) (Twp.) (Range) (Meridian)
Wildcat Mckinley County New Mexico
(Field) (County or Subdivision) (State or Territory)

The elevation of the derrick floor above sea level is 6681.7 ft.

DETAILS OF WORK

(State names of and expected depths to objective sands; show sizes, weights, and lengths of proposed casing; indicate mudding jobs, cementing points, and all other important proposed work.)

Will drill with rotary tools to approximately 1200 feet
to test the Hospah formation.

Surface	-----	Mancos
450 Ft.	-----	Dalton
1050 Ft.	-----	Hospah
1200 Ft.	-----	T.D.

Surface casing - 50 feet 4-5/8" cemented to surface.

I understand that this plan of work must receive approval in writing by the Geological Survey before operations may be commenced.

Company George Sountarich
Address 121 Valley Drive, Santa Fe, NM.

By George Sountarich
Title Operator

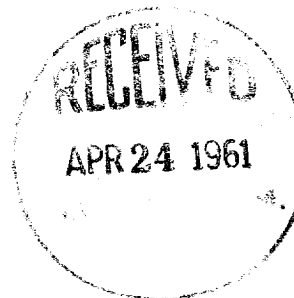

NEW MEXICO OIL CONSERVATION COMMISSION
WELL LOCATION AND ACREAGE DEDICATION PLAT

FORM C-12B
Revised 5/1/57

SEE INSTRUCTIONS FOR COMPLETING THIS FORM ON THE REVERSE SIDE

SECTION A

Operator George Semutovitch		Lease NM 040742		Well No. 7
Unit Letter George	Section 2	Township 17N	Range 11 W	County McKinley County, New Mexico
Actual Footage Location of Well: feet from the 3630 North line and 990 feet from the East line Sec. 2				
Ground Level Elev. 6601.	Producing Formation Wildcat	Pool 990	Dedicated Acreage: Acres	

1. Is the Operator the only owner in the dedicated acreage outlined on the plat below? YES _____ NO _____. ("Owner" means the person who has the right to drill into and to produce from any pool and to appropriate the production either for himself or for himself and another. (65-3-29 (e) NMSA 1935 Comp.)
2. If the answer to question one is "no," have the interests of all the owners been consolidated by communitization agreement or otherwise? YES _____ NO _____. If answer is "yes," Type of Consolidation _____
3. If the answer to question two is "no," list all the owners and their respective interests below:

Owner	Land Description
	SW/4, NE/4, SE/4, Sec. 2, 17N, 11W

SECTION B

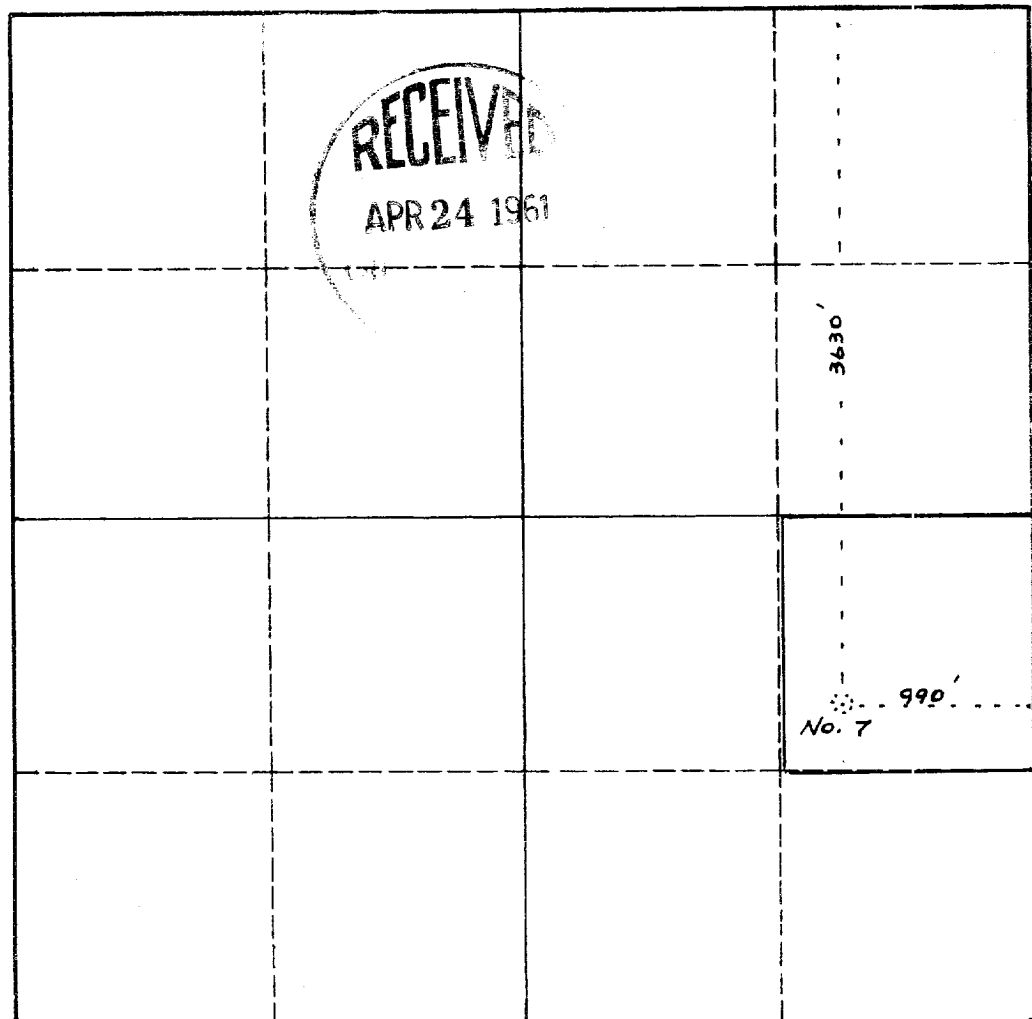

CERTIFICATION

I hereby certify that the information in SECTION A above is true and complete to the best of my knowledge and belief.

Name **George Semutovitch**
Position **Operator**
Company **Individual**
Date **April 13, 1961**

I hereby certify that the well location shown on the plat in SECTION B was plotted from field notes of actual surveys made by me or under my supervision, and that the same is true and correct to the best of my knowledge and belief.

Date Surveyed
Registered Professional Engineer and/or Land Surveyor

H. H. H. H.
Certificate No. **3082**

0 330 660 990 1320 1650 1980 2310 2640 2000 1500 1000 500 0

INSTRUCTIONS FOR COMPLETION OF FORM C-128

1. Operator shall furnish and certify to the information called for in Section A.
2. Operator shall outline the dedicated acreage for *both* oil and gas wells on the plat in Section B.
3. A registered professional engineer or land surveyor registered in the State of New Mexico or approved by the Commission shall show on the plat the location of the well and certify this information in the space provided.
4. All distances shown on the plat must be from the outer boundaries of the Section.
5. If additional space is needed for listing owners and their respective interests as required in question 3 of Section A, please use space below.