

NO. OF COPIES RECEIVED	5
DISTRIBUTION	
SANTA FE	1
FILE	1
U.S.G.S.	2
LAND OFFICE	
OPERATOR	1

NEW MEXICO OIL CONSERVATION COMMISSION

Form C-101
Revised 1-1-65 30 631-200 11

5A. Indicate Type of Lease	
STATE <input type="checkbox"/>	FEE <input checked="" type="checkbox"/>
5. State Oil & Gas Lease No.	

APPLICATION FOR PERMIT TO DRILL, DEEPEN, OR PLUG BACK

1a. Type of Work		7. Unit Agreement Name	
b. Type of Well OIL WELL <input type="checkbox"/> GAS WELL <input type="checkbox"/> OTHER <input type="checkbox"/>		8. Farm or Lease Name RED MOUNTAIN	
2. Name of Operator DAVIS OIL COMPANY		9. Well No. #1	
3. Address of Operator 1230 Denver Club Building - Denver, Colorado 80202		10. Field and Pool, or Wildcat Wildcat	
4. Location of Well UNIT LETTER D LOCATED 660 FEET FROM THE North LINE AND 660 FEET FROM THE West LINE OF SEC. 31 TWP. 20N RGE. 9W NMPM		12. County McKinley	
13. Proposed Depth 4000'		19A. Formation Morrison	
21. Elevations (Show whether DF, RT, etc.) 6390 GR		20. Rotary or C.T. Rotary	
21A. Kind & Status Plug. Bond Blanket		22. Approx. Date Work will start 4-18-71	

PROPOSED CASING AND CEMENT PROGRAM

SIZE OF HOLE	SIZE OF CASING	WEIGHT PER FOOT	SETTING DEPTH	SACKS OF CEMENT	EST. TOP
12 1/2"	8 5/8"	24#	60'	cmtd. to surf.	
If production string is run, it will be 5 1/2" thru producing zone, cemented to					displace 600'

LOGGING: Induction Electrical Survey and BHC Formation Density log with Gamma Ray from base of surface casing to total depth. BHC Sonic log with Caliper over the Dakota formation and other zones of interest to a maximum of 1500' of interval logged.

MUD PROGRAM: Fresh water native mud which will be converted to a 10 cc water loss or less chemical base mud for drilling the Dakota.

Good oil field practice will be used in determining the necessity of coring and/or drill stem testing any shows of oil or gas encountered.

APPROVAL VALID
FOR 90 DAYS UNLESS
DRILLING COMMENCED,

IN ABOVE SPACE DESCRIBE PROPOSED PROGRAM: IF PROPOSED IS TO DEEPEN OR PLUG BACK, GIVE DATA ON PRESENT PRODUCTION ZONE AND PROPOSED NEW PRODUCTION ZONE. GIVE BLOWOUT PREVENTER PROGRAM, IF ANY.

I hereby certify that the information above is true and complete to the best of my knowledge and belief.

Signed John Bergant Title Geological Assistant

(This space for State Use)

APPROVED BY Art Kendrick PETROLEUM ENGINEER DIST. NO. 3
CONDITIONS OF APPROVAL, IF ANY:

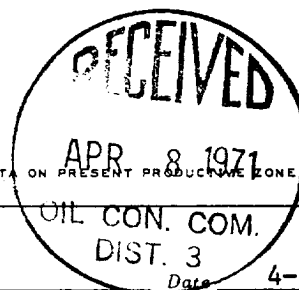

DATE 4-8-71

**NEW MEXICO OIL CONSERVATION COMMISSION
WELL LOCATION AND ACERAGE DEDICATION PLAT**

All distances must be from the outer boundaries of the Section

Order: **DAVIS OIL COMPANY** **RED MOUNTAIN** Well No. **1**
 Unit: **D** Section: **31** Township: **20 NORTH** Range: **9 WEST** County: **Mc KINLEY**
 Actual Footage Location of Well: **660** feet from the **NORTH** line **660** feet from the **WEST** line
 Ground Elevation: **6390.0** **Cretaceous** **Wildcat** Depth: **40** Acres: **NP**
 Outline the acreage dedicated to the subject well by colored pencil or hatchure marks on the plat below.

2. If more than one lease is dedicated to the well, outline each one and identify the ownership thereof (both as to working interest and royalty).

3. If more than one lease of different ownership is dedicated to the well have the interests of all owners been consolidated by communitization, unitization, force-pooling, etc?

Yes ☐ No ☐ If answer is "Yes," type of consolidation _____

If answer is "no" list the owners and tract descriptions which have actually consolidated. (Use reverse side of this form if necessary) _____

No allowable will be assigned to the well until all interests have been consolidated (by communitization, unitization, forced-pooling, or otherwise) or until a non standard unit, eliminating such interests, has been approved by the Commission

CERTIFICATION

I hereby certify that the information contained herein is true and complete to the best of my knowledge and belief.

Paul Messinger
Name

Exploration Manager
Position

Davis Oil Company
Company

4-6-71
Date

Paul Messinger

I hereby certify that the well location shown on this plat was plotted from field notes of actual surveys made by me or under my supervision, and that the same is true and correct to the best of my knowledge and belief.

30 March, 1971
Date

James P. Lee
Registered Professional Engineer
and/or Land Surveyor

JAMES P. LEESE

1463

Certificate No.

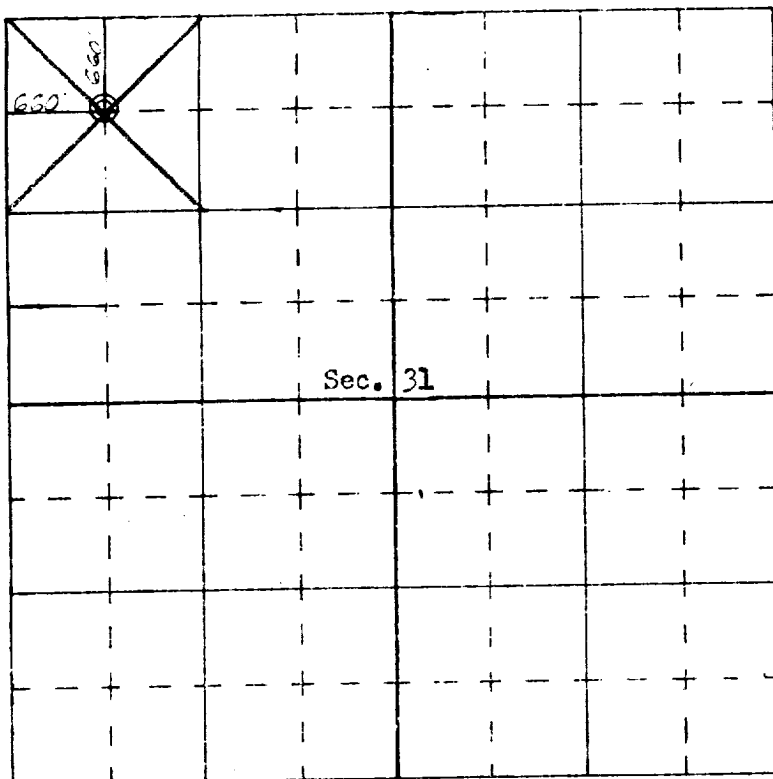

SCALE—4 INCHES EQUALS 1 MILE

SAN JUAN ENGINEERING COMPANY, FARMINGTON, N. M.