

| | |
|------------------------|---|
| NO. OF COPIES RECEIVED | 5 |
| DISTRIBUTION | |
| SANTA FE | 1 |
| FILE | 1 |
| U.S.G.S. | 2 |
| LAND OFFICE | |
| OPERATOR | 1 |

NEW MEXICO OIL CONSERVATION COMMISSION

Form C-101
Revised 1-1-65 30-031-20219

| | |
|--------------------------------|---|
| 5A. Indicate Type of Lease | |
| STATE <input type="checkbox"/> | FEE <input checked="" type="checkbox"/> |
| 5. State Oil & Gas Lease No. | |

APPLICATION FOR PERMIT TO DRILL, DEEPEN, OR PLUG BACK

| | | | | | |
|--|--|--|--|--|--|
| 1a. Type of Work b. Type of Well OIL WELL <input type="checkbox"/> GAS WELL <input type="checkbox"/> OTHER <input type="checkbox"/> | | DRILL <input checked="" type="checkbox"/> DEEPEN <input type="checkbox"/> PLUG BACK <input type="checkbox"/> | | 7. Unit Agreement Name | |
| 2. Name of Operator DAVIS OIL COMPANY | | SINGLE ZONE <input type="checkbox"/> MULTIPLE ZONE <input type="checkbox"/> | | 8. Farm or Lease Name CHACRA MESA | |
| 3. Address of Operator 1230 Denver Club Building - Denver, Colorado 80202 | | | | 9. Well No. #1 | |
| 4. Location of Well UNIT LETTER B LOCATED 660 FEET FROM THE North LINE AND 1980 FEET FROM THE East LINE OF SEC. 18 TWP. 19N RGE. 6W NMPM | | | | 10. Field and Pool, or Wildcat Wildcat | |
| | | | | 11. County McKinley | |
| | | 12. Proposed Depth 4500' | | 13. Formation Morrison | |
| | | | | 14. Rotary or C.T. Rotary | |
| 21. Elevations (Show whether Dr, RI, etc.) 6793 GR | | 21A. Kind & Status Plug. Bond Blanket Bond | | 21B. Drilling Contractor Allison Drilling Co. | |
| | | | | 22. Approx. Date Work will start Rig Availability | |

PROPOSED CASING AND CEMENT PROGRAM

| SIZE OF HOLE | SIZE OF CASING | WEIGHT PER FOOT | SETTING DEPTH | SACKS OF CEMENT | EST. TOP |
|---|----------------|-----------------|---------------|-----------------|----------|
| 12 1/4" | 8 5/8" | 24# | 60' | cmd. to surf. | |
| If oil string is run, it will be 5 1/2" thru producing zone, cemented to displace 600'. | | | | | |

LOGGING: Induction Electrical Survey and BHC Formation Density log with Gamma Ray from base of surface casing to total depth. BHC Sonic log with Caliper over the Dakota formation.

MUD PROGRAM: Fresh water native mud which will be converted to a 10 cc water loss or less chemical base mud for drilling the Dakota.

Good oil field practice will be used in determining the necessity of coring and/or drill stem testing any shows of oil or gas encountered.

APPROVAL VALID
FOR 90 DAYS UNLESS
DRILLING COMMENCED,

EXPIRES 2-16-72

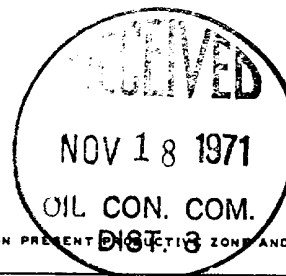

IN ABOVE SPACE DESCRIBE PROPOSED PROGRAM; IF PROPOSAL IS TO DEEPEN OR PLUG BACK, GIVE DATA ON PRESENT PRODUCTION ZONE AND PROPOSED NEW PRODUCTIVE ZONE. GIVE BLOWOUT PREVENTER PROGRAM, IF ANY.

I hereby certify that the information above is true and complete to the best of my knowledge and belief.

Signed Geological Assistant Title Geological Assistant Date 11-16-71

(This space for State Use)

APPROVED BY George A. Cawel TITLE Sup. Unit IV DATE 11-18-71

CONDITIONS OF APPROVAL, IF ANY:

NEW MEXICO OIL CONSERVATION COMMISSION

WELL LOCATION AND ACERAGE DEDICATION PLAT

All distances must be from the outer boundaries of the Section

| | | | | |
|-----------------------------------|---------------------------------------|--------------------------|-----------------------------|------------------------|
| Operator DAVIS OIL COMPANY | | Lease CHAORA MESA | | Well No. 1 |
| Unit Letter B | Section 18 | Township 19 NORTH | Range 5 WEST | County MCKINLEY |
| Actual Footage Location of Well | | | | |
| 660 | feet from the NORTH | 1980 | feet from the EAST | line |
| Ground Level Elev. 6793.0 | Producing Formation CRETACEOUS | Pop. WILDCAT | Dedicated acreage 40 | Acres |

Outline the acreage dedicated to the subject well by colored pencil or hatchure marks on the plat below.

2. If more than one lease is dedicated to the well, outline each and identify the ownership thereof (both to working interest and royalty).

3. If more than one lease of different ownership is dedicated to the well, have the interests of all owners been consolidated by communitization, unitization, force-pooling, etc?

Yes ☐ No ☐ If answer is "yes," type of consolidation _____

If answer is "no," list the owners and tract descriptions which have actually consolidated (Use reverse side of this form if necessary) _____

No allowance will be assigned to the well until all interests have been consolidated (by communitization, unitization, forced-pooling, or otherwise) or until a non standard unit, eliminating such interests, has been approved by the Commission.

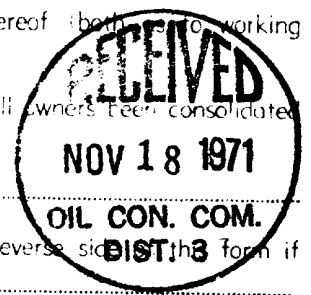

CERTIFICATION

I hereby certify that the information contained herein is true and complete to the best of my knowledge and belief.

Shelia Bergano

Name **Geological Assistant**

Position **Davis Oil Company**

Company **11-15-71**

Date _____

I hereby certify that the well location shown on this plat was plotted from field notes of actual surveys made by me or under my supervision, and that the same is true and correct to the best of my knowledge and belief.

23 August 1971
 Date Surveyed
James P. Lesse
 Registered Professional Engineer
 and/or Land Surveyor
JAMES P. LESSE
1463
 Certificate No.

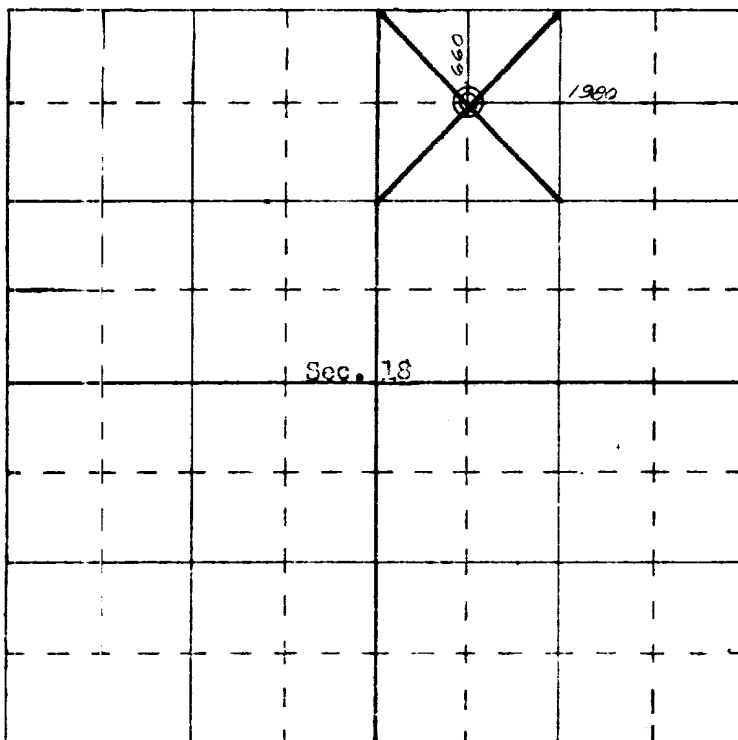

SCALE-4 INCHES EQUALS 1 MILE

SAN JUAN ENGINEERING COMPANY, FARMINGTON, N. M.