

UNITED STATES  
DEPARTMENT OF THE INTERIOR  
GEOLOGICAL SURVEY

## APPLICATION FOR PERMIT TO DRILL, DEEPEN, OR PLUG BACK

1a. TYPE OF WORK

DRILL ☒DEEPEN ☐PLUG BACK ☐

b. TYPE OF WELL

OIL  
WELL ☒GAS  
WELL ☐OTHER ☐SINGLE  
ZONE ☐MULTIPLE  
ZONE ☐

2. NAME OF OPERATOR

**Burr & Cooley**

3. ADDRESS OF OPERATOR

**152 Petroleum Center Bldg., Farmington, New Mex. 87401**

4. LOCATION OF WELL (Report location clearly and in accordance with any State requirements.)\*

At surface

**1690' FWL 330' FWL**

At proposed prod. zone

14. DISTANCE IN MILES AND DIRECTION FROM NEAREST TOWN OR POST OFFICE\*

**Six miles south White Horse Trading Post**

15. DISTANCE FROM PROPOSED\*

LOCATION TO NEAREST

PROPERTY OR LEASE LINE, FT.

(Also to nearest drlg. unit line, if any)

**330'**

18. DISTANCE FROM PROPOSED LOCATION\*

TO NEAREST WELL, DRILLING, COMPLETED,

OR APPLIED FOR, ON THIS LEASE, FT.

**1190'**

16. NO. OF ACRES IN LEASE

**80**

19. PROPOSED DEPTH

**2780'**17. NO. OF ACRES ASSIGNED  
TO THIS WELL**80**

20. ROTARY OR CABLE TOOLS

**Rotary**

21. ELEVATIONS (Show whether DF, RT, GR, etc.)

**6999' GR**

22. APPROX. DATE WORK WILL START\*

**August 5, 1974**

23.

## PROPOSED CASING AND CEMENTING PROGRAM

SIZE OF HOLE	SIZE OF CASING	WEIGHT PER FOOT	SETTING DEPTH	QUANTITY OF CEMENT
<b>12 1/4</b>	<b>8-5/8</b>	<b>20.0</b>	<b>100'</b>	<b>60 sks.</b>
<b>7-7/8</b>	<b>5 1/2</b>	<b>14.0 &amp; 13.5</b>	<b>2820'</b>	<b>225 sks.</b>

It is intended to drill this test through the Dakota "D", run 5 1/2" casing to total depth, selectively perforate, and complete.

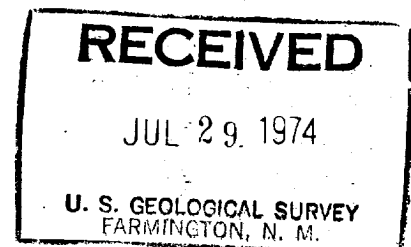

IN ABOVE SPACE DESCRIBE PROPOSED PROGRAM: If proposal is to deepen or plug back, give data on present productive zone and proposed new productive zone. If proposal is to drill or deepen directionally, give pertinent data on subsurface locations and measured and true vertical depths. Give blowout preventer program, if any.

24.

SIGNED

TITLE

**Operator**

DATE

**7/26/74**

(This space for Federal or State office use)

PERMIT NO.

APPROVAL DATE

APPROVED BY

TITLE

DATE

CONDITIONS OF APPROVAL, IF ANY:

\*See Instructions On Reverse Side



NEW MEXICO OIL CONSERVATION COMMISSION  
WELL LOCATION AND ACREAGE DEDICATION PLAT

Form C-102  
Supersedes C-128  
Effective 1-1-65

All distances must be from the outer boundaries of the Section.

Operator <b>BURR &amp; COOLEY</b>		Lease <b>COLEMAN</b>		Well No. <b>1</b>	
Unit Letter <b>C</b>	Section <b>8</b>	Township <b>17 NORTH</b>	Range <b>8 WEST</b>	County <b>McKINLEY</b>	
Actual Footage Location of Well: <b>330</b> feet from the <b>NORTH</b> line and <b>1690</b> feet from the <b>WEST</b> line					
Ground Level Elev. <b>6999.0</b>	Producing Formation <b>DAN D</b>	Pool <b>none fine</b>	Dedicated Acreage: <b>80</b> Acres		

1. Outline the acreage dedicated to the subject well by colored pencil or hatchure marks on the plat below.
2. If more than one lease is dedicated to the well, outline each and identify the ownership thereof (both as to working interest and royalty).
3. If more than one lease of different ownership is dedicated to the well, have the interests of all owners been consolidated by communitization, unitization, force-pooling, etc?

☐ Yes ☐ No If answer is "yes," type of consolidation \_\_\_\_\_

If answer is "no," list the owners and tract descriptions which have actually been consolidated. (Use reverse side of this form if necessary.) \_\_\_\_\_

No allowable will be assigned to the well until all interests have been consolidated (by communitization, unitization, forced-pooling, or otherwise) or until a non-standard unit, eliminating such interests, has been approved by the Commission.

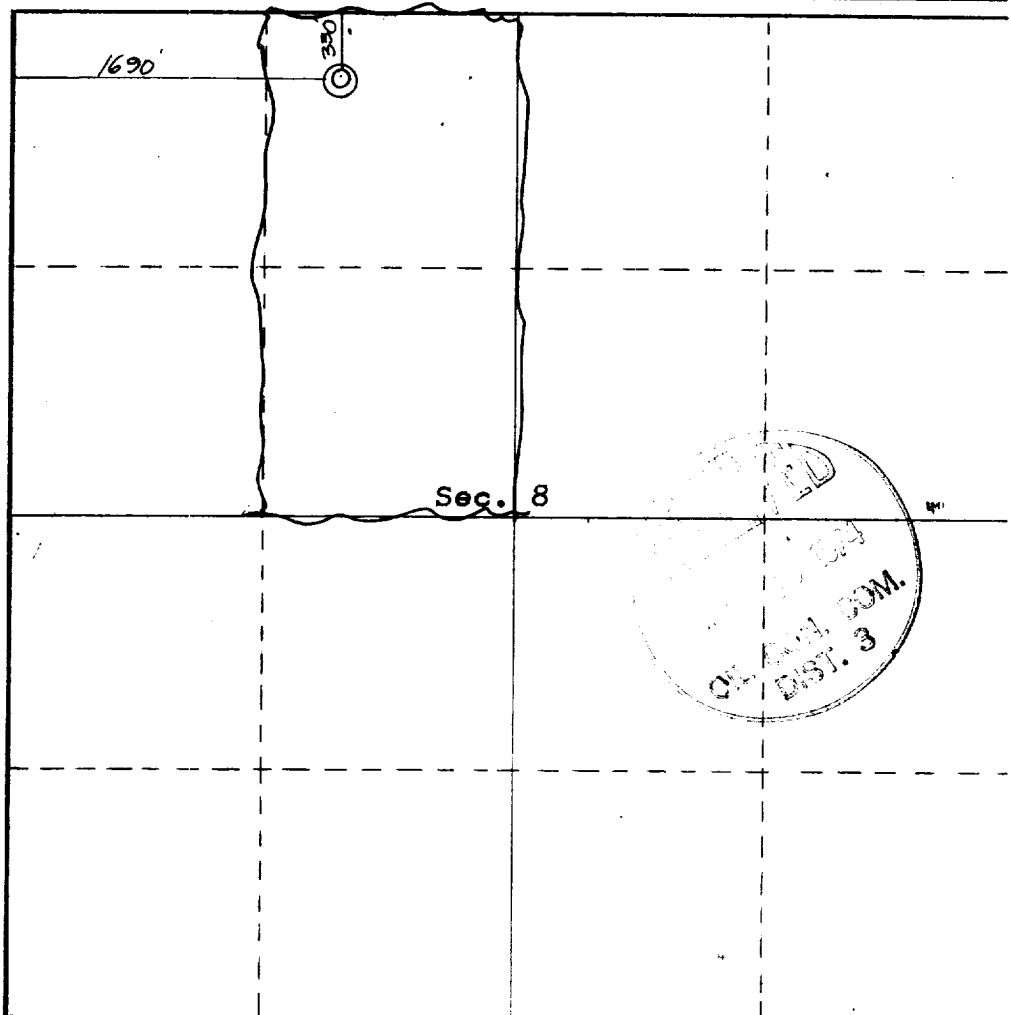

CERTIFICATION

I hereby certify that the information contained herein is true and complete to the best of my knowledge and belief.

Name \_\_\_\_\_

Position \_\_\_\_\_

Company \_\_\_\_\_

Date \_\_\_\_\_

I hereby certify that the well location shown on this plat was plotted from field notes of actual surveys made by me or under my supervision, and that the same is true and correct to the best of my knowledge.

Date Surveyed \_\_\_\_\_

**JAMES P. LEESE**

Registered Professional Engineer

and Land Surveyor

**NEW MEXICO**

**JAMES P. LEESE**

Certificate No. \_\_\_\_\_

0 330 660 990 1320 1650 1980 2310 2640 2000 1500 1000 500



COLEMAN-ANDES DRILLING CO.

P. O. BOX 1915

FARMINGTON, N. M. 87401

PHONE 505 / 325-6692

Front of Rig

Rig #1

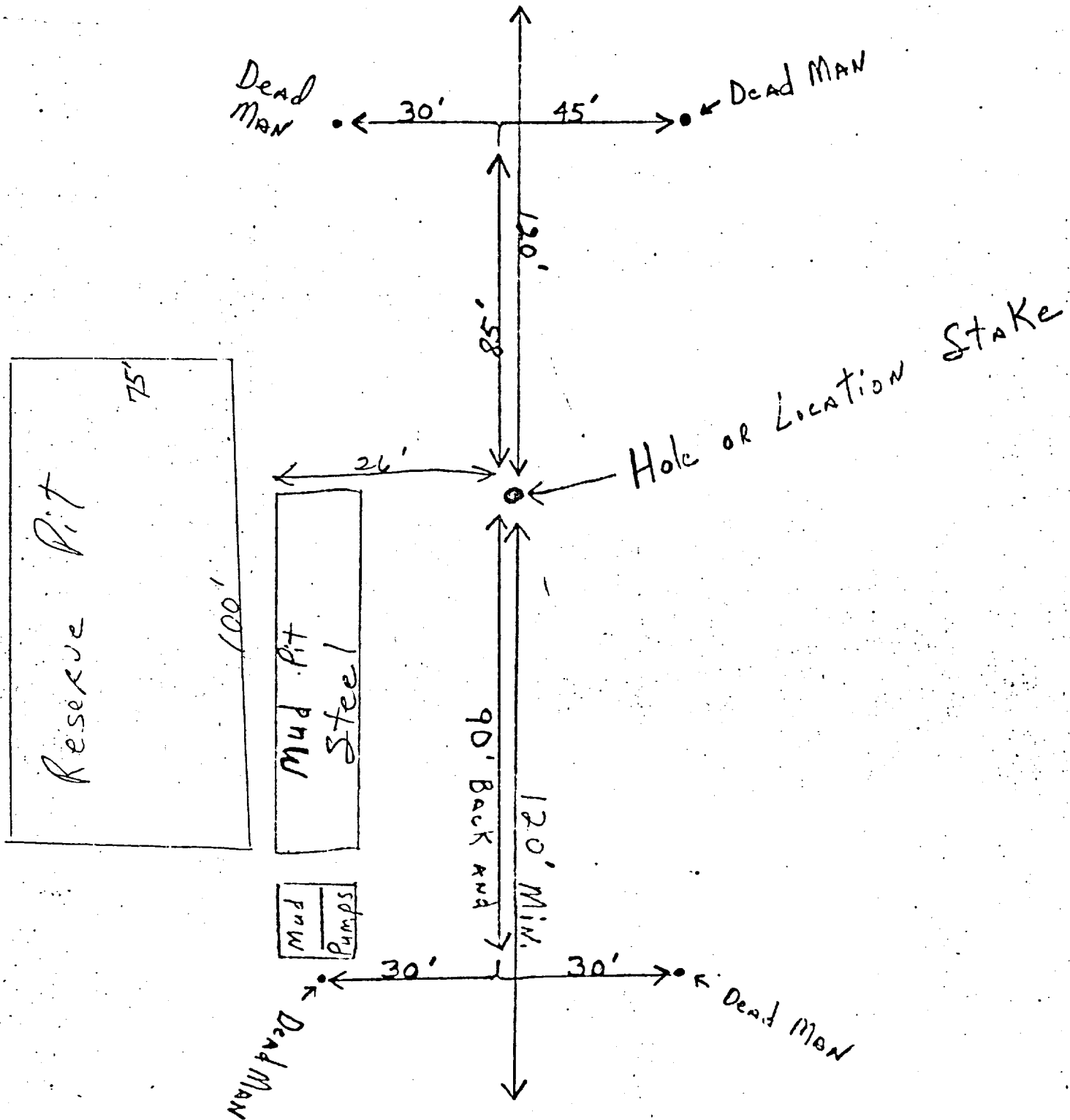

Reserve Pit 150' X 150' X 5' Deep

BURR & COOLEY  
ATTORNEYS AND COUNSELORS AT LAW  
SUITE 152 PETROLEUM CENTER BUILDING  
FARMINGTON, NEW MEXICO  
87401

JOEL B. BURR, JR.  
WM. J. COOLEY

TELEPHONE 325-1702  
AREA CODE 505

July 29, 1974

United States Department of Interior  
Geological Survey  
P. O. Box 959  
Farmington, New Mexico 87401

Att'n: Mr. P. T. McGrath, District Engineer

Re: Development Plan for Surface Use  
Burr & Cooley Coleman Nos. 1 and 2 Wells  
Sec. 8-17N-8W  
Lone Pine Dakota "D" Field  
McKinley County, New Mexico

Gentlemen:

Attached please find Vicinity Map and Well Location Plat in compliance with items 1, 2, 3, 4, 5 and 10 of the Development Plan for surface use.

Water for drilling the locations will be produced water obtained from water disposal pits now in use by Tesoro Petroleum Company within one mile of the proposed drilling sites. Waste material will be disposed of in a waste pit shown on drilling site location plat. Neither camp nor airstrip will be utilized for this project. In the event either well or both should be dry, all pits will be filled, location leveled, and well sites re-seeded in compliance with U.S.G.S. specifications. The well or wells, if productive, will be equipped to facilitate producing operations, with all drilling pits filled, locations leveled and re-seeding of the area not used for day to day operations.

Should you desire further information concerning this matter, please advise.

Very truly yours,

BURR & COOLEY

By

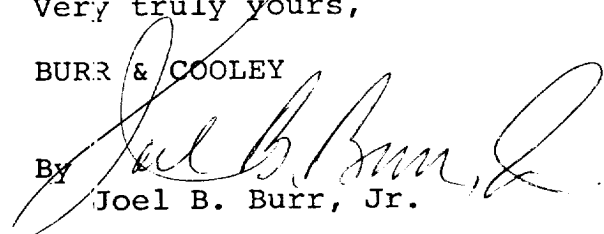
  
Joel B. Burr, Jr.

JBB:jjh