

Check for permit rules
Form 9-331 C
(May 1963)

UNITED STATES
DEPARTMENT OF THE INTERIOR
GEOLOGICAL SURVEY

SUBMIT IN TRIPLICATE*
(Other instructions on
reverse side)

Form approved.
Budget Bureau No. 42-R1425.

30-031-20444

APPLICATION FOR PERMIT TO DRILL, DEEPEN, OR PLUG BACK

1a. TYPE OF WORK

DRILL ☒

DEEPEN ☐

PLUG BACK ☐

b. TYPE OF WELL

OIL
WELL ☐

GAS
WELL ☐

OTHER

SINGLE
ZONE ☒

MULTIPLE
ZONE ☐

2. NAME OF OPERATOR

Tesoro Petroleum Corporation

3. ADDRESS OF OPERATOR

404 Fidelity Plaza, Oklahoma City, Oklahoma 73102

4. LOCATION OF WELL (Report location clearly and in accordance with any State requirements.*)

At surface 660 FSL 1980 FEL
C SW SE Sec. 6-R8W, T17N

At proposed prod. zone
Same as above

14. DISTANCE IN MILES AND DIRECTION FROM NEAREST TOWN OR POST OFFICE

8 miles from Whiteshorse Trading Post

15. DISTANCE FROM PROPOSED*

LOCATION TO NEAREST
PROPERTY OR LEASE LINE, FT.
(Also to nearest drlg. unit line, if any) 660'

16. NO. OF ACRES IN LEASE

51

17. NO. OF ACRES ASSIGNED
TO THIS WELL

40

18. DISTANCE FROM PROPOSED LOCATION*
TO NEAREST WELL, DRILLING COMPLETED,
OR APPLIED FOR, ON THIS LEASE, FT.

19. PROPOSED DEPTH

1675'

20. ROTARY OR CABLE TOOLS

Rotary

21. ELEVATIONS (Show whether DF, RT, GR, etc.)

6881 G-L

22. APPROX. DATE WORK WILL START*

April 5, 1975

23.

PROPOSED CASING AND CEMENTING PROGRAM

SIZE OF HOLE	SIZE OF CASING	WEIGHT PER FOOT	SETTING DEPTH	QUANTITY OF CEMENT
12 1/4	8 5/8	20	100'	100 sx
7 7/8	5 1/2	15.5	1675'	200 sx

The proposed development well will be drilled to a total depth of 1675' to test the Lower Hospah Formation. All potential hydrocarbon zones will be adequately evaluated.

Adequate blow out prevention measures will be observed at all times.

RECEIVED
APR 18 1975
U. S. GEOLOGICAL SURVEY

IN ABOVE SPACE DESCRIBE PROPOSED PROGRAM: If proposal is to deepen or plug back, give data on present productive zone and proposed new productive zone. If proposal is to drill or deepen directionally, give pertinent data on subsurface locations and measured and true vertical depths. Give blowout preventer program, if any.

24.

SIGNED

J. L. Tally

TITLE

District Drilling Engineer

DATE

4-14-75

(This space for Federal or State office use)

PERMIT NO.

APPROVAL DATE

APPROVED BY

TITLE

DATE

CONDITIONS OF APPROVAL, IF ANY:

*See Instructions On Reverse Side

**NEW MEXICO OIL CONSERVATION COMMISSION
WELL LOCATION AND ACREAGE DEDICATION PLAT**

Form O-122
Supersedes O-128
Effective 1-1-65

All distances must be from the outer boundaries of the Section

Operator Tesoro Petroleum Corporation			Lessee Hanson		Well No. 27
Tract Letter 0	Section 6	Township 17N	Range 8W	County McKinley	
Approximate Location of Well: 660 feet from the South line and 1980 feet from the East line					
Ground Level Elev. 6881	Producing Formation COALBED SAND	Pool 5 H-1000 EXT	Estimated Acreage: 40 Acres		

1. Outline the acreage dedicated to the subject well by colored pencil or hachure marks on the plat below.
2. If more than one lease is dedicated to the well, outline each and identify the ownership thereof (both as to working interest and royalty).
3. If more than one lease of different ownership is dedicated to the well, have the interests of all owners been consolidated by communitization, unitization, force-pooling, etc?

☐ Yes ☐ No If answer is "yes," type of consolidation _____

If answer is "no," list the owners and tract descriptions which have actually been consolidated. (Use reverse side of this form if necessary.) _____

No allowable will be assigned to the well until all interests have been consolidated (by communitization, unitization, forced-pooling, or otherwise) or until a non-standard unit, eliminating such interests, has been approved by the Commission.

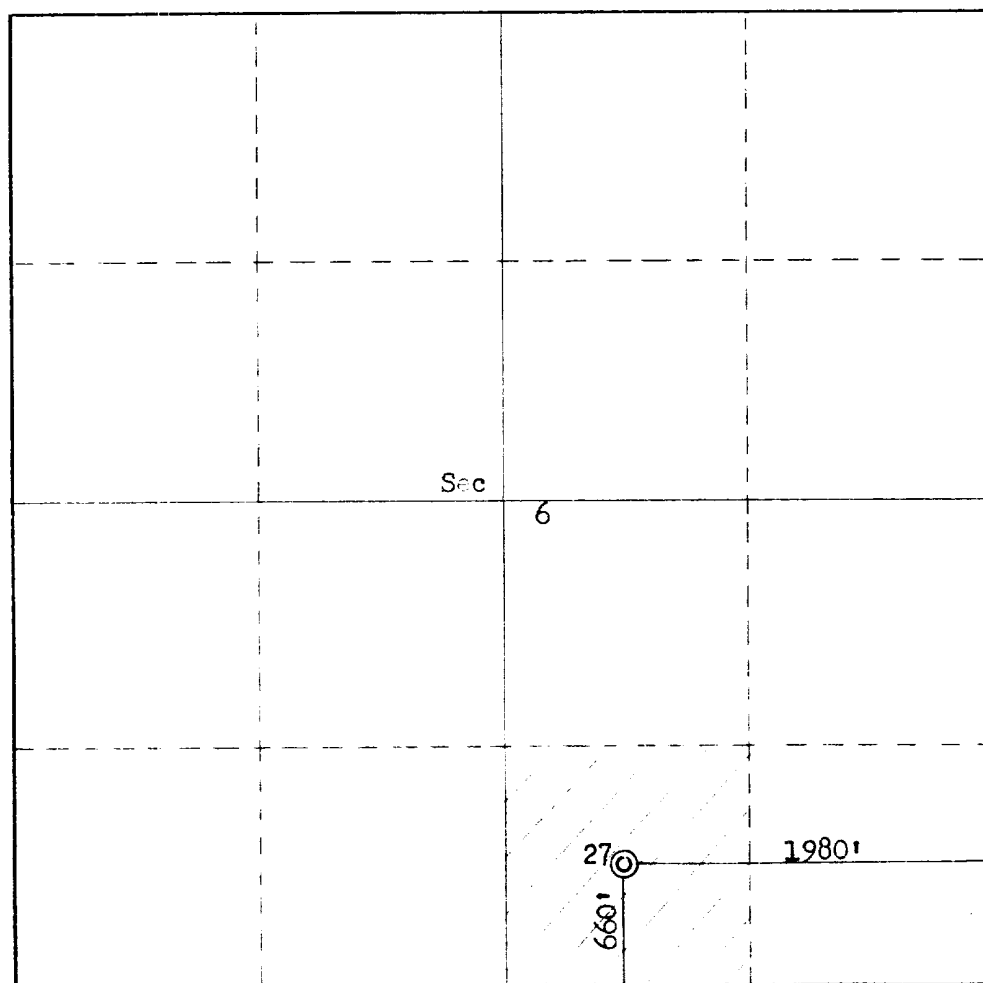
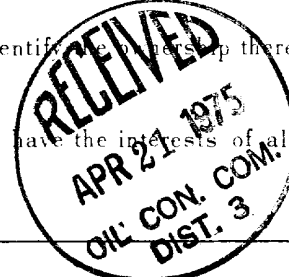

CERTIFICATION

I hereby certify that the information contained herein is true and complete to the best of my knowledge and belief.

Name
ROBERT L. G. WATSON
 Position
DEPUTY DIST. ENGINEER
 Company
TESORO PETROLEUM CORP.
 Date
4-1-75

I hereby certify that the well location shown on this plat was plotted from field notes of actual surveys made by me or under my supervision, and that the same is true and correct to the best of my knowledge and belief.

Date Surveyed
March 20, 1975
 Registered Professional Engineer and/or Land Surveyor
Fred B. Kerr Jr.
 Certificate No.
3950

J. L. TALLY
MID-CONTINENT
DISTRICT DRILLING ENGINEER

April 14, 1975

Mr. Phil McGrath
United States Geological Survey
Farmington, New Mexico 87401

Dear Sir:

The eleven point program for Tesoro's Hanson No. 27 6-17N-8W
McKinley Co, New Mexico is as follows:

1. A map showing all existing and proposed roads in the area is attached.
2. The proposed access road will be of minimum width and approximately 150' long. Surface will be bladed native dirt and sand.
3. Lateral roads are shown on the map.
4. There are existing tank batteries and flowlines in the area.
5. Water for drilling the well will be obtained from water supply well.
6. All waste material will be placed in the reserve pit and covered with sufficient overburden.
7. & 8. No camps or airstrips will be associated with this well.
9. Location plat is attached.
10. Upon completion or abandonment, the location will be restored using the guidelines of the BLM.
11. The topography of the area is fairly flat with no unusual environment.

Yours truly,



J.L. Tally
District Drilling Engineer

JLT/sdd

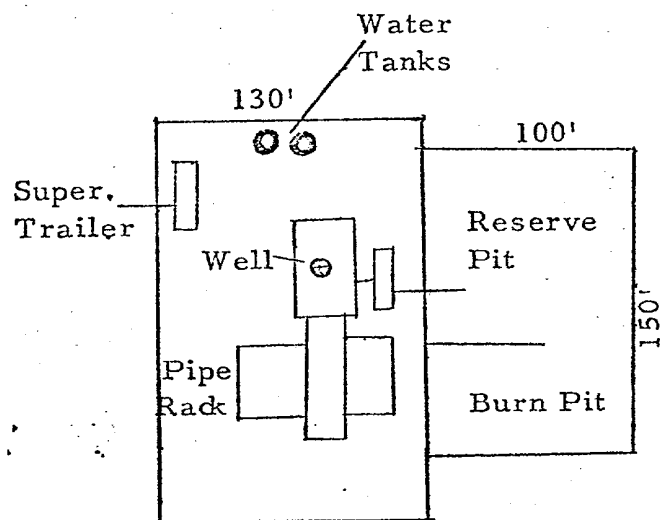

42'30"



Light-duty _____ Unimproved dirt -----

HOSPAH, N. MEX.
N3537.5-W10737.5/75

APPROX. RATE MEAN DECLINATION, 1961

THIS MAP COMPLIES WITH NATIONAL MAP ACCURACY STANDARDS
FOR SALE BY U.S. GEOLOGICAL SURVEY, DENVER 25, COLORADO OR WASHINGTON 25, D.C.
SPECIAL DESCRIPTIONS THROUGHOUT MAP AND ATLAS ARE AVAILABLE FOR PURCHASE