

NO. OF COPIES RECEIVED	5
DISTRIBUTION	
SANTA FE	1
FILE	2
U.S.G.S.	2
LAND OFFICE	
OPERATOR	1

NEW MEXICO OIL CONSERVATION COMMISSION

30-031-20577
Form C-101
Revised 1-1-65

5A. Indicate Type of Lease	
STATE <input type="checkbox"/>	FEE <input checked="" type="checkbox"/>
5. State Oil & Gas Lease No.	

APPLICATION FOR PERMIT TO DRILL, DEEPEN, OR PLUG BACK			
1a. Type of Work		7. Unit Agreement Name	
b. Type of Well OIL WELL <input checked="" type="checkbox"/> GAS WELL <input type="checkbox"/> OTHER <input type="checkbox"/>		8. Farm or Lease Name Gallup	
DRILL <input checked="" type="checkbox"/> DEEPEN <input type="checkbox"/> PLUG BACK <input type="checkbox"/>		9. Well No. 11	
2. Name of Operator Fairfax Exploration, Inc.		10. Field and Pool, or Wildcat Wildcat Gallup	
3. Address of Operator 301-B Graceland S.E. Albuquerque, New Mexico 87108		12. County McKinley	
4. Location of Well UNIT LETTER <u>2L</u> LOCATED <u>990</u> FEET FROM THE <u>West</u> LINE <u>1650</u> FEET FROM THE <u>South</u> LINE OF SEC. <u>18</u> TWP. <u>16N</u> RGE. <u>9W</u> NMPM		19. Proposed Depth 900'	
19A. Formation Hospah-Gallup		20. Rotary or C.T. Rotary	
21. Elevations (Show whether DF, RT, etc.) 7258' GR		21A. Kind & Status Plug. Bond 50000 Blanket on file	
21B. Drilling Contractor White Exploration, Inc.		22. Approx. Date Work will start Sept. 20, 1979	

23. PROPOSED CASING AND CEMENT PROGRAM					
SIZE OF HOLE	SIZE OF CASING	WEIGHT PER FOOT	SETTING DEPTH	SACKS OF CEMENT	EST. TOP
7 7/8"	5 1/2"	15.5#	900'	Cement to surface	

IN ABOVE SPACE DESCRIBE PROPOSED PROGRAM. IF PROPOSAL IS TO DEEPEN OR PLUG BACK, GIVE DATA ON PRESENT PRODUCTIVE ZONE AND PROPOSED NEW PRODUCTIVE ZONE. GIVE BLOWOUT PREVENTER PROGRAM, IF ANY.

I hereby certify that the information above is true and complete to the best of my knowledge and belief.

Signed Paul J. Wilson Title President Date Sept. 19, 1979

(This space for State Use)

APPROVED BY Frank S. Love TITLE DEPUTY CHIEF OF BUREAU DIST. #3 DATE 10/2/79

CONDITIONS OF APPROVAL, IF ANY:



1-3-80

NEW MEXICO OIL CONSERVATION COMMISSION
WELL LOCATION AND ACREAGE DEDICATION PLAT

Form C-102
Supersedes C-128
Effective 1-1-65

All distances must be from the outer boundaries of the Section.

Operator FAIRFAX EXPLORATION, INC.			Lease Bullseye		Well No. 11
Unit Letter L	Section 18	Township 16 NORTH	Range 9 WEST	County MCKINLEY	
Actual Footage Location of Well: 1650 feet from the SOUTH line and 910 feet from the WEST line					
Ground Level Elev. 7257	Producing Formation Hospah-Gallup		Pool W.C.	Dedicated Acreage: 40 Acres	

1. Outline the acreage dedicated to the subject well by colored pencil or hatchure marks on the plat below.
2. If more than one lease is dedicated to the well, outline each and identify the ownership thereof (both as to working interest and royalty).
3. If more than one lease of different ownership is dedicated to the well, have the interests of all owners been consolidated by communitization, unitization, force-pooling, etc?

☐ Yes ☐ No If answer is "yes," type of consolidation _____

If answer is "no," list the owners and tract descriptions which have actually been consolidated. (Use reverse side of this form if necessary.) _____

No allowable will be assigned to the well until all interests have been consolidated (by communitization, unitization, forced-pooling, or otherwise) or until a non-standard unit, eliminating such interests, has been approved by the Commission.

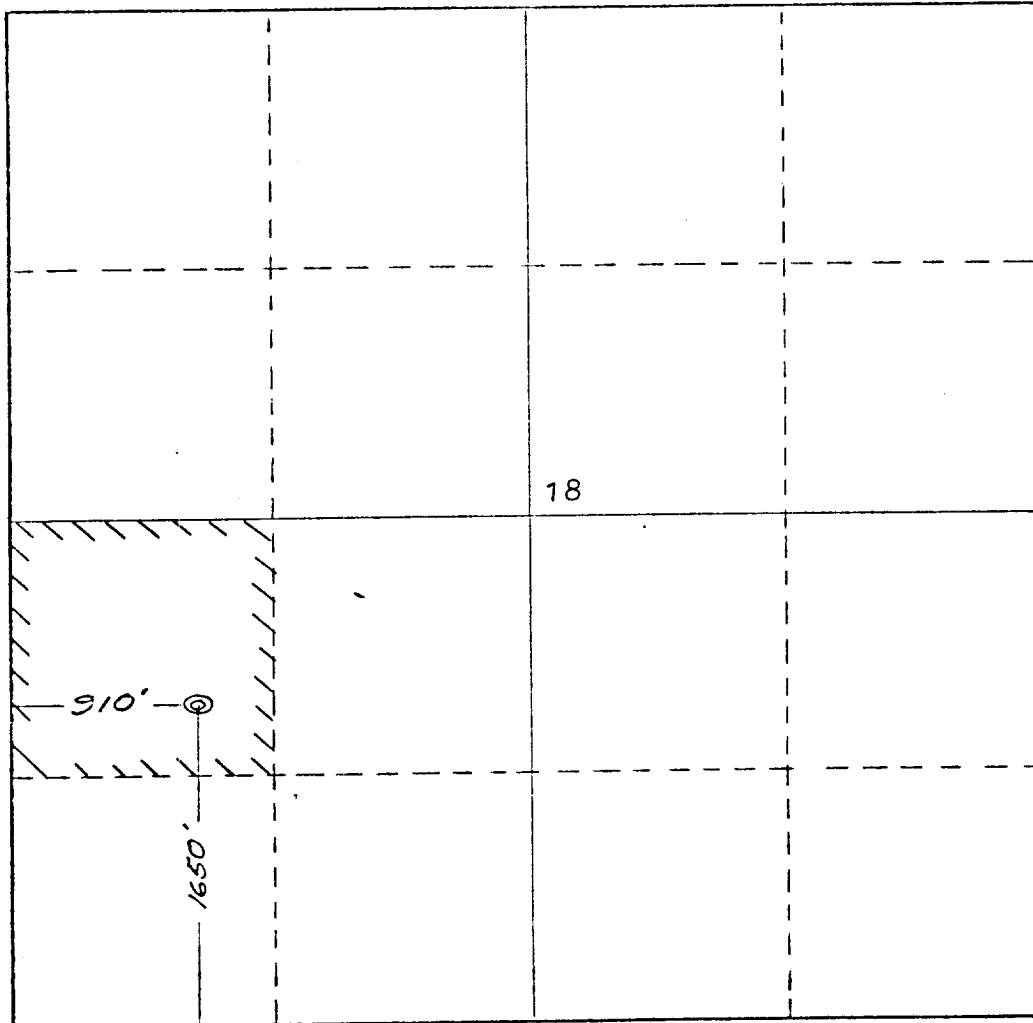

CERTIFICATION

I hereby certify that the information contained herein is true and complete to the best of my knowledge and belief.

Name _____

Gene D. Wilson

Position

President

Company

Fairfax Exploration, Inc.

Date

Sept. 27, 1979

I hereby certify that the well location shown on this plat was plotted from field notes of actual surveys made by me or under my supervision and that the same is true and correct to the best of my knowledge and belief.

Date Surveyed

September 18, 1979

Registered Professional Engineer and/or Land Surveyor

James P. Leese

James P. Leese

Certificate No.

1463

