

UNITED STATES  
DEPARTMENT OF THE INTERIOR  
GEOLOGICAL SURVEY

## APPLICATION FOR PERMIT TO DRILL, DEEPEN, OR PLUG BACK

1a. TYPE OF WORK  
DRILL ☒ DEEPEN ☐ PLUG BACK ☐

b. TYPE OF WELL  
OIL WELL ☒ GAS WELL ☐ OTHER ☐ SINGLE ZONE ☐ MULTIPLE ZONE ☐

2. NAME OF OPERATOR  
Cities Service Company

3. ADDRESS OF OPERATOR  
Box 1919 Midland, TX 79702

4. LOCATION OF WELL (Report location clearly and in accordance with any State requirements.)\*  
At surface  
1650' FNL & 990' FEL of Sec 28-T19N-R5W, McKinley County, NM  
At proposed prod. zone  
same as above

14. DISTANCE IN MILES AND DIRECTION FROM NEAREST TOWN OR POST OFFICE\*  
8 1/2 miles NW of Torreon, NM

15. DISTANCE FROM PROPOSED\*  
LOCATION TO NEAREST  
PROPERTY OR LEASE LINE, FT.  
(Also to nearest drlg. unit line, if any) 990' East

16. NO. OF ACRES IN LEASE  
760 1400

17. NO. OF ACRES ASSIGNED  
TO THIS WELL  
40

18. DISTANCE FROM PROPOSED LOCATION\*  
TO NEAREST WELL, DRILLING, COMPLETED,  
OR APPLIED FOR, ON THIS LEASE, FT. 1476' NW

19. PROPOSED DEPTH  
5390'

20. ROTARY OR CABLE TOOLS  
Rotary

21. ELEVATIONS (Show whether DF, RT, GR, etc.)  
6645' GR

22. APPROX. DATE WORK WILL START\*  
August 1, 1980

5. LEASE DESIGNATION AND SERIAL NO.  
NM 6999

6. IF INDIAN, ALLOTTEE OR TRIBE NAME

7. UNIT AGREEMENT NAME

8. FARM OR LEASE NAME  
FEDERAL E

9. WELL NO.  
2

10. FIELD AND POOL, OR WILDCAT  
Undesignated WC Entrada

11. SEC., T., R., M., OR BLK.  
AND SURVEY OR AREA  
Sec 28-T19N-R5W

12. COUNTY OR PARISH  
McKinley

13. STATE  
NM

## 23. PROPOSED CASING AND CEMENTING PROGRAM

SIZE OF HOLE	SIZE OF CASING	WEIGHT PER FOOT	SETTING DEPTH	QUANTITY OF CEMENT
12 1/2"	8-5/8"	24#	200'	Circulated
7-7/8"	5 1/2"	14#	5390'	1000 sx

It is proposed to drill to a total depth of 5390' to test the Entrada formation. The blow out prevention program is as follows:

1. one set of blind rams.
2. one set of drill pipe rams.

The acreage allocated to this well is not dedicated to any gas gatherer.

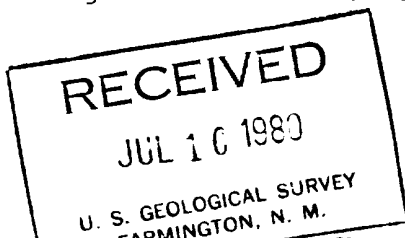

DRILLING OPERATIONS AUTHORIZED ARE  
SUBJECT TO COMPLIANCE WITH ATTACHED  
"GENERAL REQUIREMENTS"

This action is subject to administrative  
appeal pursuant to 30 CFR 290.

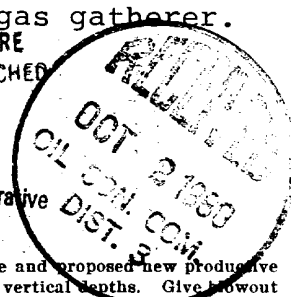

IN ABOVE SPACE DESCRIBE PROPOSED PROGRAM: If proposal is to deepen or plug back, give data on present productive zone and proposed new productive zone. If proposal is to drill or deepen directionally, give pertinent data on subsurface locations and measured and true vertical depths. Give blowout prevention program, if any.

24. SIGNED E. J. [Signature] TITLE Region Oper. Mgr. DATE 7/8/80  
(This space for Federal or State office use)

PERMIT NO. \_\_\_\_\_ APPROVAL DATE \_\_\_\_\_

APPROVED BY \_\_\_\_\_ TITLE \_\_\_\_\_ DATE \_\_\_\_\_  
CONDITIONS OF APPROVAL, IF ANY:

*ok 3/2*

FWOCC

## Instructions

**General:** This form is designed for submitting proposals to perform certain well operations, as indicated, on all types of lands and leases for appropriate action by either a Federal or a State agency, or both, pursuant to applicable Federal and/or State laws and regulations. Any necessary special instructions concerning the use of this form and the number of copies to be submitted, particularly with regard to local, area, or regional procedures and practices, either are shown below or will be issued by, or may be obtained from, the local Federal and/or State office.

**Item 1:** If the proposal is to redrill to the same reservoir at a different subsurface location or to a new reservoir, use this form with appropriate notations. Consult applicable State or Federal regulations concerning subsequent work proposals or reports on the well.

**Item 4:** If there are no applicable State requirements, locations on Federal or Indian land should be described in accordance with Federal requirements. Consult local State or Federal office for specific instructions.

**Item 14:** Needed only when location of well cannot readily be found by road from the land or lease description. A plat, or plats, separate or on this reverse side, showing the roads to, and the surveyed location of, the well, and any other required information, should be furnished when required by Federal or State agency offices.

**Items 15 and 18:** If well is to be, or has been directionally drilled, give distances for subsurface location of hole in any present or objective production zone.

**Item 22:** Consult applicable Federal or State regulations, or appropriate officials, concerning approval of the proposal before operations are started.

All distances must be from the outer boundaries of the Section.

Operator <b>CITIES SERVICE COMPANY</b>			Lease <b>FEDERAL E</b>		Well No. <b>2</b>
Unit Letter <b>H</b>	Section <b>26</b>	Township <b>19N</b>	Range <b>5W</b>	County <b>McKinley</b>	

Actual Footage Location of Well:

**1650** feet from the **North** line and **990** feet from the **East** line

Ground Level Elev. <b>6645</b>	Producing Formation <b>Entrada</b>	Pool <b>Wildcat</b>	Dedicated Acreage:  Acres
-----------------------------------	---------------------------------------	------------------------	---------------------------------

1. Outline the acreage dedicated to the subject well by colored pencil or hachure marks on the plat below.
2. If more than one lease is dedicated to the well, outline each and identify the ownership thereof (both as to working interest and royalty).
3. If more than one lease of different ownership is dedicated to the well, have the interests of all owners been consolidated by communitization, unitization, force-pooling, etc?

☐ Yes ☐ No If answer is "yes," type of consolidation \_\_\_\_\_

If answer is "no," list the owners and tract descriptions which have actually been consolidated. (Use reverse side of this form if necessary.) \_\_\_\_\_

No allowable will be assigned to the well until all interests have been consolidated (by communitization, unitization, forced-pooling, or otherwise) or until a non-standard unit, eliminating such interests, has been approved by the Commission.

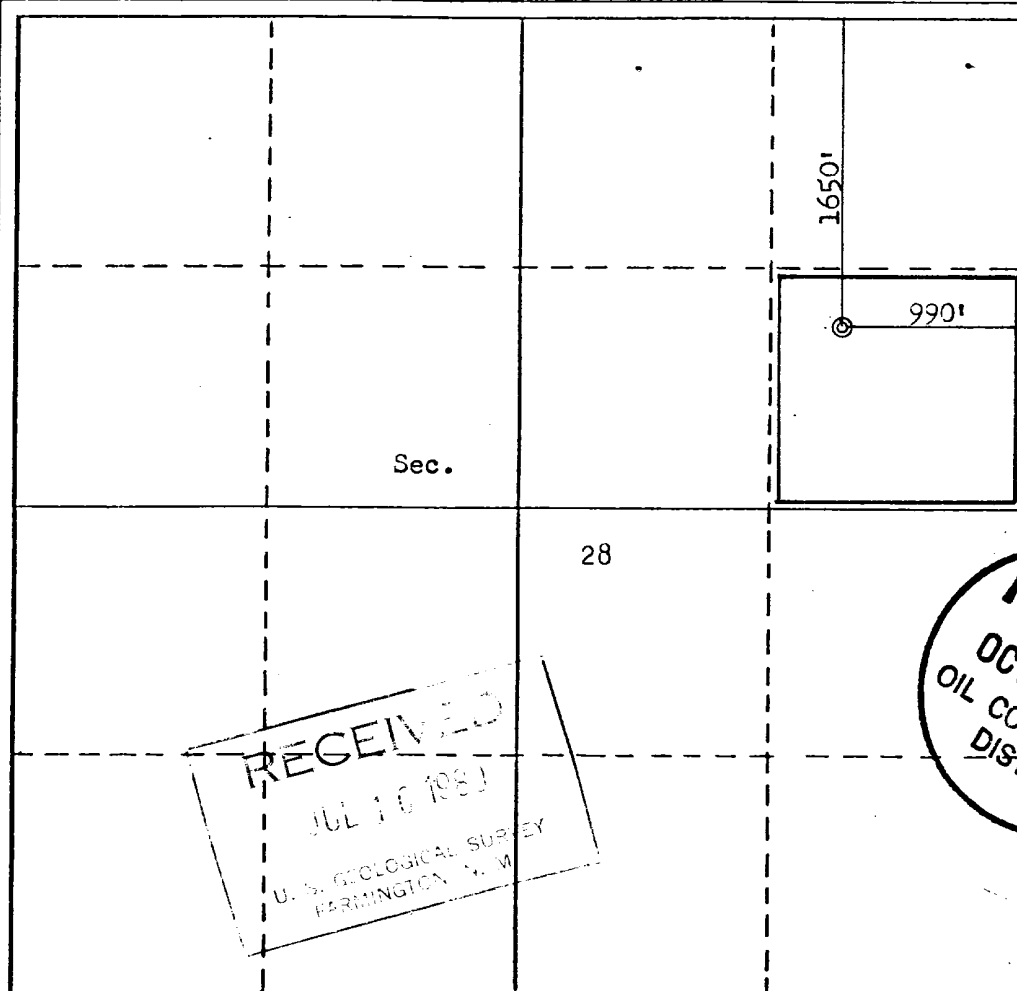

CERTIFICATION

I hereby certify that the information contained herein is true and complete to the best of my knowledge and belief.

*Spindler*

Name  
Region Operations Mgr.  
Position  
Cities Service Company  
Company  
7/8/80  
Date

I hereby certify that the well location shown on this plat was plotted from field notes of actual surveys made by me or under my supervision, and that the same is true and correct to the best of my knowledge and belief.

Date Surveyed  
June 30, 1980  
Registered Professional Engineer  
and/or Land Surveyor  
*Fred B. Kerr Jr.*  
Certificate No. 3950  
FRED B. KERR, JR.

RECEIVED  
JUL 10 1981  
U.S. GEOLOGICAL SURVEY  
FARMINGTON, N. M.

RECEIVED  
OCT 21 1980  
OIL CON. DIV.  
DIST. 3

UNITED STATES  
DEPARTMENT OF THE INTERIOR  
GEOLOGICAL SURVEYSUBMIT IN TRIPLICATE\*  
(Other instructions on re-  
verse side)Form approved.  
Budget Bureau No. 42-R1424.

5. LEASE DESIGNATION AND SERIAL NO.

NM 6999

6. IF INDIAN, ALLOTTEE OR TRIBE NAME

7. UNIT AGREEMENT NAME

8. FARM OR LEASE NAME

FEDERAL E

9. WELL NO.

2

10. FIELD AND POOL, OR WILDCAT

Undesignated

11. SEC., T., R., M., OR BLK. AND  
SURVEY OR AREA

Sec 28-T19N-R5W

12. COUNTY OR PARISH

McKinley

13. STATE

NM

1. OIL WELL ☒ GAS WELL ☐ OTHER ☐

2. NAME OF OPERATOR

Cities Service Company

3. ADDRESS OF OPERATOR

Box 1919, Midland, TX 79702

4. LOCATION OF WELL (Report location clearly and in accordance with any State requirements.\*  
See also space 17 below.)

At surface

1650' FNL & 990' FEL of Sec 28-T19N-R5W  
McKinley County, New Mexico

14. PERMIT NO.

15. ELEVATIONS (Show whether DF, RT, GR, etc.)

6645' GR

16.

## Check Appropriate Box To Indicate Nature of Notice, Report, or Other Data

## NOTICE OF INTENTION TO:

TEST WATER SHUT-OFF ☐FRACTURE TREAT ☐SHOOT OR ACIDIZE ☐REPAIR WELL ☐(Other) ☐PULL OR ALTER CASING ☐MULTIPLE COMPLETE ☐ABANDON\* ☐CHANGE PLANS ☒

## SUBSEQUENT REPORT OF:

WATER SHUT-OFF ☐FRACTURE TREATMENT ☐SHOOTING OR ACIDIZING ☐(Other) ☐REPAIRING WELL ☐ALTERING CASING ☐ABANDONMENT\* ☐(NOTE: Report results of multiple completion on Well  
Completion or Recompletion Report and Log form.)

17. DESCRIBE PROPOSED OR COMPLETED OPERATIONS. (Clearly state all pertinent details, and give pertinent dates, including estimated date of starting any proposed work. If well is directionally drilled, give subsurface locations and measured and true vertical depths for all markers and zones pertinent to this work.)\*

The proposed casing and cementing program has been changed as follows:

SIZE OF HOLE	SIZE OF CASING	WEIGHT PER FT.	SETTING DEPTH	QUANTITY OF CEMENT
12 1/4"	9-5/8"	32.3#	200'	300 sacks (Circulate)
8-3/4"	7"	20 & 23#	5420'	900 sacks

The proposed depth has been changed from 5390' to 5420'.

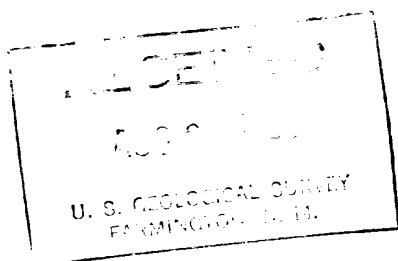
*Bruckhamer*

18. I hereby certify that the foregoing is true and correct

SIGNED

*E. J. Miller*

TITLE Region Oper. Mgr.

DATE 8/18/80

(This space for Federal or State office use)

APPROVED BY

TITLE

DATE

CONDITIONS OF APPROVAL, IF ANY:

\*See Instructions on Reverse Side

## Instructions

**General:** This form is designed for submitting proposals to perform certain well operations, and reports of such operations when completed, as indicated, on Federal and Indian lands pursuant to applicable Federal law and regulations; and, if approved or accepted by any State, on all lands in such State, pursuant to applicable State law and regulations. Any necessary special instructions concerning the use of this form and the number of copies to be submitted, particularly with regard to local, area, or regional procedures and practices, either are shown below or will be issued by, or may be obtained from, the local Federal and/or State office.

**Item 4:** If there are no applicable State requirements, locations on Federal or Indian land should be described in accordance with Federal requirements. Consult local State or Federal office for specific instructions.

**Item 17:** Proposals to abandon a well and subsequent reports of abandonment should include such special information as is required by local Federal and/or State offices. In addition, such proposals and reports should include reasons for the abandonment; data on any former or present productive zones, or other zones with present significant fluid contents not sealed off by cement or otherwise; depths (top and bottom) and method of placement of cement plugs; mud or other material placed below, between and above plugs; amount, size, method of parting of any casing, liner or tubing pulled and the depth to top of any left in the hole; method of closing top of well; and date well site conditioned for final inspection looking to approval of the abandonment.



CITIES SERVICE COMPANY  
ENERGY RESOURCES GROUP

Box 1919  
Midland, Texas 79702  
(915) 684-7131

July 10, 1980

United States Department of the Interior  
Geological Survey  
P.O. Box 959  
Farmington, New Mexico 87401

Re: Application for Permit to Drill  
Federal "E" No. 2  
McKinley County, New Mexico

Gentlemen:

Cities Service Company respectfully requests permission to drill our Federal "E" No. 2, located 1650' from the north line and 990' from the east line of Section 28-19N-5W, McKinley County, New Mexico, Federal Lease No. NM-6999.

The location, work area and access road have been staked. It is approximately 40 miles by road to Cuba and about 85 miles by road to Bloomfield, New Mexico.

In accordance with requirements stipulated in the National Environmental Policy Act, as stated in NTL-6 Section IIB, our application for permission to drill and supporting evidence is hereby submitted:

I. Application for Permit to Drill:

1. Form 9-331C
2. Form C-102 Location and Acreage Dedication Plat certified by Fred Kerr, Registered Land Surveyor #3950 in the State of New Mexico.
3. The elevation of the unprepared ground is 6645 feet above sea level.
4. The geologic name of the surface is Lewis formation in the Cretaceous.

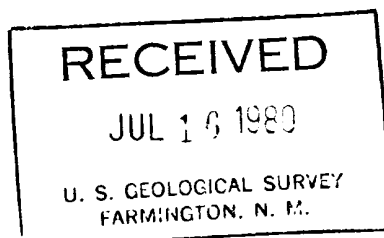
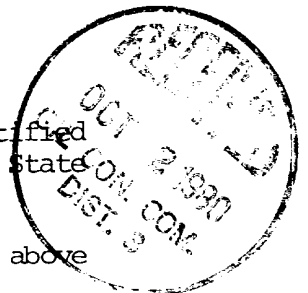

5. Rotary drilling equipment will be utilized to drill the well to TD 5420' and run casing. This equipment will then be rigged down and the well will be completed with a pulling unit.
6. Proposed total depth is 5420 feet.
7. Estimated tops of important geologic markers:

Mesa Verde Group	Near Surface
Point Lookout Ss	1990'
Mancos Sh	2100'
Gallups Ss	2901'
Greenhorn Ls	3900'
Dakota Ss	4140'
Morrison Fm	4260'
Todilto	5120'
Entrada Ss	5134'
Carmel Fm	5370'
TD	5420'

8. Estimated depths at which anticipated water, oil, gas or other mineral bearing formations are expected to be encountered.
  - A. Primary objective Entrada Ss (Jurassic) Top 5134'.
  - B. Secondary objective Dakota Ss (Cretaceous) Top 4140'.
9. The proposed casing program is as follows:

Surface: 9-5/8" OD 32.3# H40 ST&C new casing

Production: 7" OD 20# & 23# K55 ST&C new casing
10. Casing setting depth and cementing program;
  - A. 9-5/8" OD surface pipe set at 200'. Circulate cement with 300 sax Class "B" w/3% CaCl.
  - B. 7" OD production casing set at 5420', with DV tool at 2700'. Cement first stage with 500 sax 50/50 Class B Pozmix w/2% Gel, 6-1/4# Gilsonite and 6# salt per sack. Cement second stage with 400 sax Halliburton Lite with 6-1/4# Gilsonite per sack.

11. Pressure Control Equipment:

0 - 200            None

200 - 5420'      10"/3000# hydraulic BOP with blind and pipe  
rams with floor and remote operating stations.

Blowout prevention equipment will be installed, tested and in working order before drilling below the surface casing and shall be maintained ready for use until drilling operations are completed.

A kill line will be properly installed and will not be used as a fill-up line.

Drill string safety valve(s) to fit all pipe in the drill string to be maintained on the rig floor while drilling operations are in progress.

The pipe rams will be activated once each 24 hours and the blind rams each time the pipe is out of the hole to assure the equipment is operational and each crew is properly trained to carry out emergency duties.

Auxiliary equipment is an upper kelly cock and a drill pipe float.

12. Mud Program:

0 - 200'            Spud mud. Gel flocculated with Lime. Maintain  
45-60 Sec Viscosity.

200 - 5420'      Drill out with a fresh water low solids, non-  
dispersed mud maintaining the following pro-  
perties:

Mud Weight	8.6 - 8.8	Lb/Gal
Viscosity	34 - 34	cc
Water Loss	8 - 10	cc

Prior to drill the Gallup sandstone, pretreat mud with 10% LCM reducing to 5% LCM from the Dakota sandstone to TD.



13. Testing, Logging and Coring Program
  - A. No drillstem tests.
  - B. Mud Logging Program. One man unit 1500' - TD 5420'.
  - C. Electric Logging Program. CNL-FDC, Dual Induction Laterolog, BHC Sonic - GR, Proximity Microlog - Caliper. Dipmeta to be determined later (Schlumberger).
  - D. Coring Program - None.
14. No abnormal temperature, pressures or H<sub>2</sub>S gas is anticipated.
15. Anticipated starting date is one week to one month after approval of this application by the Geological Survey, depending upon rig availability.
16. Form 9-1123 "Designation of Operator" designates Cities Service Company as Operator by the Lessee, James L. Ludwick.
17. The Multi Point Surface Use and Operation Plan for submission to the Bureau of Land Management is attached.

Yours very truly,



E. Y. Wilder  
Region Operations Manager  
Southwest Region  
E & P Division

EYW/dtd

attachments

## DESIGNATION OF OPERATOR

The undersigned is, on the records of the Bureau of Land Management, holder of lease

DISTRICT LAND OFFICE: Santa Fe  
SERIAL No.: NM 6999

and hereby designates

NAME: Cities Service Company  
ADDRESS: P. O. Box 300  
Tulsa, Oklahoma 74102

as his operator and local agent, with full authority to act in his behalf in complying with the terms of the lease and regulations applicable thereto and on whom the supervisor or his representative may serve written or oral instructions in securing compliance with the Operating Regulations with respect to (describe acreage to which this designation is applicable):

Township 19 North, Range 5 West, N.M.P.M.

Section 22: SW $\frac{1}{4}$ ;

Section 28: E $\frac{1}{2}$ , NW $\frac{1}{4}$ , N $\frac{1}{2}$ SW $\frac{1}{4}$ , SE $\frac{1}{4}$ SW $\frac{1}{4}$ .

It is understood that this designation of operator does not relieve the lessee of responsibility for compliance with the terms of the lease and the Operating Regulations. It is also understood that this designation of operator does not constitute an assignment of any interest in the lease.

In case of default on the part of the designated operator, the lessee will make full and prompt compliance with all regulations, lease terms, or orders of the Secretary of the Interior or his representative.

The lessee agrees promptly to notify the supervisor of any change in the designated operator.

*James L. Ludwick*  
(Signature of lessee)

James L. Ludwick  
P. O. Box 70  
Farmington, New Mexico 87401

March 24, 1980

(Date)

(Address)

BLOWOUT PREVENTER DIAGRAM  
3000# W.P.

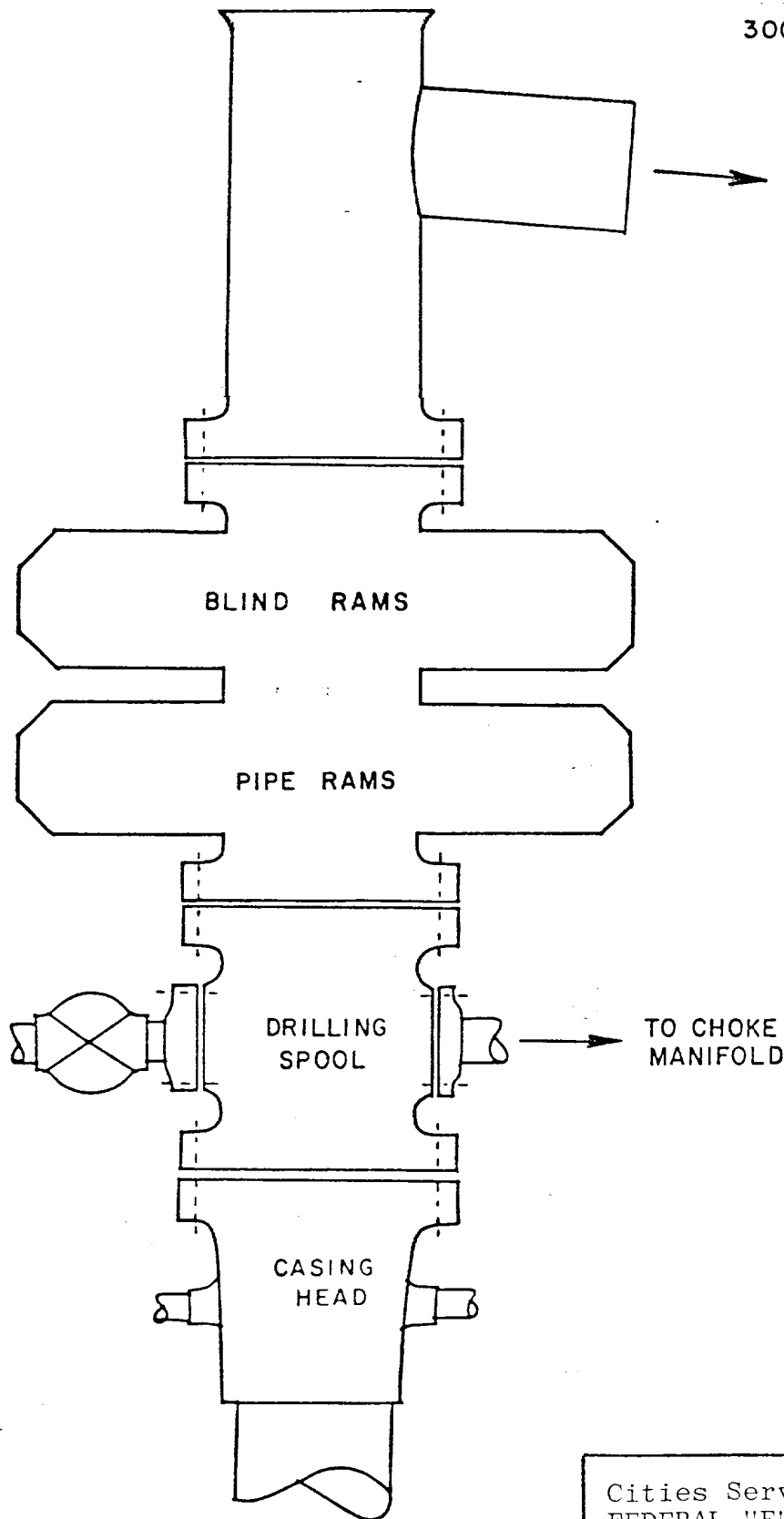

Cities Service Co.'s  
FEDERAL "E" No. 2  
1650' FNL & 990' FEL  
Section 28-19N-5W  
McKinley County, New Mexico  
Lse # NM 6999

## MULTI-POINT SURFACE USE AND OPERATIONS PLAN

CITIES SERVICE COMPANY  
WELL NO. 2 FEDERAL "E"  
1650' FNL & 990' FEL, SECTION 28-19N-5W  
MCKINLEY COUNTY, NEW MEXICO  
FEDERAL LEASE NO. NM-6999

This plan is submitted with the Application for Permit to Drill the captioned well. The purpose of the plan is to describe the location of the proposed well, the proposed construction activities and operation plan, the magnitude of necessary surface disturbance involved and the procedures to be followed in rehabilitating the surface after completion of the operation, so that a complete appraisal can be made of the environmental effects associated with the operation.

The well has been staked by Mr. Fred Kerr, a registered Land Surveyor, and the work area and access road have been staked and flagged. Mr. Bill Naylor with the San Juan Community College in Farmington has been commissioned to make an archaeological survey of the work area and access road. His findings concerning cultural resources will be reported to the Bureau of Land Management in Farmington, New Mexico.

### 1. Existing Roads

A portion of a McKinley County highway map is attached which shows the proposed location in relation to the towns of Cuba and Torreon, New Mexico and the existing road system leading into the area.

#### Direction to Location

Start at Torreon which is 27 miles southwest of Cuba, New Mexico. From Torreon go northwesterly 7 miles to a gate on the right and a large pink water storage tank. About 100 yards before coming to the water tank, turn right and follow the old road 2.7 miles. Turn right and follow an existing road approximately 3000 feet. The new access road starts at this point, veering slightly to the right. It is staked and flagged to the well location.

### 2. Planned Access Road

- A. Dirt contractor will grade the 2.7 miles of old road and the 3000' of existing road. The proposed new access road to the new location will be 12' wide and approximately 2000' long. See attached vicinity map.
- B. Surfacing Material: The roadway will be bladed, watered and graded. There may be some spots that will need to be topped with local red rock. The work area will be topped with red rock if necessary.

Planned Access Road - cont.

- C. Maximum grade: The terrain is rolling. Maximum grade 3%.
  - D. Turnouts: One passing turnout will be constructed at a halfway point on the new access road approximately 1000' west of the Federal "E" No. 2 location. This construction will increase the width of the new road to 20 feet for a distance of 30 feet.
  - E. Drainage design: Access road will have a drop of 6 inches from center line to each side.
  - F. Culverts: None needed.
  - G. Cuts and fills: Location will need to be leveled as shown on attached profile prepared by Kerr Land Surveying 6-30-80.
  - H. Gates and cattleguards: None required.
3. Location of Existing Wells
- Existing wells within a two mile radius of our proposed Federal "E" No. 2 are spotted on the third attached plat.
4. Location of Existing and/or Proposed Facilities
- There are no existing facilities in the area.
- Proposed production facilities will be set on the drilling pad approximately 150 feet from the well. The equipment will consist of a heater treater and two 500 barrel tanks to store crude oil and one 500 barrel tank to store produced water. All equipment will be fenced with a chain link fence and painted in accordance with BLM stipulation.
5. Location and Type of Water Supply
- A fresh water mud system will be used to drill this well and fresh water will be purchased and trucked to the well site over existing and proposed roads.
- One source of supply is Entrada produced water available in Section 15 to the north from Dome Petroleum Corp's tank battery in the Papers Wash Pool.
- Another source is at the Pueblo Alto Trading Post and a third source is Chapman's water hole at Escrito on Highway 44.

6. Source of Construction Material

Red Rock for the access road and well pad will be purchased and hauled by the dirt contractor from the nearest possible source.

7. Methods of Handling Waste Disposal

- A. Drill cuttings will be disposed of in the drilling pits.
- B. Drilling fluids will be allowed to evaporate in the drilling pits until pits are dry.
- C. Water produced during tests will be disposed of in the drilling pits. Oil produced during tests will be stored in test tanks until sold.
- D. Current laws and regulations pertaining to the disposal of human waste will be complied with.
- E. Trash, waste paper, garbage and junk will be collected and buried in a separate trash pit and covered with a minimum of 24 inches of dirt. All waste material will be contained to prevent scattering by wind.
- F. All trash and debris will be buried or removed from the well site within 30 days after finishing drilling and/or completion operations.

8. Ancillary Facilities

None needed.

9. Well Site Layout

A plat of the well site is attached which shows dimensions of well pad, mud pits, reserve pit and location of major rig components.

10. Plans for Restoration of the Surface

- A. After completion of the well, all equipment not needed for operations will be removed.
- B. All unattended pits containing liquids will be fenced and the liquid portion allowed to evaporate before the pits are broken and backfilled.
- C. All waste associated with the drilling operation will be buried in place in a separate pit. Garbage and debris will be buried at least 3 feet deep.

Plans for Restoration of the Surface - cont.

- D. Surface restoration will be in accordance with the requirements of the Bureau of Land Management.
- E. The well site, if a producer, will be maintained and kept clean of all trash and litter or other foreign material which detracts from the surrounding environment. Equipment will be maintained in accordance with good operating practices.

After the well site is cleaned and pits backfilled, any obstruction to the natural drainage will be corrected by ditching and/or terracing. All disturbed area, including any access road no longer needed, will be ripped and sown in grass seed recommended by the BLM.

11. Other Information

- A. Topography: Terrain is rolling and broken. Drainage is to the north into Papers Wash.
- B. Soil: Thin fine sandy soil with numerous Red Rock outcrops.
- C. Flora and Fauna: Vegetative cover is sparse sage and native grasses. No trees. Wildlife in the area includes coyotes, rabbits, rodents, reptiles, dove, quail and deer.
- D. Ponds and Streams: No streams or ponds were noted in the area.
- E. Residences and Other Structure: None noted in the immediate area.
- F. Archaeological, Historical and Cultural Sites: None observed. Mr. Bill Naylor with the San Juan Community College in Farmington, New Mexico has been engaged to make a survey of the well pad and access road.
- G. Land Use: Ranching.
- H. Surface Ownership: The well site and access road are all on Federal surface administered by the BLM.

12. Lessee's or Operator's Representative:

Cities Service Company's representative responsible for assuring compliance with the approved surface use and operation plan is:

E. Y. Wilder  
Cities Service Company  
Region Operations Manager  
P.O. Box 1919  
Midland, Texas 79702

Office Phone: 915/685-5751  
Home Phone: 915/694-8626

13. Certification

I hereby certify that I, or persons under my direct supervision, have inspected the proposed drill site and access route; that I am familiar with the conditions which presently exist; that the statements made in this plan are, to the best of my knowledge, true and correct, and, that the work associated with the operations proposed herein will be performed by Cities Service Company and its contractors and subcontractors in conformity with this plan and the terms and conditions under which it is approved.

Date

7/10/80

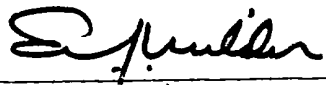
  
Region Operations Manager

Please contact me at the above address if further information is needed to properly evaluate this proposal.

EW/dtd

attachments



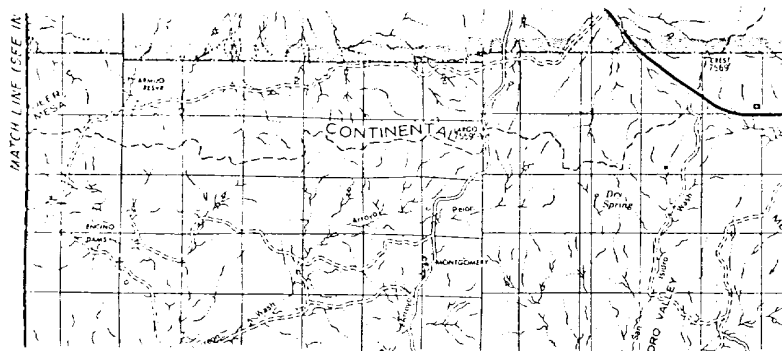

U.S. GEOLOGICAL SURVEY  
RED ROCKS

R. 5 W.

R. 4 W.

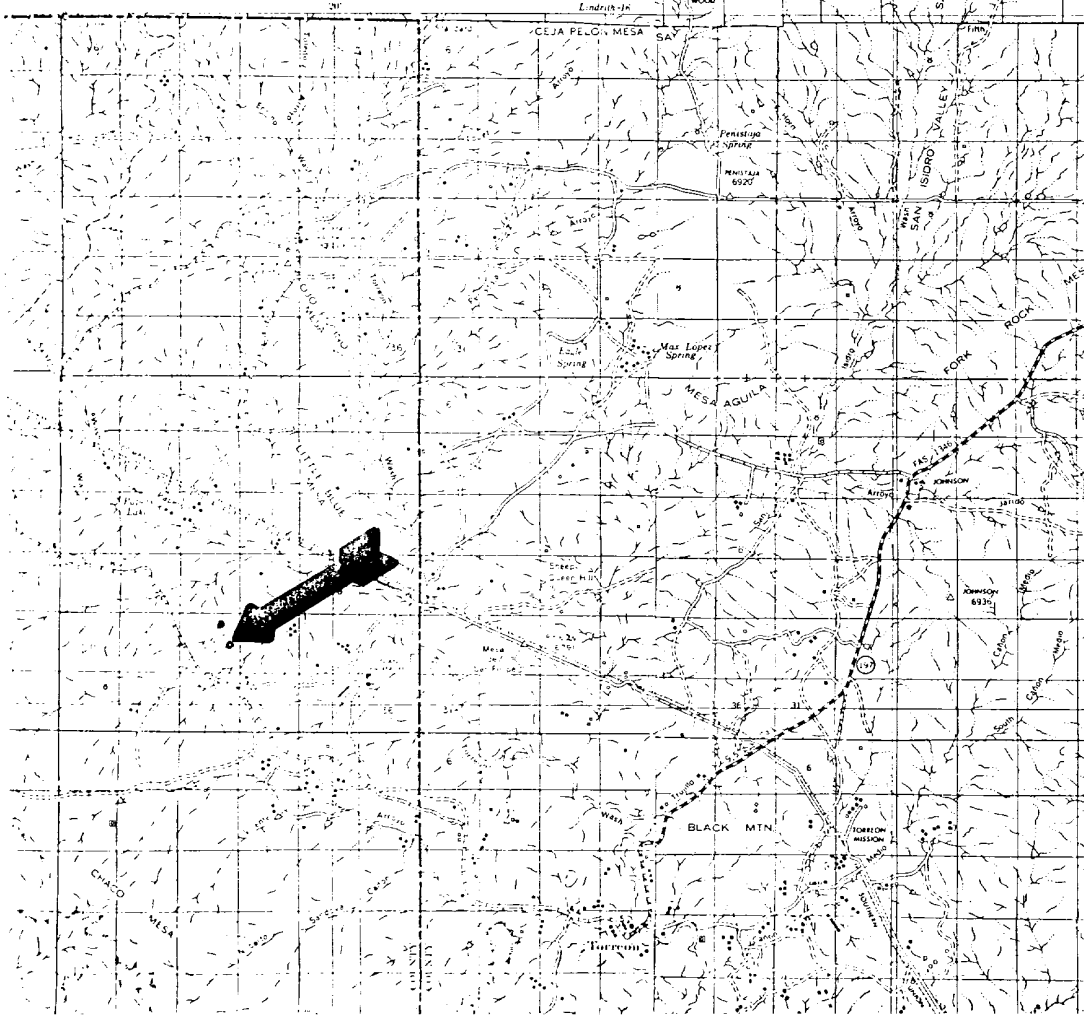

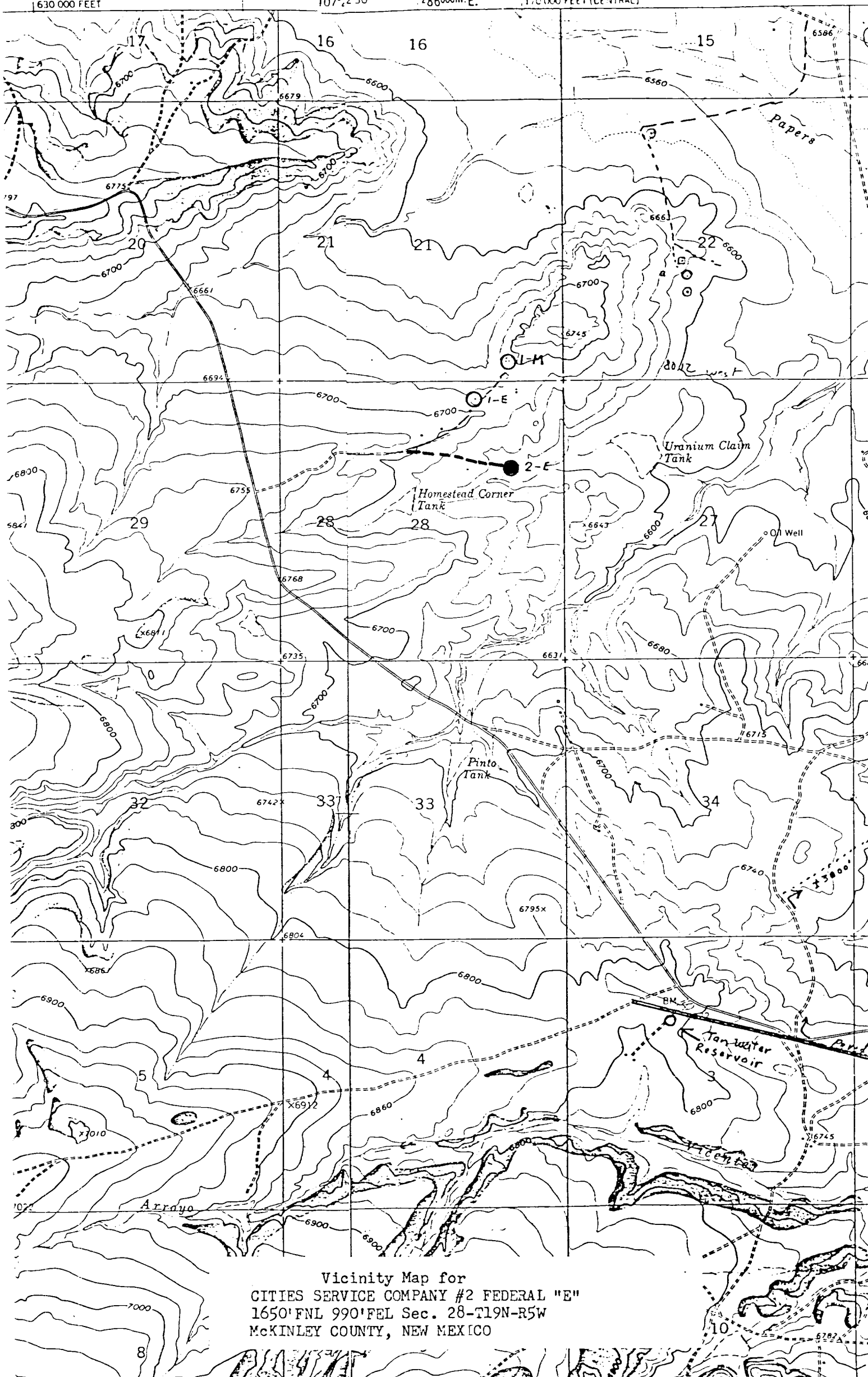

CITIES SERVICE COMPANY #2 FEDERAL E  
 1650' FNL 990' FEL Sec. 28-T19N-R5W  
 MCKINLEY COUNTY, NEW MEXICO

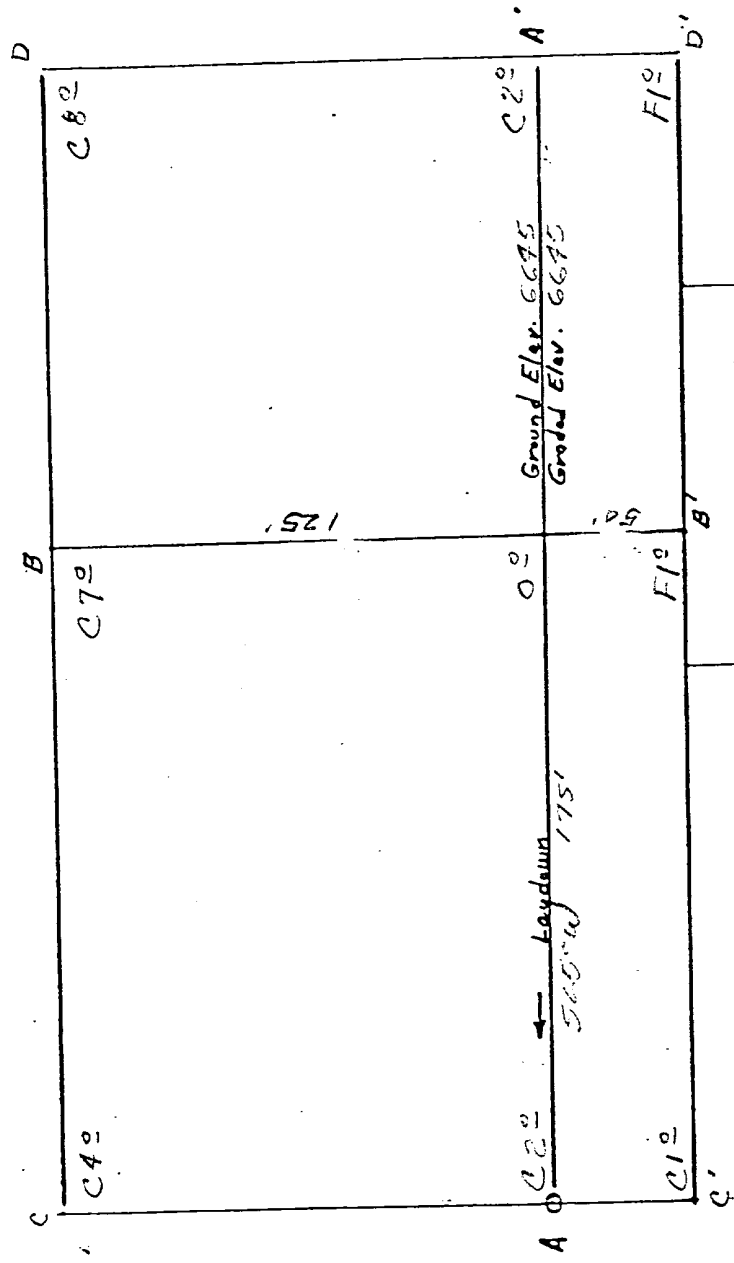

Vert. 1"=40'      A-A'      Horiz. 1"=100'

6650			
6640			
6630			

B-B'      Horiz. 1"=100'

6650			
6640			
6630			

Vert. 1"=40'      C-C'      Horiz. 1"=100'

6650			
6640			
6630			

D-D'      Horiz. 1"=100'

6650			
6640			
6630			

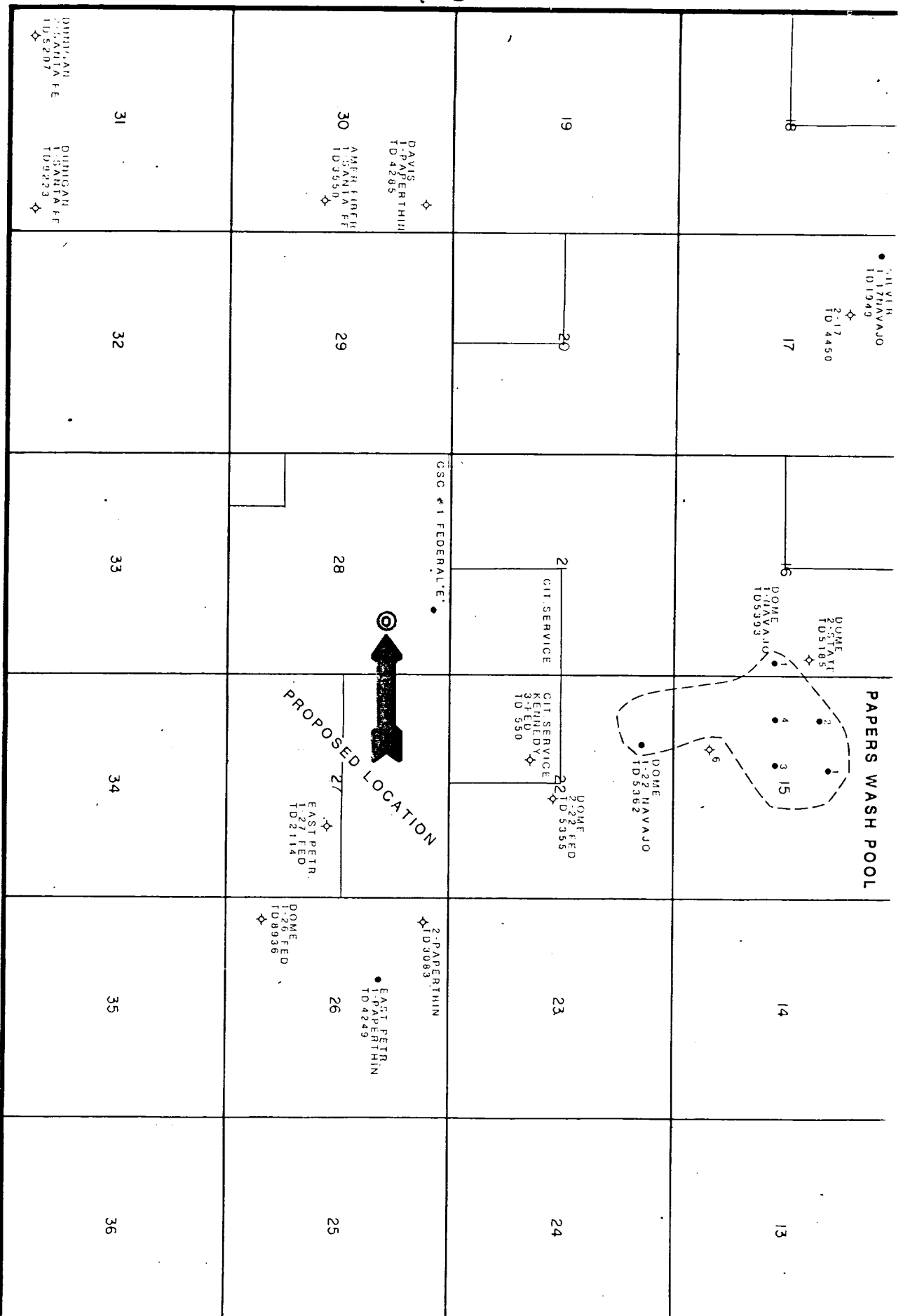

T. 19 N.

R. 5 W.

Cities Service Co.'s  
FEDERAL "E" No. 2  
1650' FNL & 330' FEL  
Section 28-19N-5W  
McKinley County, New Mexico  
Lse # NM C999

# LOCATION PLAT

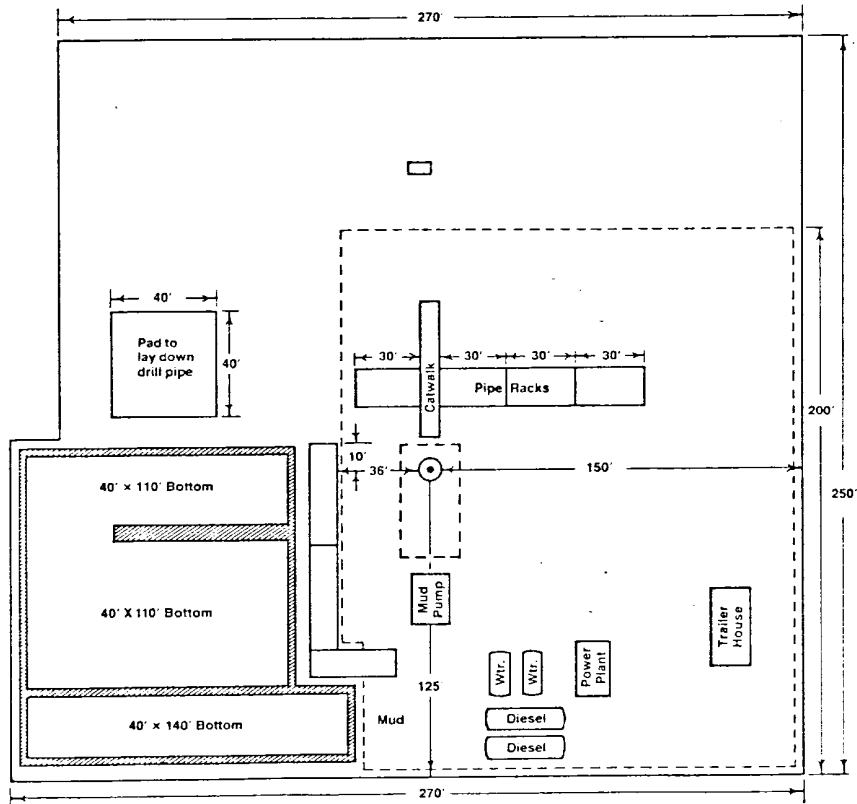

Cities Service Co.'s  
FEDERAL "E" No. 2  
1650' FNL & 990' FEL  
Section 28-19N-5W  
McKinley County, New Mexico  
Lse # NM 6999