

XM 13580

T17U,R11W

MAINTAINED ROADS

LOCAL ROADS

McKINNEY #1

Flowing Well

To Crown Point

Laguna
Castillo

South Ranch

Star Heart Rock

24

22

25

26

27

18

19

10

15

13

14

16

30

25

26

27

28

29

30

31

32

33

34

35

36

37

38

39

40

41

42

43

44

45

46

47

48

49

50

51

52

53

54

55

56

57

58

59

60

61

62

63

64

65

66

67

68

69

70

71

72

73

74

75

76

77

78

79

80

81

82

83

84

85

86

87

88

89

90

91

92

93

94

95

96

97

98

99

100

101

102

103

104

105

106

107

108

109

110

111

112

113

114

115

116

117

118

119

120

121

122

123

124

125

126

127

128

129

130

131

132

133

134

135

136

137

138

139

140

141

142

143

144

145

146

147

148

149

150

151

152

153

154

155

156

157

158

159

160

161

162

163

164

165

166

167

168

169

170

171

172

173

174

175

176

177

178

179

180

181

182

183

184

185

186

187

188

189

190

191

192

193

194

195

196

197

198

199

200

201

202

203

204

205

206

207

208

209

210

211

212

213

214

215

216

217

218

219

220

221

222

223

224

225

226

227

228

229

230

231

232

233

234

235

236

237

238

239

240

241

242

243

244

245

246

247

248

249

250

251

252

253

254

255

256

257

258

259

260

261

262

263

264

265

266

267

268

269

270

271

272

273

274

275

276

277

278

279

280

281

282

283

284

285

286

287

288

289

290

291

292

293

294

295

296

297

298

299

300

301

302

303

304

305

306

307

308

309

310

311

312

313

314

315

316

317

318

319

320

321

322

323

324

325

UNITED STATES
DEPARTMENT OF THE INTERIOR
GEOLOGICAL SURVEY

APPLICATION FOR PERMIT TO DRILL, DEEPEN, OR PLUG BACK

1a. TYPE OF WORK

DRILL ☒DEEPEN ☐PLUG BACK ☐

b. TYPE OF WELL

OIL
WELL ☒GAS
WELL ☐

OTHER

SINGLE
ZONE ☐MULTIPLE
ZONE ☐

2. NAME OF OPERATOR

HUBBELL DRILLING COMPANY

3. ADDRESS OF OPERATOR

P. O. BOX 266 Prewitt NM 87045

4. LOCATION OF WELL (Report location clearly and in accordance with any State requirements*)
At surface 1950 FNL 1950 FWL

At proposed prod. zone

14. DISTANCE IN MILES AND DIRECTION FROM NEAREST TOWN OR POST OFFICE*

About 12 miles Southeast of Crownpoint

15. DISTANCE FROM PROPOSED*

LOCATION TO NEAREST
PROPERTY OR LEASE LINE, FT.
(Also to nearest drilg. unit line, if any)

630'

16. NO. OF ACRES IN LEASE*

880

17. NO. OF ACRES ASSIGNED
TO THIS WELL

40

18. DISTANCE FROM PROPOSED LOCATION*
TO NEAREST WELL, DRILLING, COMPLETED,
OR APPLIED FOR, ON THIS LEASE, FT.

--

19. PROPOSED DEPTH

200'

20. ROTARY OR CABLE TOOLS

Combination Air & Cable Tls.

21. ELEVATIONS (Show whether DF, RT, GR, etc.)

6680 GR

22. APPROX. DATE WORK WILL START*

23. PROPOSED CASING AND CEMENTING PROGRAM

SIZE OF HOLE	SIZE OF CASING	WEIGHT PER FOOT	SETTING DEPTH	QUANTITY OF CEMENT
7 inch	5.5" New	10.5#	170 feet	17 8x common cement

If production is indicated we propose to set 2 7/8 inch tubing to TD and circulate cement to surface.

This borehole is intended to test the oil shows at 180 to 200 feet that were encountered in the nearby Senutovitch 14-3 well.

The test will start in the Satan Shale and should reach the Neta Sand at about 180'.

Well control will be by full opening globe valve with oil saver.

Logging will be by cutting samples.

IN ABOVE SPACE DESCRIBE PROPOSED PROGRAM: If proposal is to deepen or plug back, give pertinent data on present productive zone and proposed new productive zone. If proposal is to drill or deepen directionally, give pertinent data on subsurface locations and measured and true vertical depths. Give blowout preventer program, if any.

24.

SIGNED

Thomas L. Chace

TITLE

MAR 27 1981
GEOCON. COM.
DIST. 3

DATE March 2, 1981

(This space for Federal or State office use)

PERMIT NO.

APPROVAL

APPROVED BY

CONDITIONS OF APPROVAL, IF ANY:

APPROVED
AS AMENDED

DATE MAR 26 1981

James F. Sims
JAMES F. SIMS
DISTRICT ENGINEER

All distances must be from the outer boundaries of the Section.

Operator		Lease		Well No.	
Init Letter	Section	Township	Range	County	
F	14	17 North	11 West	McKinley	
Actual Postage Location of Well:					
1950 feet from the North line and		1950 feet from the West line			
Ground Level Elev.	Producing Formation		Dedicated Acreage:		Acre
6680			40		

1. Outline the acreage dedicated to the subject well by colored pencil or hatchure marks on the plat below.
2. If more than one lease is dedicated to the well, outline each and identify the ownership thereof (both as to working interest and royalty).
3. If more than one lease of different ownership is dedicated to the well, have the interests of all owners been consolidated by communitization, unitization, force-pooling, etc?

☐ Yes ☐ No If answer is "yes," type of consolidation _____

If answer is "no," list the owners and tract descriptions which have actually been consolidated. (Use reverse side of this form if necessary.) _____

No allowable will be assigned to the well until all interests have been consolidated (by communitization, unitization, forced-pooling, or otherwise) or until a non-standard unit, eliminating such interests, has been approved by the Division.

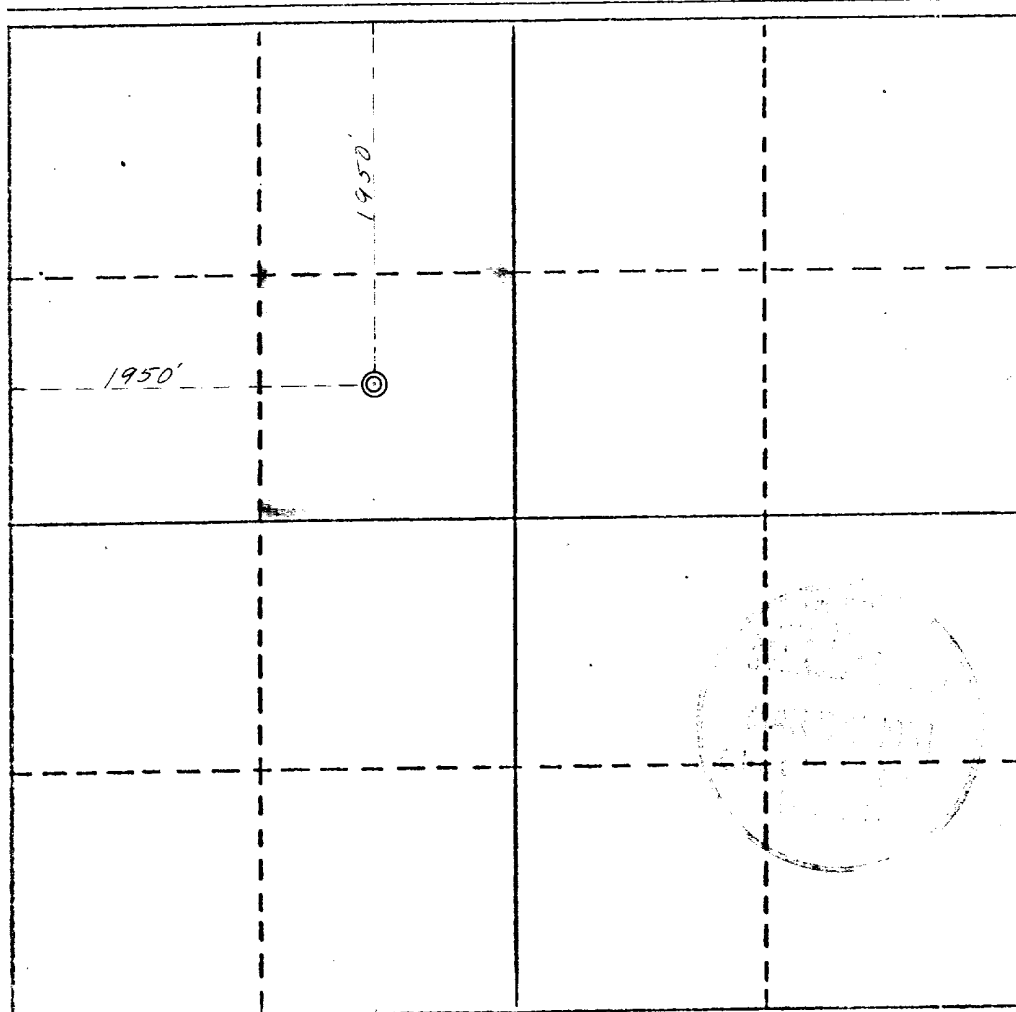

CERTIFICATION

I hereby certify that the information contained herein is true and complete to the best of my knowledge and belief.

Name Thomas A. Chan

Position Surveyor

Company McKinley

Date March 2, 1981

I hereby certify that the well location shown on this plat was plotted from field notes of actual surveys made by me or under my supervision, and that the same is true and correct to the best of my knowledge and belief.

March 2, 1981

Date Surveyed

Registered Professional Engineer and/or Land Surveyor

Certificate No.
N M #1161

