

NO. OF COPIES RECEIVED	
DISTRIBUTION	
SANTA FE	
FILE	
U.S.G.S.	
LAND OFFICE	
OPERATOR	

5A. Indicate Type of Lease	
STATE <input type="checkbox"/>	FEE <input checked="" type="checkbox"/>
5. State Oil & Gas Lease No.	

## APPLICATION FOR PERMIT TO DRILL, DEEPEN, OR PLUG BACK

1a. Type of Work

DRILL ☒DEEPEN ☐

b. Type of Well

OIL WELL ☒GAS WELL ☐OTHER ☐

2. Name of Operator

SIERRA OIL AND GAS COMPANY

3. Address of Operator

1444 WAZEE, SUITE 340, DENVER, COLORADO 80202

4. Location of Well

UNIT LETTER J

LOCATED 1980

FEET FROM THE EAST LINE

AND 1980

FEET FROM THE

SOUTH

LINE OF SEC. 9

TWP. 17N

RGE. 12W

NMPM

7. Unit Agreement Name

8. Farm or Lease Name

SECO NM-AZ LAND CO. 9

9. Well No.

22

10. Field and Pool, or Wildcat

WILDCAT Permian

12. County

MCKINLEY

19. Proposed Depth

2300

19A. Formation

ABO

20. Rotary or C.T.

ROTARY

21. Elevations (Show whether DF, RT, etc.)

GL 6704

21A. Kind &amp; Status Plug. Bond

\$50,000 BLANKET IN  
FORCE

21B. Drilling Contractor

STEWART BROS.

22. Approx. Date Work will start

10-1-81

23.

## PROPOSED CASING AND CEMENT PROGRAM

SIZE OF HOLE	SIZE OF CASING	WEIGHT PER FOOT	SETTING DEPTH	SACKS OF CEMENT	EST. TOP
12 1/4	10-3/4	32-75	100	200	SURFACE
9-7/8	7-5/8	24	1000	200	SURFACE
6-3/4	4 1/2	10.5	2300	200	1500'

1. Drill 12 1/4" hole to approximately 100'; run and cement 10-3/4" casing.
2. Drill 9-7/8" hole to approximately 1000'; run and cement 7-5/8" casing.
3. Drill 6-3/4" hole to approximately 2300'; test and log zones of interest. If tests warrant, run and cement 4 1/2" production string. Perforate and test well for completion.
4. If no commercial production is found, plug well according to State rules.
5. Use adequate BOP equipment throughout operations.

APPROVAL VALID  
FOR 90 DAYS UNLESS  
DRILLING COMMENCED,

EXPIRES 3-10-82

IN ABOVE SPACE DESCRIBE PROPOSED PROGRAM: IF PROPOSAL IS TO DEEPEN OR PLUG BACK, GIVE DATA ON PRESENT PRODUCTIVE ZONE AND PROPOSED NEW PRODUCTIVE ZONE. GIVE BLOWOUT PREVENTER PROGRAM, IF ANY.

I hereby certify that the information above is true and complete to the best of my knowledge and belief.

Signed C. J. [Signature] Title Vice President-Operations Date September 2, 1981

(This space for State Use)

APPROVED BY [Signature] TITLE SUPERVISOR DISTRICT # 3 DATE SEP 10 1981

CONDITIONS OF APPROVAL, IF ANY:

All distances must be from the outer boundaries of the Section.

Operator <b>SIERRA OIL AND GAS COMPANY</b>			Lease <b>SECO NM-AZ LAND CO.</b>			Well No. <b>9-2</b>	
Unit Letter <b>J</b>	Section <b>9</b>	Township <b>17N</b>	Range <b>12W</b>	County <b>MCKINLEY</b>			
Actual Footage Location of Well:							
<b>1980</b>		feet from the <b>EAST</b>		line and <b>1980</b>		feet from the <b>SOUTH</b>	
Ground Level Elev. <b>6704</b>	Producing Formation <b>WILDCAT</b>		Pool			Dedicated Acreage: <b>40</b> Acres	

1. Outline the acreage dedicated to the subject well by colored pencil or hatchure marks on the plat below.
2. If more than one lease is dedicated to the well, outline each and identify the ownership thereof (both as to working interest and royalty).
3. If more than one lease of different ownership is dedicated to the well, have the interests of all owners been consolidated by communitization, unitization, force-pooling, etc?

☐ Yes ☐ No If answer is "yes," type of consolidation \_\_\_\_\_

If answer is "no," list the owners and tract descriptions which have actually been consolidated. (Use reverse side of this form if necessary.) \_\_\_\_\_

No allowable will be assigned to the well until all interests have been consolidated (by communitization, unitization, forced-pooling, or otherwise) or until a non-standard unit, eliminating such interests, has been approved by the Division.

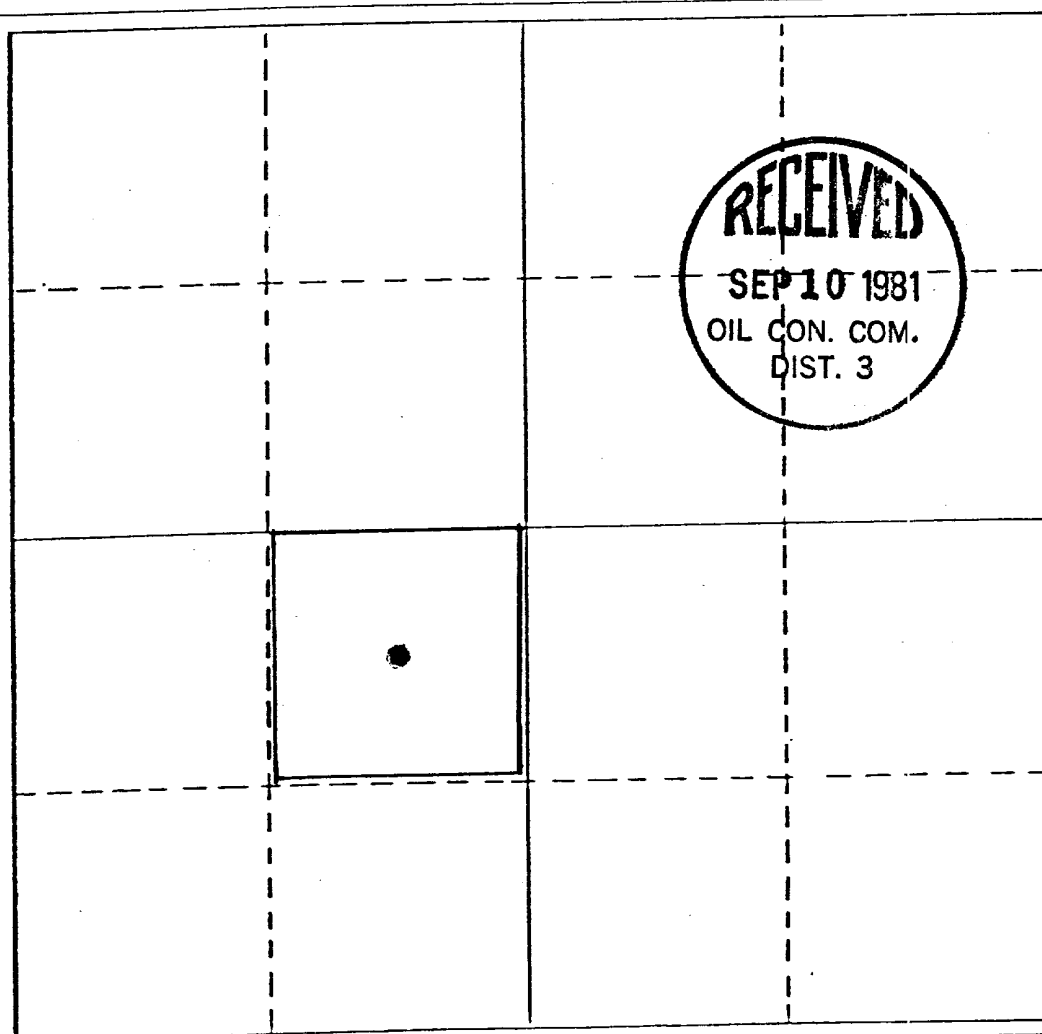

CERTIFICATION

I hereby certify that the information contained herein is true and complete to the best of my knowledge and belief.

*C.L. Creager*  
Name

C.L. CREAGER

Position  
Vice President-Operations

Company  
Sierra Oil & Gas Co.

Date  
September 2, 1981

I hereby certify that the well location shown on this plat was plotted from field notes of actual surveys made by me or under my supervision, and that the same is true and correct to the best of my knowledge and belief.

Date Surveyed

Registered Professional Engineer  
and/or Land Surveyor

Certificate No.

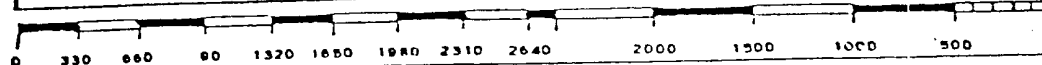

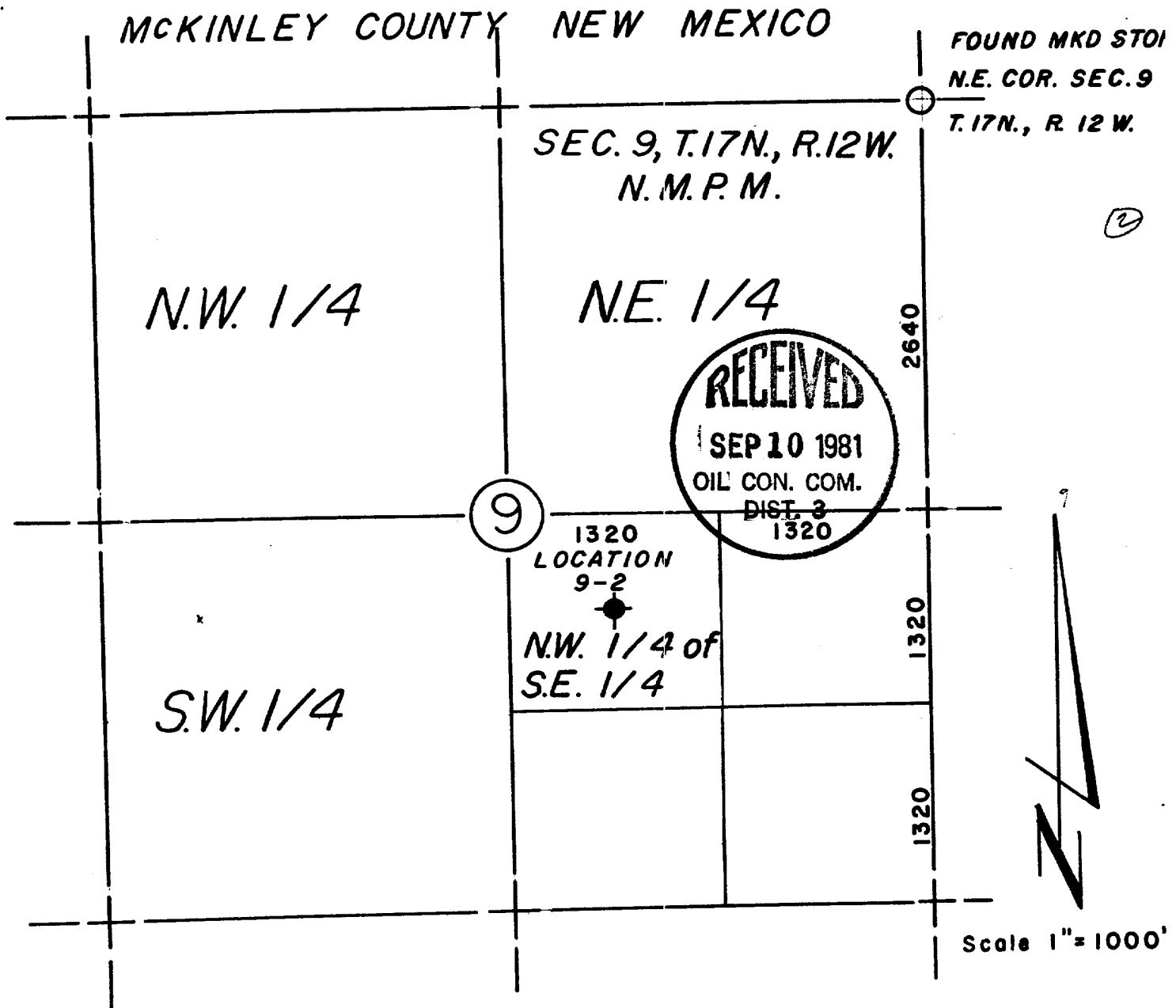

# LEGAL DESCRIPTION

SECO NM-AZ LAND CO. 9-2 is located 3300 feet South and 1980 feet West of the North East corner of Section 9, T. 17 N., R. 12 W., N.M.P.M., McKinley County, New Mexico. Elevation at the location is 6704.44

This is to certify that I am a Registered Land Surveyor and that work was done by actual field notes by me or under my supervision and are true and correct to the best of my knowledge and belief.

*Dennis L. Mirabal*  
Dennis L. Mirabal, P.L.S.  
Lic. No. 7001  
August 19, 1981

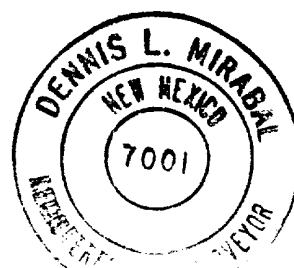

## GEOLOGICAL SURVEY

