

NO. OF COPIES RECEIVED	
STATION	
SANTA FE	
FILE	
U.S.G.S.	
LAND OFFICE	
OPERATOR	

P.O. BOX 2088 *20051-20100*
 SANTA FE, NEW MEXICO 87501

5A. Indicate Type of Lease
STATE <input checked="" type="checkbox"/> FEE <input type="checkbox"/>
5. State Oil & Gas Lease No.
LG 2779

APPLICATION FOR PERMIT TO DRILL, DEEPEN, OR PLUG BACK

Type of Work

DRILL ☒ DEEPEN ☐ PLUG BACK ☐

Type of Well

OIL WELL ☒ GAS WELL ☐ OTHER ☐

SINGLE ZONE ☐ MULTIPLE ZONE ☐

7. Unit Agreement Name

8. Farm or Lease Name

State

Name of Operator

RED MOUNTAIN ASSOCIATES c/o M. Zenati

9. Well No.

25

Address of Operator

2626 Holly St., Denver Co 80207

10. Field and Pool, or Wildcat

CHACO WASH. (M.V.)

Location of Well

UNIT LETTER B LOCATED 350 FEET FROM THE North LINE

2260 FEET FROM THE East LINE OF SEC. 28 TWP. 20M RGE. 9W NMPM

11. County

McKinley

19. Proposed Depth		
1400'		
19A. Formation		
Menefee		
20. Rotary or C.T.		
Rotary		

Elevations (Show whether DF, RT, etc.)	21A. Kind & Status Plug. bond	21B. Drilling Contractor	22. Approx. Date Work will start
6428 GL		Meztemp Drilling Co.	December 30, 1981

PROPOSED CASING AND CEMENT PROGRAM

SIZE OF HOLE	SIZE OF CASING	WEIGHT PER FOOT	SETTING DEPTH	SACKS OF CEMENT	EST. TOP
6 3/4	4 1/2	10.5 #	T.D	170	Surface

Operator proposes to drill this well to test the Fino and Chaco Wash sands and deeper sands for oil production and development of secondary recovery potential

Water base mud will be used to remove cuttings

Resistivity logs will be used to evaluate the pay zones along with cores of selected intervals

Close spacing is required to obtain economical drainage of this very low pressure reservoir.

APPROVAL VALID
 FOR 90 DAYS UNLESS
 DRILLING COMMENCED

DOVE SPACE DESCRIBE PROPOSED PROGRAM: IF PROPOSAL IS TO DEEPEN OR PLUG BACK, GIVE DATA ON PRESENT PRODUCTIVE ZONE AND PROPOSED NEW PROGRAM. GIVE BLOWOUT PREVENTER PROGRAM, IF ANY.

I hereby certify that the information above is true and complete to the best of my knowledge and belief.

M. Zenati Title Petroleum Engineer Date 12/15/1981

(This space for State Use)

APPROVED BY Jeff A. Edmister TITLE DEPUTY OIL & GAS INSPECTOR, DIST. #3 DATE DEC 21 1981

CONDITIONS OF APPROVAL, IF ANY:

STATE OF NEW MEXICO
ENERGY AND MINERALS DEPARTMENT

OIL CONSERVATION DIVISION

P. O. BOX 2088

SANTA FE, NEW MEXICO 87501

Form C-102
Revised 10-1-78

All distances must be from the outer boundaries of the Section.

Operator Red Mountain Associates Ltd. Partners			Lease State		Well No. 25
Unit Letter B	Section 28	Township 20 North	Range 9 West	County McKinley	
Actual Footage Location of Well: 350 feet from the North line and 2260 feet from the East line					
Ground Level Elev. 6428	Producing Formation Menefee		Pool Chaco Wash		Dedicated Acreage: 40 Acres

- Outline the acreage dedicated to the subject well by colored pencil or hachure marks on the plat below.
- If more than one lease is dedicated to the well, outline each and identify the ownership thereof (both as to working interest and royalty).
- If more than one lease of different ownership is dedicated to the well, have the interests of all owners been consolidated by communitization, unitization, force-pooling, etc?

☐ Yes ☐ No If answer is "yes," type of consolidation _____

If answer is "no," list the owners and tract descriptions which have actually been consolidated. (Use reverse side of this form if necessary.) _____

No allowable will be assigned to the well until all interests have been consolidated (by communitization, unitization, forced-pooling, or otherwise) or until a non-standard unit, eliminating such interests, has been approved by the Division.

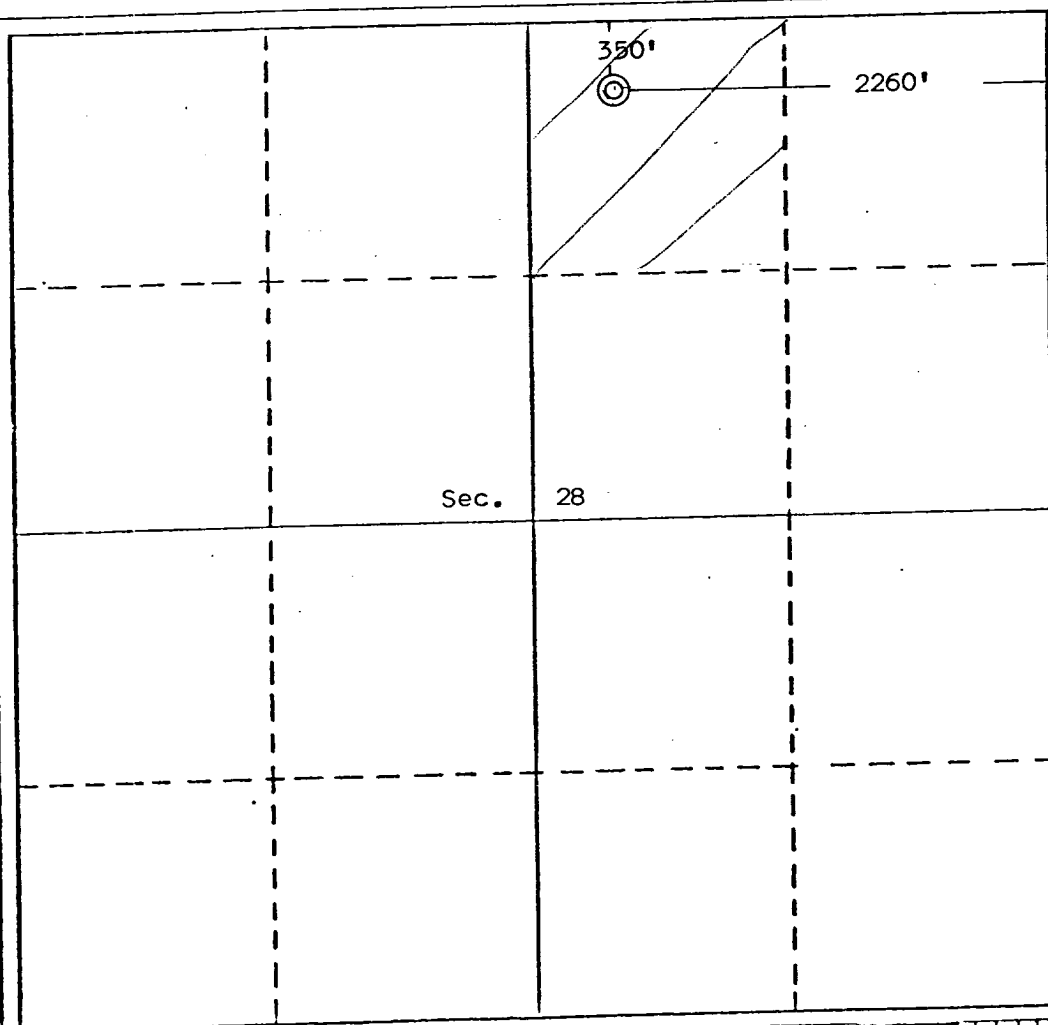

CERTIFICATION

I hereby certify that the information contained herein is true and complete to the best of my knowledge and belief.

Name
M. ZENATI

Position
Engineer

Company

Date
12/17/81

I hereby certify that the location shown on this plat was from field notes of actual survey made by me or under my supervision, and that the same is correct to the best of my knowledge and belief.

Date Surveyed

December 9, 1981

Registered Professional Engineer and/or Land Surveyor

Edgar L. Risenhoover
Certificate No.

