

NO. OF COPIES RECEIVED	
DISTRIBUTION	
SANTA FE	
FILE	
U.S.G.S.	
LAND OFFICE	
OPERATOR	

P. O. BOX 2088
SANTA FE, NEW MEXICO 87501

30-031-20781

5A. Indicate Type of Lease
STATE ☐ FEE ☒

5. State Oil & Gas Lease No.
09725

7. Unit Agreement Name
Miguel Creek

8. Form or Lease Name
S.F.P.R.R.

9. Well No.
86

10. Field and Pool, or Wildcat
Miguel Creek Gallup Extension

12. County
McKinley

APPLICATION FOR PERMIT TO DRILL, DEEPEN, OR PLUG BACK

1a. Type of Work
DRILL ☒ DEEPEN ☐ PLUG BACK ☐

b. Type of Well
OIL WELL ☒ GAS WELL ☐ OTHER ☐ SINGLE ZONE ☒ MULTIPLE ZONE ☐

2. Name of Operator
Capital Oil and Gas Corporation

3. Address of Operator
P. O. Box 2130, Kilgore, Texas 75662

4. Location of Well
UNIT LETTER J LOCATED 1650 FEET FROM THE South LINE
AND 1650 FEET FROM THE East LINE OF SEC. 17 TWP. 16N RGE. 6W NMPM

15. Proposed Depth
1000'

19A. Formation
Hospah-Gallup

20. Rotary or C.T.
Rotary

21. Elevations (Show whether D.F., R.T., etc.)
6615.81

21A. Kind & Status Plug. Bond
\$50,000 Blanket

21B. Drilling Contractor
Alamo Drilling, Inc.

22. Approx. Date Work will start
4/20/82

23. PROPOSED CASING AND CEMENT PROGRAM

SIZE OF HOLE	SIZE OF CASING	WEIGHT PER FOOT	SETTING DEPTH	SACKS OF CEMENT	EST. TOP
12-1/4"	8-5/8"	24#	80'	75	Surface
7-7/8"	5-1/2"	14#	1000'	75	500'

1. Drill 85' 12-1/4" hole.
2. Set 8-5/8" surface casing.
3. Circulate cement to surface.
4. Drill and core to a depth of 25' below Hospah Sand.
5. Run electric log.
6. Set 5-1/2" casing 20' below Hospah zone.
7. Cement with 75 sx.
8. Perforate and put on production.

EXPIRES October 19, 1982



IN ABOVE SPACE DESCRIBE PROPOSED PROGRAM IF PROPOSAL IS TO DEEPEN OR PLUG BACK, GIVE DATA ON PRESENT PRODUCTIVE ZONE AND PROPOSED NEW PRODUCTIVE ZONE. GIVE CEMENT PREVENTED PROGRAM, IF ANY.

I hereby certify that the information above is true and complete to the best of my knowledge and belief.

Signed Jean Houston Title Agent Date 4/13/82

(This space for State Use)
APPROVED BY Frank T. Quigley TITLE SUPERVISOR DISTRICT # 3 DATE APR 19 1982

CONDITIONS OF APPROVAL, IF ANY:

OIL CONSERVATION DIVISION

P. O. BOX 2088

SANTA FE, NEW MEXICO 87501

Form C-102
Revised 10-1-78

All distances must be from the outer boundaries of the Section.

Operator Capital Oil and Gas Corporation		Lease S.F.P.R.R.		Well No. S.F.P.R.R. #86	
Unit Letter J	Section 17	Township 16N.	Range 6W.	County McKinley	
Actual Footage Location of Well: 1650' feet from the South line and 1650' feet from the East line					
Ground Level Elev. 6615.81	Producing Formation Hospah		Pool Miguel Creek Gallup Extension		Dedicated Acreage: 40 Acres

1. Outline the acreage dedicated to the subject well by colored pencil or hachure marks on the plat below.
2. If more than one lease is dedicated to the well, outline each and identify the ownership thereof (both as to working interest and royalty).
3. If more than one lease of different ownership is dedicated to the well, have the interests of all owners been consolidated by communitization, unitization, force-pooling, etc?

☐ Yes ☒ No If answer is "yes," type of consolidation _____

If answer is "no," list the owners and tract descriptions which have actually been consolidated. (Use reverse side of this form if necessary.) Capital Oil and Gas Corporation and Zenith Energy Corporation own 100% working interest in the lease.

No allowable will be assigned to the well until all interests have been consolidated (by communitization, unitization, forced-pooling, or otherwise) or until a non-standard unit, eliminating such interests, has been approved by the Commission.

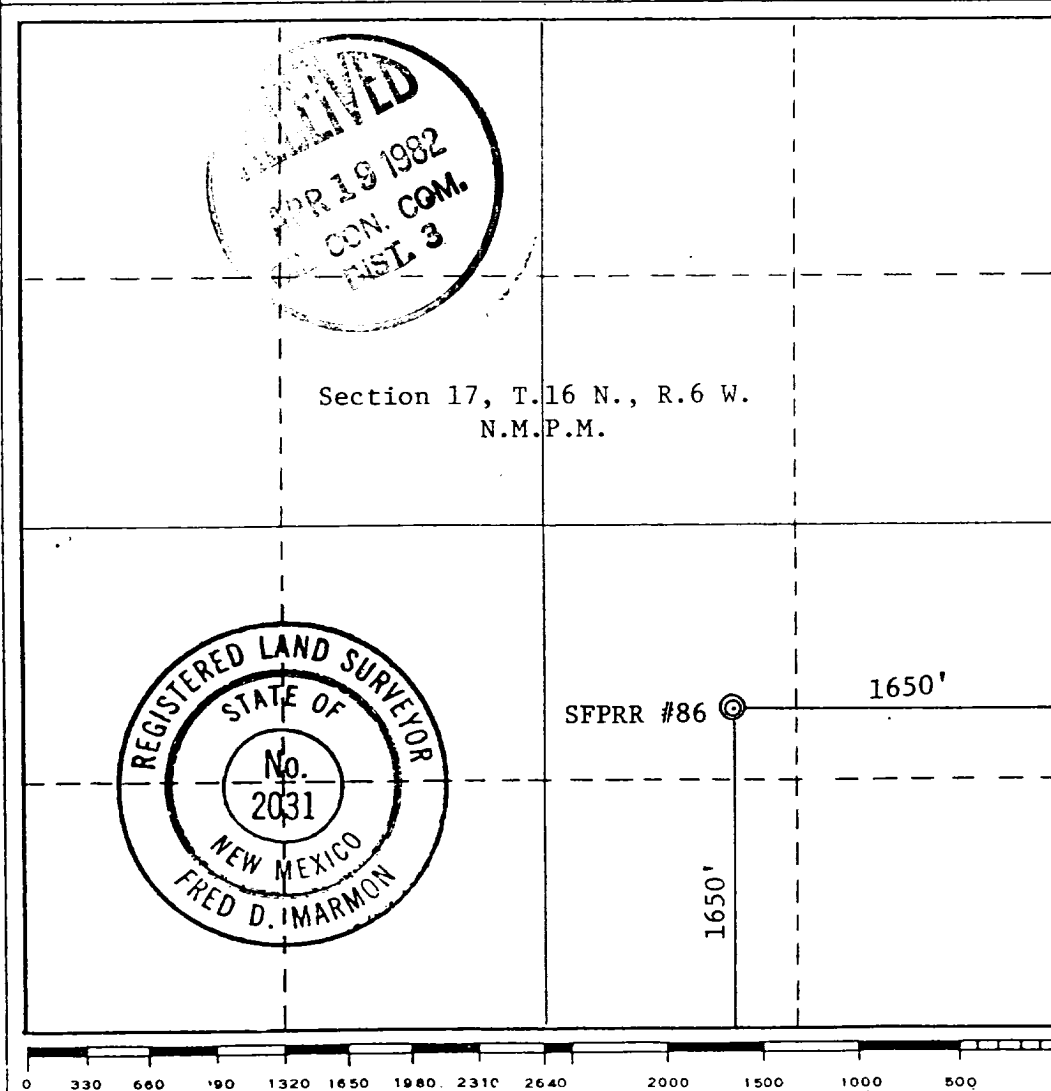

CERTIFICATION

I hereby certify that the information contained herein is true and complete to the best of my knowledge and belief.

Name Jean Houston
Position
Agent
Company Capital Oil and Gas Corporation
Date
4/13/82

I hereby certify that the well location shown on this plat was plotted from field notes of actual surveys made by me or under my supervision, and that the same is true and correct to the best of my knowledge and belief.

Date Surveyed
March 21, 1982

Registered Professional Engineer
and/or Land Surveyor

Fred D. Marmon
Certificate No.
2031