

NO. OF COPIES RECEIVED	
DISTRIBUTION	
SANTA FE	
FILE	
U.S.G.S.	
LAND OFFICE	
OPERATOR	

P. O. BOX 2088  
SANTA FE, NEW MEXICO 87501

30-031-20782

5A. Indicate Type of Lease  
STATE ☐ FEE ☒

5. Time Oil & Gas Lease No.  
09725

## APPLICATION FOR PERMIT TO DRILL, DEEPEN, OR PLUG BACK

1a. Type of Work  
DRILL ☒ DEEPEN ☐ PLUG BACK ☐  
b. Type of Well  
OIL WELL ☒ GAS WELL ☐ OTHER ☐ SINGLE ZONE ☒ MULTIPLE ZONE ☐

7. Unit Agreement Name  
Miguel Creek

8. Name of Lessee Name  
S.F.P.R.R.

9. Well No.  
71

10. Field and Pool, or Wildcat  
Miguel Creek Gallup  
Extension

2. Name of Operator  
Capital Oil and Gas Corporation  
3. Address of Operator  
P. O. Box 2130, Kilgore, Texas 75662  
4. Location of Well UNIT LETTER I LOCATED 2310 FEET FROM THE South LINE  
AND 330 FEET FROM THE East LINE OF SEC. 20 TWP. 16N RST. 6W NMPM

12. County  
McKinley

15. Proposed Depth 1400'	19A. Formation Hospah-Gallup	20. Rotary or C.T. Rotary
21. Elevations (Show whether D.F., R.T., etc.) 6770.'	21A. Kind & Status Plug. Band \$50,000 Blanket	21B. Drilling Contractor Alamo Drilling, Inc.
		22. Approx. Date Work will start 4/20/82

## 23. PROPOSED CASING AND CEMENT PROGRAM

SIZE OF HOLE	SIZE OF CASING	WEIGHT PER FOOT	SETTING DEPTH	SACKS OF CEMENT	EST. TOP
12-1/4"	8-5/8"	24#	80'	75	Surface
7-7/8"	5-1/2"	14#	1400'	75	800'

1. Drill 85' 12-1/4" hole.
2. Set 8-5/8" surface casing.
3. Circulate cement to surface.
4. Drill and core to a depth of 25' below Hospah Sand.
5. Run electric log.
6. Set 5-1/2" casing 20' below Hospah zone.
7. Cement with 75 sx.
8. Perforate and put on production.

IN ABOVE SPACE DESCRIBE PROPOSED PROGRAM IF PROPOSAL IS TO DEEPEN OR PLUG BACK. GIVE DATA ON PRESENT PRODUCTIVE ZONE AND PROPOSED NEW PRODUCTIVE ZONE. GIVE SHUT-IN PREVENTER PROGRAM, IF ANY.

I hereby certify that the information above is true and complete to the best of my knowledge and belief.

Signed Jean Houston Title Agent Date 4/13/82

(This space for State Use)  
APPROVED BY Int'l. Party TITLE SUPERVISOR DISTRICT #3 DATE 4/20/82  
CONDITIONS OF APPROVAL, IF ANY:

APPROVAL VALID  
FOR 90 DAYS  
DRILLING COMPANY, INC.  
EXPIRES October 19, 1982

APR 19 1982  
OIL CON. COM.  
DIST. 3

## OIL CONSERVATION DIVISION

P. O. BOX 2088

SANTA FE, NEW MEXICO 87501

Form C-102  
Revised 10-1-78

All distances must be from the outer boundaries of the Section.

Operator Capital Oil and Gas Corporation		Lease S.F.P.R.R.		Well No. S.F.P.R.R. #71	
Unit Letter I	Section 20	Township 16N.	Range 6W.	County McKinley	
Actual Footage Location of Well: 2310' feet from the South line and 330' feet from the East line					
Ground Level Elev. 6770.'	Producing Formation Hospah	Pool Miguel Creek Gallup Extension		Dedicated Acreage: 40 Acres	

1. Outline the acreage dedicated to the subject well by colored pencil or hachure marks on the plat below.
2. If more than one lease is dedicated to the well, outline each and identify the ownership thereof (both as to working interest and royalty).
3. If more than one lease of different ownership is dedicated to the well, have the interests of all owners been consolidated by communitization, unitization, force-pooling, etc?

☐ Yes ☒ No If answer is "yes," type of consolidation \_\_\_\_\_

If answer is "no," list the owners and tract descriptions which have actually been consolidated. (Use reverse side of this form if necessary.) Capital Oil and Gas Corporation and Zenith Energy Corporation own 100% working interest in the lease.

No allowable will be assigned to the well until all interests have been consolidated (by communitization, unitization, forced-pooling, or otherwise) or until a non-standard unit, eliminating such interests, has been approved by the Commission.

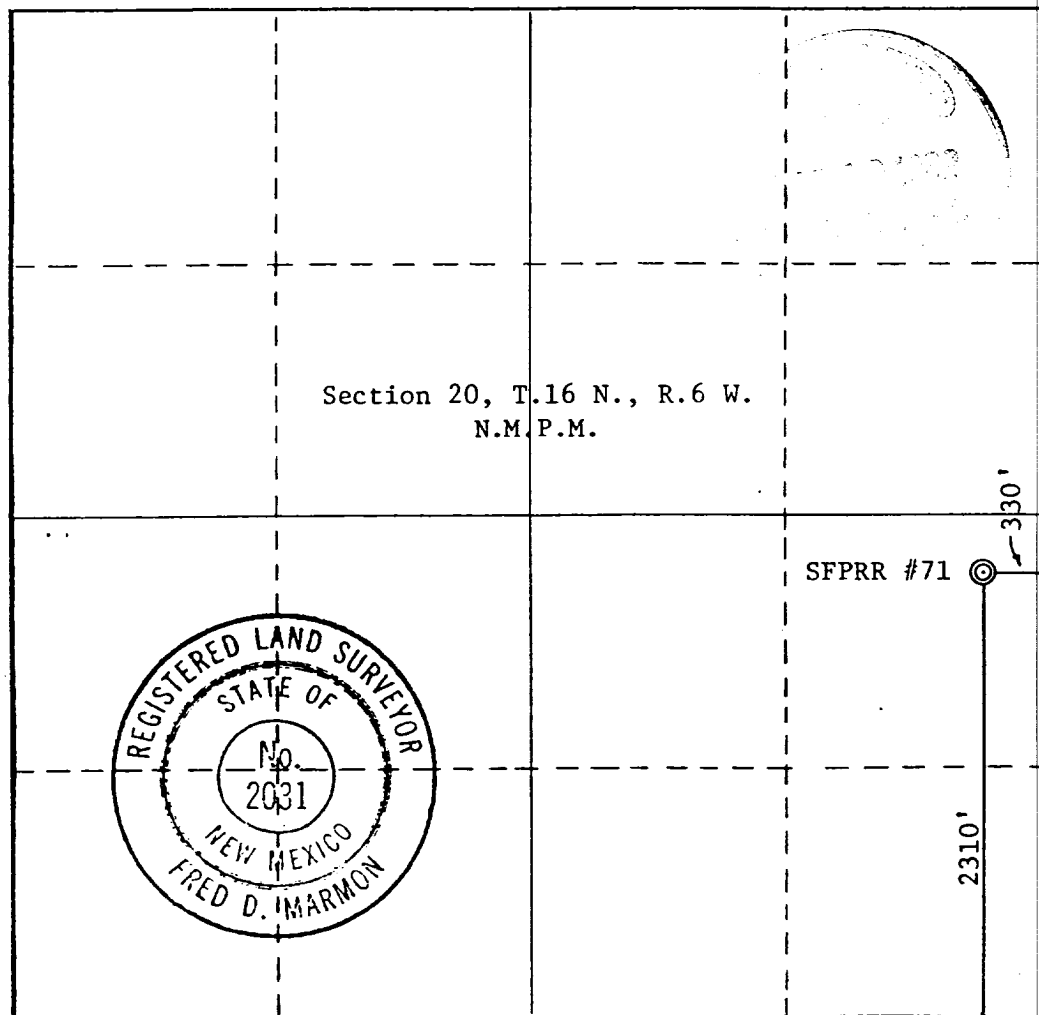

## CERTIFICATION

I hereby certify that the information contained herein is true and complete to the best of my knowledge and belief.

Name Jean Houston

Position

Agent

Company

Capital Oil and Gas Corporation

Date

4/13/82

I hereby certify that the well location shown on this plat was plotted from field notes of actual surveys made by me or under my supervision, and that the same is true and correct to the best of my knowledge and belief.

Date Surveyed

March 12, 1982

Registered Professional Engineer  
and/or Land Surveyor

Fred D. Marmon

Certificate No.

2031

0 330 660 990 1320 1650 1980 2310 2640 2000 1500 1000 500 0