



STATE OF NEW MEXICO
ENERGY AND MINERALS DEPARTMENT

OIL CONSERVATION DIVISION
AZTEC DISTRICT OFFICE

1000 RIO BRAZOS ROAD
AZTEC, NEW MEXICO 87410
(505) 334-6178

OIL CONSERVATION DIVISION
BOX 2088
SANTA FE, NEW MEXICO 87501

DATE 2-25-93

RE: Proposed MC _____
Proposed DHC _____
Proposed NSL ✓ _____
Proposed SWD _____
Proposed WFX _____
Proposed PMX _____

Gentlemen:

I have examined the application dated 2-25-93
for the Capital O & G Corp. SFPRR # 79 L-21-16N-6W
Operator Lease and Well No. Unit, S-T-R

and my recommendations are as follows:

Approve

Yours truly,

Jeff A. Edmister



RECEIVED

FEB 25 1983

OIL CON. DIV.

Capital Oil and Gas Corporation

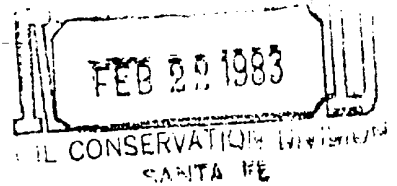

214 - 983-2081

February 17, 1983

214 - 983-2082

Mr. Joe Ramey
Energy and Minerals Department
Oil Conservation Commission
P. O. Box 2088
Santa Fe, New Mexico 87501

Re: Commission Order R-4875

Dear Mr. Ramey:

Enclosed is information needed for request of administrative approval for a nonstandard location for our SFPRR Nos. 79, 80 and 83 wells. The information enclosed is in compliance with the Operating Rules for the Waterflood Project, Miguel Creek Field, Gallup Pool, in McKinley County, New Mexico, Case No. 5321. As requested in Paragraph 6 of the Commission Order No. R-4875, we seek approval for a nonstandard location for SFPRR Nos. 79, 80 and 83.

- A. A plat marked "Exhibit A" for each well is enclosed, showing new location and the particle of acreage dedicated to the well.
- B. Enclosure for each well marked "Exhibit B" is an aerial map of each location and offset wells. At the present time, there are no offset producers except for Capital Oil and Gas Corporation in the area.
- C. "Exhibit C" is a downhole schematic of each well.
- D. "Exhibit D" is a Sundry Notice and Report on Well (Form C-103) for each well.
- E. A nonstandard location is needed for these wells to be in a line drive sequence for a proposed waterflood in this section of the field.
- F. To our knowledge, there are no water, oil and gas strata zones of the Gallup Hospah pay zone in this area.

This information should be satisfactory with the rules set forth in the Commission Order R-4875. If you need further information, please do not hesitate to contact me.

Yours very truly,

CAPITAL OIL AND GAS CORPORATION

By Gary Blanks
Gary Blanks, Vice President

GB:jh

१५२

6W

Q 161. E

Schematic

Tabular Data

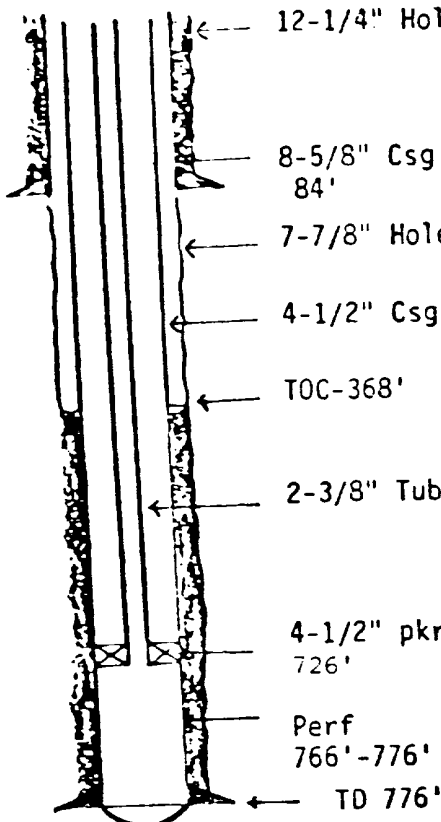

12-1/4" Hole Surface Casing

Size 8-5/8

Cemented with 75 SX SV.

LOC Surface

feet determined by Visual

8-5/8" Csg
84'

Hole size 12-1/4"

7-7/8" Hole

Intermediate Casing

Size None

Cemented with _____ 8x.

4-1/2" Csg

TOC

feet determined by

TOC-368'

Hole size

Long string

Size 4-1/2"

Completed with 85 3x.

2-3/8" Tubing

TOC 368

feet determined by Calculation

Male size 7-7/8"

4-1/2" pkr
726'

Total depth 786'

Perf
766'-776'

Injection interval

766' feet to 776' 4 JSPF feet
(perforated or open-hole, indicate which)

— TO 776'

Tubing size 2-3/8 lined with J-55 set in a (material)

Guiberson Unit - 1

packer at 726

feet

(or describe any other casing-tubing seal).

Other Data

1. Name of the injection formation Hospah-Gallup
2. Name of Field or Pool (if applicable) Miguel Creek-Gallup
3. Is this a new well drilled for injection? ☒ Yes ☐ No

If no, for what purpose was the well originally drilled?

4. Has the well ever been perforated in any other zone(s)? List all such perforated intervals and give plugging detail (sacks of cement or bridge plug(s) used) _____

No other perforations

5. Give the depth to and name of any overlying and/or underlying oil or gas zones (pools) in this area.

No other production in this area

EXHIBIT C

L CONSERVATION DIVISION

P. O. BOX 2088

SANTA FE, NEW MEXICO 87501

FEB 23 1983

Form C-102
Revised 10-1-78

All distances must be from the outer boundaries of the section

Operator Capital Oil and Gas Corporation			Lease S.F.P.R.R.		OIL CONSERVATION DIVISION SANTA FE	Well No. S.F.P.R.R. #79
Unit Letter L	Section 21	Township 16N.	Range 6W.	County McKinley		
Actual Footage Location of Well: 1330' feet from the South line and 10' feet from the West line						
Ground Level Elev. 6428.79'	Producing Formation Hospah-Gallup		Pool Miguel Creek Gallup Extension		Dedicated Acreage: 40 Acres	

1. Outline the acreage dedicated to the subject well by colored pencil or hatchure marks on the plat below.
2. If more than one lease is dedicated to the well, outline each and identify the ownership thereof (both as to working interest and royalty).
3. If more than one lease of different ownership is dedicated to the well, have the interests of all owners been consolidated by communitization, unitization, force-pooling, etc?

☐ Yes ☒ No If answer is "yes," type of consolidation _____

If answer is "no," list the owners and tract descriptions which have actually been consolidated. (Use reverse side of this form if necessary.) Capital Oil and Gas Corporation and Zenith Energy Corporation own 100% working interest in the lease
No allowable will be assigned to the well until all interests have been consolidated (by communitization, unitization, forced-pooling, or otherwise) or until a non-standard unit, eliminating such interests, has been approved by the Commission.

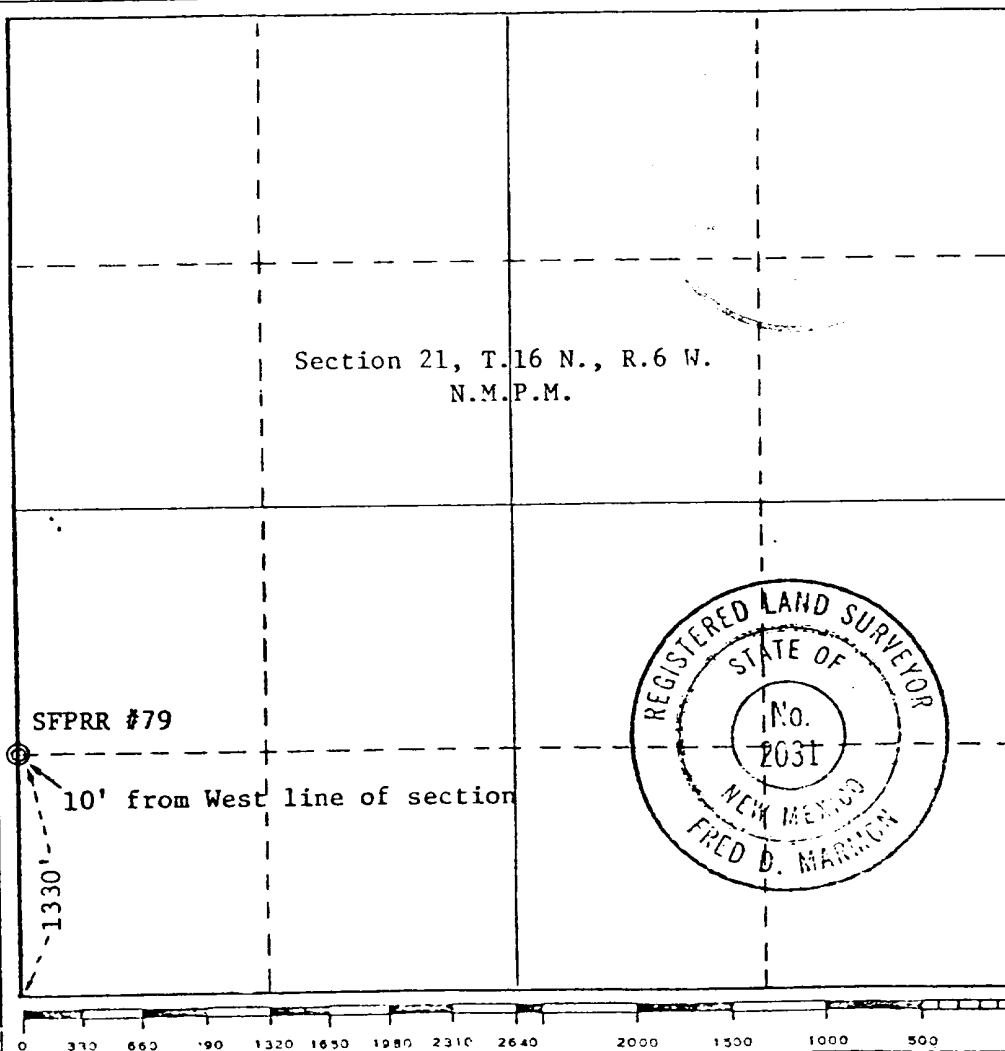

CERTIFICATION

I hereby certify that the information contained herein is true and complete to the best of my knowledge and belief.

Name Jean Houston

Position
Agent
Company **Capital Oil and Gas Corporation**

Date
4/22/82

I hereby certify that the well location shown on this plat was plotted from field notes of actual surveys made by me or under my supervision, and that the same is true and correct to the best of my knowledge and belief.

Date Surveyed
March 12, 1982

Registered Professional Engineer and/or Land Surveyor
Fred D. Marmon

Certificate No.
2031

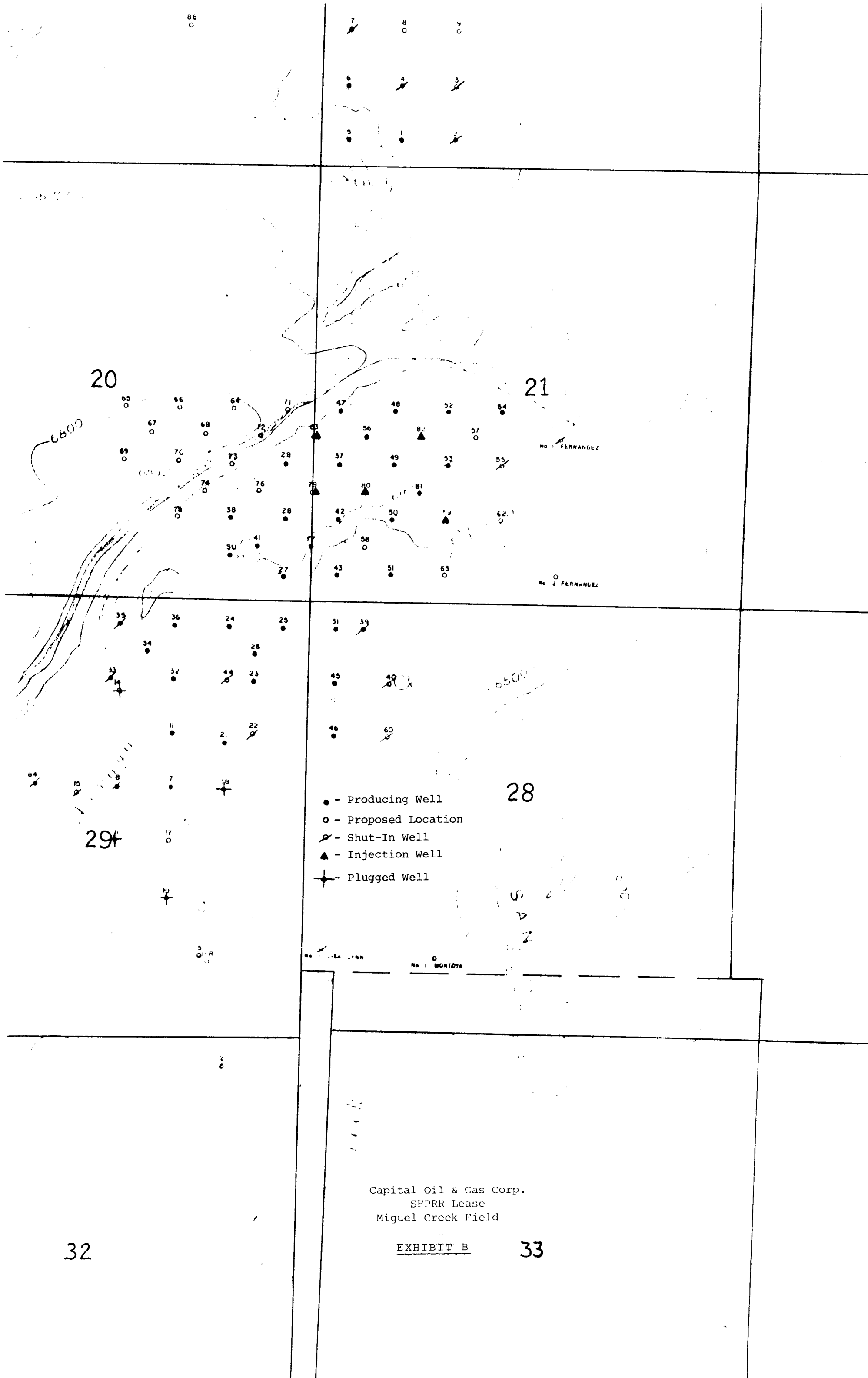

Capital Oil & Gas Corp.
SFPRR Lease
Miguel Creek Field

EXHIBIT B