

DATE RECEIVED	
DATE	
G.S.	
NO OFFICE	
PRATOR	

P. O. BOX 2088
SANTA FE, NEW MEXICO 87501

5A. Indicate Type of Lease
STATE ☒ REC ☐

5. Lease Oil & Gas Lease No.
L-6469

7. Unit Agreement Name
Miguel Creek - Gallup

8. Term of Lease Name
STATE

9. Well No.
State #20

10. Field and Pool, or Wildcat
WILDCAT Under Gallup

12. County
McKinley

APPLICATION FOR PERMIT TO DRILL, DEEPEN, OR PLUG BACK

1. Kind of Work
DRILL ☒ DEEPEN ☐ PLUG BACK ☐

2. Kind of Well
GAS WELL ☒ OTHER ☐ SINGLE ZONE ☐ MULTIPLE ZONE ☐

Name of Operator
CAPITAL OIL & GAS CORPORATION

Address of Operator
P. O. DRAWER M MILAN, NEW MEXICO 87021

Location of Well
UNIT LETTER D LOCATED 990 FEET FROM THE North LINE
90 West LINE OF SEC. 16 TWP. 16N R. 6W

15. Proposed Depth
1300'

19A. Formation
Hospah-Gallup

21A. Kind & Status of Plug and
\$50,000

21B. Drilling Contractor
Alamo Drilling, Inc.

22. Approx. Date Work will start
10-22-82

PROPOSED CASING AND CEMENT PROGRAM

SIZE OF HOLE	SIZE OF CASING	WEIGHT PER FOOT	SETTING DEPTH	SACKS OF CEMENT	EST. TOP
12 1/4	8 5/8	24	90 ft.	85	Surface
7 7/8	5 1/2	15-50	TD	175	400

- Drill 12 1/4 hole. Set 2 joints 8 5/8. Cement surface.
- Drill to top of Hospah.
- Core log. Drill 20' rat hole
- If commercially productive, set 4 1/2 casing to total depth and cement with 175 sacks of cement.

APPROVAL VALID
FOR 60 DAYS UNLESS
DRILLING COMMENCED,

EXPIRES 5-8-83

VE SPACE DESCRIBE PROPOSED PROGRAM IF PROPOSAL IS TO DEEPEN OR PLUG BACK, GIVE DATA ON PRESENT PRODUCTIVE ZONE AND PROPOSED NEW PRODU-
TION, SIZE, SLOPE, PREVENTED PROGRAM, IF ANY.

certify that the information above is true and complete to the best of my knowledge and belief.

Signed by Jim Lepper Title Representative Date 10/22/82

SIGNED BY Frank J. Day TITLE SUPERVISOR DISTRICT # 2 DATE NOV 8 1982

REMARKS OF APPROVAL, IF ANY:
Joint with well #19

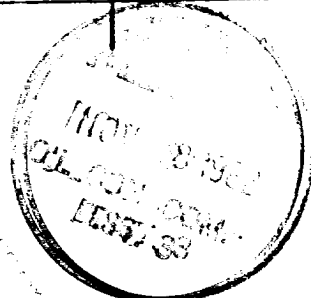

OIL CONSERVATION DIVISION

P. O. BOX 2088

SANTA FE, NEW MEXICO 87501

Form C-102
Revised 10-1-78*Milton Office*

All distances must be from the outer boundaries of the Section.

Capital Oil & Gas			Lease State Lease L-6469		Well No. State #20
Section 16	Township 16N.	Range 6W.	County McKinley		
Footage Location of Well: 990' feet from the North line and 990' feet from the West line					
Level Elev. 5463.58'	Producing Formation Hospah-Gallup	Pool Undes	Dedicated Acreage: 40 Joint with well #19 Acres		

1. Outline the acreage dedicated to the subject well by colored pencil or hatchure marks on the plat below.

2. If more than one lease is dedicated to the well, outline each and identify the ownership thereof (both as to working interest and royalty).

3. If more than one lease of different ownership is dedicated to the well, have the interests of all owners been consolidated by communitization, unitization, force-pooling, etc?

☐ Yes ☒ No If answer is "yes," type of consolidation _____

If answer is "no," list the owners and tract descriptions which have actually been consolidated. (Use reverse side of this form if necessary.) Golden Exploration owns 100% interest

No allowable will be assigned to the well until all interests have been consolidated (by communitization, unitization, forced-pooling, or otherwise) or until a non-standard unit, eliminating such interests, has been approved by the Commission.

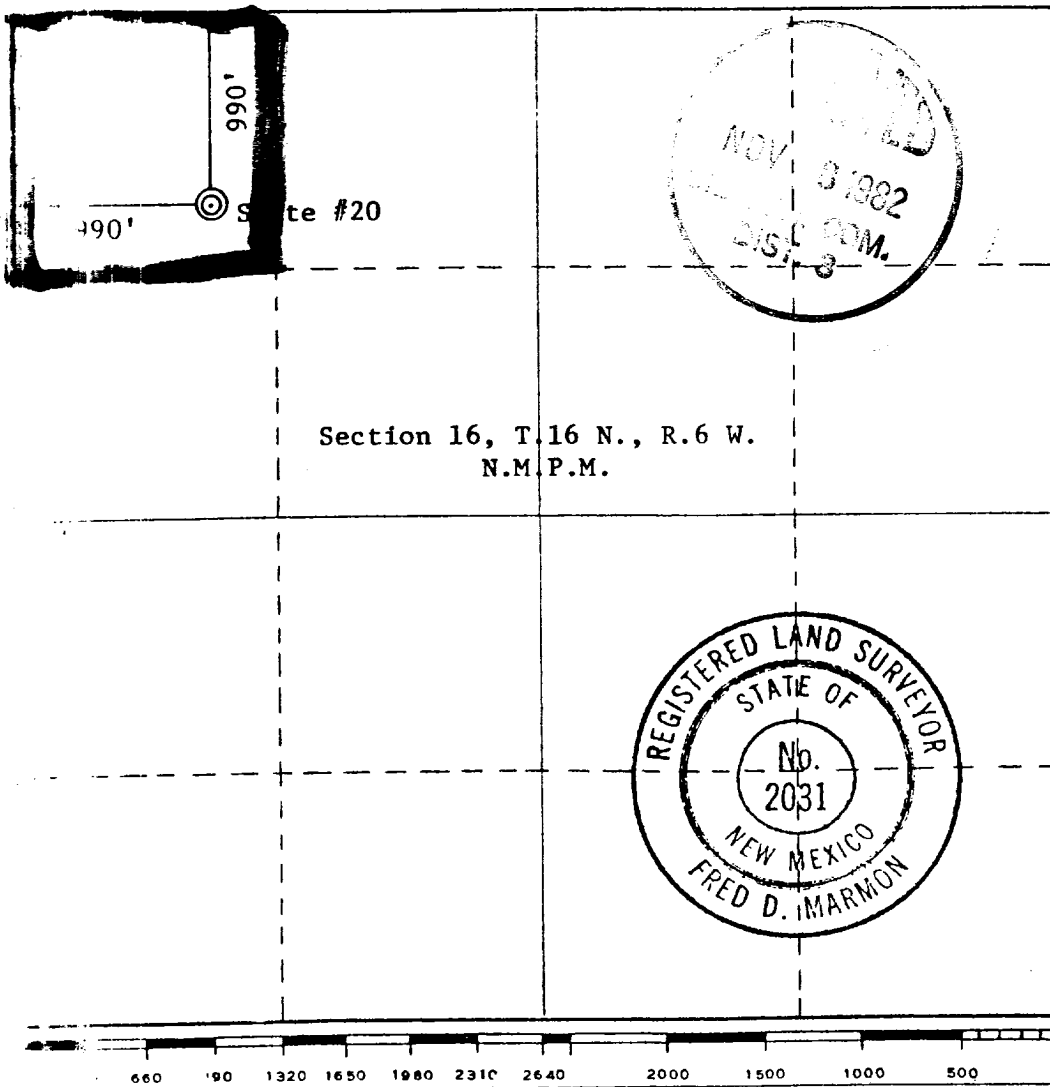

CERTIFICATION

I hereby certify that the information contained herein is true and complete to the best of my knowledge and belief.

Name

Representative

Position

Capital Oil & Gas

Company

October 22, 1982

Date

I hereby certify that the well location shown on this plat was plotted from field notes of actual surveys made by me or under my supervision, and that the same is true and correct to the best of my knowledge and belief.

Date Surveyed

March 21, 1982

Registered Professional Engineer
and/or Land Surveyor

Fred D. Marmion

Certificate No.

2031