

UNITED STATES
DEPARTMENT OF THE INTERIOR
GEOLOGICAL SURVEY30-031-20864
5. LEASE DESIGNATION AND SERIAL NO.
NM-33907

APPLICATION FOR PERMIT TO DRILL, DEEPEN, OR PLUG BACK

1a. TYPE OF WORK

DRILL ☒DEEPEN ☐PLUG BACK ☐

b. TYPE OF WELL

OIL
WELL ☒GAS
WELL ☐

OTHER

SINGLE
ZONE ☐MULTIPLE
ZONE ☐

2. NAME OF OPERATOR

Woosley Oil Company

3. ADDRESS OF OPERATOR

Post Office Drawer 1480, Cortez, Colorado 81321

4. LOCATION OF WELL (Report location clearly and in accordance with any State requirements.)

At surface 1650' FSL & 1650' FEL

At proposed prod. zone

Same

FEB 14 1984

14. DISTANCE IN MILES AND DIRECTION FROM NEAREST TOWN OR POST OFFICE*

13 miles southeast of Star Lake Compressor Station

15. DISTANCE FROM PROPOSED*
LOCATION TO NEAREST
PROPERTY OR LEASE LINE, FT.
(Also to nearest drlg. unit line, if any)

1650'

16. NO. OF ACRES IN LEASE

640

17. NO. OF ACRES ASSIGNED
TO THIS WELL

40

18. DISTANCE FROM PROPOSED LOCATION*
TO NEAREST WELL, DRILLING, COMPLETED,
OR APPLIED FOR, ON THIS LEASE, FT.

1320'

19. PROPOSED DEPTH

2200'

20. ROTARY OR CABLE TOOLS

Rotary

21. ELEVATIONS (Show whether DF, RT, GR, etc.) DRILLING OPERATIONS AUTHORIZED ARE
SUBJECT TO COMPLIANCE WITH ATTACHED

6650 GL

22. APPROX. DATE WORK WILL START*

As soon as approved

23. GENERAL REQUIREMENTS
PROPOSED CASING AND CEMENTING PROGRAMThis action is subject to administrative
appeal pursuant to 30 CFR 290.

SIZE OF HOLE	SIZE OF CASING	WEIGHT PER FOOT	SETTING DEPTH	QUANTITY OF CEMENT
9"	7"	24# J-55	90'	10 sks. Class C w/2% CaCl
6-1/4"	4-1/2"	9.5# J-55	T.D.	180 sks. Class C w/2% CaCl

1. Drill 9" hole and set 7" surface casing to 90'; cement to surface. Test surface by pressuring with mud pump.
2. Drill 6-1/4" hole to T.D. Cement to surface.
3. Plan to use mud logging unit. Run tests if warranted and run 4-1/2" casing if productive.
4. Run logs, as needed, and perforate and stimulate as needed.

Surface Formation: Lewis Shale

Estimated Formation Tops: Chacra - 662'

Menefee - 1122'

Cliff House - 1162'

Point Lookout - 2142'

IN ABOVE SPACE DESCRIBE PROPOSED PROGRAM: If proposal is to deepen or plug back, give data on present productive zone and proposed new productive zone. If proposal is to drill or deepen directionally, give pertinent data on subsurface locations and measured and true vertical depths. Give blowout preventer program, if any.

24. WOOSLEY OIL COMPANY
SIGNED James P. Woosley TITLE Operator

(This space for Federal or State office use)

PERMIT NO. _____

APPROVAL DATE _____

APPROVED BY _____

TITLE _____

CONDITIONS OF APPROVAL IF ANY

APPROVED

DATE 2-9-84

AS AMENDED

APR 24 1984

DATE
AREA MANAGER
FARMINGTON RESOURCE AREA

*See Instructions On Reverse Side

NMOCC

Operator: WOOSLEY OIL COMPANY		Lease: NM-33807		Well No.: Prasynski A-2
Unit Letter: J	Section: 11	Township: 19 NORTH	Range: 5 WEST	County: McKINLEY

Actual Well Location of Well:

1650 feet from the SOUTH line and	1650 feet from the EAST line
Ground Level Elev.: 6650	Producing Formation: Point Lookout
Pool: Blue Mesa MV, Wileat	Dedicated Acreage: 40

1. Outline the acreage dedicated to the subject well by colored pencil or hatchure marks on the plat below.
2. If more than one lease is dedicated to the well, outline each and identify the ownership thereof (both as to work interest and royalty).
3. If more than one lease of different ownership is dedicated to the well, have the interests of all owners been consolidated by communitization, unitization, force-pooling, etc?

☐ Yes ☐ No If answer is "yes," type of consolidation _____

If answer is "no," list the owners and tract descriptions which have actually been consolidated. (Use reverse side of this form if necessary.) _____

No allowable will be assigned to the well until all interests have been consolidated (by communitization, unitization, forced-pooling, or otherwise) or until a non-standard unit, eliminating such interests, has been approved by the Division.

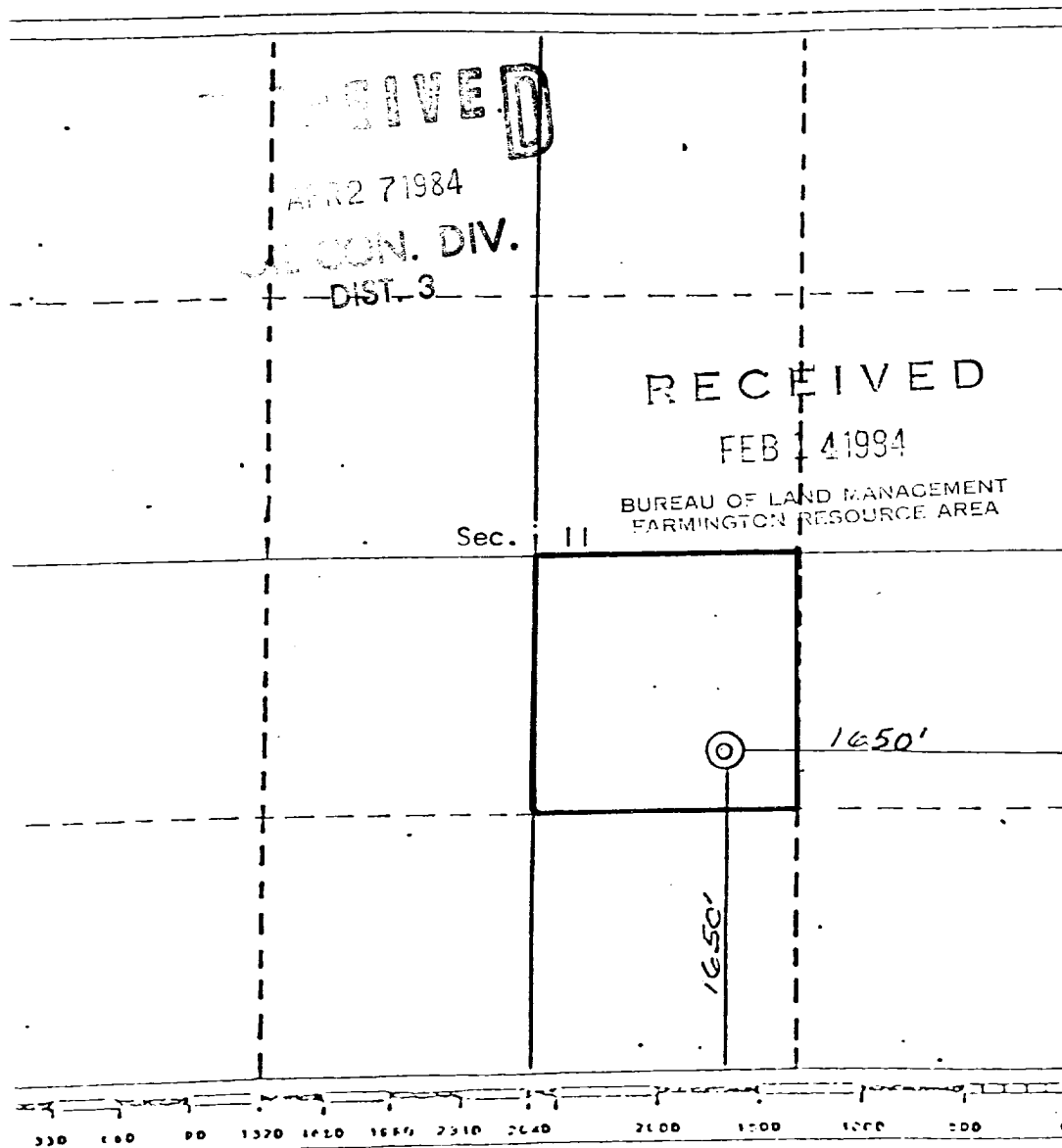

CERTIFICATION

I hereby certify that the information contained herein is true and complete to the best of my knowledge and belief.

James P. Woosley
Name: **James P. Woosley**
Operator

Position: **Woosley Oil Company**

Company: **February 9, 1984**

Date: _____

I hereby certify that the well location shown on this plat was plotted from the notes of actual surveys made by me under my supervision, and that the same is true and correct to the best of my knowledge and belief.

30 January 1984

Date: _____
Registered Professional Engineer
and/or Land Surveyor
Curtis C. Stucking
Curtis C. Stucking
C. STUCKING

Certificate No. **5980**