

30-031-20917

NO. OF COPIES RECEIVED	
DISTRIBUTION	
SANTA FE	
FILE	
U.S.G.S.	
LAND OFFICE	
OPERATOR	

NEW MEXICO OIL CONSERVATION COMMISSION

Form C-101
Revised 1-1-65

5A. Indicate Type of Lease	
STATE <input type="checkbox"/>	FEE <input checked="" type="checkbox"/>
5. State Oil & Gas Lease No.	

APPLICATION FOR PERMIT TO DRILL, DEEPEN, OR PLUG BACK

1a. Type of Work b. Type of Well OIL WELL <input checked="" type="checkbox"/> GAS WELL <input type="checkbox"/> OTHER <input type="checkbox"/> c. Name of Operator Black Oil, Inc. d. Address of Operator P.O. Box 537, Farmington, NM 87499 e. Location of Well UNIT LETTER P LOCATED 990 FEET FROM THE South LINE AND 990 FEET FROM THE East LINE OF SEC. 9 TWP. 20N RGE. 12W NMPM f. Elevations (Show whether DF, RT, etc.) 6153 GR 21A. Kind & Status Plug. Bond Blanket 21B. Drilling Contractor Salazar 22. Approx. Date Work will start June 1, 1986		7. Unit Agreement Name NMALCO-GURLEY 8. Farm or Lease Name 5 9. Well No. Wildcat Gallup 10. Field and Pool, or Wildcat 11. County McKinley 12. Proposed Depth 2300 13A. Formation Hospah 14. Rotary or C.T. Rotary
--	--	--

PROPOSED CASING AND CEMENT PROGRAM

SIZE OF HOLE	SIZE OF CASING	WEIGHT PER FOOT	SETTING DEPTH	SACKS OF CEMENT	EST. TOP
9-5/8"	7"		200	To Surface	Surface
6-1/4"	4-1/2"	20#	2300	To Surface	Surface

We propose to drill a 9-5/8" hole to 200'. We will then set 200' of 7" surface casing.
We will then drill a 6-1/4" hole to 2300' to test the Hospah sandstone. In the event oil
sands are found, 4-1/2" casing will be run through the producing interval.

APPROVAL EXPIRES 12-23-86
UNLESS DRILLING IS COMMENCED.
SPUD NOTICE MUST BE SUBMITTED
WITHIN 10 DAYS.

RECEIVED
JUN 23 1986
OIL CON. DIV.
DIST. 3

IN ABOVE SPACE DESCRIBE PROPOSED PROGRAM: IF PROPOSAL IS TO DEEPEN OR PLUG BACK, GIVE DATA ON PRESENT PRODUCTIVE ZONE AND PROPOSED NEW PRODUCTIVE ZONE. GIVE BLOWOUT PREVENTER PROGRAM, IF ANY.

I hereby certify that the information above is true and complete to the best of my knowledge and belief.

Signed Ernie Busch Title President Date May 10, 1986

(This space for State Use)

APPROVED ORIGINAL SIGNED BY ERNIE BUSCH TITLE DEPUTY OIL & GAS INSPECTOR, DIST. 3 DATE JUN 24 1986
CONDITIONS OF APPROVAL, IF ANY:

OIL CONSERVATION DIVISION

STATE OF NEW MEXICO
ENERGY AND MINERALS DEPARTMENTP. O. BOX 2088
SANTA FE, NEW MEXICO 87501Form O-101
Revised 10-1-79

All distances must be from the outer boundaries of the section.

Operator BLACK OIL INC.			Lease NMALCO - GURLEY		Well No. 5
Unit Letter P	Section 9	Township 20 North	Range 12 West	County McKinley	
Actual Location of Well: (cardinal) 990 feet from the South line and 990 feet from the East line					
Ground Level Elev. 6153'	Producing Formation Hospah		Pool Wildcat		Dedicated Acreage: 40 Acres

1. Outline the acreage dedicated to the subject well by colored pencil or hatchure marks on the plat below.
2. If more than one lease is dedicated to the well, outline each and identify the ownership thereof (both as to working interest and royalty).
3. If more than one lease of different ownership is dedicated to the well, have the interests of all owners been consolidated by communitization, unitization, force-pooling, etc?

☐ Yes ☐ No If answer is "yes," type of consolidation _____

If answer is "no," list the owners and tract descriptions which have actually been consolidated. (Use reverse side of this form if necessary.) _____

No allowable will be assigned to the well until all interests have been consolidated (by communitization, unitization, forced-pooling, or otherwise) or until a non-standard unit, eliminating such interests, has been approved by the Division.

* Record GLO 1950 plat ♦ Fd. GLO 1948 B.C. Corner

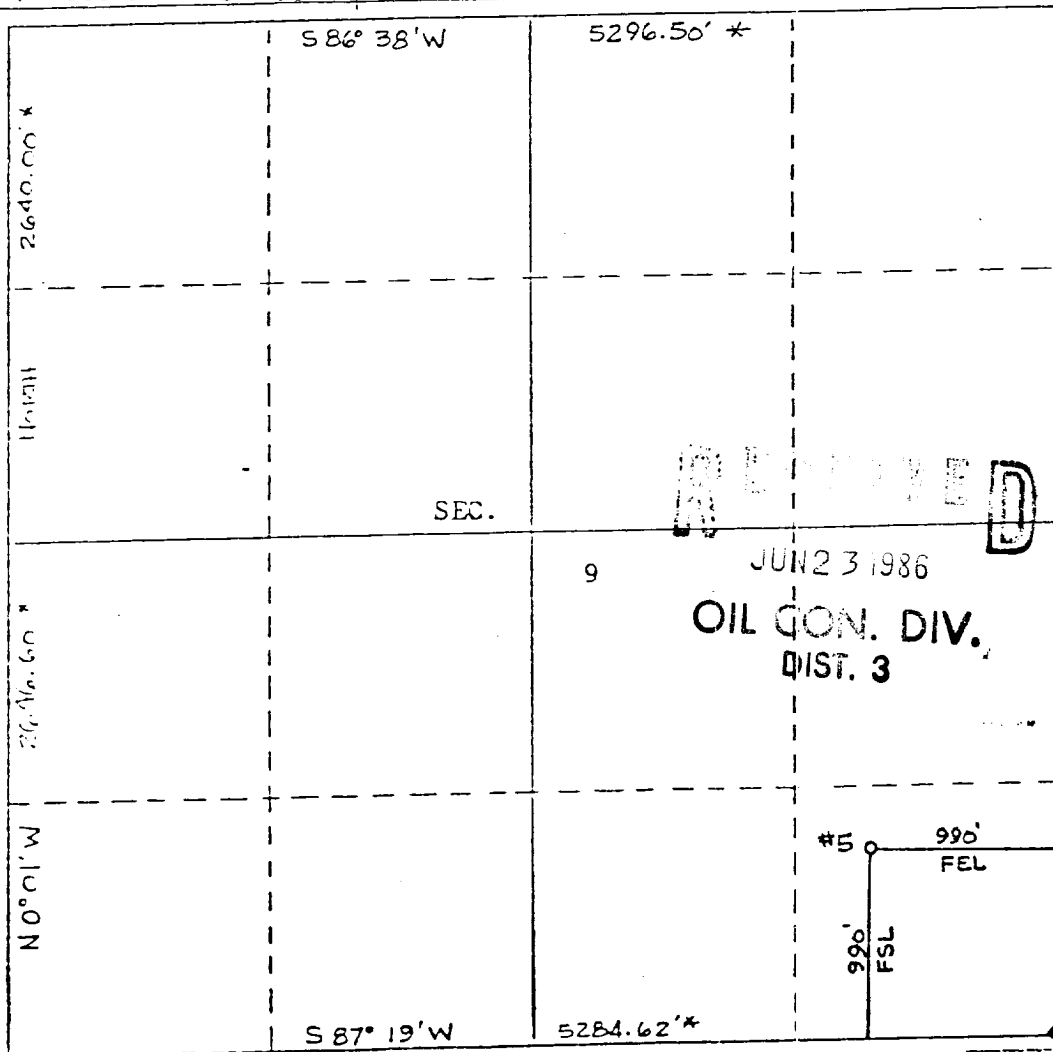

CERTIFICATION

I hereby certify that the information contained herein is true and complete to the best of my knowledge and belief.

Name
Bruce A. Black
Position
President
Company
Black Oil, Inc.
Date
May 28, 1986

I hereby certify that the well location shown on this plat was plotted from field notes of actual surveys made by me or under my supervision, and that the same is true and correct to the best of my knowledge and belief.

Date Surveyed
May 28, 1986
Registered Professional Engineer
and/or Land Surveyor

Certificate No.

8894