



STATE OF NEW MEXICO
ENERGY, MINERALS AND NATURAL RESOURCES DEPARTMENT
OIL CONSERVATION DIVISION

no HFD
3-25-91

BRUCE KING
GOVERNOR

POST OFFICE BOX 2088
STATE LAND OFFICE BUILDING
SANTA FE, NEW MEXICO 87504
(505) 827-5800

March 15, 1991

Merrion Oil & Gas Corp.
P.O.Box 840
Farmington, NM 87499

Attention: Steven S. Dunn

RECEIVED
MAR 19 1991
OIL CON. DIV.
DIST. 3

Administrative Order NSL-2998

Dear Mr. Dunn:

Reference is made to your application dated March 14, 1991 for a non-standard oil well location for your Federal 28 Well No. 2 to be located 1800 feet from the South line and 1450 feet from the East line (Unit J) of Section 28, Township 20North, Range 5West, NMPM, Undesignated Ojo Encino-Entrada Pool, McKinley County, New Mexico. The NW/4 SE/4 of said Section 28 shall be dedicated to the well forming a standard 40-acre oil spacing and proration unit for said pool.

By the authority granted me under the provisions of General Rule 104F.I. the above-described unorthodox oil well location is hereby approved.

Sincerely,

William J. LeMay / m.s.

William J. LeMay
Director

WJL/MES/ag

cc: Oil Conservation Division - Aztec
U.S. BLM - Farmington

1990

MERRION OIL & GAS CORPORATION

610 REILLY AVE. • P. O. Box 840
FARMINGTON, NEW MEXICO 87499

Attn: E. Bosch

March 14, 1991

Mr. William J. LeMay, Director
New Mexico Oil Conservation Division
P. O. Box 2088
Santa Fe, New Mexico 87504

Re: Federal 28 No. 2, Unorthodox Location
1800' FSL & 1450' FEL
Sec 28, T20N, R5W
McKinley County, New Mexico

RECEIVED

MAR 18 1991

**OIL CON. DIV.
DIST. 3**

Dear Mr. LeMay:

Merrion Oil and Gas requests an exception to the well location requirements of Rule 104 B for the Federal 28 No. 2 well due to topographical conditions. The well is located in the optimum spot to avoid an existing roadway running through the 40 acre drilling tract. In addition, to stay away from an archeological site we are further constrained to the proposed footages.

All offsetting spacing units are part of the same lease, NM-7509, and Merrion is the operator. Therefore, proper notification has been made.

Attached are a topographical plat and acreage dedication form identifying the proposed spacing unit, existing and proposed wells in the area, and the topographic conditions thereon.

If further is required, please advise.

Sincerely,

MERRION OIL & GAS CORPORATION

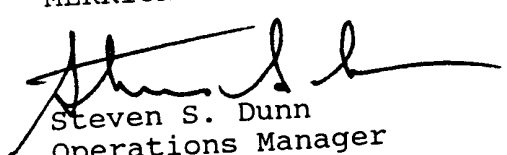
Steven S. Dunn
Operations Manager

SSD/l1s

cc: Doug Endsley
Well File

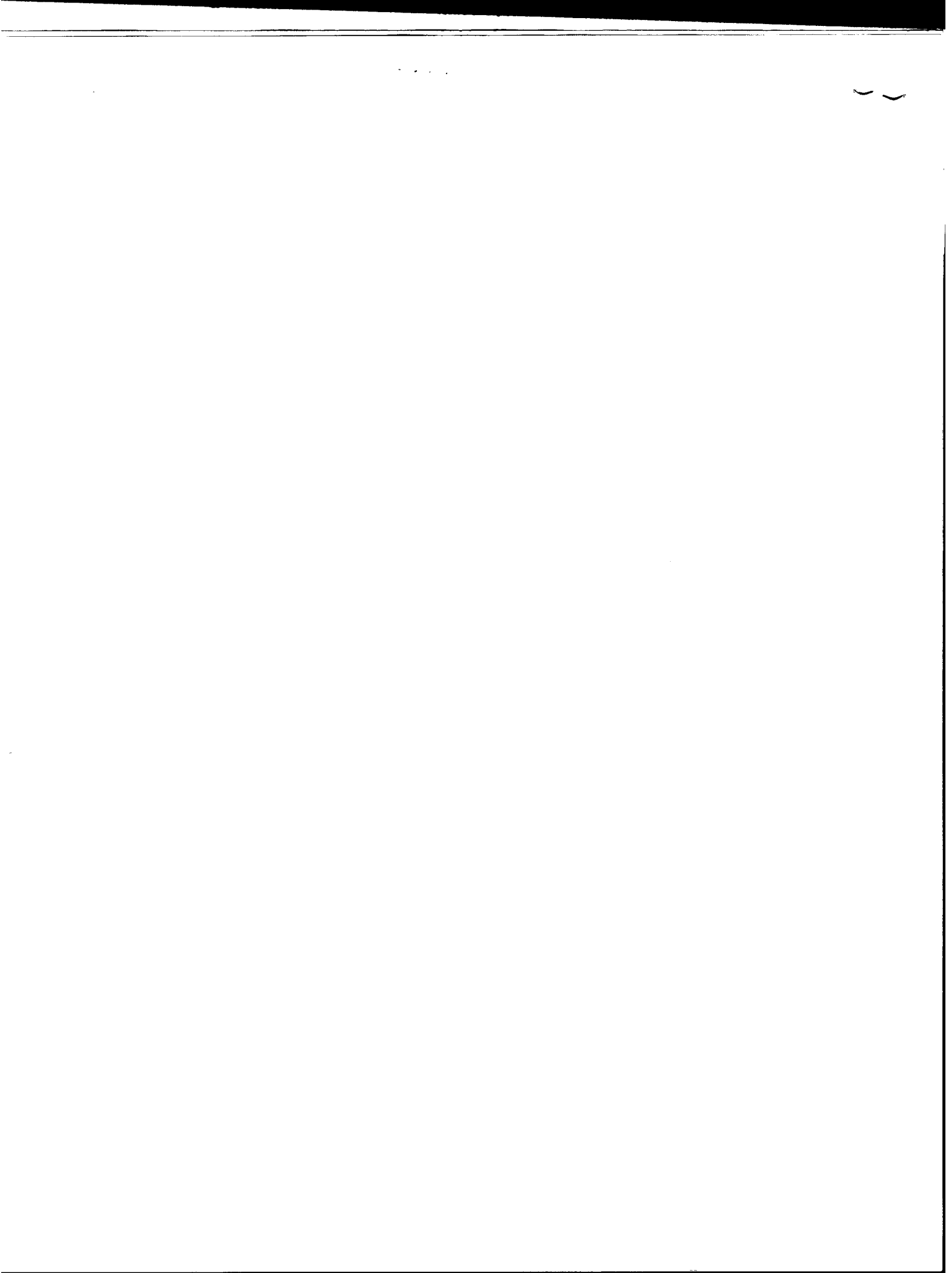

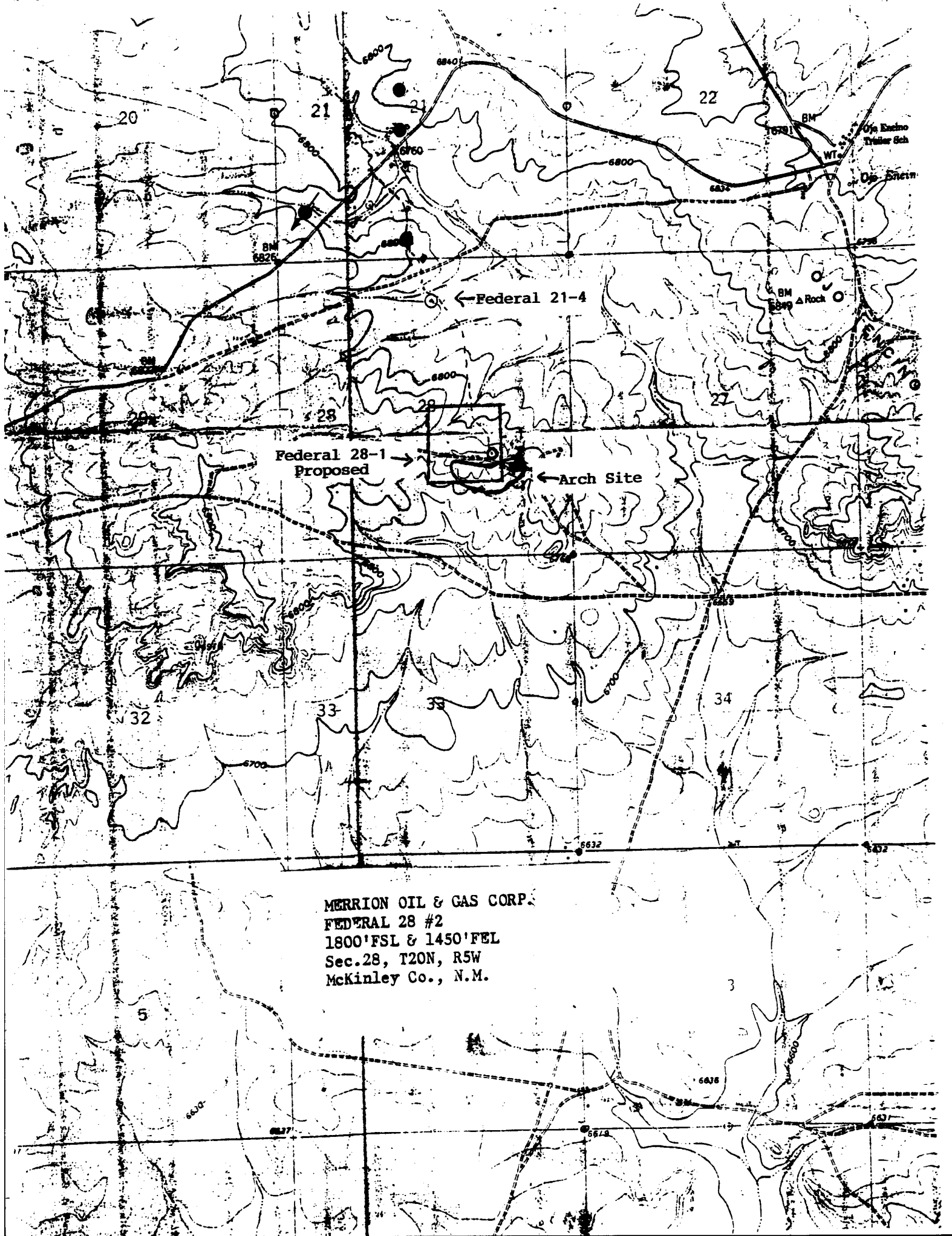

Submit to Appropriate
District Office
State Lease - 4 copies
Fee Lease - 3 copies

State of New Mexico
Energy, Minerals and Natural Resources Department

Form C-102
Revised 1-1-89

OIL CONSERVATION DIVISION

P.O. Box 2088
Santa Fe, New Mexico 87504-2088

DISTRICT I
P.O. Box 1980, Hobbs, NM 88240

DISTRICT II
P.O. Drawer DD, Artesia, NM 88210

DISTRICT III
1000 Rio Brazos Rd., Aztec, NM 87410

WELL LOCATION AND ACREAGE DEDICATION PLAT
All Distances must be from the outer boundaries of the section

Operator MERRION OIL & GAS CORPORATION			Lease FEDERAL 28		Well No. 2
Unit Letter J	Section 28	Township 20 N	Range 5 W	County McKinley	
Actual Footage Location of Well: 1800 feet from the South line and 1450 feet from the East line					
Ground level Elev. 6825		Producing Formation Entrada		Pool Ojo Encino	
Dedicated Acreage: 40 Acres					

1. Outline the acreage dedicated to the subject well by colored pencil or hatchure marks on the plat below.
2. If more than one lease is dedicated to the well, outline each and identify the ownership thereof (both as to working interest and royalty).
3. If more than one lease of different ownership is dedicated to the well, have the interest of all owners been consolidated by communitization, unitization, force-pooling, etc.?
☐ Yes ☐ No If answer is "yes" type of consolidation _____
If answer is "no" list the owners and tract descriptions which have actually been consolidated. (Use reverse side of this form if necessary.)
No allowable will be assigned to the well until all interests have been consolidated (by communitization, unitization, forced-pooling, or otherwise) or until a non-standard unit, eliminating such interest, has been approved by the Division.

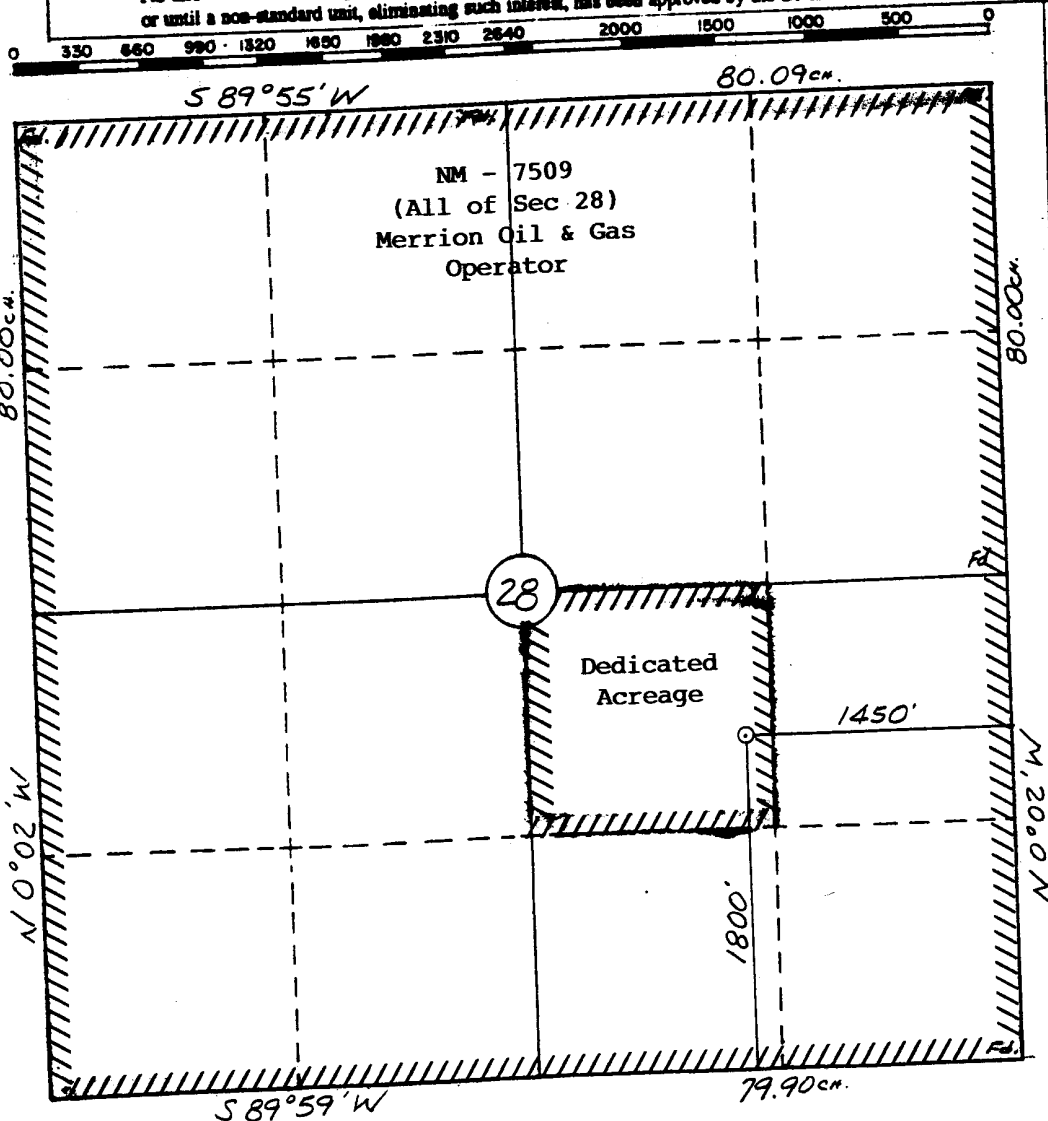

OPERATOR CERTIFICATION

I hereby certify that the information contained herein is true and complete to the best of my knowledge and belief.

Signature *Steven S. Dunn*
Printed Name **Steven S. Dunn**
Position **Operations Manager**
Company **Merrion Oil & Gas**
Date **3/14/91**

SURVEYOR CERTIFICATION

I hereby certify that the well location shown on this plat was plotted from field notes of actual surveys made by me or under my supervision, and that the same is true and correct to the best of my knowledge and belief.

3-13-91

Date Surveyed
William E. Mahnke II

Signature of Professional Surveyor
William E. Mahnke II
Professional Surveyor
NEW MEXICO
#8466
Certificate No. **8466**
PROFESSIONAL LAND SURVEYOR