

UNITED STATES  
DEPARTMENT OF THE INTERIOR  
GEOLOGICAL SURVEYRECEIVED  
BLM30-031-20950  
5. LEASE DESIGNATION AND SERIAL NO.

NM85829

6. IF INDIAN, ALLOTTEE OR TRIBE NAME

7. UNIT AGREEMENT NAME

8. FARM OR LEASE NAME

Patience 12

9. WELL NO.

12-1

10. FIELD AND POOL, OR WELLS

96167 Wild Cat Hospah

11. SEC., T., R., M., OR BLK.  
AND SURVEY OR AREA

Sec. 12, T20N, R13W

12. COUNTY OR PARISH

McKinley

13. STATE

NM

## APPLICATION FOR PERMIT TO DRILL, DEEPEN, OR PLUG BACK

1a. TYPE OF WORK

DRILL ☒DEEPEN ☐PLUG BACK ☐

b. TYPE OF WELL

OIL WELL ☒GAS WELL ☐

OTHER

SINGLE ZONE ☐MULTIPLE ZONE ☐

2. NAME OF OPERATOR

GURLEY OIL COMPANY 9536

3. ADDRESS OF OPERATOR

P. O. Box 2092, Farmington, NM 87499

4. LOCATION OF WELL (Report location clearly and in accordance with any State requirements.)

At surface

330' FWL and 330' FSL

OIL CON. DIV.  
DIST. 3

At proposed prod. zone

Same

14. DISTANCE IN MILES AND DIRECTION FROM NEAREST TOWN OR POST OFFICE\*

22 miles north of Crownpoint, NM

15. DISTANCE FROM PROPOSED\*

LOCATION TO NEAREST  
PROPERTY OR LEASE LINE, FT.  
(Also to nearest drg. unit line, if any)

330' FWL

16. NO. OF ACRES IN LEASE

640

17. NO. OF ACRES ASSIGNED  
TO THIS WELL

40 JTW/#2

18. DISTANCE FROM PROPOSED LOCATION\*  
TO NEAREST WELL, DRILLING, COMPLETED,  
OR APPLIED FOR, ON THIS LEASE, FT.

19. PROPOSED DEPTH

+ 2300'

20. ROTARY OR CABLE TOOLS

Rotary

21. ELEVATIONS (Show whether DF, RT, GR, etc.)

6132 GR

22. APPROX. DATE WORK WILL START\*

May 1, 1991

23. This action is subject to technical and  
procedural review pursuant to 43 CFR 3165.3  
and appeal pursuant to 43 CFR 3165.4.  
PROPOSED CASING AND CEMENTING PROGRAM

SIZE OF HOLE	SIZE OF CASING	WEIGHT PER FOOT	SETTING DEPTH	QUANTITY OF CEMENT
8-3/4"	7" ST&C	23# K-55	+ 120'	40 cu. ft. Class B Neat
6-1/4"	4-1/2" ST&C	10.5# K-55	+ 2300'	378 cu. ft. Class B Neat

We propose to drill a 8-3/4" hole to 120' and set 120' of 7" 23#/ft K-55 used casing, cemented with 40 cu ft, Class B cement, circulated to surface. We will drill a 6-1/4" hole to 2300'+. We will run induction and density logs, if oil sands are present we will run 2300' of 4-1/2" 10.5#/ft. used casing cemented with 378 cu.ft. of Class B cement circulated to surface.

Circulating medium will be clear water, natural mud and water loss control additives. Unlined earth pits will be used. No abnormal pressures or temperatures are anticipated. A good supply of mud will be on hand to control the well as needed. Blowout preventor schematic is attached. We will use a 2000 psi WP annular blow out preventor. A Upper Kelly cock valve (with handle available) will be used. Safety valve and subs to fit all drill strings will be on the rig floor. Choke manifold equipment will be of the 2000 psi configuration. Estimated Formation Tops: Surface formation: Clays and Sand (Menefee); Point Lookout: 1060'; Top Mancos: 1200'; Hospah: 2060'; Oil Sand: 2175'. Centralizers: Surface, shoe joint, 60' & Bottom of cellar. Production casing, across all water and oil sands.

IN ABOVE SPACE DESCRIBE PROPOSED PROGRAM: If proposal is to deepen or plug back, give data on present productive zone and proposed new productive zone. If proposal is to drill or deepen directionally, give pertinent data on subsurface locations and measured and true vertical depths. Give blowout preventer program, if any.

24.

SIGNED

L. Mike Maloney

TITLE

Manager

DATE

3-7-91

(This space for Federal or State office use)

PERMIT NO.

APPROVAL DATE

APPROVED  
AS AMENDED

APPROVED BY

TITLE

NMOC D

CONDITIONS OF APPROVAL, IF ANY:

MAY 15 1991

AREA MANAGER

## Instructions

**General:** This form is designed for submitting proposals to perform certain well operations, as indicated, on all types of lands and leases for appropriate action by either a Federal or a State agency, or both, pursuant to applicable Federal and/or State laws and regulations. Any necessary special instructions concerning the use of this form and the number of copies to be submitted, particularly with regard to local, area, or regional procedures and practices, either are shown below or will be issued by, or may be obtained from, the local Federal and/or State office.

**Item 1:** If the proposal is to redrill to the same reservoir at a different subsurface location or to a new reservoir, use this form with appropriate notations. Consult applicable State or Federal regulations concerning subsequent work proposals or reports on the well.

**Item 4:** If there are no applicable State requirements, locations on Federal or Indian land should be described in accordance with Federal requirements. Consult local State or Federal office for specific instructions.

**Item 14:** Needed only when location of well cannot readily be found by road from the land or lease description. A plat, or plats, separate or on this reverse side, showing the roads to, and the surveyed location of, the well, and any other required information, should be furnished when required by Federal or State agency offices.

**Items 15 and 18:** If well is to be, or has been directionally drilled, give distances for subsurface location of hole in any present or objective production zone.

**Item 22:** Consult applicable Federal or State regulations, or appropriate officials, concerning approval of the proposal before operations are started.

Submit to Appropriate  
District Office  
State Leases - 4 copies  
Fee Lease - 3 copies

State of New Mexico  
Energy, Minerals and Natural Resources Department

Form C-102  
Revised 1-1-89

OIL CONSERVATION DIVISION

P.O. Box 2088  
Santa Fe, New Mexico 87504-2088

DISTRICT I

P.O. Box 1980, Hobbs, NM 88240

DISTRICT II

P.O. Drawer DD, Artesia, NM 88210

DISTRICT III

1000 Rio Brazos Rd., Aztec, NM 87410

WELL LOCATION AND ACREAGE DEDICATION PLAT

All Distances must be from the outer boundaries of the section

RECEIVED  
BLM

SENT 12:00:32  
JUN 12 1991

WASHINGTON, N.M.

Operator GURLEY OIL COMPANY			Lease PATIENCE 12		Well No. 12-1
Unit Letter M	Section 12	Township 20N	Range 13W	County NMFM	McKinley
Actual Footage Location of Well: 330' feet from the South line and 330' feet from the West line					
Ground level Elev. 6132'	Producing Formation Hospah		Pool Wildcat	Dedicated Acreage: 40 Acres	

1. Outline the acreage dedicated to the subject well by colored pencil or hatchure marks on the plat below.
2. If more than one lease is dedicated to the well, outline each and identify the ownership thereof (both as to working interest and royalty).
3. If more than one lease of different ownership is dedicated to the well, have the interest of all owners been consolidated by communization, unitization, force-pooling, etc?  
☐ Yes ☐ No If answer is "yes" type of consolidation \_\_\_\_\_  
If answer is "no" list the owners and tract descriptions which have actually been consolidated. (Use reverse side of this form if necessary.)  
No allowable will be assigned to the well until all interests have been consolidated (by communization, unitization, forced-pooling, or otherwise) or until a non-standard unit, eliminating such interest, has been approved by the Division.

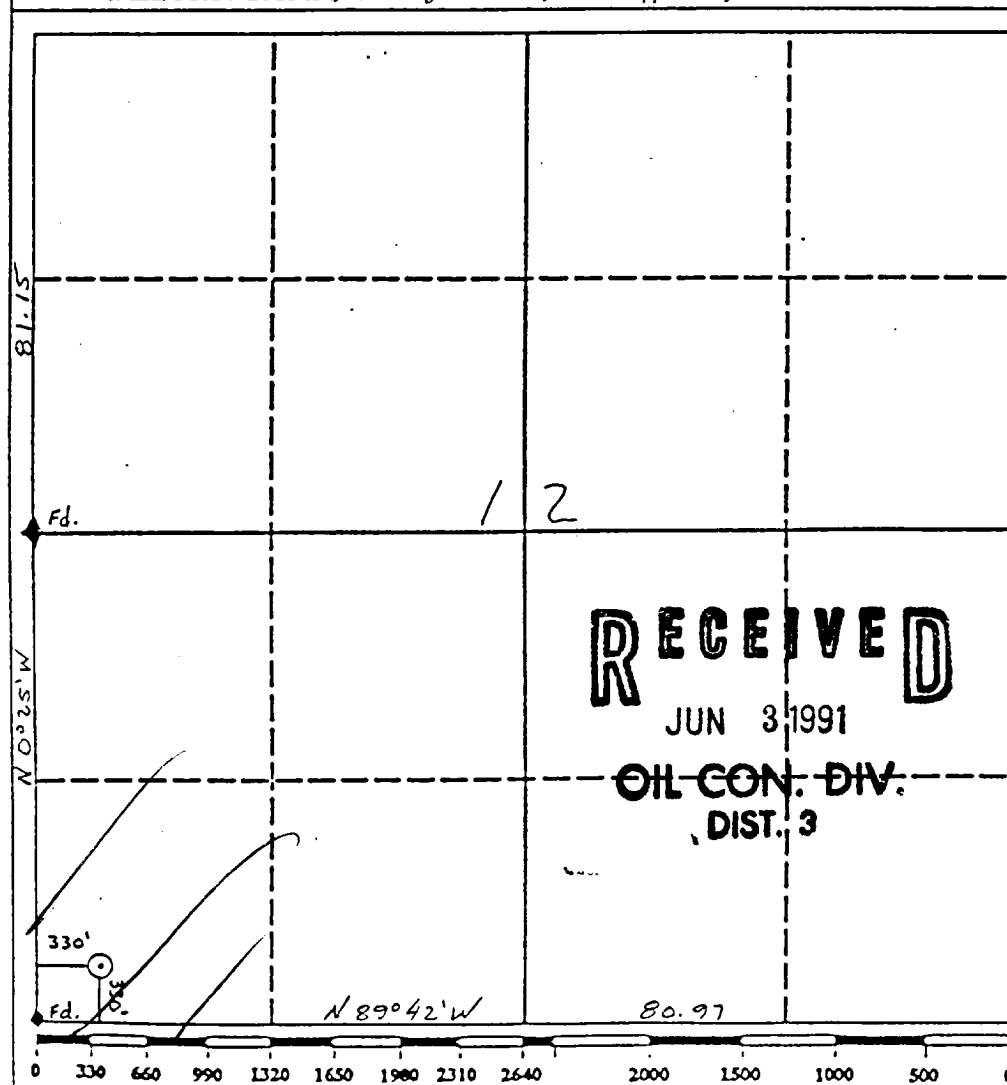

OPERATOR CERTIFICATION

I hereby certify that the information contained herein is true and complete, to the best of my knowledge and belief.

Signature  
*Mike Maloney*  
Printed Name  
Mike Maloney  
Position  
Manager  
Company  
Gurley Oil Company  
Date  
march 7, 1991

SURVEYOR CERTIFICATION

I hereby certify that the well location shown on this plat was plotted from field notes of actual surveys made by me or under my supervision, and that the same is true and correct to the best of my knowledge and belief. 2-20-91

Date Surveyed  
Roy A. Rush

Signature & Seal of  
Professional Surveyor  
ROY A. RUSH  
NEW MEXICO  
8894  
Certification  
8894  
REGISTERED PROFESSIONAL LAND SURVEYOR

