

(SUBMIT IN TRIPLICATE)

Indian Agency Alamo

UNITED STATES
DEPARTMENT OF THE INTERIOR
GEOLOGICAL SURVEY

Contract # 77

Allottee

Lease No. 188386

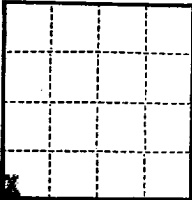

See Attached Plans

SUNDRY NOTICES AND REPORTS ON WELLS

NOTICE OF INTENTION TO DRILL	<input checked="" type="checkbox"/>	SUBSEQUENT REPORT OF WATER SHUT-OFF	
NOTICE OF INTENTION TO CHANGE PLANS		SUBSEQUENT REPORT OF SHOOTING OR ACIDIZING	
NOTICE OF INTENTION TO TEST WATER SHUT-OFF		SUBSEQUENT REPORT OF ALTERING CASING	
NOTICE OF INTENTION TO REDRILL OR REPAIR WELL		SUBSEQUENT REPORT OF REDRILLING OR REPAIR	
NOTICE OF INTENTION TO SHOOT OR ACIDIZE		SUBSEQUENT REPORT OF ABANDONMENT	
NOTICE OF INTENTION TO PULL OR ALTER CASING		SUPPLEMENTARY WELL HISTORY	
NOTICE OF INTENTION TO ABANDON WELL			

(INDICATE ABOVE BY CHECK MARK NATURE OF REPORT, NOTICE, OR OTHER DATA)

JICARILLA APACHE
TRIBE OF INDIANS

April 30, 19 57

Well No. 3 is located 200 ft. from S line and 210 ft. from W line of sec. 12

SW/4 Section 10 13-N 3-W
(1/4 Sec. and Sec. No.) (Twp.) (Range) (Meridian)
Cliffs Pictured Rio Arriba New Mexico
(Field) (County or Subdivision) (State or Territory)

The elevation of the derrick floor above sea level is 2100 ft.

DETAILS OF WORK

(State names of and expected depths to objective sands; show sizes, weights, and lengths of proposed casings; indicate mudding jobs, cementing points, and all other important proposed work)

CASING PROGRAM	CEMENTING RECORD	CORING PROGRAM
<p>5 1/8" 14' 2500'</p>	<p>Circulate to surface Circulate to 6 5/8" casing.</p>	<p>NONE</p>

Proposed total depth 2530' - to test Pictured Cliffs
Oil-water emulsion drilling fluid
Ballston method of cementing.

ILLEGIBLE



I understand that this plan of work must receive approval in writing by the Geological Survey before operations are commenced.

Company Shule Oil & Refining Company

Address Box 1800

Midland, Texas

By [Signature]

Title Div. Chief Clerk



NEW MEXICO
OIL CONSERVATION COMMISSION

Form C-128

Well Location and/or Gas Fracturing Plat

Date 4-20-57

Operator HUMBLE OIL & REFINING CO. Lease JICARILLA APACHE TRIBE OF INDIANS

Well No. 3 Section 10 Township 23-N Range 5-W NMPM

Located 990 Feet From SOUTH Line, 990 Feet From WEST Line,

RIO ARRIBA

County, New Mexico. G. L. Elevation

Name of Producing Formation PICTURED CLIFFS Pool OTERO CLIFFS Dedicated Acreage 160

(Note: All distances must be from outer boundaries of Section)

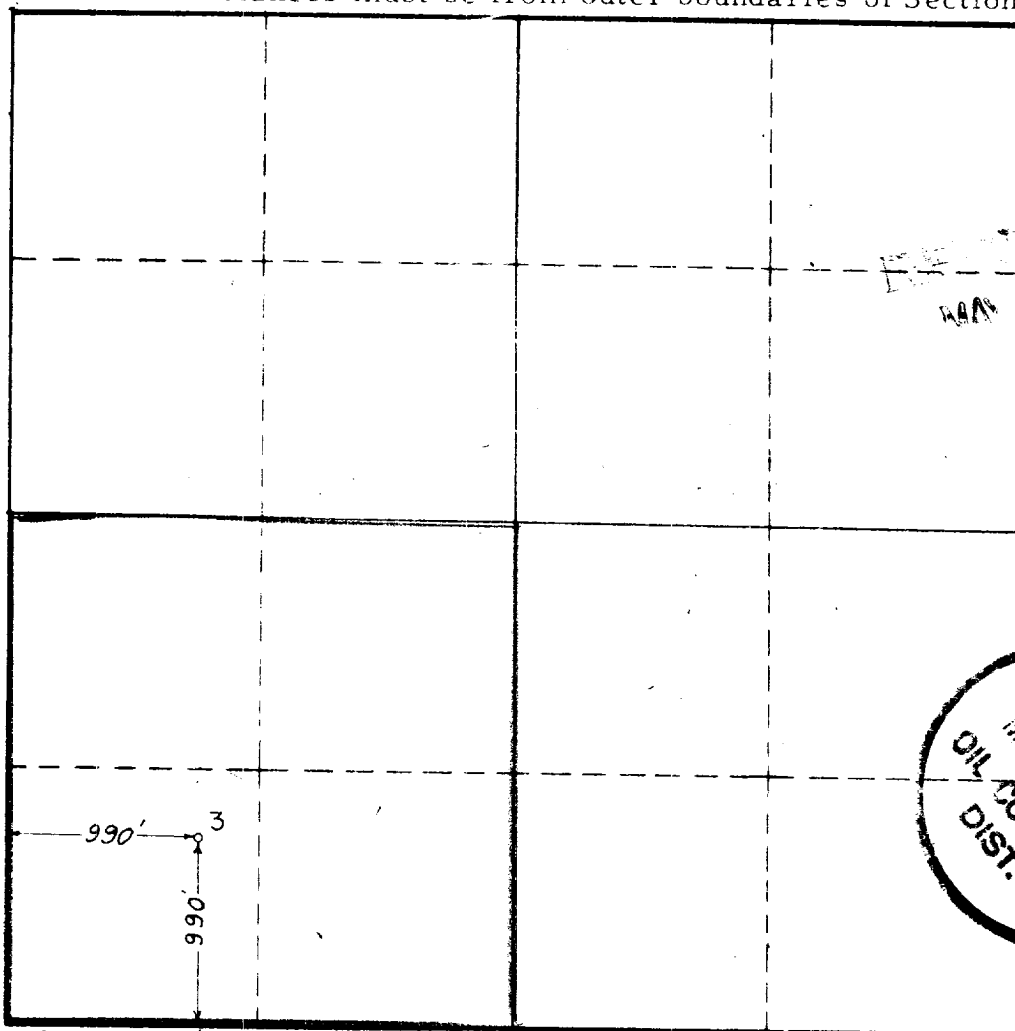

SCALE: 1"=1000'

1. Is this Well a Dual Comp. ? Yes No
2. If the answer to Question 1 is yes, are there any other dually completed wells within the dedicated acreage? Yes No

This is to certify that the above plat was prepared from field notes of actual surveys made by me or under my supervision and that the same are true and correct to the best of my knowledge and belief.

Name E. T. Shaban
Position ASSISTANT DIVISION SUPERINTENDENT
Representing HUMBLE OIL & REFINING CO.
Address BOX 1800 MIDLAND, TEXAS

Date Surveyed 4-20-57
E. T. Shaban
Registered Professional Engineer and/or
Land Surveyor
LEASE NO. 166396
CONTRACT NO. 78

W-A 2157