



IN REPLY REFER TO: ✓

UNITED STATES  
DEPARTMENT OF THE INTERIOR  
GEOLOGICAL SURVEY  
P. O. Box 965  
Farmington, New Mexico

July 5, 1956

Humble Oil & Refining Company  
Box 1600  
Midland, Texas

Re: Jicarilla Contract #77

Gentlemen:

Receipt is acknowledged of your "Notice of Intention to Drill" dated July 3, 1956 covering your well No. 2 Jicarilla Apache Tribe of Indians in SW 1/4 sec. 9, T. 23 N., R. 5 W., N. M. P. M., Rio Arriba County, New Mexico, OteroPieCliffs pool.

Your proposed work is hereby approved subject to compliance with the provisions of the "Oil and Gas Operating Regulations" revised May 25, 1942, a copy of which will be sent to you on request, and subject to the following conditions:

1. Drilling operations so authorized are subject to the attached sheet for general conditions of approval.
2. Furnish copies of all logs.

Very truly yours,

P. T. McGrath  
District Engineer

PTMcGrath:ac  
cc - Jicarilla Agency



UNITED STATES  
DEPARTMENT OF THE INTERIOR  
GEOLOGICAL SURVEY

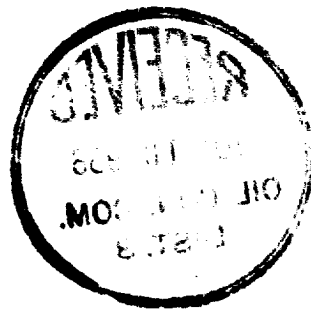

(SUBMIT IN TRIPLICATE)

Indian Agency Jicarilla

Contract #77

UNITED STATES  
DEPARTMENT OF THE INTERIOR  
GEOLOGICAL SURVEY

Allottee

Co. Lease No. 106396

See attached plat

SUNDRY NOTICES AND REPORTS ON WELLS

NOTICE OF INTENTION TO DRILL	<input checked="" type="checkbox"/>	SUBSEQUENT REPORT OF WATER SHUT-OFF	
NOTICE OF INTENTION TO CHANGE PLANS		SUBSEQUENT REPORT OF SHOOTING OR ACIDIZING	
NOTICE OF INTENTION TO TEST WATER SHUT-OFF		SUBSEQUENT REPORT OF ALTERING CASING	
NOTICE OF INTENTION TO REDRILL OR REPAIR WELL		SUBSEQUENT REPORT OF REDRILLING OR REPAIR	
NOTICE OF INTENTION TO SHOOT OR ACIDIZE		SUBSEQUENT REPORT OF ABANDONMENT	
NOTICE OF INTENTION TO PULL OR ALTER CASING		SUPPLEMENTARY WELL HISTORY	
NOTICE OF INTENTION TO ABANDON WELL			

(INDICATE ABOVE BY CHECK MARK NATURE OF REPORT, NOTICE, OR OTHER DATA)

JICARILLA APACHE  
TRIBE OF INDIANS

Midland, Texas July 3, 19 56

Well No. 2 is located 1140 ft. from DN line and 990 ft. from W line of sec. 9

SW/4 SW/4 Section 9 T-23-N, R-5-W  
(1/4 Sec. and Sec. No.) (Twp.) (Range) (Meridian)

Otero Pictured Cliffs Rio Arriba New Mexico  
(Field) (County or Subdivision) (State or Territory)

The elevation of the derrick floor above sea level is later ft.

DETAILS OF WORK

(State names of and expected depths to objective sands; show sizes, weights, and lengths of proposed casings; indicate mudding jobs, cementing points, and all other important proposed work)

CASING PROGRAM			CEMENTING RECORD	CORING PROGRAM
Size	Weight	Depth		
8-5/8"	24	150'	Circulate to surface	Pictured Cliffs
4-1/2"	11	2300'	Circulate to 8-5/8" casing	

Proposed total depth - 2300' to test Pictured Cliffs.  
Oil-water emulsion drilling fluid.  
Halliburton method of cementing.

I understand that this plan of work must receive approval in writing by the Geological Survey before operations may be commenced.

Company Humble Oil & Refining Company

Address Box 1800

Midland, Texas

By A. J. Beards

Title Division Chief Clerk



NEW MEXICO  
OIL CONSERVATION COMMISSION

Form C-128

Well Location and/or Gas Proration Plat

Date 6-27-56

Operator HUMBLE OIL & REFINING CO. Lease JICARILLA TRIBE OF INDIANS

Well No. 2 Section 9 Township 23-N Range 5-WEST NMPM

Located 1140 Feet From SOUTH Line, 990 Feet From WEST Line,

RIO ARRIBA County, New Mexico. G. L. Elevation \_\_\_\_\_

Name of Producing Formation PICTURED CLIFFS Pool OTERO ~~DEPOX~~ Dedicated Acreage 160

(Note: All distances must be from outer boundaries of Section)

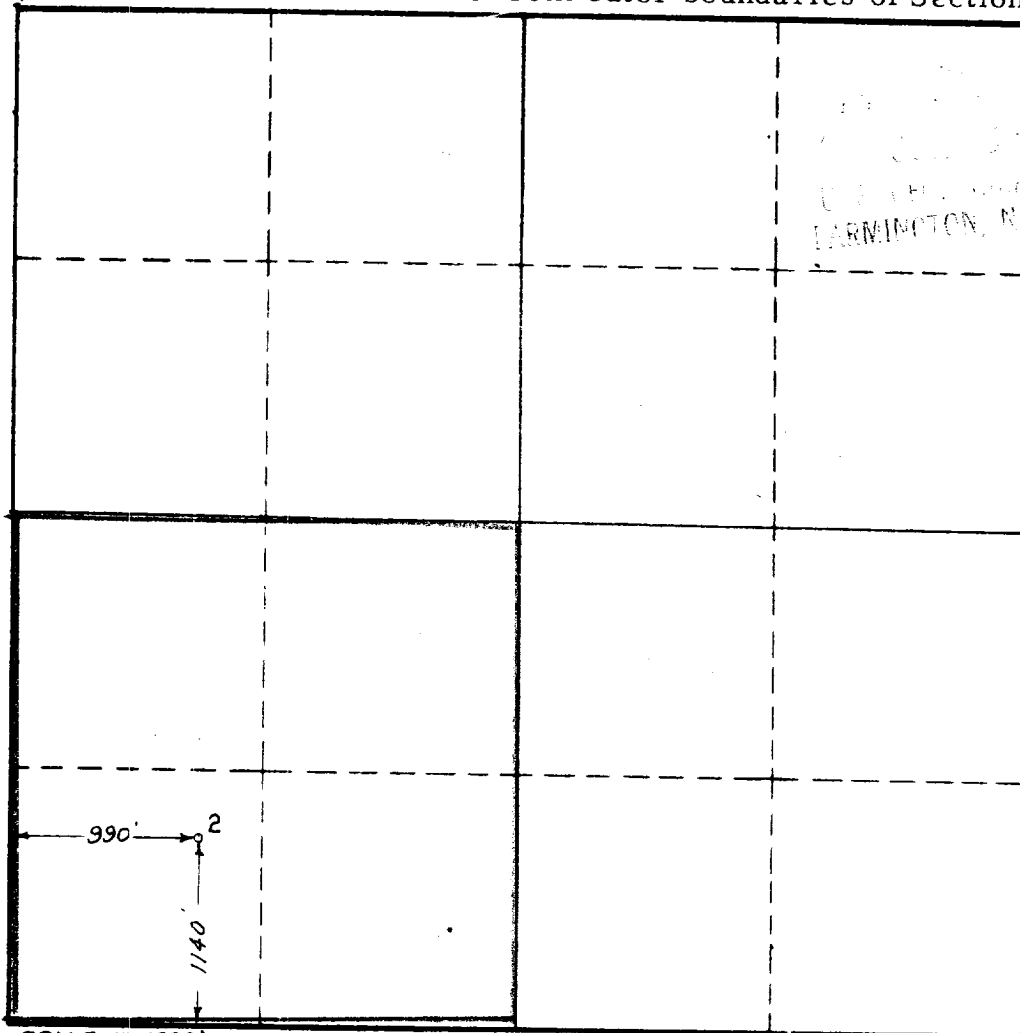

SCALE: 1" = 1000'

1. Is this Well a Dual Comp. ? Yes No \_\_\_\_\_.
2. If the answer to Question 1 is yes, are there any other dually completed wells within the dedicated acreage ? Yes No \_\_\_\_\_.

This is to certify that the above plat was prepared from field notes of actual surveys made by me or under my supervision and that the same are true and correct to the best of my knowledge and belief.

Name C. W. Hume  
Position ASSISTANT DIVISION SUPERINTENDENT  
Representing HUMBLE OIL & REFINING CO.  
Address \_\_\_\_\_

Date Surveyed 6-26-56  
E. T. Abraham  
Registered Professional Engineer and/or  
Land Surveyor  
LEASE NO. 166396  
CONTRACT NO. 27

W-A 2156