

(SUBMIT IN TRIPLICATE)

UNITED STATES  
DEPARTMENT OF THE INTERIOR  
GEOLOGICAL SURVEY

Indian Agency Hicarilla Apache  
Allottee \_\_\_\_\_  
Lease No. 38

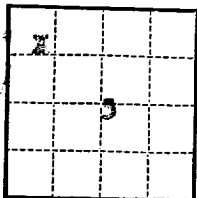

SUNDRY NOTICES AND REPORTS ON WELLS

NOTICE OF INTENTION TO DRILL	<input checked="" type="checkbox"/>	SUBSEQUENT REPORT OF WATER SHUT-OFF	
NOTICE OF INTENTION TO CHANGE PLANS		SUBSEQUENT REPORT OF SHOOTING OR ACIDIZING	
NOTICE OF INTENTION TO TEST WATER SHUT-OFF		SUBSEQUENT REPORT OF ALTERING CASING	
NOTICE OF INTENTION TO REDRILL OR REPAIR WELL		SUBSEQUENT REPORT OF REDRILLING OR REPAIR	
NOTICE OF INTENTION TO SHOOT OR ACIDIZE		SUBSEQUENT REPORT OF ABANDONMENT	
NOTICE OF INTENTION TO PULL OR ALTER CASING		SUPPLEMENTARY WELL HISTORY	
NOTICE OF INTENTION TO ABANDON WELL			

(INDICATE ABOVE BY CHECK MARK NATURE OF REPORT, NOTICE, OR OTHER DATA)

April 18, 19 63

**AXI Apache "B" Lease**  
Well No. 11 is located 917 ft. from N line and 1187 ft. from E line of sec. 5

SW/4 Sec. 5 T23N R5W MEPM  
(1/4 Sec. and Sec. No.) (Twp.) (Range) (Meridian)  
**Ballard Pictured Cliffs** **Rio Arriba County** **New Mexico**  
(Field) (County or Subdivision) (State or Territory)

The elevation of the derrick floor above sea level is 6648 ft.

DETAILS OF WORK

(State names of and expected depths to objective sands; show sizes, weights, and lengths of proposed casings; indicate mudding jobs, cementing points, and all other important proposed work)

We propose to drill this well with rotary tools to approximately 2300' to test the Pictured Cliffs formation. Approximately 300' of 8 5/8" surface casing will be set and cemented to the surface. If commercial production is encountered, a string of 4 1/2" production casing will be set and cemented and the well completed.

I understand that this plan of work must receive approval in writing by the Geological Survey before operations may be commenced.

Company Continental Oil Company

Address P. O. Box 3312

Durango, Colorado

By R. Jensen  
Title Asst. District Superintendent

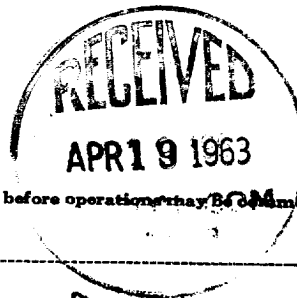

1. The first part of the document is a list of names and addresses of the members of the committee. The names are written in a cursive hand, and the addresses are written in a more formal, printed hand. The list is organized in two columns, with names on the left and addresses on the right. The names are: John A. Smith, James B. Jones, William C. Brown, and Thomas D. White. The addresses are: 123 Main Street, New York, N.Y.; 456 Elm Street, Boston, Mass.; 789 Oak Street, Philadelphia, Pa.; and 101 Pine Street, Washington, D.C.

NUMBER OF COPIES RECEIVED	
DISTRIBUTION	
SANTA FE	
FILE	
U.S.G.S.	
LAND OFFICE	
TRANSPORTER	OIL GAS
PRORATOR OFFICE	
OPERATOR	

**NEW MEXICO OIL CONSERVATION COMMISSION**  
**WELL LOCATION AND ACREAGE DEDICATION PLAT**  
 SEE INSTRUCTIONS FOR COMPLETING THIS FORM ON THE REVERSE SIDE

FORM C-128  
 Revised 5/1/57

SECTION A					
Operator <b>Continental Oil Company</b>			Lease <b>AXI Apache "H"</b>		Well No. <b>11</b>
Unit Letter <b>D</b>	Section <b>5</b>	Township <b>23N</b>	Range <b>5W</b>	County <b>Rio Arriba</b>	
Actual Footage Location of Well: <b>917</b> feet from the <b>North</b> line and <b>1187</b> feet from the <b>West</b> line					
Ground Level Elev. <b>6638</b>	Producing Formation <b>Pictured Cliffs</b>	Pool <b>Ballard Pictured Cliffs</b>		Dedicated Acreage: <b>161.50</b> Acres	

1. Is the Operator the only owner in the dedicated acreage outlined on the plat below? YES ☒ NO ☐ . ("Owner" means the person who has the right to drill into and to produce from any pool and to appropriate the production either for himself or for himself and another. (65-3-29 (e) NMSA 1935 Comp.)
2. If the answer to question one is "no," have the interests of all the owners been consolidated by communitization agreement or otherwise? YES ☐ NO ☐ . If answer is "yes," Type of Consolidation \_\_\_\_\_
3. If the answer to question two is "no," list all the owners and their respective interests below:

Owner	Land Description

**RECEIVED**  
**APR 19 1963**

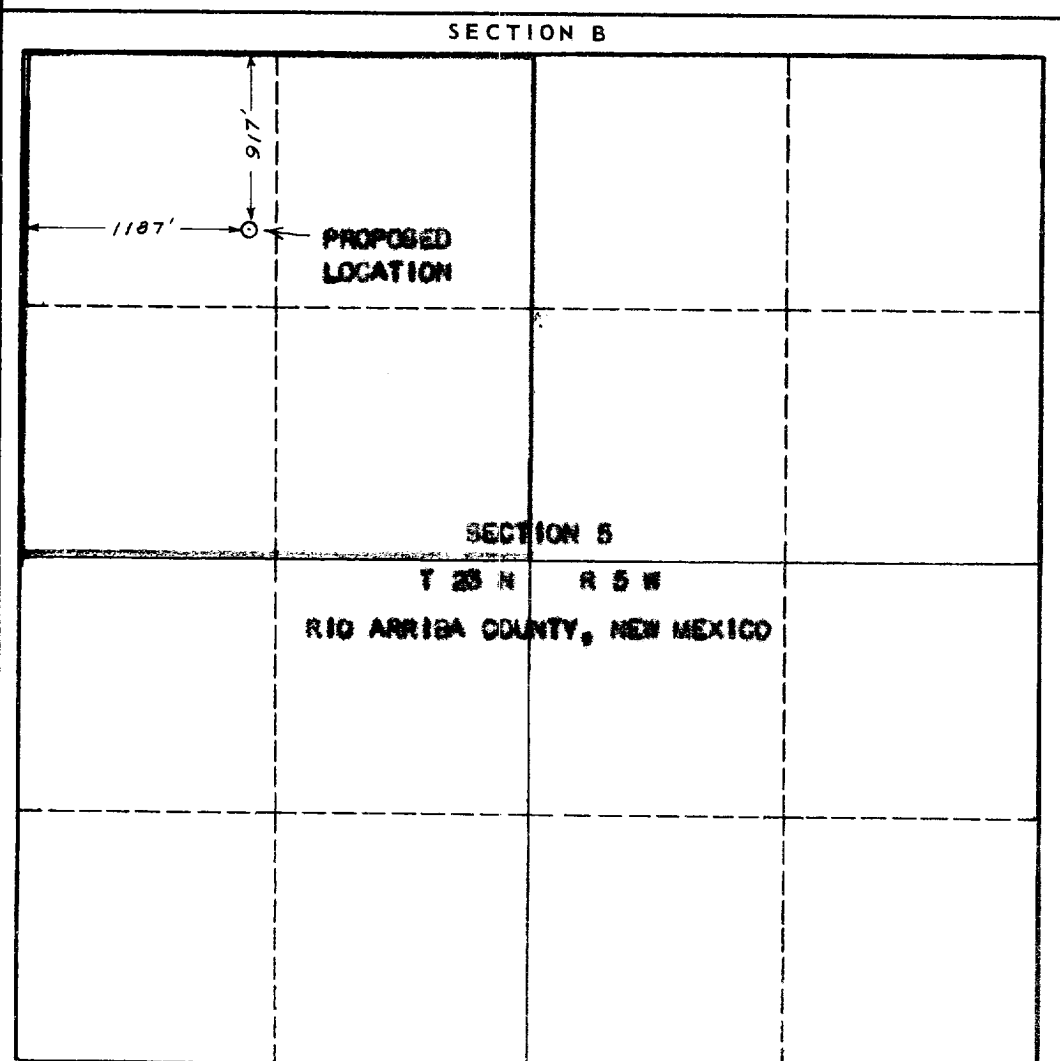

**COM. CERTIFICATION**

I hereby certify that the information in SECTION A above is true and complete to the best of my knowledge and belief.

Name	<b>ORIGINAL SIGNED BY R. E. JENSEN</b>
Position	<b>Asst. Dist. Superintendent</b>
Company	<b>Continental Oil Company</b>
Date	<b>4-18-63</b>

I hereby certify that the well location shown on the plat in SECTION B was plotted from field notes of actual surveys made by me or under my supervision, and that the same is true and correct to the best of my knowledge and belief.

Date Surveyed	<b>April 15, 1963</b>
Registered Professional Engineer and/or Land Surveyor	<i>Thomas M. Clark</i>
Cert. No.	<b>10180</b>

## INSTRUCTIONS FOR COMPLETION OF FORM C-128

1. Operator shall furnish and certify to the information called for in Section A.
2. Operator shall outline the dedicated acreage for *both* oil and gas wells on the plat in Section B.
3. A registered professional engineer or land surveyor registered in the State of New Mexico or approved by the Commission shall show on the plat the location of the well and certify this information in the space provided.
4. All distances shown on the plat must be from the outer boundaries of the Section.
5. If additional space is needed for listing owners and their respective interests as required in question 3 of Section A, please use space below.