

UNITED STATES  
DEPARTMENT OF THE INTERIOR  
GEOLOGICAL SURVEY

30-039-20564

5. LEASE DESIGNATION AND SERIAL NO.

Contract 413

6. IF INDIAN, ALLOTTEE OR TRIBE NAME

Jicarilla

7. UNIT AGREEMENT NAME

8. FARM OR LEASE NAME

Chacon Jicarilla

9. WELL NO.

2

10. FIELD AND POOL, OR WILDCAT

Ballard - P.C. *ext*

11. SEC., T., R., M., OR BLK. AND SURVEY OR AREA

Sec. 15, T-23-N, R-3-W

12. COUNTY OR PARISH 13. STATE

Rio Arriba N.M.

APPLICATION FOR PERMIT TO DRILL, DEEPEN, OR PLUG BACK

1a. TYPE OF WORK

DRILL

DEEPEN

PLUG BACK

b. TYPE OF WELL

OIL WELL

GAS WELL

OTHER

SINGLE ZONE

MULTIPLE ZONE

2. NAME OF OPERATOR

Keesee & Thomas

3. ADDRESS OF OPERATOR

P. O. Box 2026, Farmington, N.M. 87401

4. LOCATION OF WELL (Report location clearly and in accordance with any State requirements.)\*

At surface

790' FSL, 1850' FEL

At proposed prod. zone

Same

14. DISTANCE IN MILES AND DIRECTION FROM NEAREST TOWN OR POST OFFICE\*

18 miles north of Cuba, N.M.

10. DISTANCE FROM PROPOSED\* LOCATION TO NEAREST PROPERTY OR LEASE LINE, FT. (Also to nearest drlg. unit line, if any)

790'

16. NO. OF ACRES IN LEASE

1920

17. NO. OF ACRES ASSIGNED TO THIS WELL

160

18. DISTANCE FROM PROPOSED LOCATION\* TO NEAREST WELL, DRILLING, COMPLETED, OR APPLIED FOR, ON THIS LEASE, FT.

2640'

19. PROPOSED DEPTH

3500'

20. ROTARY OR CABLE TOOLS

Rotary

21. ELEVATIONS (Show whether DF, RT, GR, etc.)

7339' GR

22. APPROX. DATE WORK WILL START\*

9-18-72

23. PROPOSED CASING AND CEMENTING PROGRAM

SIZE OF HOLE	SIZE OF CASING	WEIGHT PER FOOT	SETTING DEPTH	QUANTITY OF CEMENT
12 1/4	9 5/8	32.30	120'	50 sacks
7 7/8	4 1/2	9.5	3500'	100 sacks

It is intended to drill this well to 3500', run 4 1/2" casing to Total Depth, perforate and sand water frac the Pictured Cliffs sandstone.

RECEIVED

SEP 15 1972

U. S. GEOLOGICAL SURVEY  
DURANGO, COLO.



IN ABOVE SPACE DESCRIBE PROPOSED PROGRAM: If proposal is to deepen or plug back, give data on present productive zone and proposed new productive zone. If proposal is to drill or deepen directionally, give pertinent data on subsurface locations and measured and true vertical depths. Give blowout preventer program, if any.

24.

SIGNED *Steve M. Thomas*

TITLE Partner

DATE 9-14-72

(This space for Federal or State office use)

PERMIT NO.

APPROVAL DATE

APPROVED BY

TITLE

DATE

CONDITIONS OF APPROVAL, IF ANY:

**NEW MEXICO OIL CONSERVATION COMMISSION  
WELL LOCATION AND ACERAGE DEDICATION PLAT**

All distances must be from the outer boundaries of the Section

Operator <b>KEESSEE AND THOMAS</b>		Lease <b>CHACON JICARILLA</b>			Well No. <b>2</b>
Unit Letter <b>0</b>	Section <b>15</b>	Township <b>23 NORTH</b>	Range <b>3 WEST</b>	County <b>RIO ARriba</b>	
Actual Footage Location of Well: <b>790</b> feet from the <b>SOUTH</b> line and <b>1850</b> feet from the <b>EAST</b> line					
Ground Level Elev. <b>7339</b>	Producing Formation <b>Pictured Cliffs</b>		Pool <b>Ballard ext</b>	Dedicated Acreage: <b>160</b> Acres	

1. Outline the acreage dedicated to the subject well by colored pencil or hachure marks on the plat below.
2. If more than one lease is dedicated to the well, outline each and identify the ownership thereof (both as to working interest and royalty).
3. If more than one lease of different ownership is dedicated to the well, have the interests of all owners been consolidated by communitization, unitization, force-pooling, etc?

( ) Yes ( ) No If answer is "yes," type of consolidation .....

If answer is "no," list the owners and tract descriptions which have actually consolidated. (Use reverse side of this form if necessary.) .....

No allowable will be assigned to the well until all interests have been consolidated (by communitization, unitization, forced-pooling, or otherwise) or until a non standard unit, eliminating such interests, has been approved by the Commission.

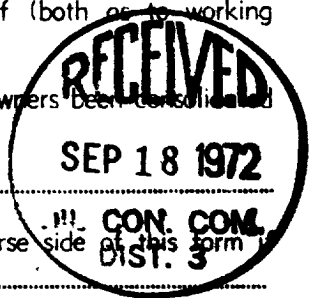

**CERTIFICATION**

I hereby certify that the information contained herein is true and complete to the best of my knowledge and belief.

*Dave M. Thomas, Jr.*

Name  
**Dave M. Thomas, Jr.**

Position  
**Partner**

Company  
**Keessee & Thomas**

Date  
**9-14-72**

I hereby certify that the well location shown on this plat was plotted from field notes of actual surveys made by me or under my supervision, and that the same is true and correct to the best of my knowledge and belief.

**12 September 1972**  
Date Surveyed

*James P. Leese*  
Registered Professional Engineer  
and/or Land Surveyor

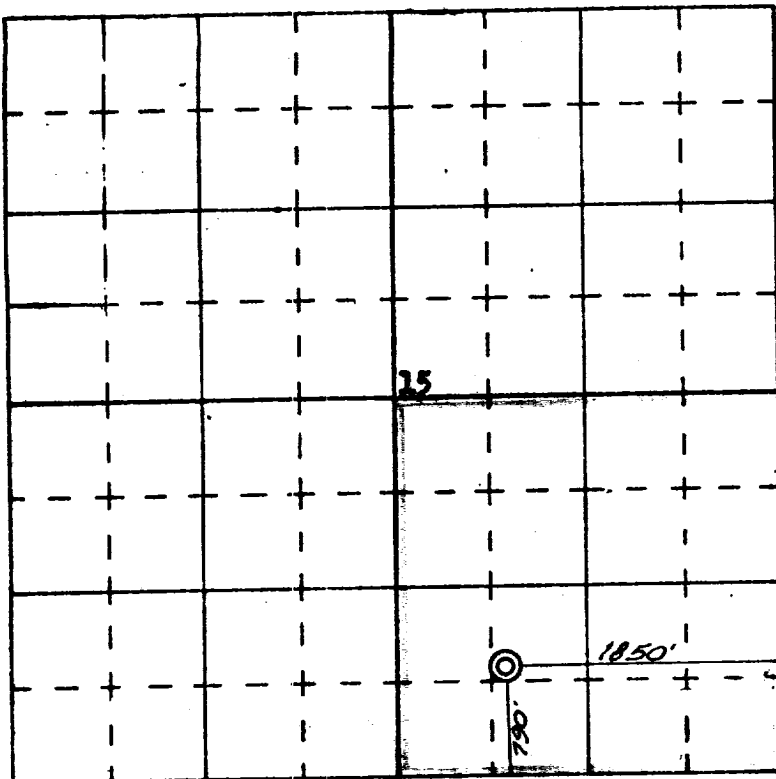
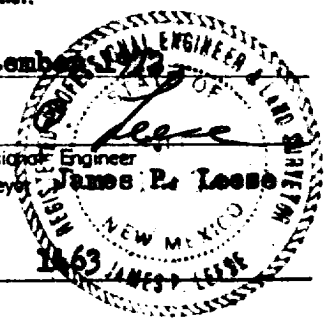

SCALE—4 INCHES EQUALS 1 MILE

**SAN JUAN ENGINEERING COMPANY, FARMINGTON, N. M.**

Certificate No.