

UNITED STATES  
DEPARTMENT OF THE INTERIOR  
GEOLOGICAL SURVEY

SUBMIT IN TRIPPLICATE  
(Other instructions on reverse side)

Form approved  
Budget Bureau No. 42-R1424

SUNDRY NOTICES AND REPORTS ON WELLS

(Do not use this form for proposals to drill or to deepen or plug back to a different reservoir.  
Use "APPLICATION FOR PERMIT—" for such proposals.)

|  |  |  |
|--|--|--|
| 1. OIL WELL <input checked="" type="checkbox"/> GAS WELL <input type="checkbox"/> OTHER <input type="checkbox"/>   |  | 5. LEASE DESIGNATION AND SERIAL NO.<br>Contract No. 412                          |
| 2. NAME OF OPERATOR<br>Odessa Natural Corporation  |  | 7. UNIT AGREEMENT NAME<br>Jicarilla Apache                                       |
| 3. ADDRESS OF OPERATOR<br>P. O. Box 3908, Odessa, Texas 79760  |  | 8. FARM OR LEASE NAME<br>Chacon Jicarilla "D"                                    |
| 4. LOCATION OF WELL (Report location clearly and in accordance with any State requirements.*<br>See also space 17 below.)<br>At surface<br>1777' FSL, 980' FEL |  | 9. WELL NO.<br>2   |
| 14. PERMIT NO.   | 15. ELEVATIONS (Show whether DF, RT, GR, etc.)<br>7378' GL, 7390' KB | 10. FIELD AND POOL, OR WILDCAT<br>Chacon Dakota                                  |
|  |  | 11. SEC., T., R., M., OR BLK. AND SURVEY OR AREA<br>Sec. 16-T23N-R3W<br>N.M.P.M. |
|  |  | 12. COUNTY OR PARISH<br>Rio Arriba   |
|  |  | 13. STATE<br>New Mex.  |

16. Check Appropriate Box To Indicate Nature of Notice, Report, or Other Data

NOTICE OF INTENTION TO:

SUBSEQUENT REPORT OF:

TEST WATER SHUT-OFF ☐  
FRACTURE TREAT ☐  
SHOOT OR ACIDIZE ☐  
REPAIR WELL ☐  
(Other) ☐

PULL OR ALTER CASING ☐  
MULTIPLE COMPLETE ☐  
ABANDON\* ☐  
CHANGE PLANS ☐

WATER SHUT-OFF ☐  
FRACTURE TREATMENT ☐  
SHOOTING OR ACIDIZING ☐  
(Other) See Below

REPAIRING WELL ☐  
ALTERING CASING ☐  
ABANDONMENT\* ☐

(NOTE: Report results of multiple completion on Well Completion or Recompletion Report and Log form.)

17. DESCRIBE PROPOSED OR COMPLETED OPERATIONS (Clearly state all pertinent details, and give pertinent dates, including estimated date of starting any proposed work. If well is directionally drilled, give subsurface locations and measured and true vertical depths for all markers and zones pertinent to this work.)\*

Change Acreage Dedication

From: E/2, 320 Ac., Section 16

To: N/2SE/4, 80 Ac., Section 16

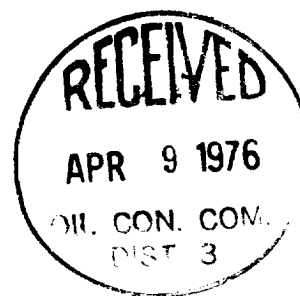

For: Odessa Natural Corporation

18. I hereby certify that the foregoing is true and correct

SIGNED Ewell N. Walsh, P. E.

President, Walsh Engineering  
& Prod. Corp.

DATE April 8, 1976

(This space for Federal or State office use)

APPROVED BY \_\_\_\_\_  
CONDITIONS OF APPROVAL, IF ANY:

TITLE \_\_\_\_\_

DATE \_\_\_\_\_

NEW MEXICO OIL CONSERVATION COMMISSION  
WELL LOCATION AND ACREAGE DEDICATION PLAT

Form No. 1  
September 1972  
Effective 1974

All distances must be from the outer boundaries of the Section.

|                            |        |               |                  |            |   |
|----------------------------|--------|---------------|------------------|------------|---|
| ODESSA NATURAL CORPORATION |        |               | CHACON JICARILLA |            | 2 |
| I                          | 16     | 23 NORTH      | 3 WEST           | RIO ARRIBA |   |
| Section 1777               |        |               |                  |            |   |
| 1777                       |        | SOUTH         | 980              | EAST       |   |
| 7378                       | Dakota | Chacon Dakota |                  | 80         |   |

1. Outline the acreage dedicated to the subject well by colored pencil or hatchure marks on the plat below.
2. If more than one lease is dedicated to the well, outline each and identify the ownership thereof (both as to working interest and royalty).
3. If more than one lease of different ownership is dedicated to the well, have the interests of all owners been consolidated by communitization, unitization, force-pooling, etc?

☐ Yes ☐ No If answer is "yes" type of consolidation \_\_\_\_\_

If answer is "no," list the owners and tract descriptions which have actually been consolidated. (Use reverse side of this form if necessary.) \_\_\_\_\_

No allowable will be assigned to the well until all interests have been consolidated (by communitization, unitization, forced-pooling, or otherwise) or until a non-standard unit, eliminating such interests, has been approved by the Commission.

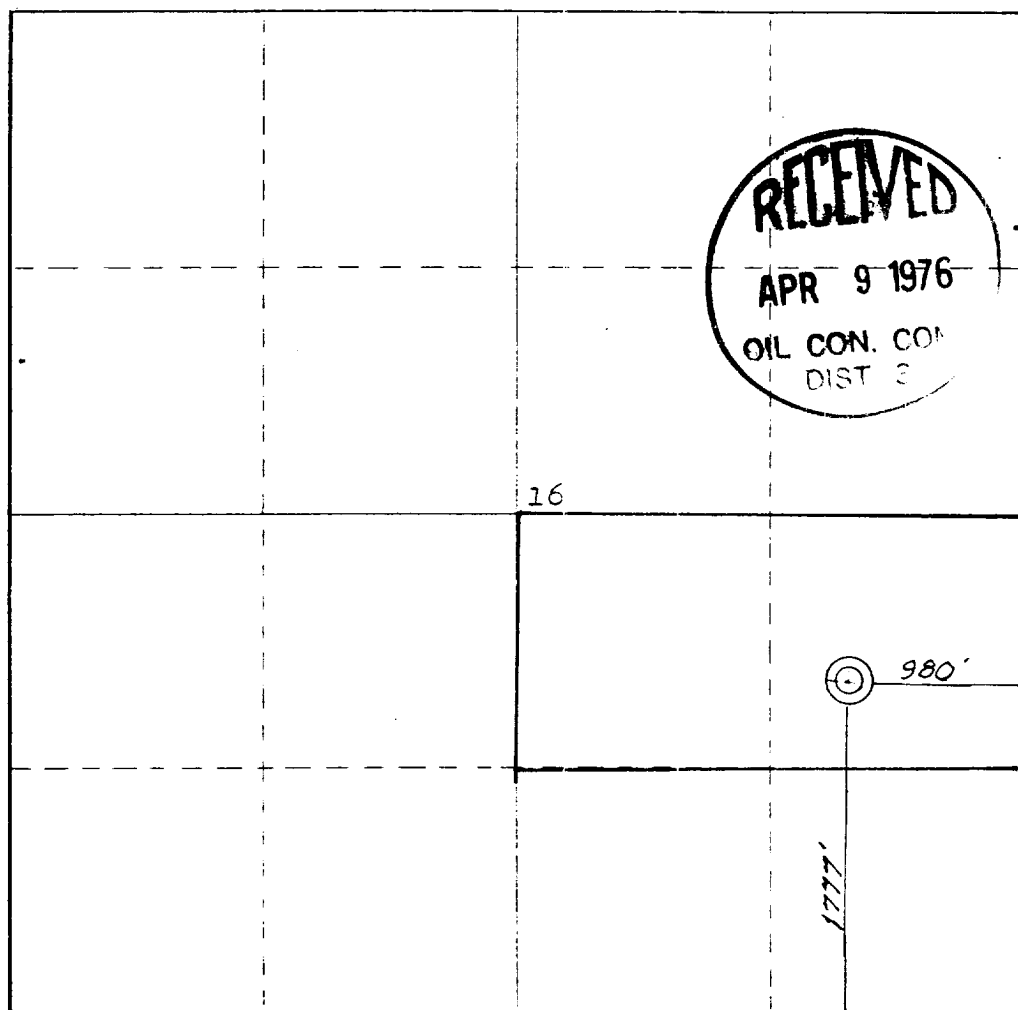

CERTIFICATION

I hereby certify that the information contained herein is true and complete to the best of my knowledge and belief.

For: Odessa Natural Corp.

Ewell N. Walsh, P.E.

President, Walsh Engr.

& Prod. Corp.

Date April 8, 1976

I hereby certify that the information shown on this plat was plotted from notes of a survey made by me under my supervision, and the same is true and correct to the best of my knowledge and belief.

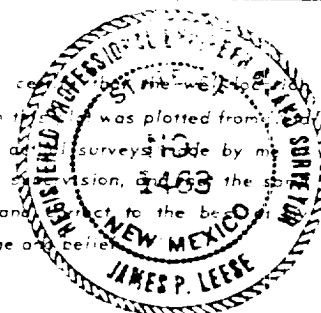

Date Surveyed 14 August 1975

Registered Professional Engineer and or Land Surveyor  
James P. Leese

License No. 1463

Scale: 0 500 1000 1500 2000 2500 3000 3500 4000 4500 5000