

UNITED STATES
DEPARTMENT OF THE INTERIOR
GEOLOGICAL SURVEY

APPLICATION FOR PERMIT TO DRILL, DEEPEN, OR PLUG BACK

1a. TYPE OF WORK

DRILL ☒DEEPEN ☐PLUG BACK ☐

b. TYPE OF WELL

OIL
WELL ☐GAS
WELL ☒OTHER ☐SINGLE
ZONE ☒MULTIPLE
ZONE ☐

2. NAME OF OPERATOR

Amoco Production Company

3. ADDRESS OF OPERATOR

501 Airport Drive, Farmington, New Mexico 87401

4. LOCATION OF WELL (Report location clearly and in accordance with any State requirements.)

At surface

1120' FSL x 820' FEL, Section 8-T23N-R3W

At proposed prod. zone

Same

14. DISTANCE IN MILES AND DIRECTION FROM NEAREST TOWN OR POST OFFICE*

Approximately 30 miles west of Counselors, New Mexico

16. DISTANCE FROM PROPOSED*

LOCATION TO NEAREST
PROPERTY OR LEASE LINE, FT.
(Also to nearest 1/2 sec. unit line, if any)

820'

18. DISTANCE FROM PROPOSED LOCATION*

TO NEAREST WELL DRILLING COMPLETED,
OR APPROVED FOR, ON THIS LEASE, FT.

Approx. 3500'

21. ELEVATIONS (Show whether DE, RT, GR, etc.)

7506' GL

23.

PROPOSED CASING AND CEMENTING PROGRAM

SIZE OF HOLE	SIZE OF CASING	WEIGHT PER FOOT	SETTING DEPTH	QUANTITY OF CEMENT
12-1/4"	8-5/8"	24# (K-55)	400' 300'	210 157 sx Class B neat W/2% CaCl ₂ -circ.
7-7/8"	5-1/2"	17# (K-55)	7600'	Stage 1 - 224 sx-Class "B" neat, 50:50 POZ 6% gel, 2# med tuf plug/sx and .8% fluid loss additive. Tail in 309 sx class "B" neat - circ.
Amoco proposes to drill the above well to further develop the Basin Dakota reservoir. The well will be drilled from 0-300' using native spud mud. The well will then be drilled from 300' to TD using a low solids non-dispersed mud system. Completion design will be based on open hole logs. Copies of all logs will be filed upon completion. Amoco's standard blowout prevention will be employed; see Attachment. The gas from the well is not dedicated at this time.				Stage 2 - 587 sx-Class "B" 65:35 POZ 6% gel, 2# med tuf plug/sx and .8% fluid loss additive. Tail in 100 sx class "B" neat-circ.

IN CASE SPACE IS NEEDED FOR PROPOSED PROGRAM: If proposal is to deepen or plug back, give data on present productive zone and proposed new productive zone. If proposal is to drill or deepen directionally, give pertinent data on subsurface locations and measured and true vertical depths. Give blowout prevention program, if any.

SIGNED

TITLE

District Engineer

DATE

MAR 26 1982

(This space for Federal or State office use)

PERMIT NO.

APPROVAL DATE

APPROVED BY

TITLE

CONDITIONS OF APPROVAL, IF ANY:

NMOCC

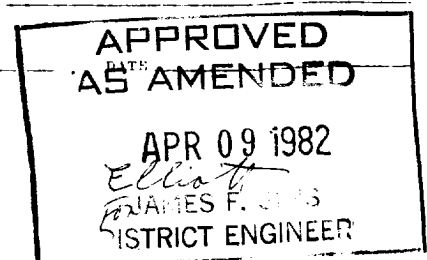

All distances must be from the outer boundaries of the Section.

Operator AMOCO PRODUCTION COMPANY			Lease JICARILLA TRIBAL 396		Well No. 2
Unit Letter P	Section 8	Township 23N	Range 3W	County Rio Arriba	
Actual Footage Location of Well: 1120 feet from the South line and 820 feet from the East line					
Ground Level Elev. 7506	Producing Formation Dakota		Pool Basin Dakota		Dedicated Acreage: 320 Acres

1. Outline the acreage dedicated to the subject well by colored pencil or hachure marks on the plat below.
2. If more than one lease is dedicated to the well, outline each and identify the ownership thereof (both as to working interest and royalty).
3. If more than one lease of different ownership is dedicated to the well, have the interests of all owners been consolidated by communitization, unitization, force-pooling, etc?

☐ Yes ☐ No If answer is "yes," type of consolidation _____

If answer is "no," list the owners and tract descriptions which have actually been consolidated. (Use reverse side of this form if necessary.) _____

No allowable will be assigned to the well until all interests have been consolidated (by communitization, unitization, forced-pooling, or otherwise) or until a non-standard unit, eliminating such interests, has been approved by the Commission.

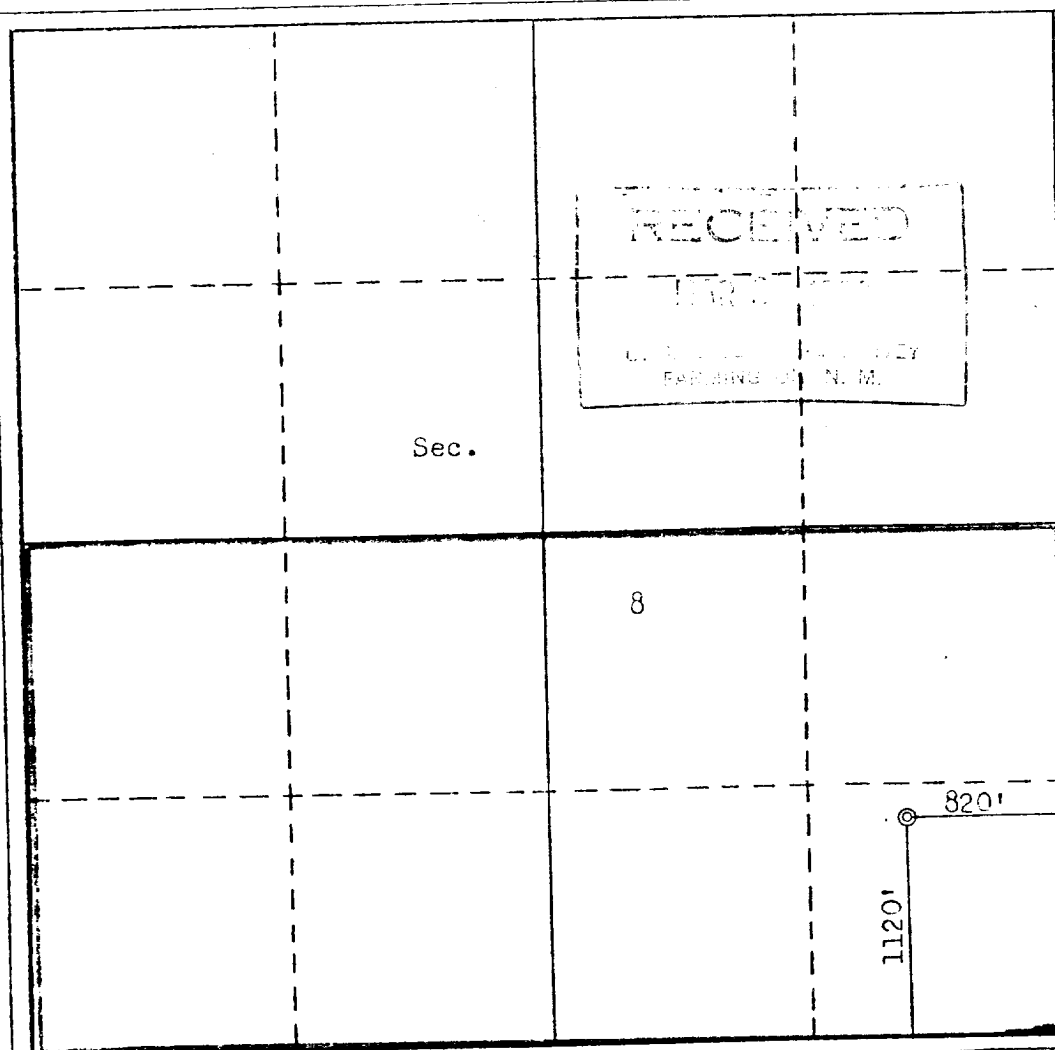

CERTIFICATION

I hereby certify that the information contained herein is true and complete to the best of my knowledge and belief.

Wayne L. Peterson
Name

Wayne L. Peterson

District Engineer

Company
Amoco Production Company

Date
MAR 26 1982

I hereby certify that the well location shown on this plat was plotted from field notes of actual surveys made by me or under my supervision, and that the same is true and correct to the best of my knowledge and belief.

Date Surveyed

March 26 1982

Registered Professional Engineer and/or Land Surveyor

Fred B. Kerr Jr.
Fred B. Kerr Jr.

Certificate No.

3950