

NO. OF COPIES RECEIVED	
DISTRIBUTION	
SANTA FE	
FILE	
U.S.G.S.	
LAND OFFICE	
OPERATOR	

NEW MEXICO OIL CONSERVATION COMMISSION

Form C-103
Supersedes Old
C-102 and C-103
Effective 1-1-65

5a. Indicate Type of Lease	
State <input type="checkbox"/>	Fee <input checked="" type="checkbox"/>
5. State Oil & Gas Lease No.	

SUNDRY NOTICES AND REPORTS ON WELLS

(DO NOT USE THIS FORM FOR PROPOSALS TO DRILL OR TO DEEPEN OR PLUG BACK TO A DIFFERENT RESERVOIR.
USE "APPLICATION FOR PERMIT -" (FORM C-101) FOR SUCH PROPOSALS.)

1. OIL WELL <input checked="" type="checkbox"/> GAS WELL <input type="checkbox"/> OTHER <input type="checkbox"/>		7. Unit Agreement Name
2. Name of Operator Merrion Oil & Gas Corporation		8. Farm or Lease Name Rita Com
3. Address of Operator P. O. Box 1017, Farmington, New Mexico 87499		9. Well No. 3
4. Location of Well UNIT LETTER <u>K</u> <u>1710</u> FEET FROM THE <u>South</u> LINE AND <u>1990</u> FEET FROM THE <u>West</u> LINE, SECTION <u>15</u> , TOWNSHIP <u>23N</u> RANGE <u>6W</u> NMPM.		10. Field and Pool, or Wildcat Counselors Gallup
15. Elevation (Show whether DF, RT, GR, etc.) 6908' GL		12. County Rio Arriba

Check Appropriate Box To Indicate Nature of Notice, Report or Other Data

NOTICE OF INTENTION TO:

PERFORM REMEDIAL WORK ☐
TEMPORARILY ABANDON ☐
PULL OR ALTER CASING ☐
OTHER ☐

PLUG AND ABANDON ☐
CHANGE PLANS ☐

SUBSEQUENT REPORT OF:

REMEDIAL WORK ☐
COMMENCE DRILLING OPNS. ☐
CASING TEST AND CEMENT JOB ☐
OTHER ☐ Change of location

17. Describe Proposed or Completed Operations (Clearly state all pertinent details, and give pertinent dates, including estimated date of starting any proposed work) SEE RULE 1103.

Original footage of 1710' FSL and 2045' FWL, Sec. 15, T23N, R6W has been changed to 1710' FSL and 1990' FWL, Sec. 15, T23N, R6W so that the well is a standard location.

OK JAE

Tract is odd size so that this is a standard location

18. I hereby certify that the information above is true and complete to the best of my knowledge and belief.

SIGNED [Signature] TITLE Operations Manager DATE 12/2/82

APPROVED BY Jeff Edmister TITLE Sec DATE 1982

CONDITIONS OF APPROVAL, IF ANY:

All distances must be from the outer boundaries of the Section.

Operator MERRION OIL & GAS CORPORATION			Lease RITA COM		Well No. 3
Unit Letter K	Section 15	Township 23N	Range 6W	County Rio Arriba	
Actual Footage Location of Well: 1710 feet from the South line and 1990 feet from the West line					
Ground Level Elev. 6908	Producing Formation Gallup		Pool Counselors Gallup		Dedicated Acreage: 160.457.93 Acres

1. Outline the acreage dedicated to the subject well by colored pencil or hachure marks on the plat below.
2. If more than one lease is dedicated to the well, outline each and identify the ownership thereof (both as to working interest and royalty).
3. If more than one lease of different ownership is dedicated to the well, have the interests of all owners been consolidated by communitization, unitization, force-pooling, etc?

☒ Yes ☐ No If answer is "yes," type of consolidation Communitized

If answer is "no," list the owners and tract descriptions which have actually been consolidated. (Use reverse side of this form if necessary.)

No allowable will be assigned to the well until all interests have been consolidated (by communitization, unitization, forced-pooling, or otherwise) or until a non-standard unit, eliminating such interests, has been approved by the Commission.

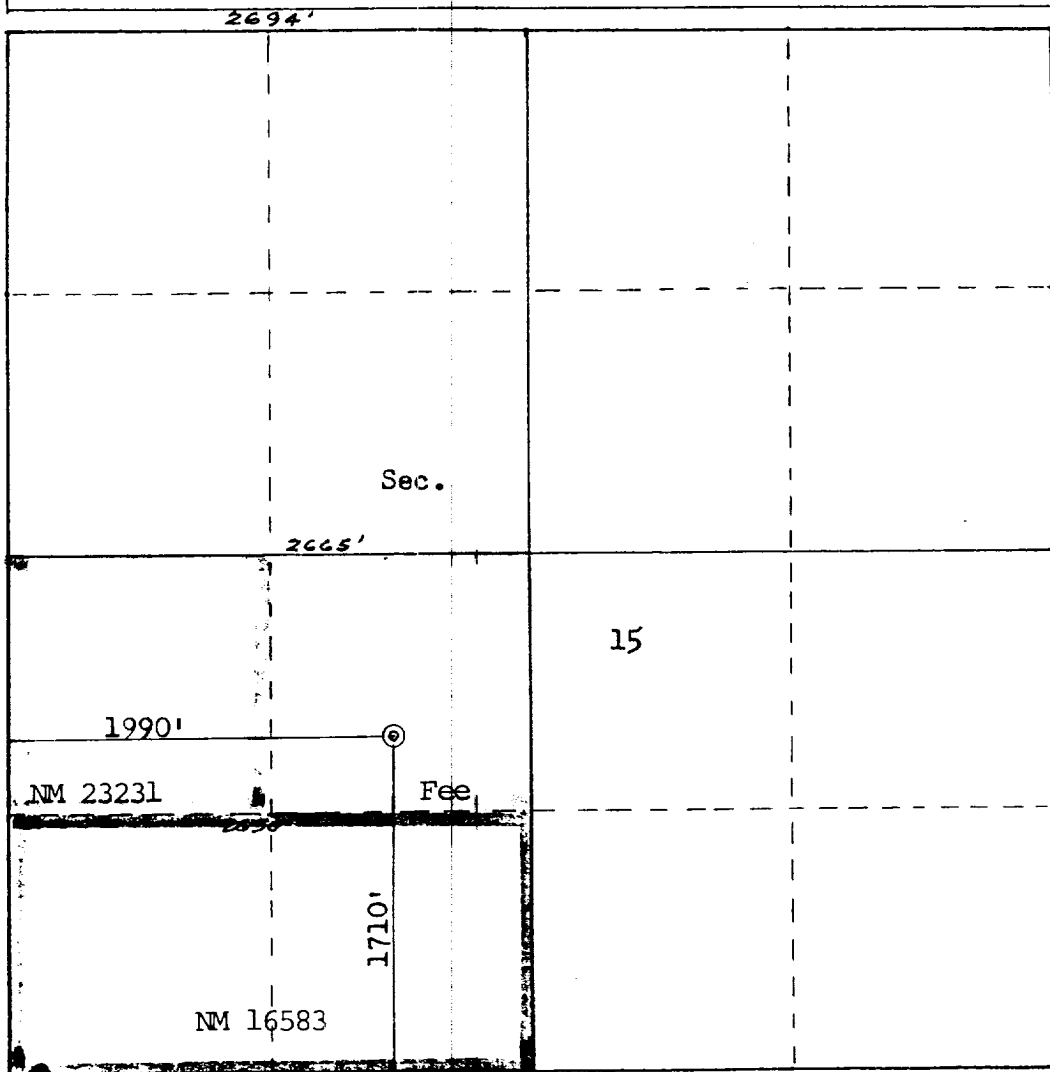

Scale: 1"=1000'

CERTIFICATION

I hereby certify that the information contained herein is true and complete to the best of my knowledge and belief.

Name

Steve S. Dunn

Position

Operations Manager

Company

Merrion Oil & Gas Corp.

Date

12/2/82

I hereby certify that the well location shown on this plat was plotted from field notes of actual surveys made by me or under my supervision, and that the same is true and correct to the best of my knowledge and belief.

Date Surveyed

December 1, 1982

Registered Professional Engineer and Land Surveyor

Fred B. Kerr Jr.

Certificate No. **3950**