

NEW MEXICO
OIL CONSERVATION COMMISSION

Form C-128

Well Location and/or Gas Proration Plat

Date _____

Operator S. D. Johnson Lease _____

Well No. 1, Haller Estate Section 34 Township 20 North Range 1 West NMPM

Located 1980 Feet From South Line, 1980 Feet From West Line,

Sandoval County, New Mexico. G. L. Elevation 6914

Name of Producing Formation _____ Pool _____ Dedicated Acreage _____

(Note: All distances must be from outer boundaries of Section)

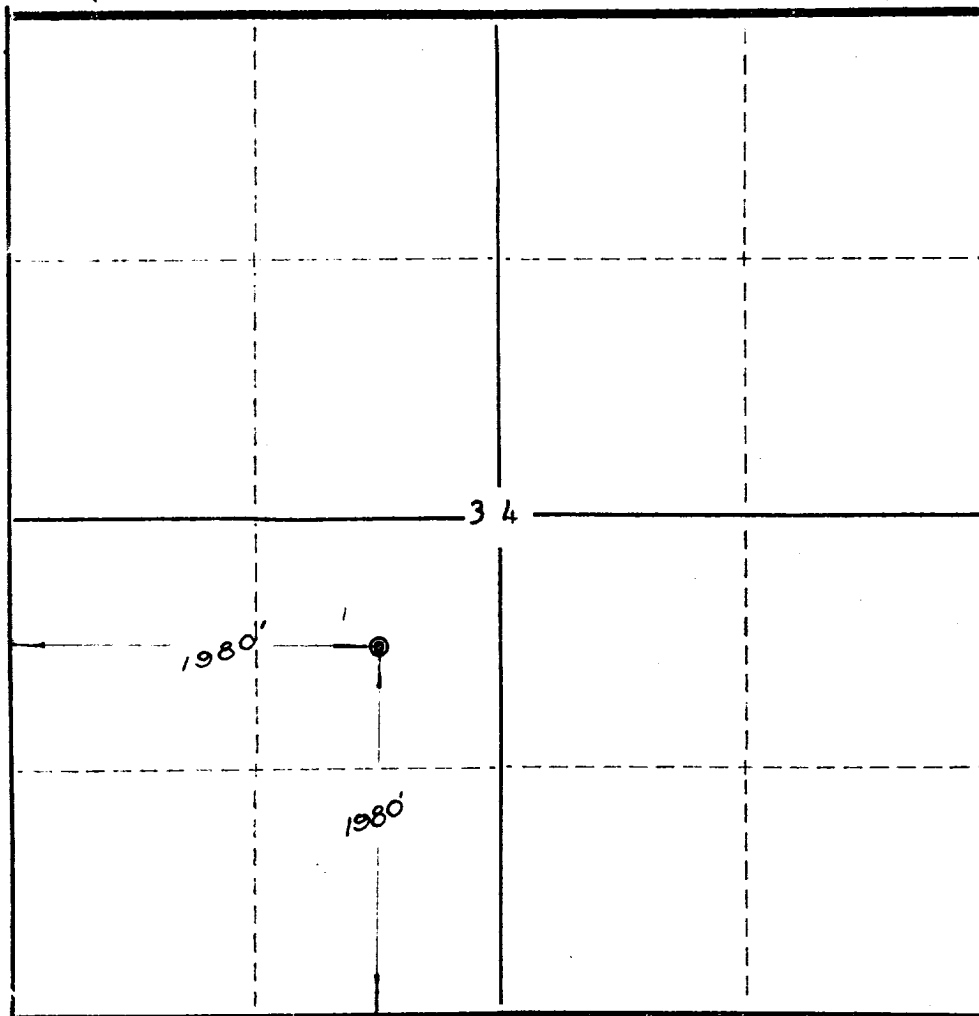

NOTE

This section of form is to be used for gas wells only.

SCALE: 1"=1000'

1. Is this Well a Dual Comp. ? Yes _____ No _____
2. If the answer to Question 1 is yes, are there any other dually completed wells within the dedicated acreage?
Yes _____ No _____

Name _____

Position _____

Representing _____

Address _____

This is to certify that the above plat was prepared from field notes of actual surveys made by me or under my supervision and that the same are true and correct to the best of my knowledge.



Date Surveyed October 8, 1956

Ernest V. Echohawk

Ernest V. Echohawk
Reg. Land Surveyor, N. Mex., Reg. No. 1545

OIL CONSERVATION COMMISSION		
AZTEC DISTRICT OFFICE		
No. Copies Received <u>5</u>		
DISTRIBUTION		
	NO. FURNISHED	
Operator	<u>2</u>	
Santa Fe	<u>1</u>	
Proration Office		
State Land Office		
U. S. G. S.	<u>1</u>	
Transporter		
File	<u>1</u>	✓