

UNITED STATES
DEPARTMENT OF THE INTERIOR
GEOLOGICAL SURVEY

APPLICATION FOR PERMIT TO DRILL, DEEPEN, OR PLUG BACK

1a. TYPE OF WORK

DRILL ☒DEEPEN ☐PLUG BACK ☐

b. TYPE OF WELL

OIL
WELL ☒GAS
WELL ☐OTHER ☐SINGLE
ZONE ☐MULTIPLE
ZONE ☐

2. NAME OF OPERATOR

Aztec Energy Corporation

3. ADDRESS OF OPERATOR

1206 East 20th Street, Farmington, N. M. 87401

4. LOCATION OF WELL (Report location clearly and in accordance with any State requirements.)

At surface

1904 FSL and 2200 FWL
At proposed prod. zone

Gallup

14. DISTANCE IN MILES AND DIRECTION FROM NEAREST TOWN OR POST OFFICE*

1 1/2 miles West of Counselor, N. M.

15. DISTANCE FROM PROPOSED*

LOCATION TO NEAREST

PROPERTY OR LEASE LINE, FT.

(Also to nearest drlg. unit line, if any)

584 ft.

18. DISTANCE FROM PROPOSED LOCATION*

TO NEAREST WELL, DRILLING, COMPLETED,
OR APPLIED FOR, ON THIS LEASE, FT.

16. NO. OF ACRES IN LEASE

200

19. PROPOSED DEPTH

5690

17. NO. OF ACRES ASSIGNED
TO THIS WELL

40

20. ROTARY OR CABLE TOOLS

Rotary

21. ELEVATIONS (Show whether DF, RT, GR, etc.)

7144 GR

22. APPROX. DATE WORK WILL START*

23.

PROPOSED CASING AND CEMENTING PROGRAM

SIZE OF HOLE	SIZE OF CASING	WEIGHT PER FOOT	SETTING DEPTH	QUANTITY OF CEMENT
12-1/4"	8-5/8"	24.0#	250	200 Sx Circ. to Surface
7-7/8"	5-1/2"	15.5#	5690	420 Sxs 2 stage

1. Drill 12-1/4" hole to approx. 250 feet and run new 8-5/8" 24#/ft. casing. Cement casing with approx. 200 sx cement, circulating to the surface.
2. Install BOP and test casing and BOP to 1000 psig.
3. Drill 7-7/8" to approx 5690 feet with fresh water gel mud.
4. Log well.
5. Run and set 5-1/2", 15.5# casing and cement in two stages, cement to cover Ojo Alamo.
6. Perforate and stimulate Gallup Formation. Clean up well and complete as required.

IN ABOVE SPACE DESCRIBE PROPOSED PROGRAM: If proposal is to deepen or plug back, give data on present productive zone and proposed new productive zone. If proposal is to drill or deepen directionally, give pertinent data on subsurface locations and measured and true vertical depths. Give blowout preventer program, if any.

24.

SIGNED

Ronnie W. Allen

TITLE

Geologist

DATE

6-23-82

(This space for Federal or State office use)

PERMIT NO.

APPROVAL DATE

APPROVED BY

CONDITIONS OF APPROVAL, IF ANY:

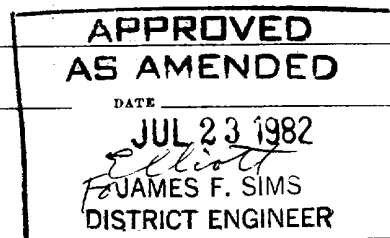
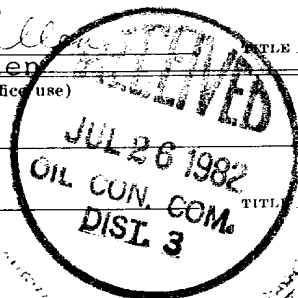

NMOCC

WELL LOCATION AND ACREAGE DEDICATION PLAT

Supercedes C-128
Effective 1-1-83

All distances must be from the outer boundaries of the Section.

Operator AZTEC ENERGY CORPORATION			Lease Emily		Well No. 2
Unit Letter K	Section 20	Township 23 NORTH	Range 6 WEST	County SANDOVAL	
Actual Footage Location of Well:					
1904 feet from the SOUTH line and		2200 feet from the WEST line			
Ground Level Elev. 7144	Producing Formation Gallup	Pool Lybrook Extension	Dedicated Acreage: 40 Acres		

1. Outline the acreage dedicated to the subject well by colored pencil or hachure marks on the plat below.
2. If more than one lease is dedicated to the well, outline each and identify the ownership thereof (both as to working interest and royalty).
3. If more than one lease of different ownership is dedicated to the well, have the interests of all owners been consolidated by communitization, unitization, force-pooling, etc?

☐ Yes ☐ No If answer is "yes," type of consolidation _____

If answer is "no," list the owners and tract descriptions which have actually been consolidated. (Use reverse side of this form if necessary.) _____

No allowable will be assigned to the well until all interests have been consolidated (by communitization, unitization, forced-pooling, or otherwise) or until a non-standard unit, eliminating such interests, has been approved by the Commission.

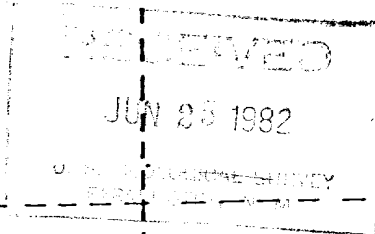
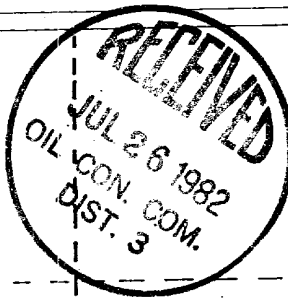
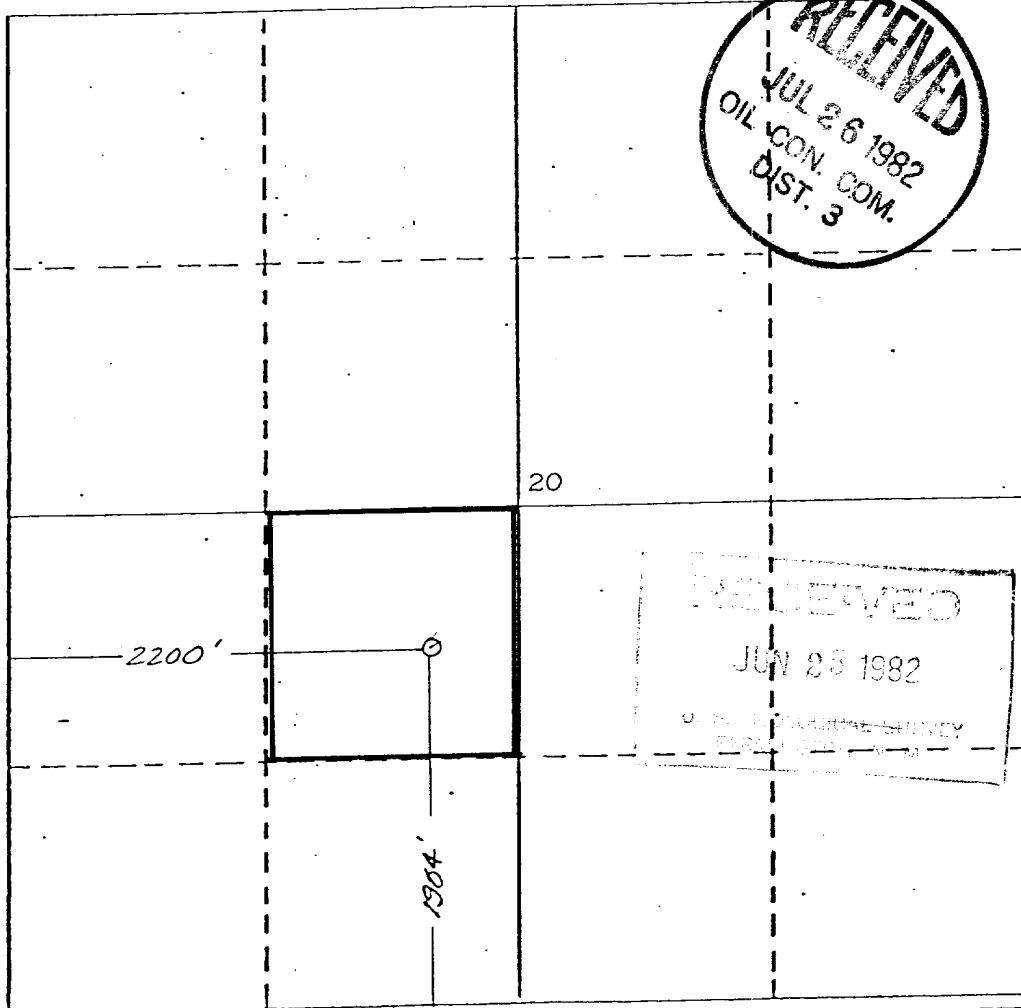

CERTIFICATION

I hereby certify that the information contained herein is true and complete to the best of my knowledge and belief.

Ronnie W. Allen
Name

Geologist
Position

Aztec Energy Corp
Company

June 23, 1982
Date

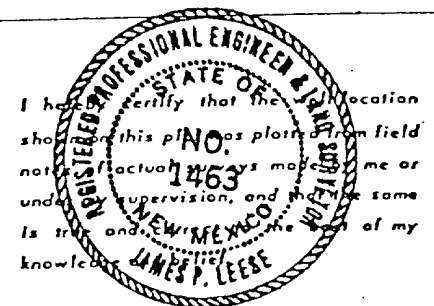

Date Surveyed
21 June 1982

Registered Professional Engineer
and/or Land Surveyor

James P. Lease
James P. Lease

Certificate No.
1463

