

UNITED STATES
DEPARTMENT OF THE INTERIOR
GEOLOGICAL SURVEY

30-043-20672

APPLICATION FOR PERMIT TO DRILL, DEEPEN, OR PLUG BACK

1a. TYPE OF WORK

DRILL ☒DEEPEN ☐PLUG BACK ☐

b. TYPE OF WELL

OIL
WELL ☒GAS
WELL ☐OTHER ☐SINGLE
ZONE ☐MULTIPLE
ZONE ☐

2. NAME OF OPERATOR

~~LOBO PRODUCTION~~

(Dick Lauritsen)

3. ADDRESS OF OPERATOR

P.O. BOX 2364, Farmington, New Mex. 87490

4. LOCATION OF WELL (Report location clearly and in accordance with any State requirements.)

At surface

920' FNL, 795' FWL

At proposed prod. zone

14. DISTANCE IN MILES AND DIRECTION FROM NEAREST TOWN OR POST OFFICE*

30 miles Northwest of Cuba, New Mexico

15. DISTANCE FROM PROPOSED*

LOCATION TO NEAREST
PROPERTY OR LEASE LINE, FT.
(Also to nearest drlg. unit line, if any)

18. DISTANCE FROM PROPOSED LOCATION*

TO NEAREST WELL, DRILLING, COMPLETED,
OR APPLIED FOR, ON THIS LEASE, FT.

21. ELEVATIONS (Show whether DF, RT, GR, etc.)

7069' Gr.

23. PROPOSED CASING AND CEMENTING PROGRAM

SIZE OF HOLE	SIZE OF CASING	WEIGHT PER FOOT	SETTING DEPTH	QUANTITY OF CEMENT
12 1/2"	8 5/8"	J55-23#	200'	175 Sacks
7 7/8"	4 1/2"	K55-10.5#	5650'	850 Sacks

Will drill 12 1/4" hole to 200 ft. and set 200' of 8 5/8", 23#, used casing with 175 sacks of cement. Will drill 7 7/8" hole to 5,650', and run open hole logs. If appears productive, will run 5650' of 4 1/2" 10.5# new casing and bring cement up across Ojo Alamo formation. Will perforate and stimulate as required. Minimum specifications for pressure control equipment which is to be used; 10", 900 Series Double Ran BOP

FORMATION	ESTIMATED TOPS DEPTH	CONTENT
Ojo Alamo	1668'	" "
Picture Cliffs	2156'	" "
Chacra	2658'	" "
Point Lookout	4474'	" "
Mancos	4698'	" "
Gallup	5290'	Oil, Gas

19. ABOVE SPACE DESCRIBE PROPOSED PROGRAM: If proposal is to deepen or plug back, give data on proposed productive zone and proposed new productive zone. If proposal is to drill or deepen directionally, give pertinent data on subsurface locations and measured and true vertical depths. Give blowout preventer program, if any.

24.

SIGNED

James F. Roberts

TITLE

Operator

DATE

3-14-83

(This space for Federal or State office use)

PERMIT NO.

APPROVAL DATE

APPROVED BY

TITLE

DATE

CONDITIONS OF APPROVAL, IF ANY:

ch 2

NMOCC

James F. Sims
DISTRICT ENGINEER

All distances must be from the outer boundaries of the Section.

Operator LOBO PRODUCTION <u>DICK LAUTITSEN</u>		Lease #1 Gulf Federal - 24		Well No. 1
Unit Letter D	Section 24	Township 23 NORTH	Range 6 WEST	County SANDOVAL
Actual Footage Location of Well:				
920	feet from the	NORTH	line and	795
feet from the			WEST	line
Ground Level Elev. 7069	Producing Formation Gallup		Pool <u>Counselors</u> Undesignated Gallup Ext	Dedicated Acreage: 40/160
				Acre

1. Outline the acreage dedicated to the subject well by colored pencil or hatchure marks on the plat below.
2. If more than one lease is dedicated to the well, outline each and identify the ownership thereof (both as to working interest and royalty).
3. If more than one lease of different ownership is dedicated to the well, have the interests of all owners been consolidated by communitization, unitization, force-pooling, etc?

☐ Yes ☐ No If answer is "yes," type of consolidation N/A

If answer is "no," list the owners and tract descriptions which have actually been consolidated. (Use reverse side of this form if necessary.)

No allowable will be assigned to the well until all interests have been consolidated (by communitization, unitization, forced-pooling, or otherwise) or until a non-standard unit, eliminating such interests, has been approved by the Division

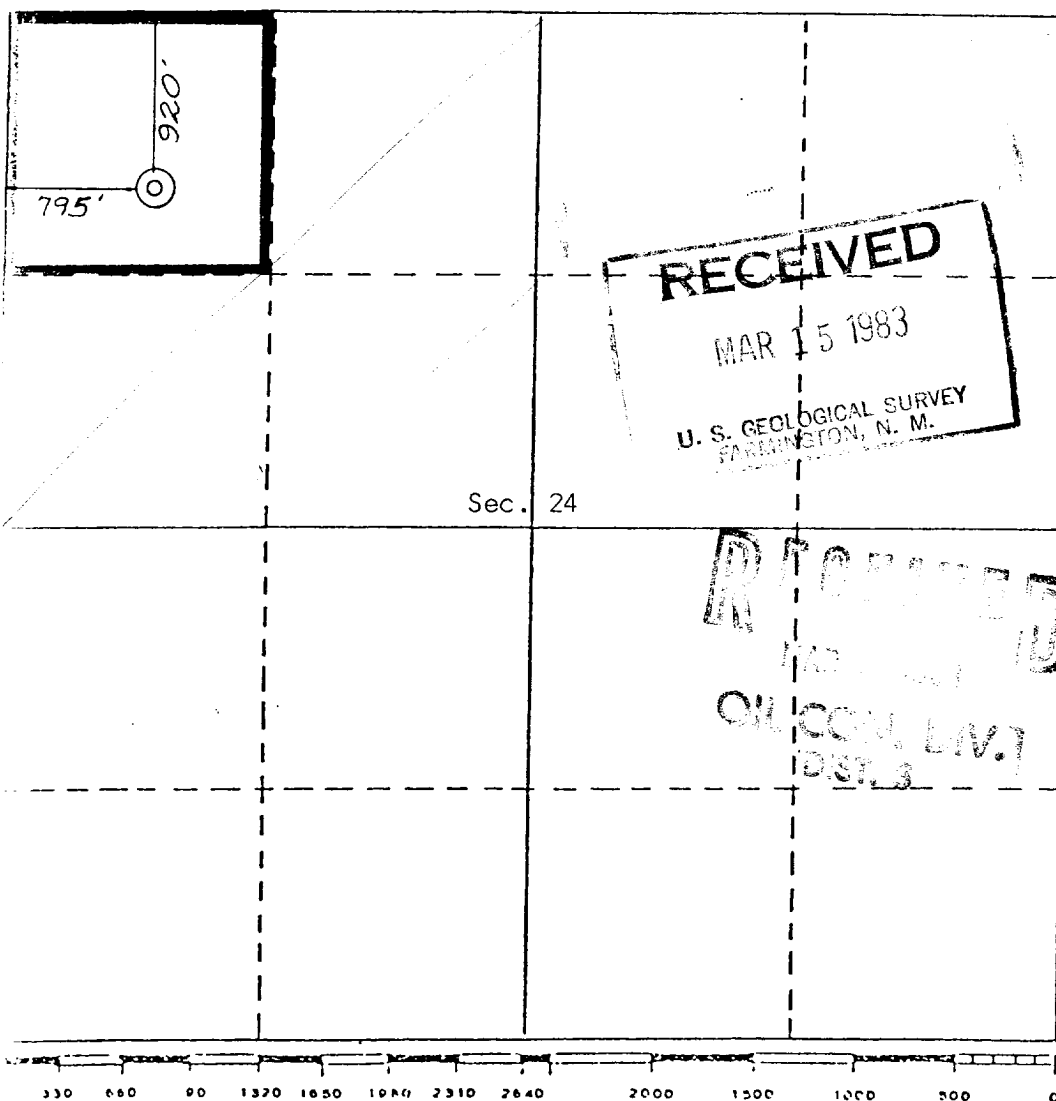

CERTIFICATION

I hereby certify that the information contained herein is true and complete to the best of my knowledge and belief.

Name Gary E. Roberts
Position PARTNER - OPERATOR
Company LOBO PRODUCTION
Date 3 - 3 - 83

I hereby certify that the well location shown on this plat was plotted from field notes of actual surveys made by me or under my supervision, and that the same is true and correct to the best of my knowledge and belief.

20 December 1982
Date Surveyed
NEW MEXICO
Registered Professional Engineer
and/or Land Surveyor
Curtis C. Stocking
CURTIS C. STOCKING
Certificate No. N.M. 5980

LOBO PRODUCTION #1 GULF FEDERAL
 D - 24 - 23N - 26W
 SANDOVAL COUNTY NEW MEXICO

Gallo

14

Counselor

DETACHED EMPLOYEES

SUCRUITE
 21 TEXAS

LOBO ROAD
 #1 GULF FEDERAL

M A I
 LOCAL

