

UNITED STATES
DEPARTMENT OF THE INTERIOR
GEOLOGICAL SURVEY

APPLICATION FOR PERMIT TO DRILL, DEEPEN, OR PLUG BACK

1a. TYPE OF WORK
DRILL ☒ DEEPEN ☐ PLUG BACK ☐

b. TYPE OF WELL
OIL WELL ☒ GAS WELL ☐ OTHER ☐ SINGLE ZONE ☐ MULTIPLE ZONE ☐

2. NAME OF OPERATOR
Anderson Oil Company

3. ADDRESS OF OPERATOR
635 Majestic Bldg. Denver, Colorado 80202

4. LOCATION OF WELL (Report location clearly and in accordance with any State requirements.)
At surface
430 FNL 2000 FEL Sec.36-T22N-R14W
At proposed prod. zone
Same

14. DISTANCE IN MILES AND DIRECTION FROM NEAREST TOWN OR POST OFFICE*

12 miles south of Bisti, N. Mex.

15. DISTANCE FROM PROPOSED* LOCATION TO NEAREST PROPERTY OR LEASE LINE, FT.
(Also to nearest drig. unit line, if any)
430

16. NO. OF ACRES IN LEASE
640

17. NO. OF ACRES ASSIGNED TO THIS WELL
40

18. DISTANCE FROM PROPOSED* LOCATION TO NEAREST WELL, DRILLING COMPLETED, OR APPLIED FOR, ON THIS LEASE, FT.
0

19. PROPOSED DEPTH
4100

20. ROTARY OR CABLE TOOLS

Rotary

21. ELEVATIONS (Show whether DF, RT, GR, etc.)

6127 Gr.

22. APPROX. DATE WORK WILL START*

8-4-71

23. PROPOSED CASING AND CEMENTING PROGRAM

SIZE OF HOLE	SIZE OF CASING	WEIGHT PER FOOT	SETTING DEPTH	QUANTITY OF CEMENT
12-1/4	8-5/8	24	69	50 sacks (circulated)
7-7/8	4-1/2	10.5	T.D.	150 sacks

This well will be drilled to log and test any show of oil and gas.
The primary objective will be the Dakota
Adequate drilling operation will be observed at all times.

The mud properties will be low fluid loss and low solids as deemed necessary. We will run IES-Density-C, logs and drill stem test as justified from logs. No coring is anticipated.

IN ABOVE SPACE DESCRIBE PROPOSED PROGRAM: If proposal is to deepen or plug back, give data on present productive zone and proposed new productive zone. If proposal is to drill or deepen directionally, give pertinent data on subsurface locations and measured and true vertical depths. Give blowout preventer program, if any.

24.

SIGNED Allen B. Burrell TITLE Chief Clerk

DATE 7-31-71

(This space for Federal or State office use)

PERMIT NO.

APPROVAL DATE

APPROVED BY

TITLE

CONDITIONS OF APPROVAL, IF ANY:

*See Instructions On Reverse Side

NEW MEXICO OIL CONSERVATION COMMISSION

WELL LOCATION AND ACERAGE DEDICATION PLAT

All distances must be from the outer boundaries of the Section

Operator ANDERSON OIL COMPANY		Lease Navajo Duncan		Well No. 1
Unit Letter B	Section 36	Township 22 NORTH	Range 14 WEST	County SAN JUAN
Actual Footage Location of Well: 430 feet from the NORTH line and 2000 feet from the EAST line				
Ground Level Elev. 6127.0	Producing Formation Dakota	Pool Wildcat	Dedicated Acreage 40	Acres

1. Outline the acreage dedicated to the subject well by colored pencil or hatchure marks on the plat below.
2. If more than one lease is dedicated to the well, outline each and identify the ownership thereof (both as to working interest and royalty).
3. If more than one lease of different ownership is dedicated to the well, have the interests of all owners been consolidated by communitization, unitization, force-pooling, etc?
☐ Yes ☐ No If answer is "yes," type of consolidation _____

If answer is "no," list the owners and tract descriptions which have actually consolidated (Use reverse of this form if necessary.) _____

No allowable will be assigned to the well until all interests have been consolidated (by communitization, unitization, forced-pooling, or otherwise) or until a non standard unit, eliminating such interests, has been approved by the Commission.

CERTIFICATION

I hereby certify that the information contained herein is true and complete to the best of my knowledge and belief.

Name Allen Brewer
 Position Chief Clerk
 Company Anderson Oil Company
 Date 7-31-71

I hereby certify that the well location shown on this plat was plotted from field notes of actual surveys made by me or under my supervision, and that the same is true and correct to the best of my knowledge and belief.

Date Surveyed 23 July, 1971
 Signature [Signature]
 Registered Professional Engineer and Land Surveyor
 JAMES P. LEASE
 Certificate No. 12863

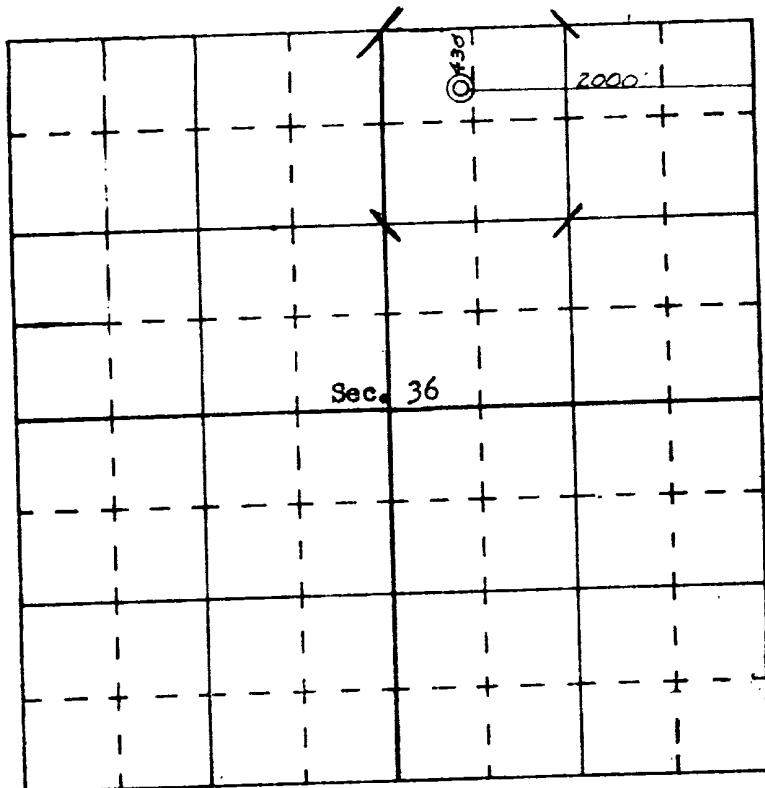

SCALE—4 INCHES EQUALS 1 MILE

SAN JUAN ENGINEERING COMPANY, FARMINGTON, N. M.