

UNITED STATES
DEPARTMENT OF THE INTERIOR
GEOLOGICAL SURVEY

30-045-20-51

APPLICATION FOR PERMIT TO DRILL, DEEPEN, OR PLUG BACK

1a. TYPE OF WORK

DRILL ☐DEEPEN ☐PLUG BACK ☐

b. TYPE OF WELL

OIL
WELL ☒GAS
WELL ☐OTHER ☐SINGLE
ZONE ☒MULTIPLE
ZONES ☐

2. NAME OF OPERATOR

Bco. Inc.

3. ADDRESS OF OPERATOR

P.O. Box 669 Santa Fe, N.M. 87501

4. LOCATION OF WELL (Report location clearly and in accordance with any State requirements.)*

At surface

1960' FEL 2080' FSL Sec 8 T23N 88W

At proposed prod. zone SAME

14. DISTANCE IN MILES AND DIRECTION FROM NEAREST TOWN OR POST OFFICE*

4 miles Nageezi, N.M. 87037

15. DISTANCE FROM PROPOSED*

LOCATION TO NEAREST
PROPERTY OR LEASE LINE, FT.
(Also to nearest drlg. line, if any)

16. NO. OF ACRES IN LEASE

1919.60

17. NO. OF ACRES ASSIGNED
TO THIS WELL

40

18. DISTANCE FROM PROPOSED LOCATION*

TO NEAREST WELL, DRILLING, COMPLETED,
OR APPLIED FOR, ON THIS LEASE, FT.

19. PROPOSED DEPTH

5300 (NOTE)

20. ROTARY OR CABLE TOOLS

Rotary

21. ELEVATIONS (Show whether DF, RT, GR, etc.)

GR 6857

22. APPROX. DATE WORK WILL START*

10-7-71

23.

PROPOSED CASING AND CEMENTING PROGRAM

SIZE OF HOLE	SIZE OF CASING	WEIGHT PER FOOT	SETTING DEPTH	QUANTITY OF CEMENT
12 $\frac{1}{4}$	8 5/8	24 $\frac{1}{2}$	120	Circulate
7 7/8	4 1/2	9.5#	5100	125 sacks

Drill 12 $\frac{1}{4}$ hole to approximately 120'. Circulate cement. Drill 7 7/8" hole to bottom of Gallup at approximately 5300'. Set 4 $\frac{1}{2}$ " casing at approximately 5100' and cement with 125 sacks cement. Drill out cement, clean up formation and put in production. If Gallup completion is not attempted hole may be deepened to bottom of Dakota formation. 4 1/2" casing set with 125 sacks cement. Perforate & fracture formation.

Induction electrical log will be run, prior to time casing is set.

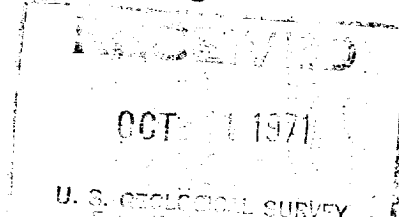

IN ABOVE SPACE DESCRIBE PROPOSED PROGRAM: If proposal is to deepen or plug back, give data on present productive zone and proposed new productive zone. If proposal is to drill or deepen directionally, give pertinent data on subsurface locations and measured and true vertical depths. Give blowout preventer program, if any.

24.

SIGNED

Harry R. B. [Signature]

TITLE

Vice President

DATE

9-29-71

(This space for Federal or State office use)

PERMIT NO.

APPROVAL DATE

APPROVED BY

[Signature]

TITLE

DATE

CONDITIONS OF APPROVAL, IF ANY:

**NEW MEXICO OIL CONSERVATION COMMISSION
WELL LOCATION AND ACERAGE DEDICATION PLAT**

All distances must be from the outer boundaries of the Section

Operator Bco, Inc.			Lease Federal F		Well No. 0-1
Unit Letter J	Section 8	Township 23 North	Range 8 West	County San Juan	
Actual Footage Location of Well:					
2080		feet from the	South	line and	1960
				feet from the	East
					line
Ground Level Elev. 6857	Producing Formation		Pool	Dedicated Acreage 40 Acres	

1. Outline the acreage dedicated to the subject well by colored pencil or hachure marks on the plat below.
2. If more than one lease is dedicated to the well, outline each and identify the ownership thereof (both as to working interest and royalty),
3. If more than one lease of different ownership is dedicated to the well, have the interests of all owners been consolidated by communitization, unitization, force-pooling, etc?

☐ Yes ☐ No If answer is "yes," type of consolidation

If answer is "no," list the owners and tract descriptions which have actually consolidated. (Use reverse side of this Form if necessary.)

No allowable will be assigned to the well until all interests have been consolidated (by communitization, unitization, forced-pooling, or otherwise) or until a non standard unit, eliminating such interests, has been approved by the Commission.

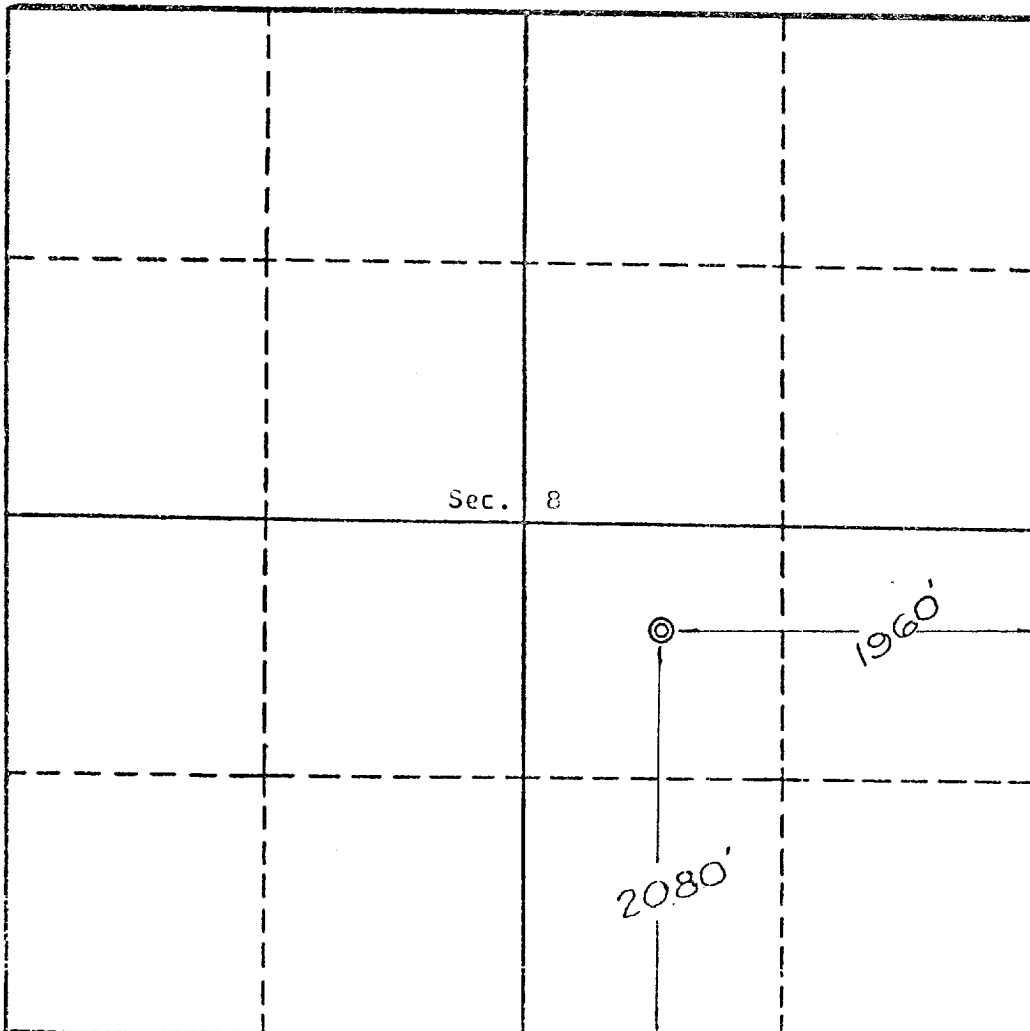

CERTIFICATION

I hereby certify that the information contained hereid is true and complete to the best of my knowledge and belief.

Name _____
Position _____
Company _____

Date _____

I hereby certify that the well location shown on this plat was plotted from field notes of actual surveys made by me or under my supervision, and that the same is true and correct to the best of my knowledge and belief.

Date Surveyed _____
September 16, 1971
Registered Professional Engineer
and/or Land Surveyor

E. V. Echohawk
Certificate No. **3602**
E. V. Echohawk L.S.

Scale, 1 inch = 1,000 feet.