

***See Instructions On Reverse Side**

U. S. GEOLOGICAL SURVEY
FARMINGTON, N. M.

All distances must be from the outer boundaries of the Section

San Juan

8. 1000

660

4565.0

THEIR CREATIONS

40

Circle the number in the table that best describes how often you use each service on the plan below.

Interest rate on the loan is 10% per annum, compounded annually. The well-wisher has received the loan and the borrower has received the cash. Therefore, both parties are working.

1. If a more than one person is involved in the crime, the FBI will interview all persons involved in the crime, including the victim, the perpetrator, and any witnesses. If a more than one person is involved in the crime, the FBI will interview all persons involved in the crime, including the victim, the perpetrator, and any witnesses.

Printed on Recycled Paper. When you buy this item, please help protect our environment. Use reverse side of this form if necessary.

to allow new firms to enter the market, all interest rate, "consolidated" by consolidation, unitization, forced-
 pooling, and other means, and, finally, eliminating such interest rate, has been approved by the Commission.

OIL CON. COM.
DIST. 3

I hereby certify that the information contained herein is true and complete to the best of my knowledge and belief.

Stelia Bercano

Name-

Geological Assistant

6. 10. 1990

Davis Oil Company

Citigroup

10-13-71

De: [REDACTED]

I hereby certify that the well location shown on this plat was plotted from field notes of actual surveys made by me or under my supervision, and that the same is true and correct to the best of my knowledge and belief.

18 June 1977

Professional Engineer
and/or Land Surveyor

JAMES F. LEASE

2463

Certificate No.

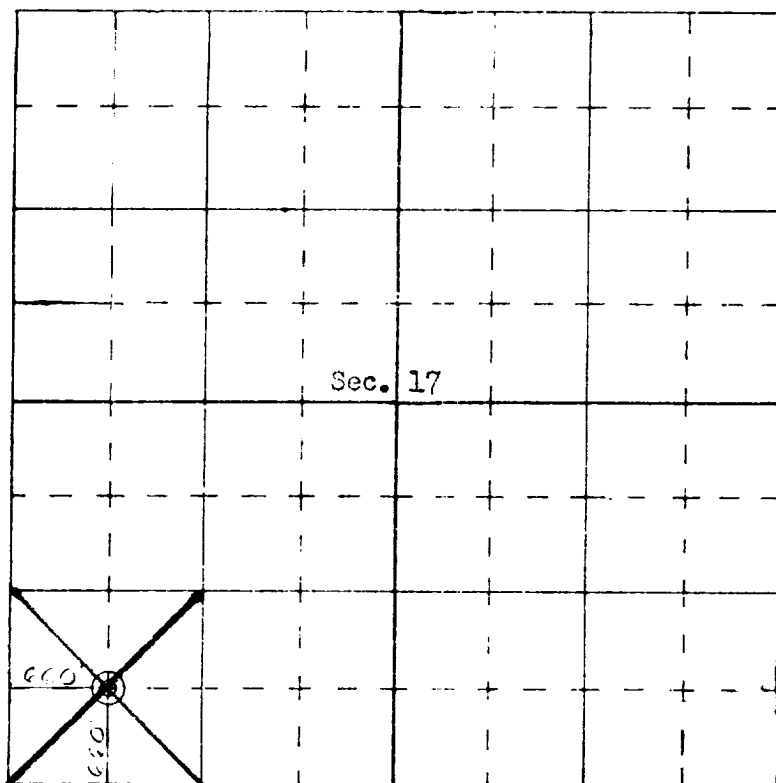

SCALE—4 INCHES EQUALS 1 MILE

SAN JUAN ENGINEERING COMPANY, FARMINGTON, N. M.