

NO. OF COPIES RECEIVED	5
DISTRIBUTION	
SANTA FE	1
FILE	1
U.S.G.S.	2
LAND OFFICE	
OPERATOR	1

NEW MEXICO OIL CONSERVATION COMMISSION

30-045-2253/
Form C-101
Revised 1-1-65

5A. Indicate Type of Lease	
STATE <input type="checkbox"/>	FEE <input checked="" type="checkbox"/>

5. State Oil & Gas Lease No.

APPLICATION FOR PERMIT TO DRILL, DEEPEN, OR PLUG BACK

1a. Type of Work		7. Unit Agreement Name	
b. Type of Well OIL WELL <input checked="" type="checkbox"/> GAS WELL <input type="checkbox"/> OTHER <input type="checkbox"/> DRILL <input checked="" type="checkbox"/> DEEPEN <input type="checkbox"/> PLUG BACK <input type="checkbox"/> SINGLE ZONE <input checked="" type="checkbox"/> MULTIPLE ZONE <input type="checkbox"/>		8. Farm or Lease Name Santa Fe 20	
2. Name of Operator Dome Petroleum Corporation		9. Well No. 2	
3. Address of Operator Minerals Management Inc., Suite 105, 501 Airport Drive, Farmington, New Mexico 87401		10. Field and Pool, or Wildcat Snake Eyes Entrada	
4. Location of Well UNIT LETTER F LOCATED 2150 FEET FROM THE North LINE AND 1980 FEET FROM THE West LINE OF SEC. 20 TWP. 21N RGE. 8W NMPM		12. County San Juan	
19. Proposed Depth 5850'		19A. Formation Entrada	
20. Rotary or C.T. Rotary		21. Elevations (Show whether DF, RT, etc.) 6568' GL	
21A. Kind & Status Plug. Bond Statewide		21B. Drilling Contractor Four Corners Drilling	
22. Approx. Date Work will start May 15, 1977			

PROPOSED CASING AND CEMENT PROGRAM

SIZE OF HOLE	SIZE OF CASING	WEIGHT PER FOOT	SETTING DEPTH	SACKS OF CEMENT	EST. TOP
12 1/4	9 5/8	23.75	200'	175	Circ.
8 3/4	7	23	5850'	500	

Operator proposes to drill Entrada test to 5850'. Completion to be determined from logs. A Series 900 (3000 spi) blowout preventer will be used during drilling operations below surface pipe.

NOTE: THIS IS A TIGHT HOLE.

CONFIDENTIAL

EXPIRES 7-27-77

IN ABOVE SPACE DESCRIBE PROPOSED PROGRAM: IF PROPOSAL IS TO DEEPEN OR PLUG BACK, GIVE DATA ON PRESENT PRODUCTIVE ZONE AND PROPOSED NEW PRODUCTIVE ZONE. GIVE BLOWOUT PREVENTER PROGRAM, IF ANY.

hereby certify that the information above is true and complete to the best of my knowledge and belief.

Signed [Signature] Title Area Manager Minerals Management Inc. Date April 26, 1977
(This space for State Use)

APPROVED BY [Signature] TITLE SUPERVISOR DIST. #3 DATE [Signature]
CONDITIONS OF APPROVAL, IF ANY:

**NEW MEXICO OIL CONSERVATION COMMISSION
WELL LOCATION AND ACREAGE DEDICATION PLAT**

Form C-102
Supersedes C-128
Effective 1-1-65

All distances must be from the outer boundaries of the Section.

Operator Dome Petroleum Corporation			Lease Santa Fe 20		Well No. 2
Unit Letter F	Section 20	Township 21N	Range 8W	County San Juan	
Actual Footage Location of Well:					
2150 feet from the North line and 1980 feet from the West line					
Ground Level Elev. 6568	Producing Formation Entrada	Pool Snake Eyes		Dedicated Acreage: 40 Acres	

1. Outline the acreage dedicated to the subject well by colored pencil or hachure marks on the plat below.
2. If more than one lease is dedicated to the well, outline each and identify the ownership thereof (both as to working interest and royalty).
3. If more than one lease of different ownership is dedicated to the well, have the interests of all owners been consolidated by communitization, unitization, force-pooling, etc?

☐ Yes ☐ No If answer is "yes," type of consolidation _____

If answer is "no," list the owners and tract descriptions which have actually been consolidated. (Use reverse side of this form if necessary.) _____

No allowable will be assigned to the well until all interests have been consolidated (by communitization, unitization, forced-pooling, or otherwise) or until a non-standard unit, eliminating such interests, has been approved by the Commission.

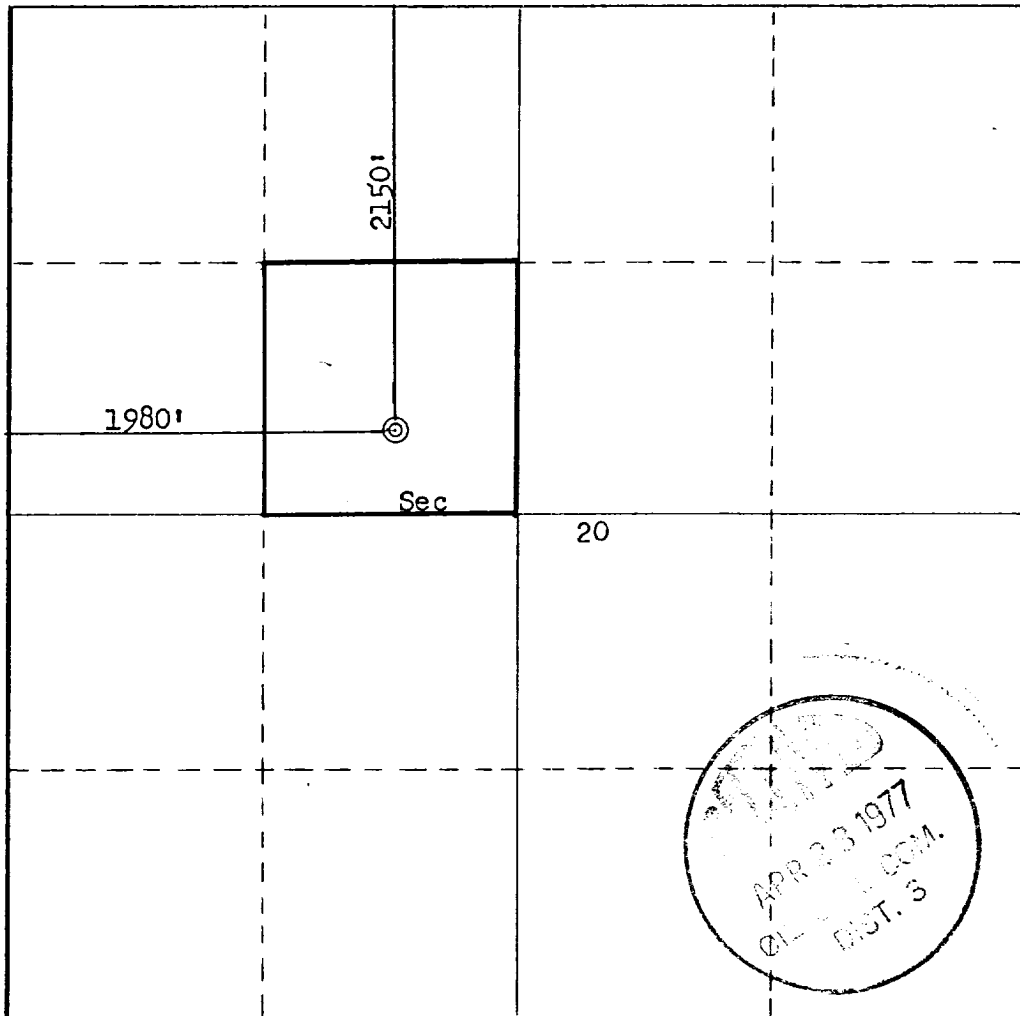

CERTIFICATION

I hereby certify that the information contained herein is true and complete to the best of my knowledge and belief.

Name *[Signature]*
Area Manager
 Position
Minerals Management Inc.
 Company
April 26, 1977
 Date

I hereby certify that the well location shown on this plat was plotted from field notes of actual surveys made by me or under my supervision, and that the same is true and correct to the best of my knowledge and belief.

Date Surveyed
March 25, 1977

Registered Professional Engineer
 and/or Land Surveyor

[Signature]
Fred B. Kerr Jr.

Certificate No.

3950

