

NO. OF COPIES RECEIVED	6
DISTRIBUTION	
SANTA FE	1
FILE	1
U.S.G.S.	2
LAND OFFICE	2
OPERATOR	2

NEW MEXICO OIL CONSERVATION COMMISSION

30-045-23027
Form C-101
Revised 1-1-65

5A. Indicate Type of Lease	
STATE <input type="checkbox"/>	FEE <input checked="" type="checkbox"/>
5. State Oil & Gas Lease No.	

APPLICATION FOR PERMIT TO DRILL, DEEPEN, OR PLUG BACK

1a. Type of Work		7. Unit Agreement Name	
b. Type of Well DRILL <input checked="" type="checkbox"/> DEEPEN <input type="checkbox"/> PLUG BACK <input type="checkbox"/> OIL WELL <input checked="" type="checkbox"/> GAS WELL <input type="checkbox"/> OTHER <input type="checkbox"/> SINGLE ZONE <input checked="" type="checkbox"/> MULTIPLE ZONE <input type="checkbox"/>		8. Firm or Lease Name Santa Fe Leggs	
2. Name of Operator Dome Petroleum Corp.		9. Well No. 2	
3. Address of Operator K & A, Inc. Minerals Management, 501 Airport Drive, Suite 105, Farmington, New Mexico 87401		10. Field and Pool, or Wildcat Leggs Entrada	
4. Location of Well UNIT LETTER <u>N</u> LOCATED <u>990</u> FEET FROM THE <u>South</u> LINE AND <u>2310</u> FEET FROM THE <u>West</u> LINE OF SEC. <u>11</u> TWP. <u>21N</u> RGE. <u>10W</u> NMMP		12. County San Juan	
19. Proposed Depth 5800'		19A. Formation Entrada	
20. Rotary or C.T. Rotary		21. Elevations (Show whether DF, RT, etc.)	
21A. Kind & Status Plug. Bond Statewide		21B. Drilling Contractor 4-Corners Drilling	
22. Approx. Date Work will start June 1, 1978			

PROPOSED CASING AND CEMENT PROGRAM

SIZE OF HOLE	SIZE OF CASING	WEIGHT PER FOOT	SETTING DEPTH	SACKS OF CEMENT	EST. TOP
13 1/4"	9 5/8"	3	200	200	Surface
8 3/4"	7	20 & 23	6500	1000 (2 stage)	Surface

Operator proposes to drill an Entrada test to the depth of 5800'. Completion will be determined from logs. A series 900 (3000 psi WP) blowout preventer will be used during drilling operations below surface pipe.

8-13-78

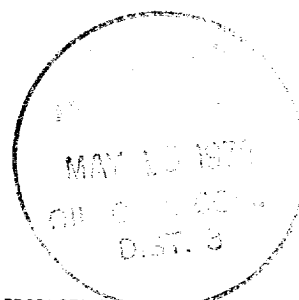

ABOVE SPACE DESCRIBE PROPOSED PROGRAM: IF PROPOSAL IS TO DEEPEN OR PLUG BACK, GIVE DATA ON PRESENT PRODUCTIVE ZONE AND PROPOSED NEW PRODUCTION ZONE. GIVE BLOWOUT PREVENTER PROGRAM, IF ANY.

I hereby certify that the information above is true and complete to the best of my knowledge and belief.
Signature: [Signature] Title: Area Manager Date: May 12, 1978

(This space for State Use)

PROVED BY: [Signature] TITLE: DEPUTY OIL & GAS INSPECTOR, DIST #3 DATE: MAY 15 1978
CONDITIONS OF APPROVAL, IF ANY:

**NEW MEXICO OIL CONSERVATION COMMISSION
WELL LOCATION AND ACREAGE DEDICATION PLAT**

Form C-102
Supersedes C-128
Effective 1-1-65

All distances must be from the outer boundaries of the Section.

Operator DOMO PETROLEUM CORPORATION			Lease Santa Fe-Leggs		Well No. 2
Unit Letter N	Section 11	Township 21N	Range 10W	County San Juan	
Actual Footage Location of Well: 990 feet from the South line and 2310 feet from the West line					
Ground Level Elev. 6379	Producing Formation Entrada		Pool Leggs Entrada		Dedicated Acreage: 40 Acres

1. Outline the acreage dedicated to the subject well by colored pencil or hachure marks on the plat below.
2. If more than one lease is dedicated to the well, outline each and identify the ownership thereof (both as to working interest and royalty).
3. If more than one lease of different ownership is dedicated to the well, have the interests of all owners been consolidated by communitization, unitization, force-pooling, etc?

☐ Yes ☐ No If answer is "yes," type of consolidation _____

If answer is "no," list the owners and tract descriptions which have actually been consolidated. (Use reverse side of this form if necessary.) _____

No allowable will be assigned to the well until all interests have been consolidated (by communitization, unitization, forced-pooling, or otherwise) or until a non-standard unit, eliminating such interests, has been approved by the Commission.

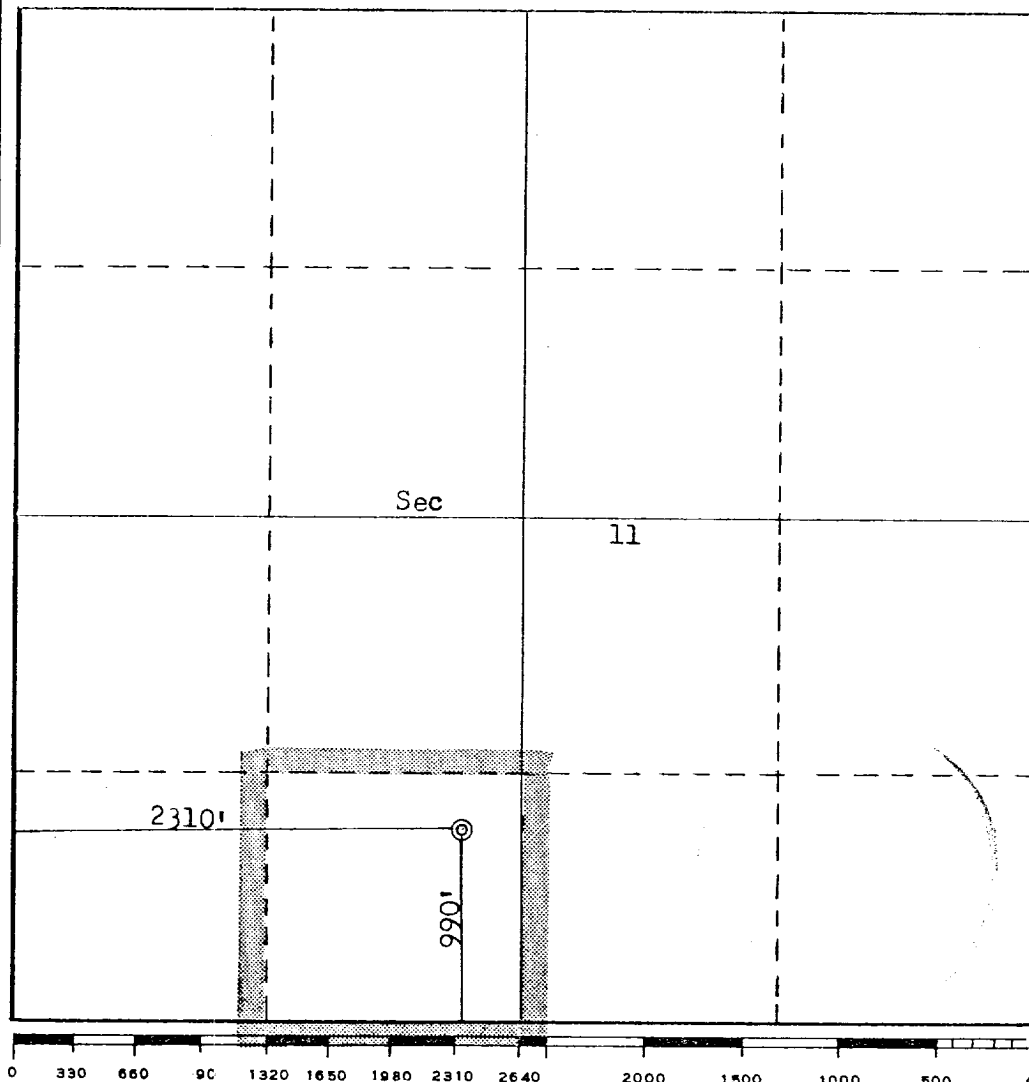

CERTIFICATION

I hereby certify that the information contained herein is true and complete to the best of my knowledge and belief.

[Signature]

Name
Area Manager
Position **K & A, Inc.**
Minerals Management
Company
May 12, 1978
Date

I hereby certify that the well location shown on this plat was plotted from field notes of actual surveys made by me or under my supervision, and that the same is true and correct to the best of my knowledge and belief.

Date Surveyed
May 10, 1978
Registered Professional Engineer and/or Land Surveyor
[Signature]
Fred B. Kerr Jr.
Certificate No. **3950**
NEW MEXICO
FRED B. KERR, JR.