

UNITED STATES  
DEPARTMENT OF THE INTERIOR  
GEOLOGICAL SURVEY

## APPLICATION FOR PERMIT TO DRILL, DEEPEN, OR PLUG BACK

## 1a. TYPE OF WORK

DRILL ☒DEEPEN ☐PLUG BACK ☐

## b. TYPE OF WELL

OIL  
WELL ☐GAS  
WELL ☒OTHER ☐SINGLE  
ZONE ☒MULTIPLE  
ZONE ☐

## 2. NAME OF OPERATOR

Kenai Oil &amp; Gas Inc.

## 3. ADDRESS OF OPERATOR

2000 Energy Center One-717-17th Street, Denver, Colorado 80202  
4. LOCATION OF WELL (Report location clearly and in accordance with any State requirements.)\*  
At surface

A 990' FNL &amp; 830' FEL

At proposed prod. zone

## 14. DISTANCE IN MILES AND DIRECTION FROM NEAREST TOWN OR POST OFFICE\*

Bloomfield, N.M. 40 miles

## 15. DISTANCE FROM PROPOSED\*

LOCATION TO NEAREST

PROPERTY OR LEASE LINE, FT.

(Also to nearest drlg. unit line, if any)

830'

## 18. DISTANCE FROM PROPOSED LOCATION\*

TO NEAREST WELL, DRILLING, COMPLETED,  
OR APPLIED FOR, ON THIS LEASE, FT.

---

## 21. ELEVATIONS (Show whether DF, RT, GR, etc.)

6931' G.L.

## 23.

## PROPOSED CASING AND CEMENTING PROGRAM

SIZE OF HOLE	SIZE OF CASING	WEIGHT PER FOOT	SETTING DEPTH	QUANTITY OF CEMENT
12 1/4	8 5/8	23#	550'	350 sx-Circulate to surface
7 7/8	4 1/2	10.5#	6500'	250 sx-50/50 Pozmix-10% Salt, 2% gel. Top of cement to be 5550 and 200 sx if same from 5300 to 4550.

Selectively test, perforate, and sandwater fracture the Dakota formation.

A 3000 psi WP and 6000 psi test double gate preventer equipped  
with blind and pipe rams will be used for blow out prevention.

The East 1/2 of Section 6 is dedicated to this well.

IN ABOVE SPACE DESCRIBE PROPOSED PROGRAM: If proposal is to deepen or plug back, give data on present productive zone and proposed new productive zone. If proposal is to drill or deepen directionally, give pertinent data on subsurface locations and measured and true vertical depths. Give blowout preventer program, if any.

## 24.

SIGNED

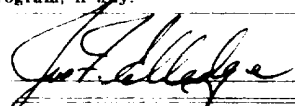

TITLE Agent

DATE 1-31-80

(This space for Federal or State office use)

PERMIT NO.

APPROVAL DATE

APPROVED BY

TITLE

CONDITIONS OF APPROVAL, IF ANY:

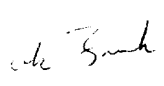

\*See Instructions On Reverse Side

NMOC

30-045-24213  
5. LEASE DESIGNATION AND SERIAL NO.  
41579-NM-11578  
6. IF INDIAN, ALLOTTEE OR TRIBE NAME

## 7. UNIT AGREEMENT NAME

## 8. FARM OR LEASE NAME

Federal-6

## 9. WELL NO.

41

## 10. FIELD AND POOL, OR WILDCAT

Basin Dakota (test)  
11. SEC., T., R., M., OR BLK.  
AND SURVEY OR AREA

A-6-23N-8W

## 12. COUNTY OR PARISH

## 13. STATE

San Juan

N.M.

17. NO. OF ACRES ASSIGNED  
TO THIS WELL

E 320 321-68

## 20. ROTARY OR CABLE TOOLS

Rotary

## 22. APPROX. DATE WORK WILL START\*

February 15, 1980

RECEIVED  
FEB 29 1980  
U. S. GEOLOGICAL SURVEY  
FARMINGTON, N. M.RECEIVED  
FEB 29 1980  
N. M. COM.  
3APPROVED  
AS AMENDED  
FEB 28 1980  
James F. Sims  
JAMES F. SIMS  
DISTRICT ENGINEER

## OIL CONSERVATION DIVISION

STATE OF NEW MEXICO  
ENERGY AND MINERALS DEPARTMENTP. O. BOX 2088  
SANTA FE, NEW MEXICO 87501Form C-102  
Revised 10-1-78

All distances must be from the outer boundaries of the Section

Operator <b>KENAI OIL &amp; GAS, INCORPORATED</b>			Lease <b>FEDERAL 6</b>		Well No. <b>41</b>
Unit Letter <b>A</b>	Section <b>6</b>	Township <b>23N</b>	Range <b>8W</b>	County <b>San Juan</b>	
Actual Footage Location of Well:					
<b>990</b>	feet from the	<b>North</b>	line and	<b>830</b>	feet from the
Ground Level Elev. <b>6931</b>	Producing Formation <b>Dakota (Test)</b>		Pool <b>Basin</b>	<b>Dakota (Test)</b>	Dedicated Acreage: <b>320 321.68 Acres</b>

1. Outline the acreage dedicated to the subject well by colored pencil or hatchure marks on the plat below.
2. If more than one lease is dedicated to the well, outline each and identify the ownership thereof (both as to working interest and royalty).
3. If more than one lease of different ownership is dedicated to the well, have the interests of all owners been consolidated by communitization, unitization, force-pooling, etc?

☐ Yes ☐ No If answer is "yes," type of consolidation \_\_\_\_\_

If answer is "no," list the owners and tract descriptions which have actually been consolidated. (Use reverse side of this form if necessary.) \_\_\_\_\_

No allowable will be assigned to the well until all interests have been consolidated (by communitization, unitization, forced-pooling, or otherwise) or until a non-standard unit, eliminating such interests, has been approved by the Commission.

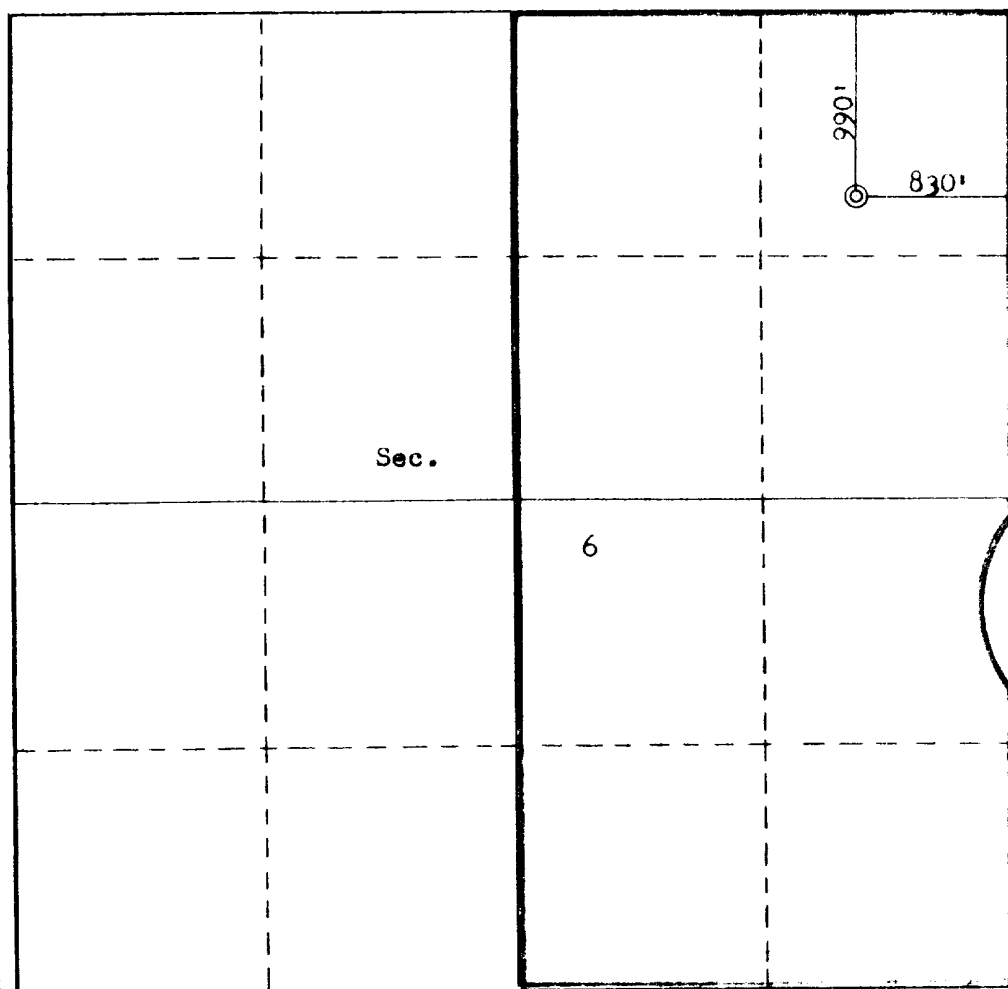

## CERTIFICATION

I hereby certify that the information contained herein is true and complete to the best of my knowledge and belief.

Name *Joe F. Elledge*  
Position *Agent*  
Company *Kenai Oil & Gas Inc.*  
Date *January 31, 1980*

I hereby certify that the well location shown on this plat was plotted from field notes of actual surveys made by me or by my division, and that the same is correct to the best of my knowledge and belief.

Date Surveyed *January 25, 1980*  
Registered Professional Engineer and/or Land Surveyor  
*Fred B. Kennerly*  
Certificate No. *3950*

0 330 660 990 1320 1650 1980 2310 2640 2000 1500 1000 500 0

THIS  
FOR SALE BY U.S. GEOLO  
A FOLDER DESCR

Vicinity Map for  
KENAI OIL & GAS, INCORPORATED #41 FEDERAL 6  
990'FNL 830'FEL Sec 6-T23N-R8W  
SAN JUAN COUNTY, NEW MEXICO