

X			

(SUBMIT IN TRIPLICATE)

UNITED STATES
DEPARTMENT OF THE INTERIOR
GEOLOGICAL SURVEYIndian Agency Jicarilla Apache
Alottee _____
Lease No. 36

Sec. 22

SUNDRY NOTICES AND REPORTS ON WELLS

NOTICE OF INTENTION TO DRILL	X	SUBSEQUENT REPORT OF WATER SHUT-OFF
NOTICE OF INTENTION TO CHANGE PLANS		SUBSEQUENT REPORT OF SHOOTING OR ACIDIZING
NOTICE OF INTENTION TO TEST WATER SHUT-OFF		SUBSEQUENT REPORT OF ALTERING CASING
NOTICE OF INTENTION TO REDRILL OR REPAIR WELL		SUBSEQUENT REPORT OF REDRILLING OR REPAIR
NOTICE OF INTENTION TO SHOOT OR ACIDIZE		SUBSEQUENT REPORT OF ABANDONMENT
NOTICE OF INTENTION TO PULL OR ALTER CASING		SUPPLEMENTARY WELL HISTORY
NOTICE OF INTENTION TO ABANDON WELL		

(INDICATE ABOVE BY CHECK MARK NATURE OF REPORT, NOTICE, OR OTHER DATA)

May 15, 1962

N. E. Haynes
Well No. 5 is located 1606 ft. from N line and 928 ft. from E line of sec. 22
NW/4 Sec. 22 T24N R5W NMPM
(1/4 Sec. and Sec. No.) (Twp.) (Range) (Meridian)
Basin Dakota Rio Arriba County New Mexico
(Field) (County or Subdivision) (State or Territory)

The elevation of the derrick floor above sea level is 6706 ft.

DETAILS OF WORK

(State names of and expected depths to objective sands; show sizes, weights, and lengths of proposed casings; indicate mudding jobs, cementing points, and all other important proposed work)

We propose to drill this well with rotary tools to an estimated depth of 6850' to test the Dakota formation. Approximately 300' of 8 5/8" surface casing will be run & cemented to surface. If commercial production is encountered, the well will be completed following running 5 1/2" production casing and cementing as follows: the Dakota & Gallup formation will be cemented through the casing shoe and the Mesa Verde & Pictured Cliffs formations will be cemented through a stage collar at approximately 4700'.

I understand that this plan of work must receive approval in writing by the Geological Survey before operations may be commenced.

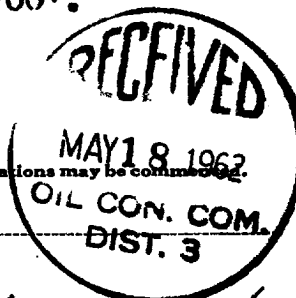
Company Continental Oil CompanyAddress Box 3312Durango, ColoradoBy H. D. Haley
Title District Superintendent

NUMBER OF COPIES RECEIVED	
DISTRIBUTION	
SANTA FE	
FILE	
U.S.G.S.	
LAND OFFICE	
TRANSPORTER	OIL / GAS
PROBATION OFFICE	
OPERATOR	

NEW MEXICO OIL CONSERVATION COMMISSION
WELL LOCATION AND ACREAGE DEDICATION PLAT
 SEE INSTRUCTIONS FOR COMPLETING THIS FORM ON THE REVERSE SIDE

FORM C-128
 Revised 5/1/57

SECTION A

Operator Continental Oil Company		Lease N. E. Haynes Apache		Well No. 5
Unit Letter E	Section 22	Township 24N	Range 5W	County Rio Arriba
Actual Footage Location of Well: 1606 feet from the North line and 928 feet from the West line				
Ground Level Elev. 6692	Producing Formation Dakota	Pool Basin Dakota	Dedicated Acreage: 320 Acres	

1. Is the Operator the only owner in the dedicated acreage outlined on the plat below? YES ☒ NO _____. ("Owner" means the person who has the right to drill into and to produce from any pool and to appropriate the production either for himself or for himself and another. (65-3-29 (e) NMSA 1935 Comp.))
2. If the answer to question one is "no," have the interests of all the owners been consolidated by communitization agreement or otherwise? YES ____ NO _____. If answer is "yes," Type of Consolidation _____
3. If the answer to question two is "no," list all the owners and their respective interests below:

Owner	Land Description

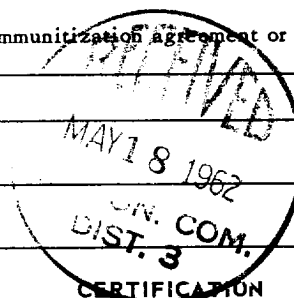

SECTION B

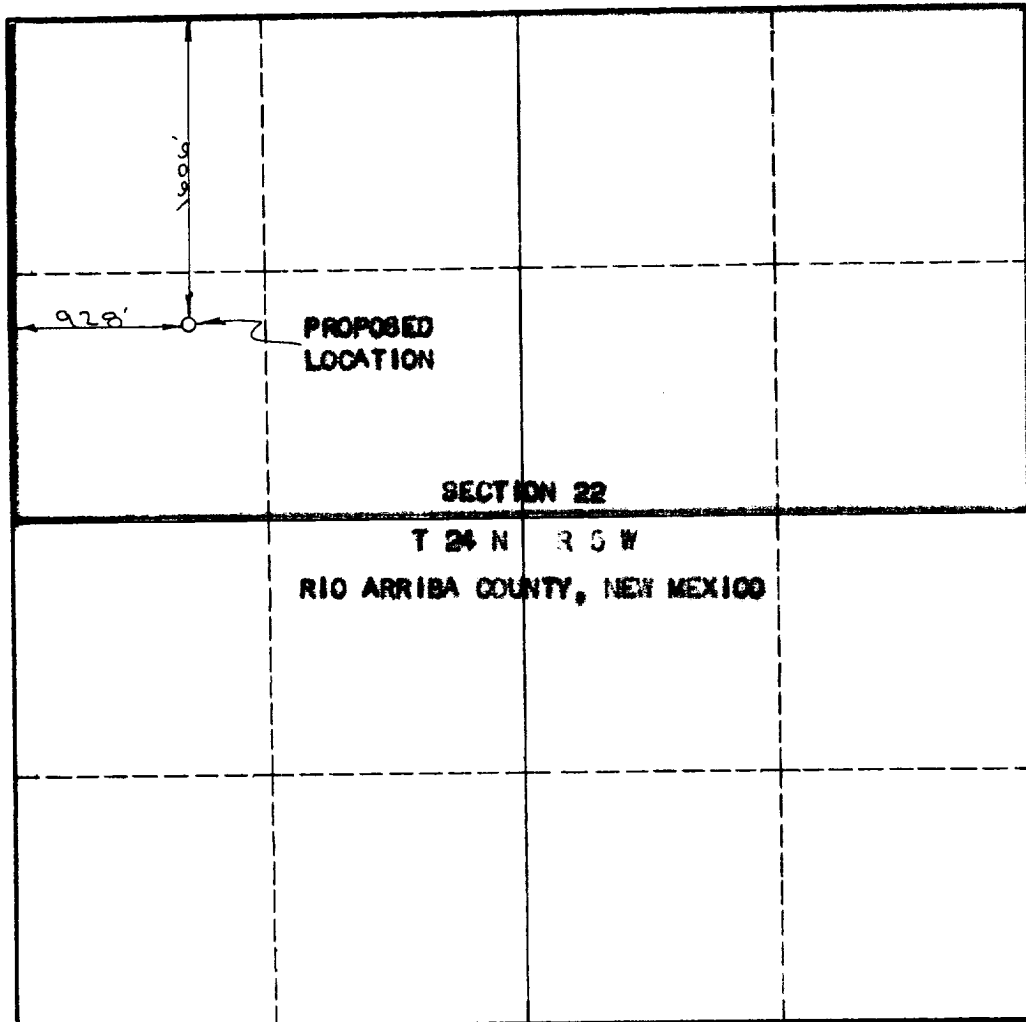

I hereby certify that the information in SECTION A above is true and complete to the best of my knowledge and belief.

Name and Signed By <i>[Signature]</i>
Position District Superintendent
Company Continental Oil Company
Date 5-15-62

I hereby certify that the well location shown on the plat in SECTION B was plotted from field notes of actual surveys made by me or under my supervision, and that the same is true and correct to the best of my knowledge and belief.

Date Surveyed MAY 11, 1962
Registered Professional Engineer and/or Land Surveyor <i>[Signature]</i>

Certificate No.
#3180

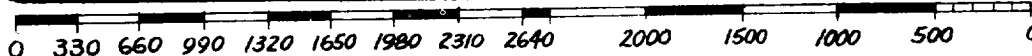

INSTRUCTIONS FOR COMPLETION OF FORM C-128

1. Operator shall furnish and certify to the information called for in Section A.
2. Operator shall outline the dedicated acreage for *both* oil and gas wells on the plat in Section B.
3. A registered professional engineer or land surveyor registered in the State of New Mexico or approved by the Commission shall show on the plat the location of the well and certify this information in the space provided.
4. All distances shown on the plat must be from the outer boundaries of the Section.
5. If additional space is needed for listing owners and their respective interests as required in question 3 of Section A, please use space below.