

NEW MEXICO OIL CONSERVATION COMMISSION
Santa Fe, New Mexico

Form C-101
Revised (12/1/55)

NOTICE OF INTENTION TO DRILL

Notice must be given to the District Office of the Oil Conservation Commission and approval obtained before drilling or recompletion begins. If changes in the proposed plan are considered advisable, a copy of this notice showing such changes will be returned to the sender. Submit this notice in QUINTUPPLICATE. One copy will be returned following approval. See additional instructions in Rules and Regulations of the Commission. If State Land submit 6 Copies Attach Form C-128 in triplicate to first 3 copies of form C-101

FARMINGTON, NEW MEXICO
(Place)

MARCH 19 1959
(Date)

OIL CONSERVATION COMMISSION
SANTA FE, NEW MEXICO

Gentlemen:

You are hereby notified that it is our intention to commence the Drilling of a well to be known as

CENTRAL PRODUCTION CO. P.O. BOX 3097 STA. A. EL PASO TEXAS
(Company or Operator)

(Lease), Well No. STATE CP # 2, in (Unit) The well is

located 1490 feet from the 1750 SOUTH line and 1750 feet from the WEST line of Section 36, T. 24 N., R. 6 W., NMPM.

(GIVE LOCATION FROM SECTION LINE) Clear Pool, RIO ARRIBA County

If State Land the Oil and Gas Lease is No.

If patented land the owner is.

Address.

We propose to drill well with drilling equipment as follows: ROTARY TOOLS

The status of plugging bond is ON FILE IN SANTA FE.

Drilling Contractor EMPIRE STATES DRILLING CORPORATION

P.O. BOX 891 FARMINGTON, NEW MEXICO

We intend to complete this well in the PICTURED CLIFFS formation at an approximate depth of 2300 feet.

CASING PROGRAM

We propose to use the following strings of Casing and to cement them as indicated:

Size of Hole	Size of Casing	Weight per Foot	New or Second Hand	Depth	Sacks Cement
12 1/4	8 5/8	24	new	100	100 reg.
7 7/8	5 1/2	14	new	2300	150 reg.

If changes in the above plans become advisable we will notify you immediately.

ADDITIONAL INFORMATION (If recompletion give full details of proposed plan of work.)

Approved: MAR 23 1959, 19.
Except as follows:

OIL CONSERVATION COMMISSION

By: [Signature]

Sincerely yours,

CENTRAL PRODUCTION CO.
(Company or Operator)

By: [Signature]

Position: AGENT
Send Communications regarding well to

Name: CENTRAL PRODUCTION CO.

Address: P.O. BOX 3097 STA. A. EL PASO TEXAS

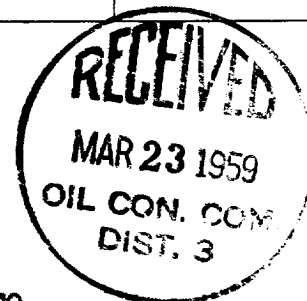

NEW MEXICO OIL CONSERVATION COMMISSION

Well Location and Acreage Dedication Plat

Section A.

Date MARCH 19 1959

Operator CENTRAL PRODUCTION COMPANY Lease ST. HITE
Well No. CP 2 Unit Letter K Section 36 Township 24 North Range 6 West NMPM
Located 1490 Feet From South Line, 1750 Feet From West Line
County Rio Arriba G. L. Elevation 6687 Dedicated Acreage 160 Acres
Name of Producing Formation PICTURED CLIFFS Pool UNDESIGNATED

1. Is the Operator the only owner* in the dedicated acreage outlined on the plat below?
Yes X No .
2. If the answer to question one is "no," have the interests of all the owners been consolidated by communitization agreement or otherwise? Yes No . If answer is "yes,"
Type of Consolidation
3. If the answer to question two is "no," list all the owners and their respective interests below:

Owner

Land Description

Section. B

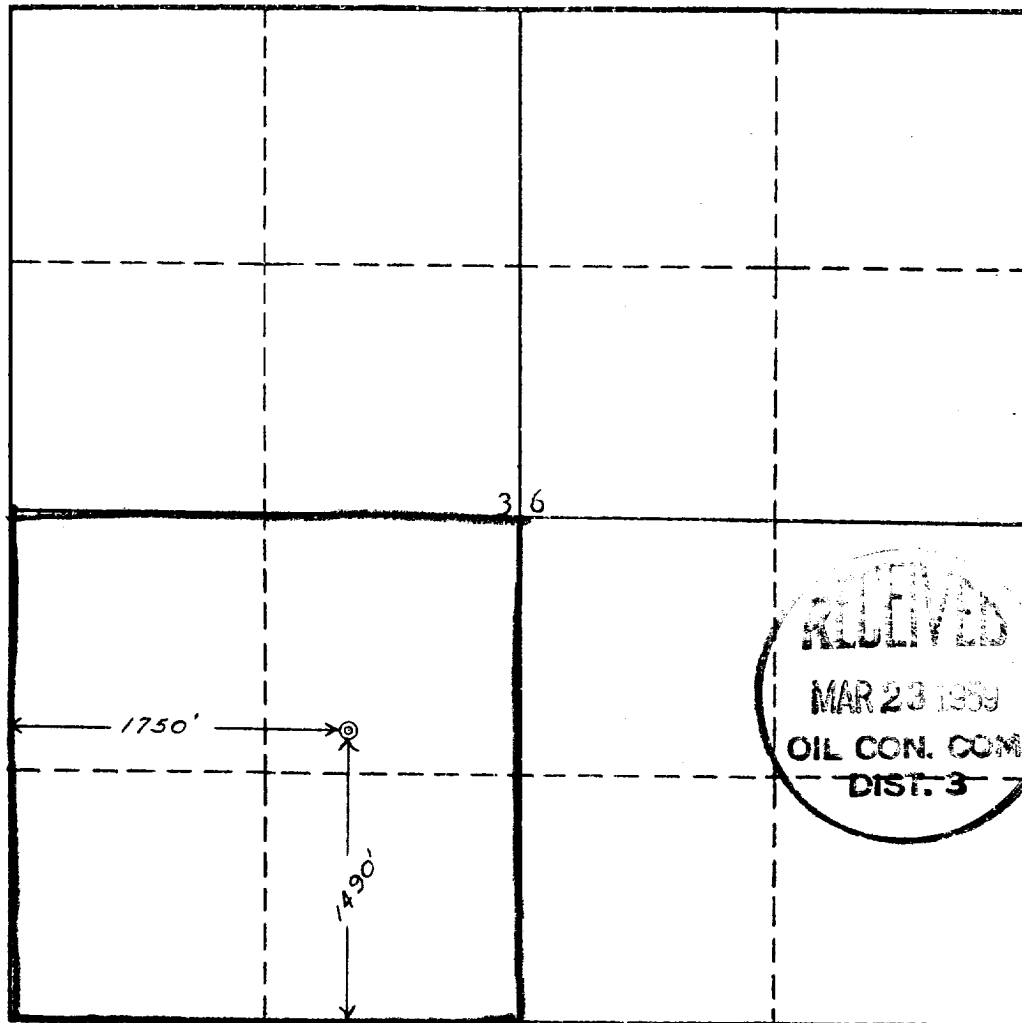

This is to certify that the information in Section A above is true and complete to the best of my knowledge and belief.

GENERAL PRODUCTION CO

(Operator)

U. E. Williams
(Representative)

P.O. BOX 891 FARMINGTON, N.M.
Address

This is to certify that the well location shown on the plat in Section B was plotted from field notes of actual surveys made by me or under my supervision and that the same is true and correct to the best of my knowledge and belief.

Date Surveyed March 13, 1959

Ernest V. Echoshawk
Ernest V. Echoshawk
Registered Land Surveyor.

Certificate No. 1545

OIL CONSERVATION COMMISSION		
AZTEC DISTRICT OFFICE		
No. Copies Received <u>6</u>		
DISTRIBUTION		
	NO. FURNISHED	
Operator	<u>1</u>	
Santa Fe	<u>1</u>	
Proration Office		
State Land Office	<u>1</u>	
U. S. G. S.	<u>2</u>	
Transporter		
File	<u>1</u>	<input checked="" type="checkbox"/>