

(SUBMIT IN TRIPLICATE)

UNITED STATES  
DEPARTMENT OF THE INTERIOR  
GEOLOGICAL SURVEY

Land Office **Santa Fe**  
Lease No. **NM 0101694**  
Unit \_\_\_\_\_

SUNDRY NOTICES AND REPORTS ON WELLS

NOTICE OF INTENTION TO DRILL.....	<input checked="" type="checkbox"/>	SUBSEQUENT REPORT OF WATER SHUT-OFF.....	
NOTICE OF INTENTION TO CHANGE PLANS.....		SUBSEQUENT REPORT OF SHOOTING OR ACIDIZING.....	
NOTICE OF INTENTION TO TEST WATER SHUT-OFF.....		SUBSEQUENT REPORT OF ALTERING CASING.....	
NOTICE OF INTENTION TO RE-DRILL OR REPAIR WELL.....		SUBSEQUENT REPORT OF RE-DRILLING OR REPAIR.....	
NOTICE OF INTENTION TO SHOOT OR ACIDIZE.....		SUBSEQUENT REPORT OF ABANDONMENT.....	
NOTICE OF INTENTION TO PULL OR ALTER CASING.....		SUPPLEMENTARY WELL HISTORY.....	
NOTICE OF INTENTION TO ABANDON WELL.....			

(INDICATE ABOVE BY CHECK MARK NATURE OF REPORT, NOTICE, OR OTHER DATA)

December 7, 1961

**Malik-Federal**  
Well No. **3** is located **790** ft. from **(N)** line and **1850** ft. from **(W)** line of sec. **36**  
**NM/4 - 36** **24 North 2 West** **NMNM**  
(1/4 Sec. and Sec. No.) (Twp.) (Range) (Meridian)  
**Undesignated** **Rio Arriba** **New Mexico**  
(Field) (County or Subdivision) (State or Territory)

The elevation of the ~~shrink~~ **ground** floor above sea level is **7465** ft.

DETAILS OF WORK

(State names of and expected depths to objective sands; show sizes, weights, and lengths of proposed casings; indicate mudding jobs, cementing points, and all other important proposed work)

To set approx. 100 feet of 8 5/8 inch surface casing and cement with approx. 50 sacks. To drill with rotary tools to an approx. total depth of 3400 feet. To run an electric log and if productive to set approx. 3400 feet of 4 1/2 inch new casing and cement with approx. 100 sacks. To perforate the Pictured Cliffs pay zone and sand-water frac same. To run approx. 3350 feet of 1 1/4 inch EUE tubing and to complete and produce as a Pictured Cliffs gas producer. To comply with the rules and regulations of the U.S.G.S. and New Mexico Oil and Gas Commission.

I understand that this plan of work must receive approval in writing by the Geological Survey before operations are commenced.

Company **SHAR-ALAN OIL COMPANY**  
Address **1402 Denver U. S. National Center**  
**Denver 2, Colorado**

Send approval to:  
By **Richard S. Hunt**  
Title **Mgr., Lands and Exploration**  
**Box 1428, Durango, Colorado**

NUMBER OF COPIES RECEIVED	
DISTRIBUTION	
SANTA FE	
FILE	
U.S.G.S.	
LAND OFFICE	
TRANSPORTER	OIL GAS
PRODUCTION OFFICE	
OPERATOR	

**NEW MEXICO OIL CONSERVATION COMMISSION**  
**WELL LOCATION AND ACREAGE DEDICATION PLAT**  
 SEE INSTRUCTIONS FOR COMPLETING THIS FORM ON THE REVERSE SIDE

FORM C-128  
Revised 5/1/57

**SECTION A**

Operator <b>Irving Pasternak</b> <b>DBA Shar-Alan Oil Company</b>		Lease <b>NM 0101694</b>		Well No. <b>#3 Melik-Federal</b>	
Unit Letter <b>C</b>	Section <b>36</b>	Township <b>24 North</b>	Range <b>2 West</b>	County <b>Rio Arriba</b>	
Actual Footage Location of Well: <b>790</b> feet from the <b>North</b> line and <b>1850</b> feet from the <b>West</b> line					
Ground Level Elev. <b>7465 ungraded</b>	Producing Formation <b>Picture Cliff</b>	Pool <b>undesignated</b>		Dedicated Acreage: <b>160</b> Acres	

1. Is the Operator the only owner in the dedicated acreage outlined on the plat below? YES ☒ NO \_\_\_\_ . ("Owner" means the person who has the right to drill into and to produce from any pool and to appropriate the production either for himself or for himself and another. (65-3-29 (e) NMSA 1935 Comp.)
2. If the answer to question one is "no," have the interests of all the owners been consolidated by communitization agreement or otherwise? YES \_\_\_\_ NO \_\_\_\_ . If answer is "yes," Type of Consolidation \_\_\_\_\_
3. If the answer to question two is "no," list all the owners and their respective interests below:

Owner <b>Irving Pasternak, DBA Shar-Alan Oil Company</b>	Land Description <b>NW Section 36, T24N, R2W, N.M.P.M.</b>
---	---

**SECTION B**

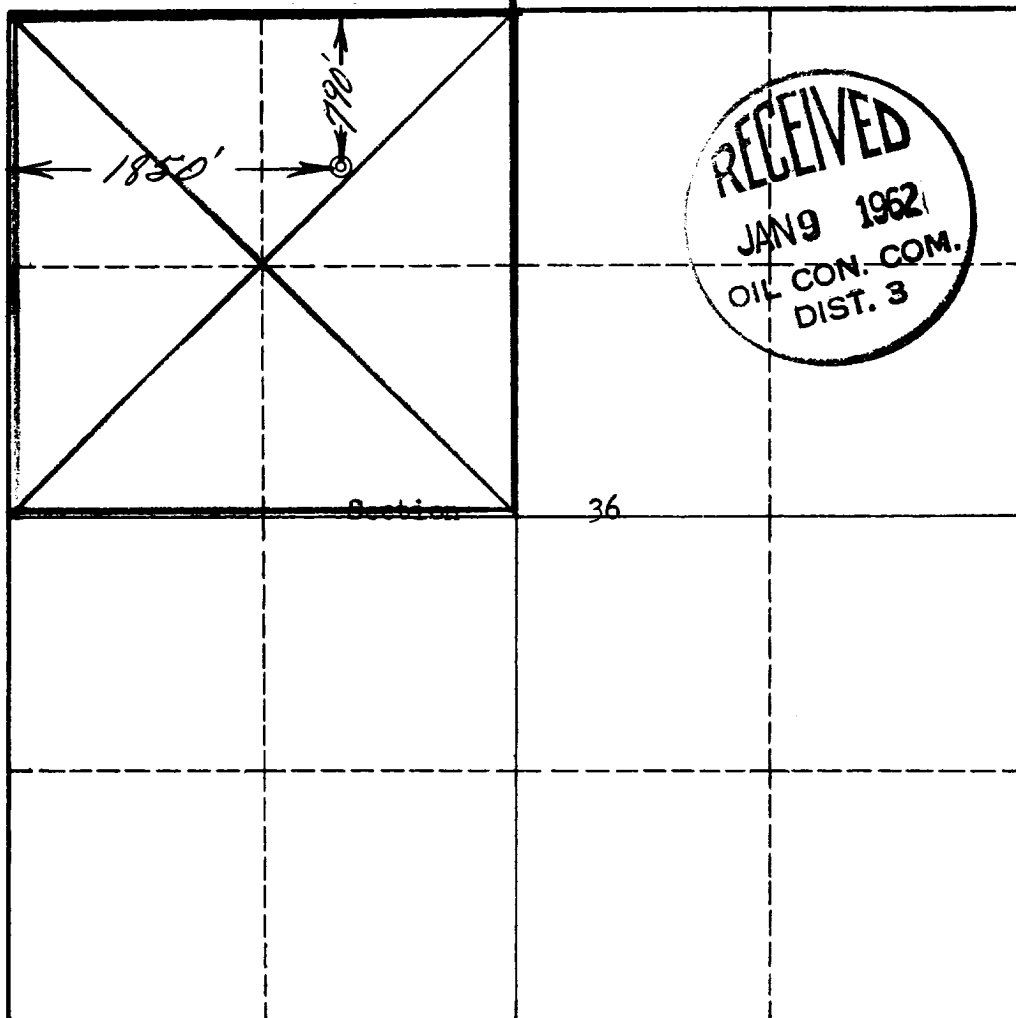

**CERTIFICATION**

I hereby certify that the information in SECTION A above is true and complete to the best of my knowledge and belief.

Name  
**Richard S. Hunt**  
 Position **Manager of Lands & Exploration**  
 Company **Irving Pasternak DBA Shar-Alan Oil Company**  
 Date  
**27 December 1961**

I hereby certify that the well location shown on the plat in SECTION B was plotted from field notes of actual surveys made by me or under my supervision, and that the same is true and correct to the best of my knowledge and belief.

Date Surveyed  
**22 December 1961**  
 Registered Professional Engineer and/or Land Surveyor  
**Robert H. Fennell**  
**San Juan Engineering Co.**  
 Certificate No.  
**PE & LS 2463**

0 330 660 990 1320 1650 1980 2310 2640 2000 1500 1000 500 0

## INSTRUCTIONS FOR COMPLETION OF FORM C-128

1. Operator shall furnish and certify to the information called for in Section A.
2. Operator shall outline the dedicated acreage for *both* oil and gas wells on the plat in Section B.
3. A registered professional engineer or land surveyor registered in the State of New Mexico or approved by the Commission shall show on the plat the location of the well and certify this information in the space provided.
4. All distances shown on the plat must be from the outer boundaries of the Section.
5. If additional space is needed for listing owners and their respective interests as required in question 3 of Section A, please use space below.