

July 24, 1961

Mr. A. L. Porter  
New Mexico Oil Conservation Commission  
P. O. Box 871  
Santa Fe, New Mexico

Dear Mr. Porter:

As provided for in Order No. R-179-3, Rule 4B, covering the Escrito-Gallup field, Val R. Reese & Associates, Inc. request administrative approval to drill their #5-30 Goff well on an unorthodox location. The #5-30 Goff well will be a Gallup completion, located 2440 feet from the North line, and 330 feet from the West line of Section 30, Township 24 North, Range 6 West, Escrito-Gallup Field, Rio Arriba County, New Mexico.

The unorthodox location is requested because of the extreme topographic conditions in the area north and east of the proposed location. Val R. Reese & Associates, Inc. are offset operators of all of the acreage surrounding this well.

Very truly yours,

Original Signed by  
MORRIS B. JONES

Morris B. Jones

MBJ:mm

cc: ✓ Mr. Emery Arnold  
U.S.G.S.  
E. B. Germany  
California Oil Company

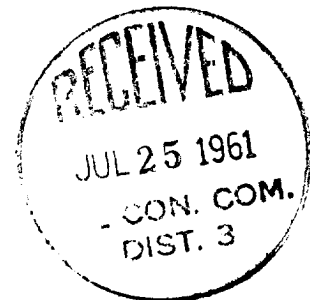

7-2

The Washington location is reported because of the extreme topographic conditions in the area north and east of the proposed location. The S. Jones & Associates, Inc. are offered operation of all of the acreage surrounding this site.

1998, 1999, 2000, 2001, 2002, 2003, 2004, 2005, 2006, 2007, 2008, 2009, 2010, 2011, 2012, 2013, 2014, 2015, 2016, 2017, 2018, 2019, 2020, 2021, 2022, 2023, 2024, 2025, 2026, 2027, 2028, 2029, 2030, 2031, 2032, 2033, 2034, 2035, 2036, 2037, 2038, 2039, 2040, 2041, 2042, 2043, 2044, 2045, 2046, 2047, 2048, 2049, 2050, 2051, 2052, 2053, 2054, 2055, 2056, 2057, 2058, 2059, 2060, 2061, 2062, 2063, 2064, 2065, 2066, 2067, 2068, 2069, 2070, 2071, 2072, 2073, 2074, 2075, 2076, 2077, 2078, 2079, 2080, 2081, 2082, 2083, 2084, 2085, 2086, 2087, 2088, 2089, 2090, 2091, 2092, 2093, 2094, 2095, 2096, 2097, 2098, 2099, 2100, 2101, 2102, 2103, 2104, 2105, 2106, 2107, 2108, 2109, 2110, 2111, 2112, 2113, 2114, 2115, 2116, 2117, 2118, 2119, 2120, 2121, 2122, 2123, 2124, 2125, 2126, 2127, 2128, 2129, 2130, 2131, 2132, 2133, 2134, 2135, 2136, 2137, 2138, 2139, 2140, 2141, 2142, 2143, 2144, 2145, 2146, 2147, 2148, 2149, 2150, 2151, 2152, 2153, 2154, 2155, 2156, 2157, 2158, 2159, 2160, 2161, 2162, 2163, 2164, 2165, 2166, 2167, 2168, 2169, 2170, 2171, 2172, 2173, 2174, 2175, 2176, 2177, 2178, 2179, 2180, 2181, 2182, 2183, 2184, 2185, 2186, 2187, 2188, 2189, 2190, 2191, 2192, 2193, 2194, 2195, 2196, 2197, 2198, 2199, 2200, 2201, 2202, 2203, 2204, 2205, 2206, 2207, 2208, 2209, 2210, 2211, 2212, 2213, 2214, 2215, 2216, 2217, 2218, 2219, 2220, 2221, 2222, 2223, 2224, 2225, 2226, 2227, 2228, 2229, 2230, 2231, 2232, 2233, 2234, 2235, 2236, 2237, 2238, 2239, 2240, 2241, 2242, 2243, 2244, 2245, 2246, 2247, 2248, 2249, 2250, 2251, 2252, 2253, 2254, 2255, 2256, 2257, 2258, 2259, 2260, 2261, 2262, 2263, 2264, 2265, 2266, 2267, 2268, 2269, 2270, 2271, 2272, 2273, 2274, 2275, 2276, 2277, 2278, 2279, 2280, 2281, 2282, 2283, 2284, 2285, 2286, 2287, 2288, 2289, 2290, 2291, 2292, 2293, 2294, 2295, 2296, 2297, 2298, 2299, 2300, 2301, 2302, 2303, 2304, 2305, 2306, 2307, 2308, 2309, 2310, 2311, 2312, 2313, 2314, 2315, 2316, 2317, 2318, 2319, 2320, 2321, 2322, 2323, 2324, 2325, 2326, 2327, 2328, 2329, 2330, 2331, 2332, 2333, 2334, 2335, 2336, 2337, 2338, 2339, 2340, 2341, 2342, 2343, 2344, 2345, 2346, 2347, 2348, 2349, 2350, 2351, 2352, 2353, 2354, 2355, 2356, 2357, 2358, 2359, 2360, 2361, 2362, 2363, 2364, 2365, 2366, 2367, 2368, 2369, 2370, 2371, 2372, 2373, 2374, 2375, 2376, 2377, 2378, 2379, 2380, 2381, 2382, 2383, 2384, 2385, 2386, 2387, 2388, 2389, 2390, 2391, 2392, 2393, 2394, 2395, 2396, 2397, 2398, 2399, 2400, 2401, 2402, 2403, 2404, 2405, 2406, 2407, 2408, 2409, 2410, 2411, 2412, 2413, 2414, 2415, 2416, 2417, 2418, 2419, 2420, 2421, 2422, 2423, 2424, 2425, 2426, 2427, 2428, 2429, 2430, 2431, 2432, 2433, 2434, 2435, 2436, 2437, 2438, 2439, 2440, 2441, 2442, 2443, 2444, 2445, 2446, 2447, 2448, 2449, 2450, 2451, 2452, 2453, 2454, 2455, 2456, 2457, 2458, 2459, 2460, 2461, 2462, 2463, 2464, 2465, 2466, 2467, 2468, 2469, 2470, 2471, 2472, 2473, 2474, 2475, 2476, 2477, 2478, 2479, 2480, 2481, 2482, 2483, 2484, 2485, 2486, 2487, 2488, 2489, 2490, 2491, 2492, 2493, 2494, 2495, 2496, 2497, 2498, 2499, 2500, 2501, 2502, 2503, 2504, 2505, 2506, 2507, 2508, 2509, 2510, 2511, 2512, 2513, 2514, 2515, 2516, 2517, 2518, 2519, 2520, 2521, 2522, 2523, 2524, 2525, 2526, 2527, 2528, 2529, 2530, 2531, 2532, 2533, 2534, 2535, 2536, 2537, 2538, 2539, 2540, 2541, 2542, 2543, 2544, 2545, 2546, 2547, 2548, 2549, 2550, 2551, 2552, 2553, 2554, 2555, 2556, 2557, 2558, 2559, 2560, 2561, 2562, 2563, 2564, 2565, 2566, 2567, 2568, 2569, 2570, 2571, 2572, 2573, 2574, 2575, 2576, 2577, 2578, 2579, 2580, 2581, 2582, 2583, 2584, 2585, 2586, 2587, 2588, 2589, 2590, 2591, 2592, 2593, 2594, 2595, 2596, 2597, 2598, 2599, 2600, 2601, 2602, 2603, 2604, 2605, 2606, 2607, 2608, 2609, 2610, 2611, 2612, 2613, 2614, 2615, 2616, 2617, 2618, 2619, 2620, 2621, 2622, 2623, 2624, 2625, 2626, 2627, 2628, 2629, 2630, 2631, 2632, 2633, 2634, 2635, 2636, 2637, 2638, 2639, 2640, 2641, 2642, 2643, 2644, 2645, 2646, 2647, 2648, 2649, 2650, 2651, 2652, 2653, 2654, 2655, 2656, 2657, 2658, 2659, 2660, 2661, 2662, 2663, 2664, 2665, 2666, 2667, 2668, 2669, 2670, 2671, 2672, 2673, 2674, 2675, 2676, 2677, 2678, 2679, 26

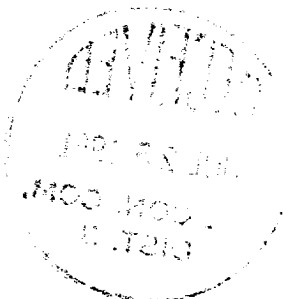
[illegible]

# NEW MEXICO OIL CONSERVATION COMMISSION

## Well Location and Acreage Dedication Plat

### SECTION A.

Date **July 24, 1961**

Operator **Val R. Reese and Associates** Lease **Goff**  
Well No. **5-30** Unit Letter **E** Section **30** Township **24 North** Range **6 West** NMPM  
Located **2460** Feet From **North** Line, **330** Feet From **West** Line  
County **Rio Arriba** G. L. Elevation **6932** Dedicated Acreage **80.00** Acres  
Name of Producing Formation **Gallup** Pool **Escrito-Gallup**

- Is the Operator the only owner\* in the dedicated acreage outlined on the plat below? Yes ☒ No ☐
- If the answer to question One is "No," have the interests of all the owners been consolidated by communitization agreement or otherwise? Yes ☐ No ☐ If answer is "Yes," Type of Consolidation \_\_\_\_\_
- If the answer to question Two is "No," list all the owners and their respective interests below:

OWNER

LAND DESCRIPTION

### SECTION B.

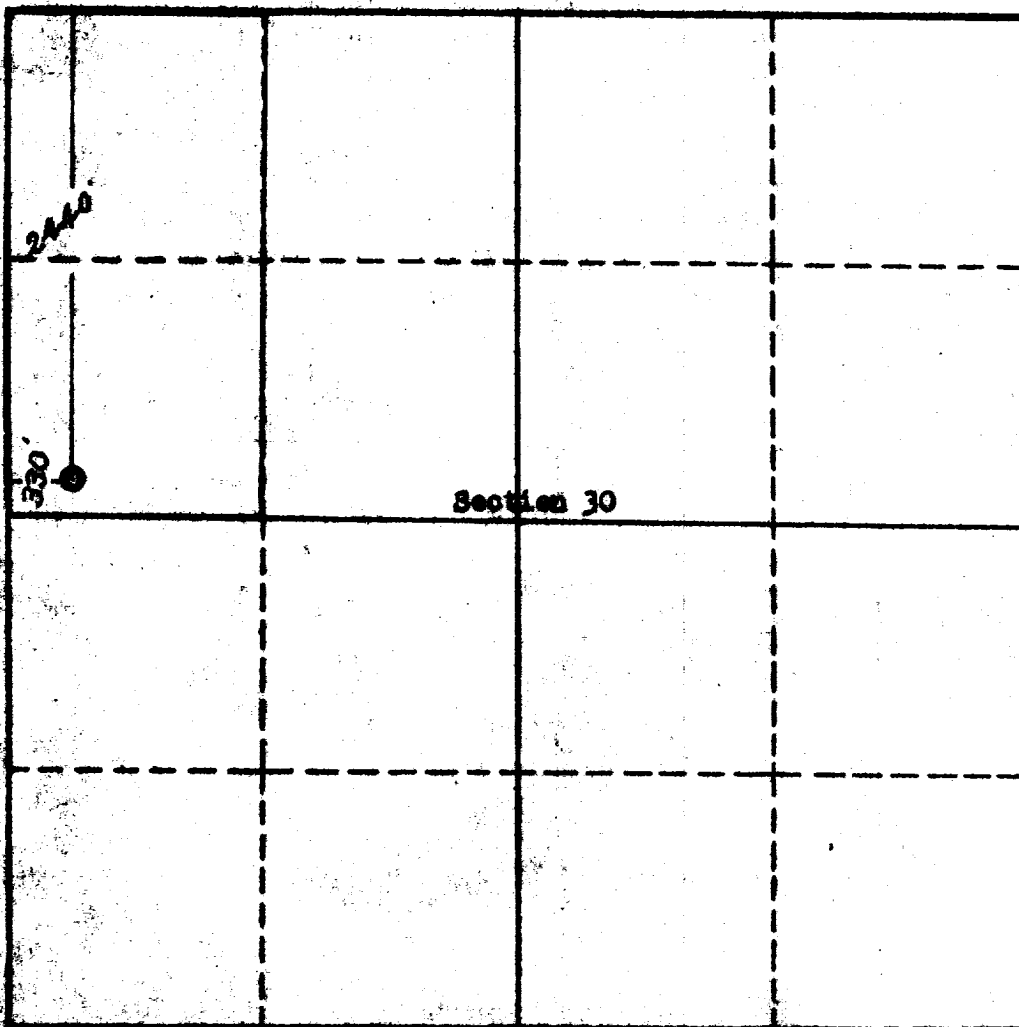

This is to certify that the information in Section A above is true and complete to the best of my knowledge and belief.

**Val R. Reese & Assoc., Inc.**

(OPERATOR)

Original Signed by  
**MORRIS B. JONES**

(REPRESENTATIVE)

**Lobby of Sims Building  
Albuquerque, New Mexico**

(ADDRESS)

This is to certify that the well location shown on the plat in Section B was plotted from field notes of actual survey made by me or my superior and that it is true and correct to the best of my knowledge and belief.

Date Surveyed **July 20, 1961**

**Four States Engineering Co.**  
FARMINGTON, NEW MEXICO

*E. L. Poter*  
REGISTERED ENGINEER OR  
LAND SURVEYOR

Certificate No. **3084**

1 Cal. Oil Co.

1 Germany

2 NMOCC

2 File

(SUBMIT IN TRIPLICATE)

Land Office **Santa Fe**

Lease No. **SF 078562**

Unit

x	30		

UNITED STATES  
DEPARTMENT OF THE INTERIOR  
GEOLOGICAL SURVEY

SUNDRY NOTICES AND REPORTS ON WELLS

NOTICE OF INTENTION TO DRILL	X	SUBSEQUENT REPORT OF WATER SHUT-OFF
NOTICE OF INTENTION TO CHANGE PLANS		SUBSEQUENT REPORT OF SHOOTING OR ACIDIZING
NOTICE OF INTENTION TO TEST WATER SHUT-OFF		SUBSEQUENT REPORT OF ALTERING CASING
NOTICE OF INTENTION TO RE-DRILL OR REPAIR WELL		SUBSEQUENT REPORT OF RE-DRILLING OR REPAIR
NOTICE OF INTENTION TO SHOOT OR ACIDIZE		SUBSEQUENT REPORT OF ABANDONMENT
NOTICE OF INTENTION TO PULL OR ALTER CASING		SUPPLEMENTARY WELL HISTORY
NOTICE OF INTENTION TO ABANDON WELL		

(INDICATE ABOVE BY CHECK MARK NATURE OF REPORT, NOTICE, OR OTHER DATA)

July 24, 19 61

Well No. **Goff 5-30** is located **2440** ft. from **(N)** line and **330** ft. from **(W)** line of sec. **30**  
**SW NW/4** **30** **24N** **6W** **NMPM**  
 (1/4 Sec. and Sec. No.) (Twp.) (Range) (Meridian)  
**Escrito-Gallup** **Rio Arriba** **New Mexico**  
 (Field) (County or Subdivision) (State or Territory)

The elevation of the **ungr. grnd.** ~~surface~~ above sea level is **6931** ft.

DETAILS OF WORK

(State names of and expected depths to objective sands; show sizes, weights, and lengths of proposed casings; indicate mudding jobs, cementing points, and all other important proposed work)

Plan to drill 12-1/2" hole to 200' and run 8-5/8" csg. cemented with 125 sxs. cement. Drill 7-7/8" hole to approximately 5950' to test Gallup. Run 4-1/2" csg. cemented with 150 sxs. at total depth. Perf. & SWF Gallup formation.



I understand that this plan of work must receive approval in writing by the Geological Survey before operations may be commenced.

Company **Val R. Reese & Associates, Inc.**

Address **Lobby of Simms Building**

**Albuquerque, New Mexico**

Original Signed by  
By **MORRIS B. JONES** **Morris B. Jones**  
Title **Engineer**

