

(SUBMIT IN TRIPLICATE)

UNITED STATES
DEPARTMENT OF THE INTERIOR
GEOLOGICAL SURVEY

Land Office santa fe
Lease No. NM 036224
Unit _____

SUNDRY NOTICES AND REPORTS ON WELLS

NOTICE OF INTENTION TO DRILL.....	<input checked="" type="checkbox"/>	SUBSEQUENT REPORT OF WATER SHUT-OFF.....
NOTICE OF INTENTION TO CHANGE PLANS.....		SUBSEQUENT REPORT OF SHOOTING OR ACIDIZING.....
NOTICE OF INTENTION TO TEST WATER SHUT-OFF.....		SUBSEQUENT REPORT OF ALTERING CASING.....
NOTICE OF INTENTION TO RE-DRILL OR REPAIR WELL.....		SUBSEQUENT REPORT OF RE-DRILLING OR REPAIR.....
NOTICE OF INTENTION TO SHOOT OR ACIDIZE.....		SUBSEQUENT REPORT OF ABANDONMENT.....
NOTICE OF INTENTION TO PULL OR ALTER CASING.....		SUPPLEMENTARY WELL HISTORY.....
NOTICE OF INTENTION TO ABANDON WELL.....		

(INDICATE ABOVE BY CHECK MARK NATURE OF REPORT, NOTICE, OR OTHER DATA)

U. S. GEOLOGICAL SURVEY
WASHINGTON, D. C. 20540

April 23

19 62

Crane-Federal

Well No. 7 is located 390 ft. from (N) line and 1650 ft. from (EX) line of sec. 29

NW/4 Section 25 24 North 1 West

NMPM

(1/4 Sec. and Sec. No.)

(Twp.)

(Range)

(Meridian)

So. Blanco Pictured Cliffs

Rio Arriba

New Mexico

(Field)

(County or Subdivision)

(State or Territory)

ground

The elevation of the ~~derrick~~ floor above sea level is 7,721 ft.

DETAILS OF WORK

(State names of and expected depths to objective sands; show sizes, weights, and lengths of proposed casings; indicate mudding jobs, cementing points, and all other important proposed work)

To set a minimum of 100' of 8 5/8" surface casing and cement with 100 sacks. To drill with rotary tools to an approximate T.D. of 3250'. To run electric log to T.D. If productive, to set approximately 3250' of 4 1/2" casing and cement with 100 sacks. To perforate the Pictured Cliffs sand, sand-water frac, and run 1 1/2" EUE tubing.

I understand that this plan of work must receive approval in writing by the Geological Survey before operations may be commenced.

Company Irving Pasternak d/b/a Shar-Alan Oil Company

Address 1402 Denver U. B/ National Center

Denver, Colorado

By Richard S. Hunt

Title Manager of Lands & Explorations

Well Location and Acreage Dedication Plat

Section A.

Date _____

Operator Irving Pasternak DBA, Shar-Alan Oil Co. Lease Crane-Federal, Lease # NW 036224
 Well No. 7 Unit Letter C Section 29 Township 24 North Range 1 West NMPM
 Located 890 Feet From North Line, 1650 Feet From West Line
 County Rio Arriba G. L. Elevation 7721 ungraded Dedicated Acreage 160 Acres
 Name of Producing Formation Picture Cliff Pool undesignated

1. Is the Operator the only owner in the dedicated acreage outlined on the plat below?
 Yes X No _____
2. If the answer to question one is "no", have the interests of all the owners been consolidated by communitization agreement or otherwise? Yes _____ No _____. If answer is "yes", Type of Consolidation.
3. If the answer to question two is "no", list all the owners and their respective interests below:

OwnerLand Description

Irving Pasternak DBA, Shar-Alan Oil Company NW 1/4 Sec 29, T23N, R1W, N.M.

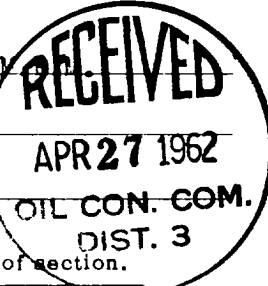

Section B.

Note: All distances must be from outer boundaries of section.

This is to certify that the information
 in Section A above is true and complete
 to the best of my knowledge and belief.

Irving Pasternak, DBA Shar-Alan Oil Co
 (Operator)

Richard S. Hunt, Mgr of Lands &
 (Representative) Exploration

1402 Denver US National Center
 (Address)

Denver 2, Colorado

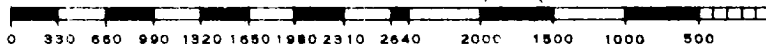
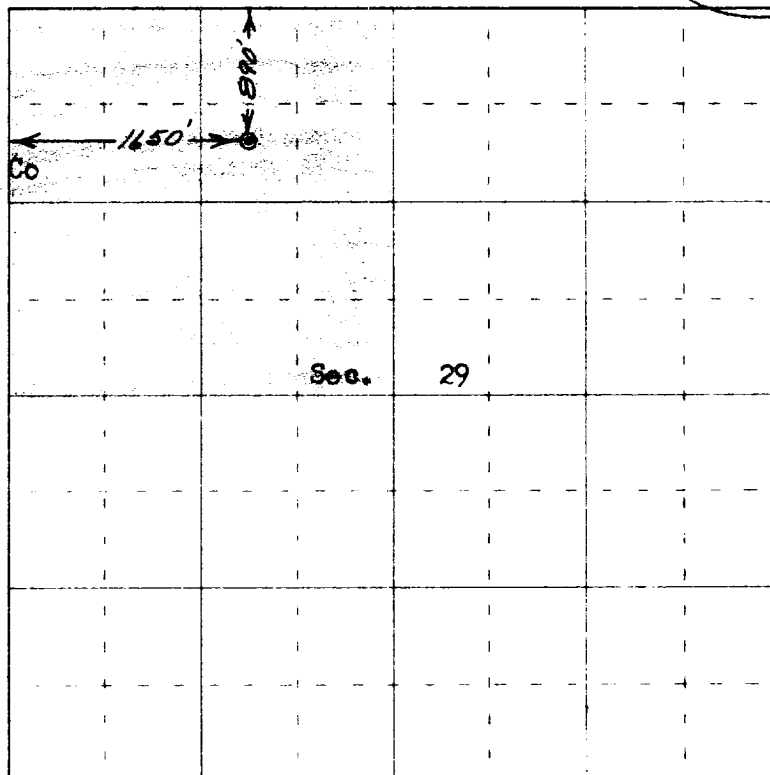

Scale 4 inches equal 1 mile

This is to certify that the above plat was prepared from field notes of actual surveys made by me or under my supervision and that the same are true and correct to the best of my knowledge and belief.

(Seal)

Date Surveyed 9 April 1962

Farmington, New Mexico
 San Juan Engineering Co.

Robert H. Ernst
 Registered Professional Engineer and/or Land Surveyor
 Robert H. Ernst DE & IS 2162