

NEW MEXICO
OIL CONSERVATION COMMISSION

Form C-128

Well Location and/or Gas Proration Plat

Date 5-15-56

Operator HUMBLE OIL & REFINING COMPANY Lease JICARILLA APACHE TRIBE OF INDIANS "D"

Well No. 2 Section 19 Township - 24- N Range - 4 - W NMPM

Located 990 Feet From SOUTH Line, 990 Feet From WEST Line,

RIO ARriba

County, New Mexico. G. L. Elevation _____

OTERO

Name of Producing Formation PICTURED CLIFFS Pool PICTURED CLIFFS Dedicated Acreage 124.14

(Note: All distances must be from outer boundaries of Section)

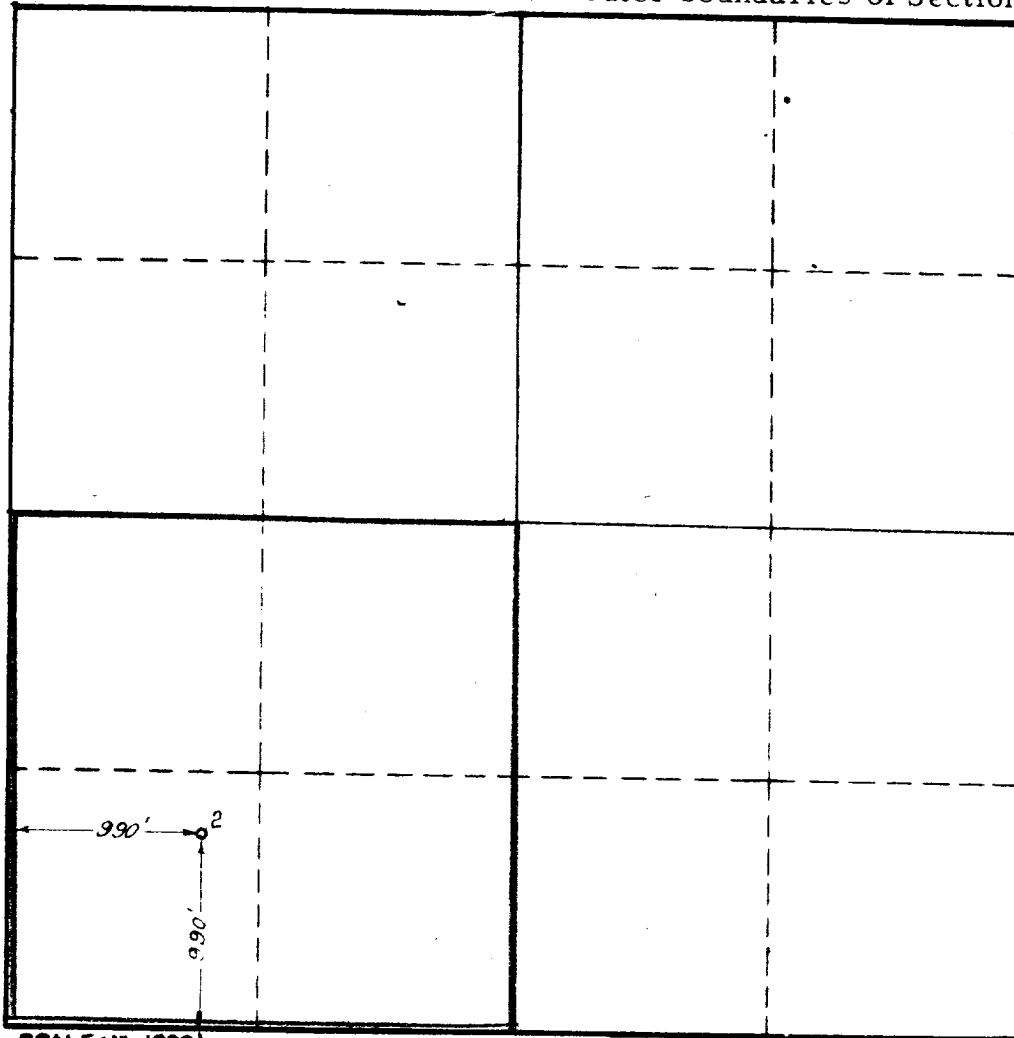

SCALE: 1" = 1000'

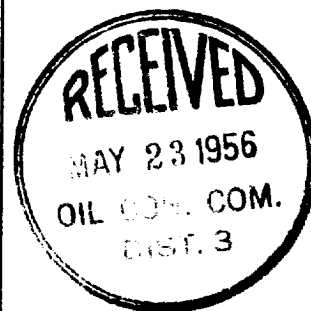

1. Is this Well a Dual Comp. ? YES No ____.
2. If the answer to Question 1 is yes, are there any other dually completed wells within the dedicated acreage ? Yes ____ No ____.

This is to certify that the above plat was prepared from field notes of actual surveys made by me or under my supervision and that the same are true and correct to the best of my knowledge and belief.

Name J. P. Henkle
Position ASSISTANT DIVISION SUPERINTENDENT
Representing HUMBLE OIL & REFINING COMPANY
Address BOX 1600, MIDLAND, TEXAS

Date Surveyed 10-19-55
E. T. Shahan
Registered Professional Engineer and/or
Land Surveyor
Lease No. 163113
Contract No. 42

W-A 2136

OIL CONSERVATION COMMISSION	
MISCELLANEOUS FILE	
No. Containing Pages	5
Date Recd.	
Date Paid	
Amount Paid	2
By Whom Paid	1
For What Purpose	
U.S.D.C.	1
Transferred	
File	✓