



COPY TO O.C.G.

UNITED STATES
DEPARTMENT OF THE INTERIOR
GEOLOGICAL SURVEY
P. O. Box 965
Farmington, New Mexico

IN REPLY REFER TO:

August 17, 1955

Amerada Petroleum Corporation
Drawer D
Monument, New Mexico

Re: Jicarilla Cont #11
Tr. 19

Gentlemen:

Receipt is acknowledged of your "Notice of Intention to ^{APACHE "B"} Drill" dated August 10, 1955 covering your well No. 2 Jicarilla in SE $\frac{1}{4}$ SE $\frac{1}{4}$ sec. 20, T. 24 N., R. 5 W., N. M. P. M., Rio Arriba County, New Mexico.

Your proposed work is hereby approved subject to compliance with the provisions of the "Oil and Gas Operating Regulations" revised May 25, 1942, a copy of which will be sent to you on request, and subject to the following conditions:

1. Drilling operations so authorized are subject to the attached sheet for general conditions of approval.
2. Furnish copies of all logs.

Very truly yours,

(Orig. Sgd. J. W. Long)

Jerry W. Long
Acting District Engineer

JWLong:as
cc: Jicarilla Agency



UNITED STATES
DEPARTMENT OF THE INTERIOR
GEOLOGICAL SURVEY



RECEIVED
JUL 10 1900

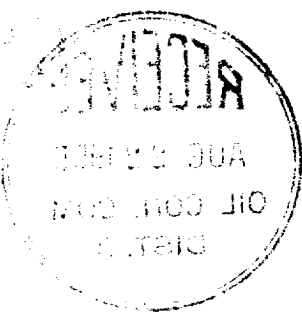

(SUBMIT IN TRIPLICATE)

UNITED STATES
DEPARTMENT OF THE INTERIOR
GEOLOGICAL SURVEY

Land Office **Hicarilla Apache**
Lease No. **Hicarilla Apache**
Fiscal **11; Tract 119**
Unit **Hicarilla Apache**

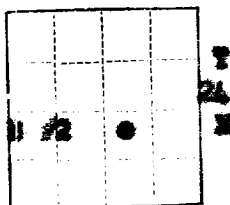

SUNDRY NOTICES AND REPORTS ON WELLS

NOTICE OF INTENTION TO DRILL	<input checked="" type="checkbox"/>	SUBSEQUENT REPORT OF WATER SHUT-OFF	
NOTICE OF INTENTION TO CHANGE PLANS		SUBSEQUENT REPORT OF SHOOTING OR ACIDIZING	
NOTICE OF INTENTION TO TEST WATER SHUT-OFF		SUBSEQUENT REPORT OF ALTERING CASING	
NOTICE OF INTENTION TO RE-DRILL OR REPAIR WELL		SUBSEQUENT REPORT OF RE-DRILLING OR REPAIR	
NOTICE OF INTENTION TO SHOOT OR ACIDIZE		SUBSEQUENT REPORT OF ABANDONMENT	
NOTICE OF INTENTION TO PULL OR ALTER CASING		SUPPLEMENTARY WELL HISTORY	
NOTICE OF INTENTION TO ABANDON WELL			

(INDICATE ABOVE BY CHECK MARK NATURE OF REPORT, NOTICE, OR OTHER DATA)

August 10, 1955

Well No. **X 2** is located **990** ft. from **100** line and **990** ft. from **100** line of sec. **20**
SE 1/4 **20** **1-21-N** **10-5-W** **100W**
 (1/4 Sec. and Sec. No.) (Twp.) (Range) (Meridian)
Unassigned **San Arriba** **New Mexico**
 (Field) (County or Subdivision) (State or Territory)

The elevation of the derrick floor above sea level is _____ ft. **not determined**

DETAILS OF WORK

(State names of and expected depths to objective sands; show sizes, weights, and lengths of proposed casings; indicate mudding jobs, cementing points, and all other important proposed work)

We intend to drill well with rotary tools to approximately 3000' to test Fruitland
Pictured Cliff Section

Hole	Casing	Depth	Well L.S.H.	Depth	Well Set	Depth
12 1/4"	8 5/8"	24	New	140'	Cemented	75
7 7/8"	5 1/2"	15.5	New	3000'	Cemented	200

I understand that this plan of work must receive approval in writing by the Geological Survey before operations may be commenced.

Company **Amerasia Petroleum Corporation**

Address **Dresser B**

Albuquerque, New Mexico

By **D.C. Cappel**

Title **D.C. Cappel Dist. Engr.**

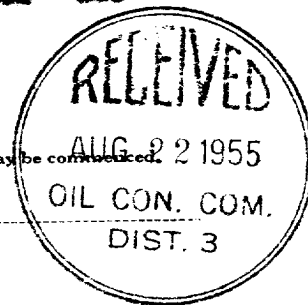

Company.....AMERADA PETROLEUM CORPORATION.....

Lease.....Well No.....

Sec. 20, T. 24 N., R. 5 W. N.M.P.M.

Location.....990' from the South line and 990' from the East line.

Rio Arriba Co.

New Mexico

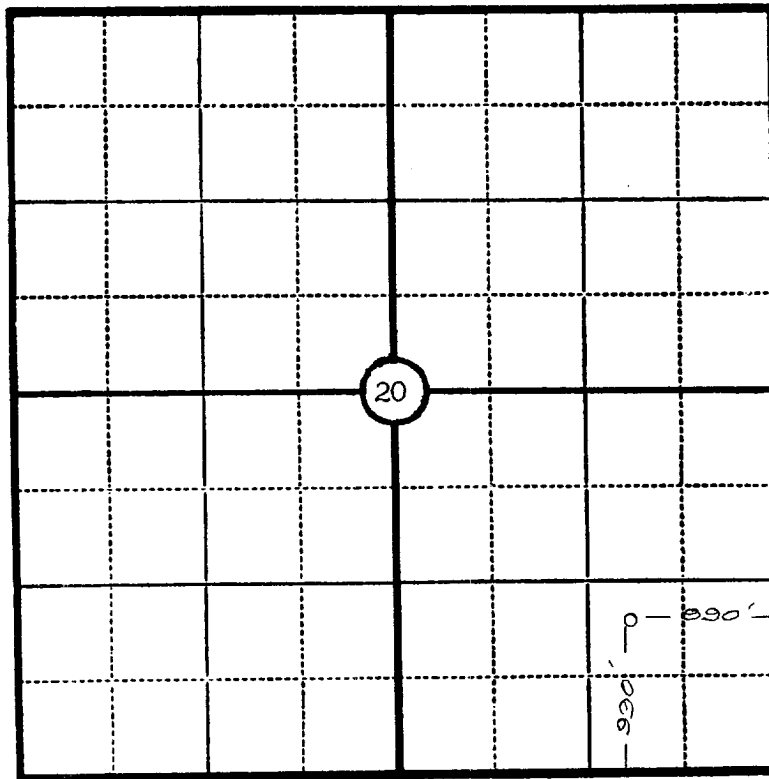

Scale—4 inches equal 1 mile.

This is to certify that the above plat was prepared from field notes of actual surveys made by me or under my supervision and that the same are true and correct to the best of my knowledge and belief.

Seal:

James P. Lee
Registered [REDACTED] Land Surveyor.

N.M. Reg. No. 1463

Surveyed August 10, 1955

