



IN REPLY REFER TO: ✓

UNITED STATES
DEPARTMENT OF THE INTERIOR
GEOLOGICAL SURVEY
P. O. Box 965
Farmington, New Mexico

May 2, 1956



El Paso Natural Gas Company
Box 997
Farmington, New Mexico

Re: Santa Fe 078909

Gentlemen:

Receipt is acknowledged of your "Notice of Intention to Drill" dated April 30, 1956 covering your well No. 7 Lindrith Unit in SW¹ sec. 21, T. 24 N., R. 2 W., N. M. P. M., Rio Arriba County, New Mexico, Wildest pool.

Your proposed work is hereby approved subject to compliance with the provisions of the "Oil and Gas Operating Regulations" revised May 25, 1942, a copy of which will be sent to you on request, and subject to the following conditions:

1. Drilling operations so authorized are subject to the attached sheet for general conditions of approval.
2. Furnish copies of all logs.

Very truly yours,

(Sgd.) P. T. McGRATH

P. T. McGrath
District Engineer

PTMcGrath:as

UNITED STATES
DEPARTMENT OF THE INTERIOR
GEOLOGICAL SURVEY

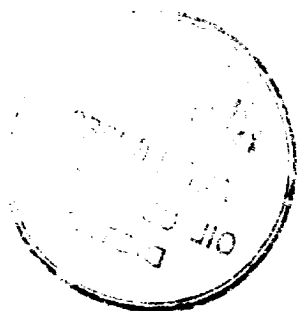

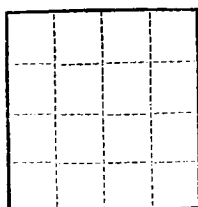

(SUBMIT IN TRIPLICATE)

UNITED STATES
DEPARTMENT OF THE INTERIOR
GEOLOGICAL SURVEY

Land Office Albuquerque, N.M.

Lease No. 71227

Unit Albuquerque Dist.

SUNDRY NOTICES AND REPORTS ON WELLS

| | | | |
|---|-------------------------------------|---|--|
| NOTICE OF INTENTION TO DRILL..... | <input checked="" type="checkbox"/> | SUBSEQUENT REPORT OF WATER SHUT-OFF..... | |
| NOTICE OF INTENTION TO CHANGE PLANS..... | | SUBSEQUENT REPORT OF SHOOTING OR ACIDIZING..... | |
| NOTICE OF INTENTION TO TEST WATER SHUT-OFF..... | | SUBSEQUENT REPORT OF ALTERING CASING..... | |
| NOTICE OF INTENTION TO RE-DRILL OR REPAIR WELL..... | | SUBSEQUENT REPORT OF RE-DRILLING OR REPAIR..... | |
| NOTICE OF INTENTION TO SHOOT OR ACIDIZE..... | | SUBSEQUENT REPORT OF ABANDONMENT..... | |
| NOTICE OF INTENTION TO PULL OR ALTER CASING..... | | SUPPLEMENTARY WELL HISTORY..... | |
| NOTICE OF INTENTION TO ABANDON WELL..... | | | |

(INDICATE ABOVE BY CHECK MARK NATURE OF REPORT, NOTICE, OR OTHER DATA)

Well No. 7 is located 1224 ft. from S line and 400 ft. from E line of sec. 21
1 (1/4 Sec. and Sec. No.) 24S (Twp.) 2E (Range) 104W (Meridian)
Alameda (Field) San Juan (County or Subdivision) New Mexico (State or Territory)

The elevation of the derrick floor above sea level is 7119 ft.

DETAILS OF WORK

(State names of and expected depths to objective sands; show sizes, weights, and lengths of proposed casings; indicate mudding jobs, cementing points, and all other important proposed work)

It is intended to drill a well thru the fractured Cliff formation using rotary tools to the casing point and to drill the pay section with cable tools and to enter fracture the entire pay section. Est. P.D. 3110'.

Logging Program.

3 5/8" at 125' w.t. 125 sacks regular cement circulated to surface.

3 1/2" at 3110' w.t. 75 sacks regular cement, 75 sacks Portland.

The 1/4 of Section 21 is dedicated to this well.

(copy of 1/4).

I understand that this plan of work must receive approval in writing by the Geological Survey before operations may be commenced.

Company Alameda Natural Gas Company

Address Box 997

Albuquerque, New Mexico

By D.C. Johnston

Title Petroleum Eng. Sec.

NEW MEXICO
OIL CONSERVATION COMMISSION

WELL LOCATION AND/OR GAS PRODUCTION PLAT

DATE APRIL 9, 1956

COMPANY EL PASO NATURAL GAS COMPANY UNIT LINDRITH UNIT SF 078909

SECTION 7 TOWNSHIP 21 RANGE 24-N COUNTY 2-N STATE N.M.

ACREAGE 1650 DIRECTION SOUTH DISTANCE 1090 BEARING WEST

RIC ARRIEBA

715874

PICTURED CLIFF

WILDCAT

160

(1915 PLAT)

Note: All distances must be from center boundary of section.

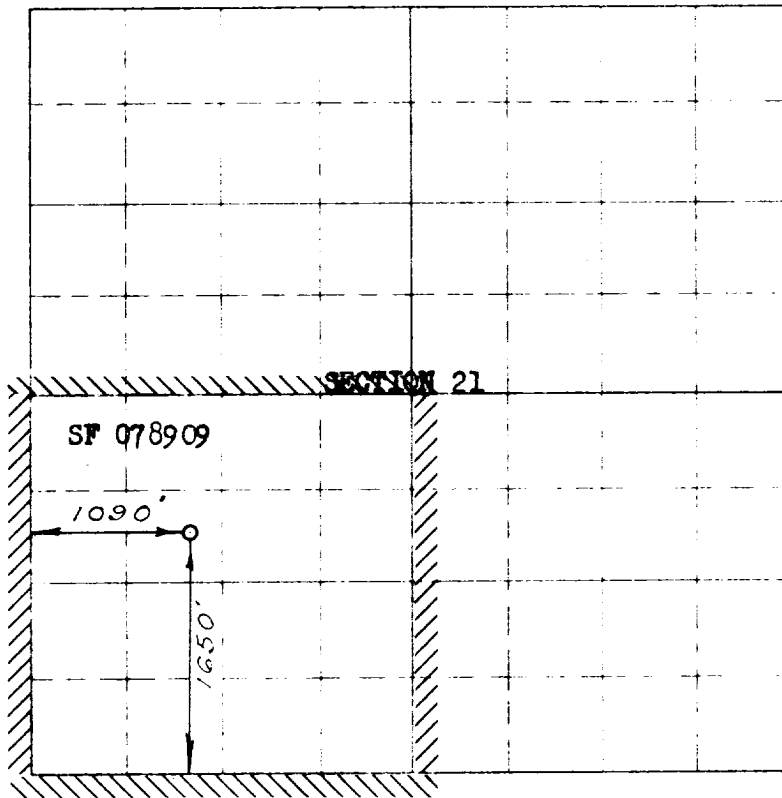

NOTE

This section of
form is to be used
for gas wells only

This is to certify that the above plat was prepared from
field notes of actual surveys made by me or under my
supervision and that the same are true and correct to the
best of my knowledge and belief.

Date Surveyed APRIL 5, 1956

E. O. Walker
Registered Professional Engineer and/or Land Surveyor

1. Is this well a Dual Comp. ☒

Yes _____ No _____

2. If the answer to Question 1
is yes, are there any other dually
completed wells within the
dedicated acreage.

Yes Original Signed D. C. Johnston

Name _____

Petroleum Engineer

Position _____

El Paso Natural Gas Co.
Representing _____

Box 997, Farmington, N.M.
Address _____